

WARNING

Any unauthorized copying, producing and reproducing of ABER company products, or any part thereof, is strictly prohibited and any such action establishes liability for a civil action and may give rise to criminal prosecution.

OSTRZEŻENIE

Jakiegokolwiek kopiowanie, produkowanie i reprodukcja wyrobów firmy ABER bez zezwolenia, w całości lub części jest surowo zabronione. Powyższe działania powodują powstanie odpowiedzialności cywilnej oraz mogą spowodować wszczęcie postępowania karnego.

35 K06



EXCLUSIVE EDITION

**UPGRADE SET
FOR TAMIYA
1/35 MODEL no 35285**

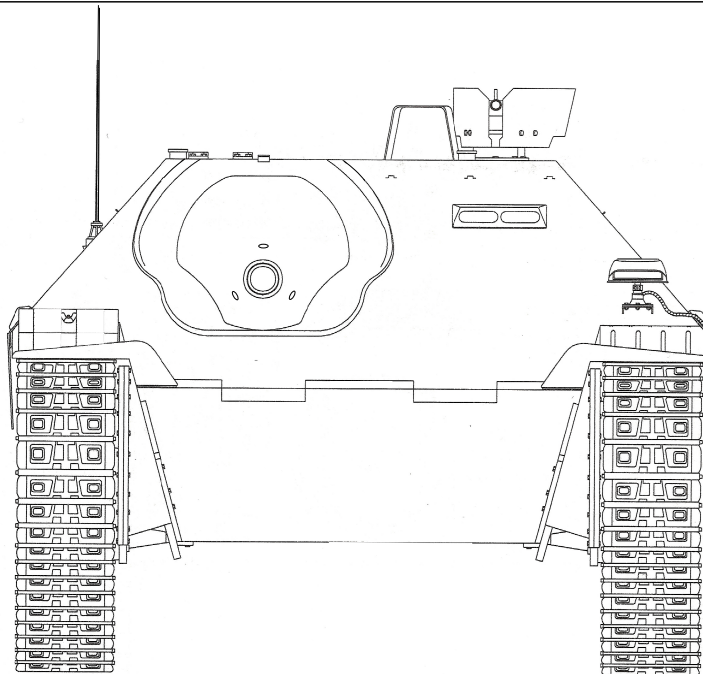

GERMAN TANK DESTROYER HETZER

Sd.Kfz. 138/2

Niemiecki niszczyciel czołgów Sd.Kfz. 138/2 "Hetzer"

TOOLS RECOMMENDED

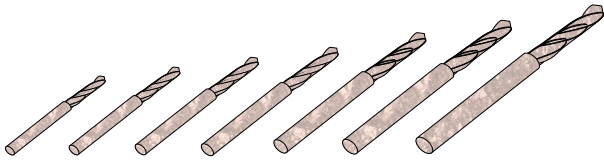

Drills from \varnothing 0,4 to 1,5 mm



Assortiment of cutting wheels and mills

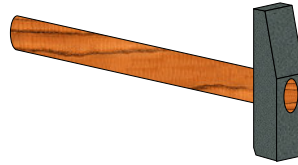

Light weight hammer

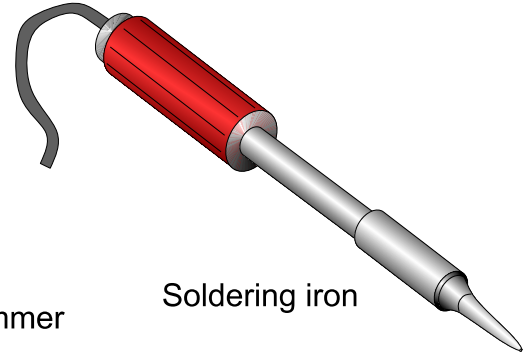

Soldering iron

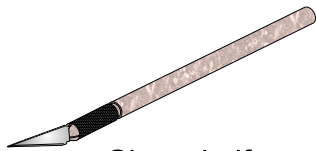

Sharp knife

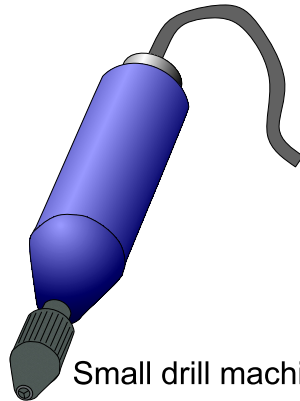

Small drill machine



Bending tool
PG01 or PG02



Soldering flux



Solder

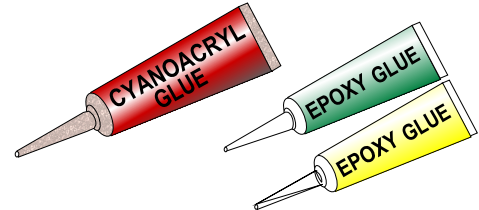

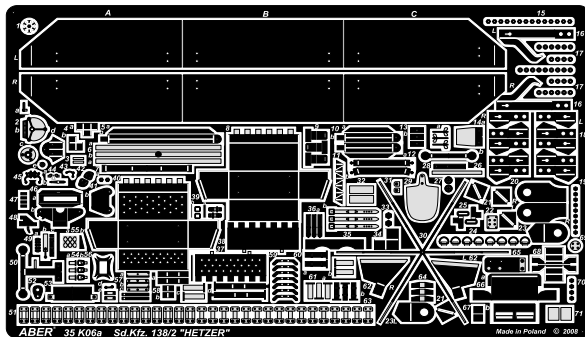
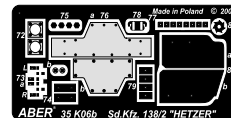
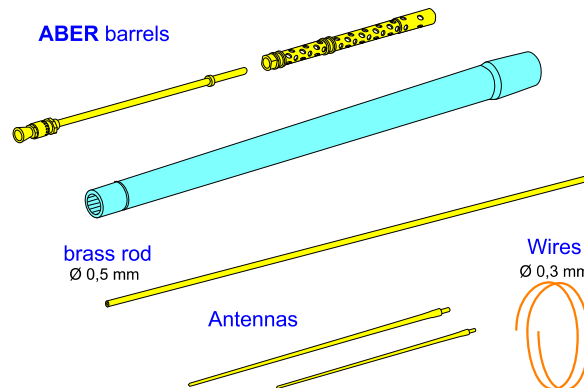
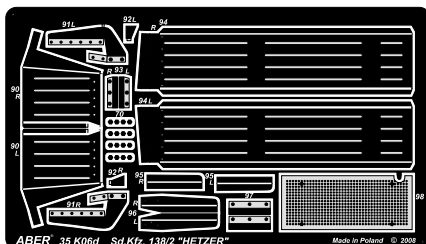
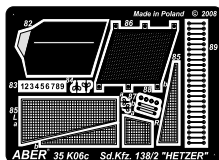
A**B****ABER barrels****D****C****Bibliography:**

- Die Panzer - Kampfwagen 35(t) und 38 (t) und ihre Abarten - Walter J. Spielberger, Hilary L. Doyle
- PANZER TRACTS No.9 - Jagdpanzer - Thomas L. Jentz, Hilary L. Doyle
- GROUND POWER No 053 (10/98)
- Tanks and Military Vehicles EE2 Vol.1 - MK Editions
- Jagdpanzer 38(t) "Hetzer" No 45 & 56 - Wydawnictwo Militaria
- Inside The Great Tanks - Hans Halberstadt
- drawings "ACHTUNG PANZER !" from Model Graphix

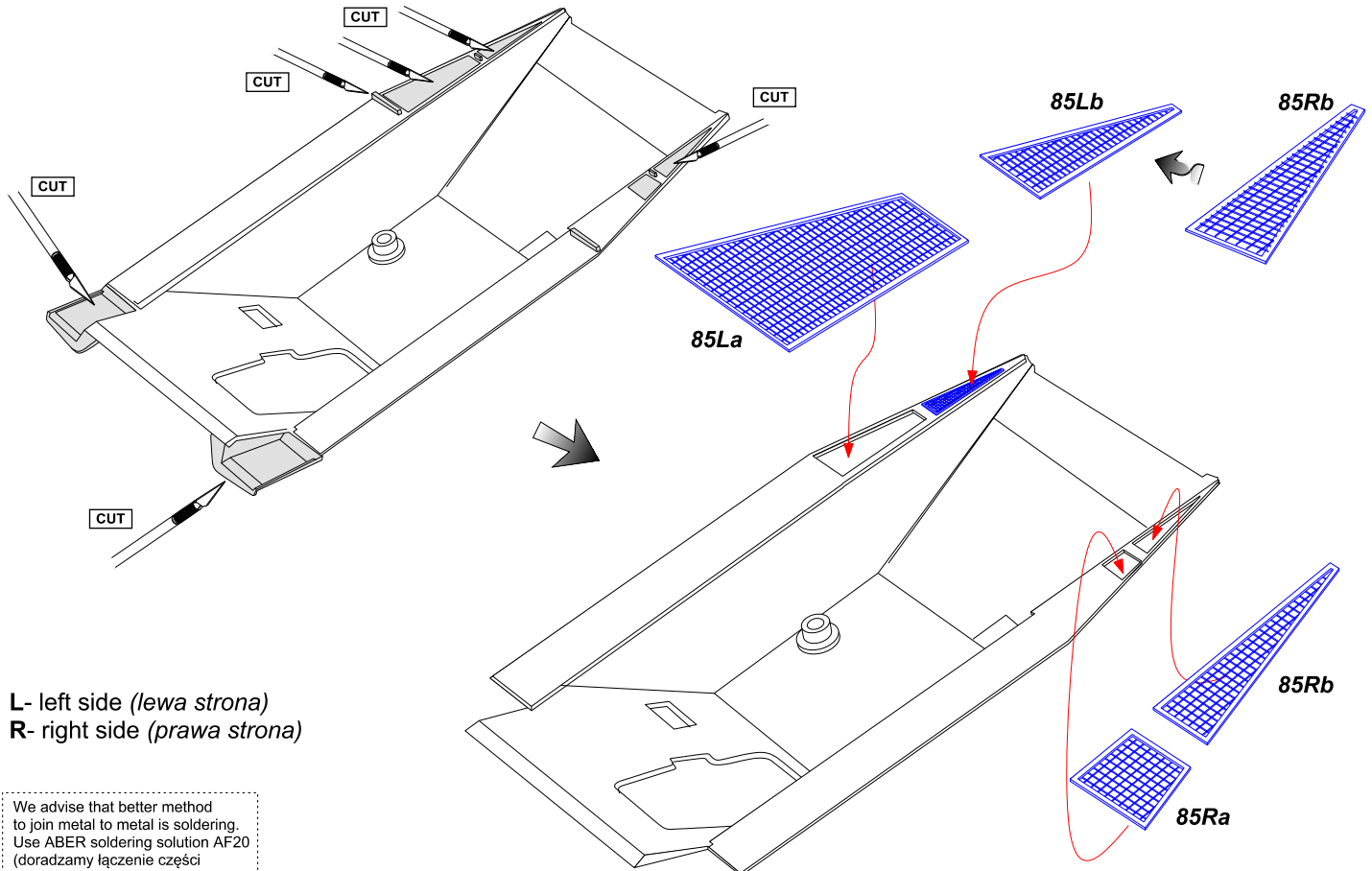

L- left side (*lewa strona*)
R- right side (*prawa strona*)

We advise that better method to join metal to metal is soldering.
 Use ABER soldering solution AF20
 (dorzadzamy łączenie części metalowych za pomocą lutownia.
 Zastosuj nasz topnik AF20)

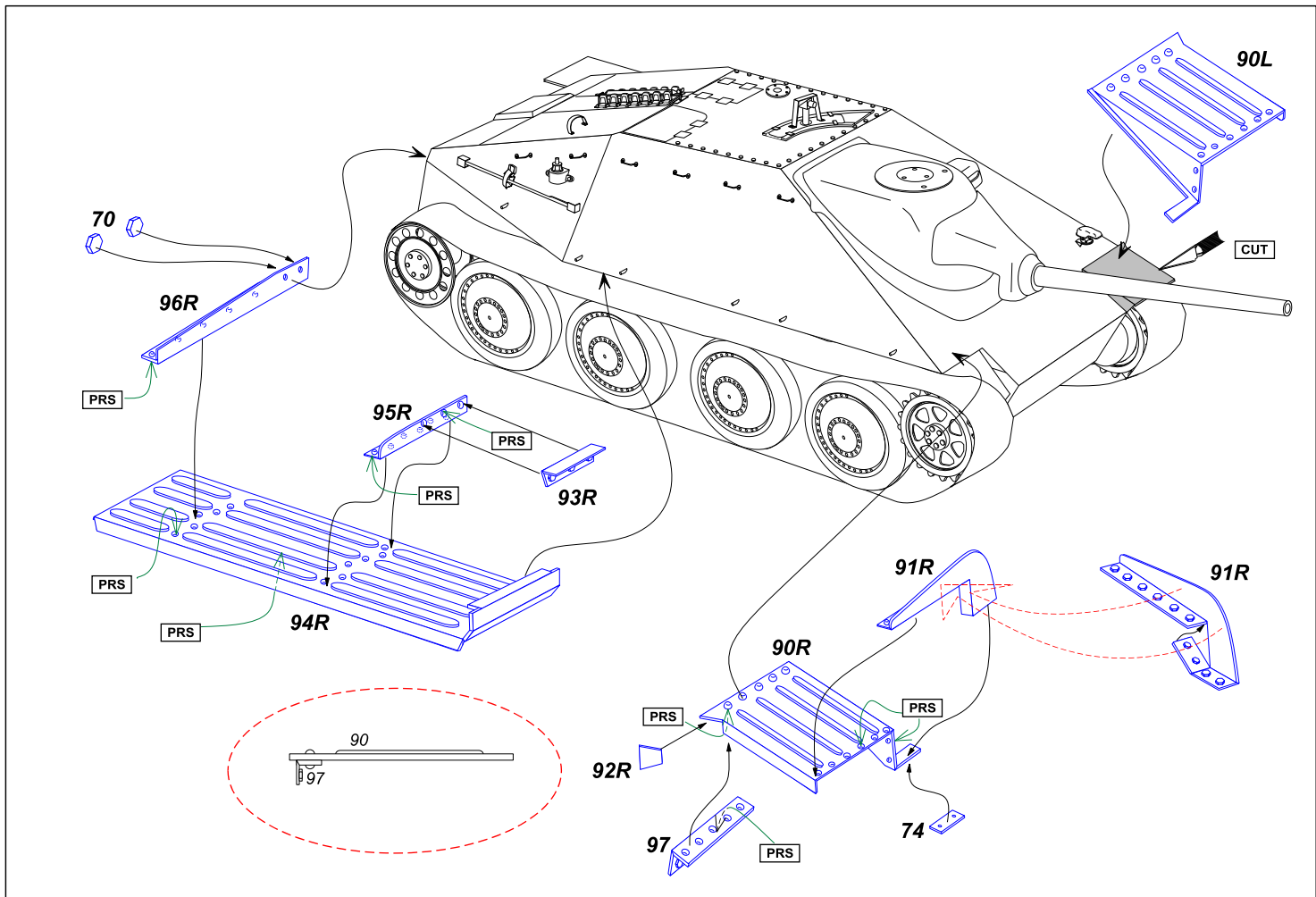

OPTIONAL - Hetzer early / middle version

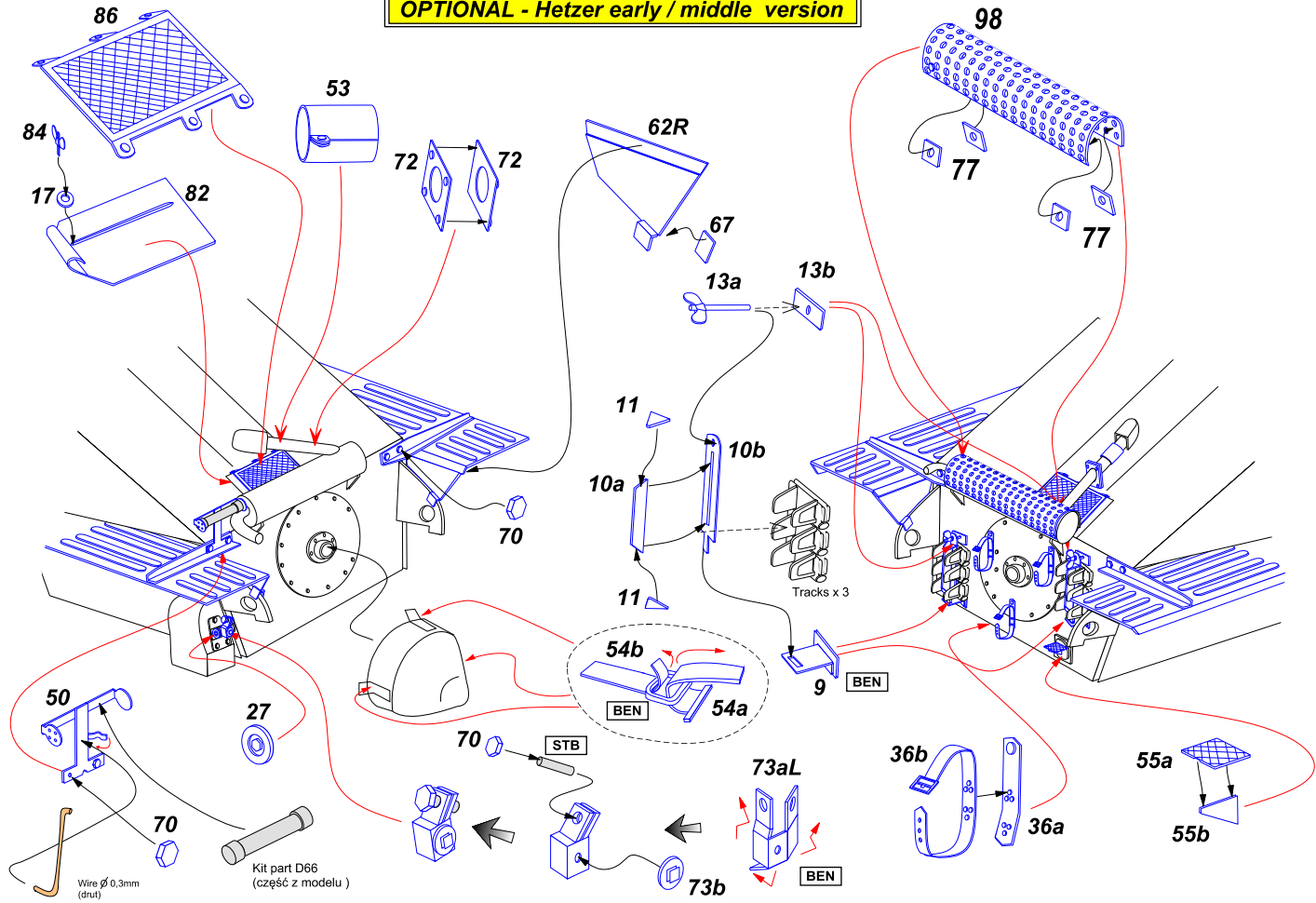

Wire \varnothing 0,3mm
(druć)

Kit part D66
(część z modelu)

OPTIONAL - Hetzer late version

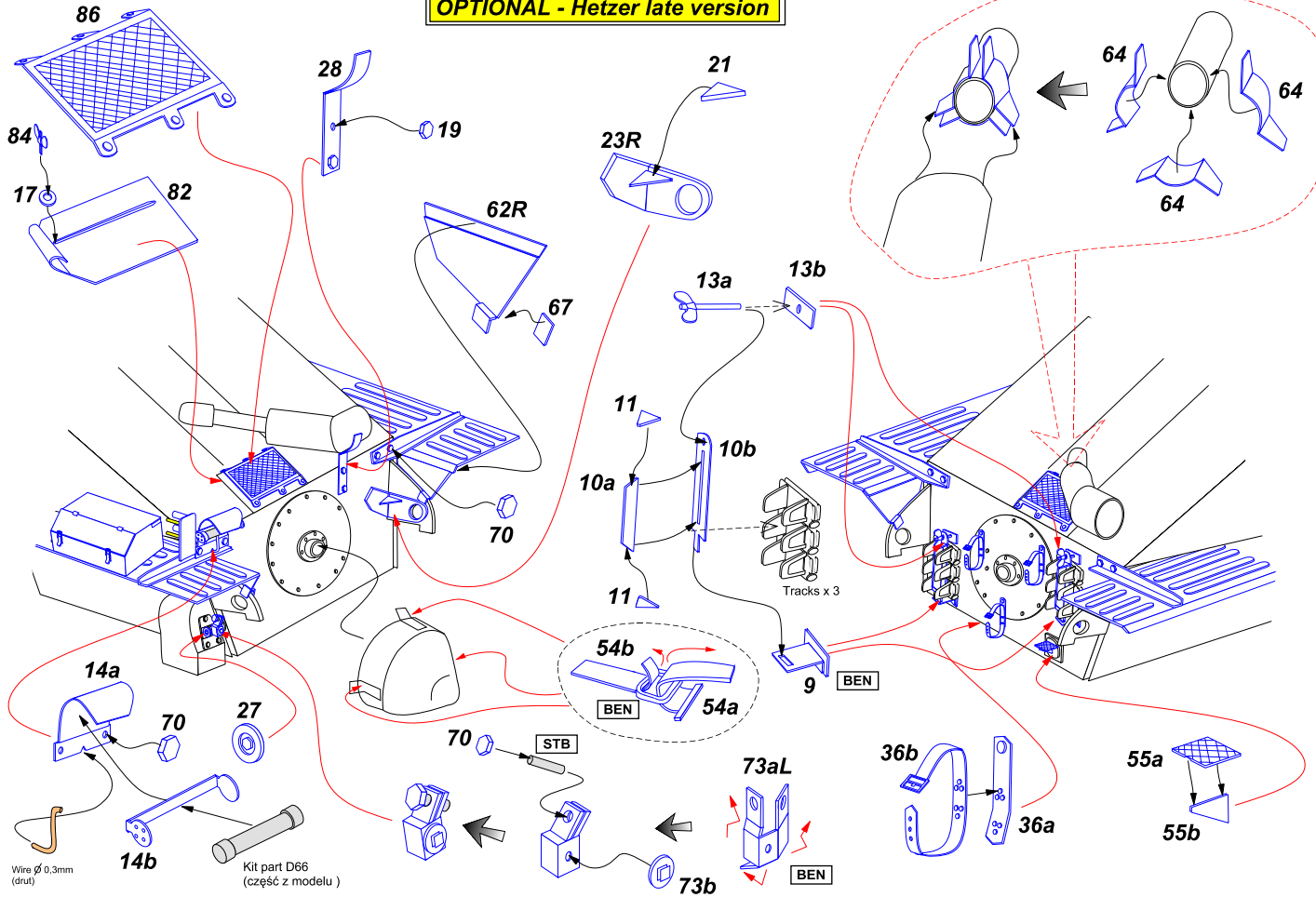

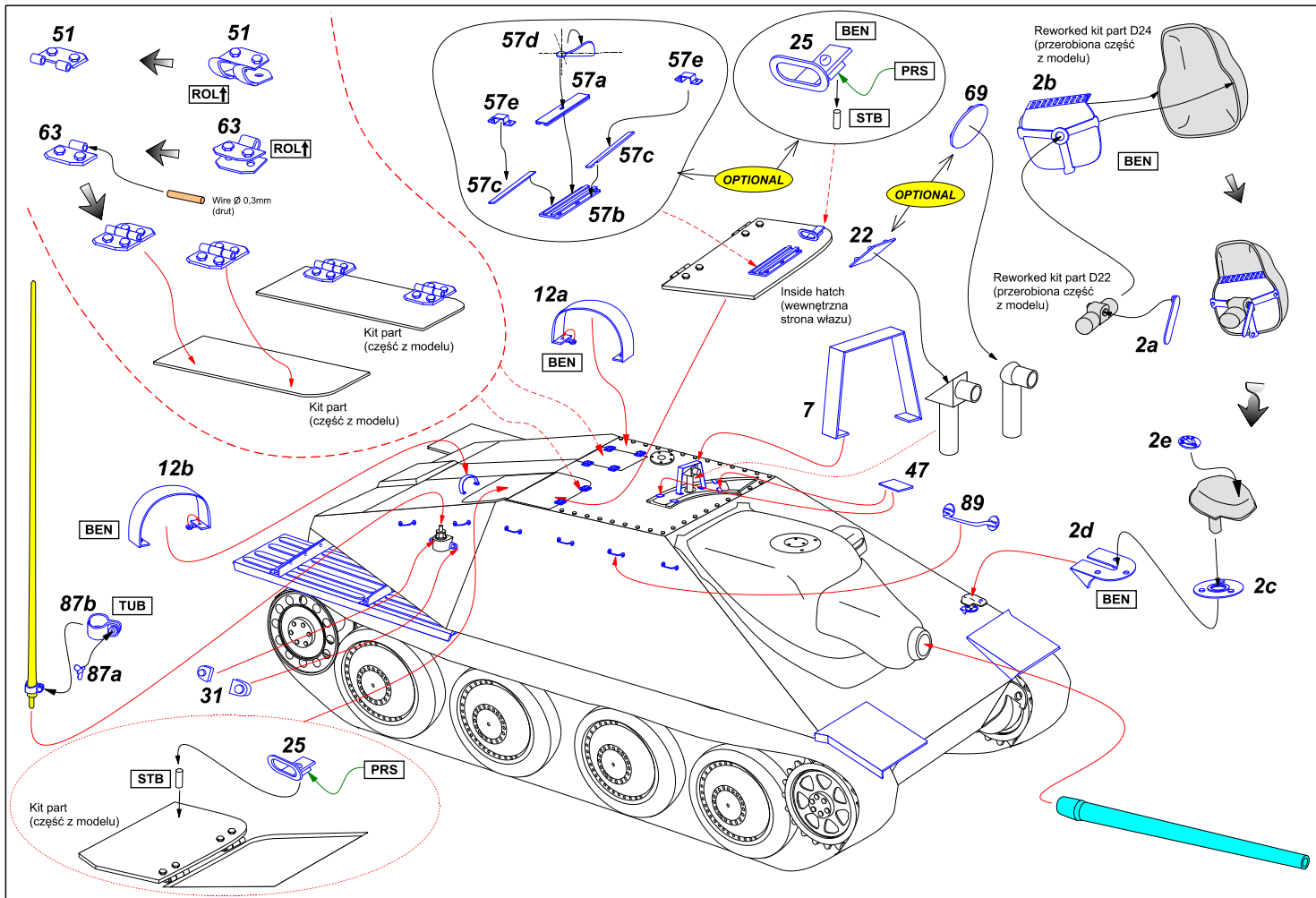

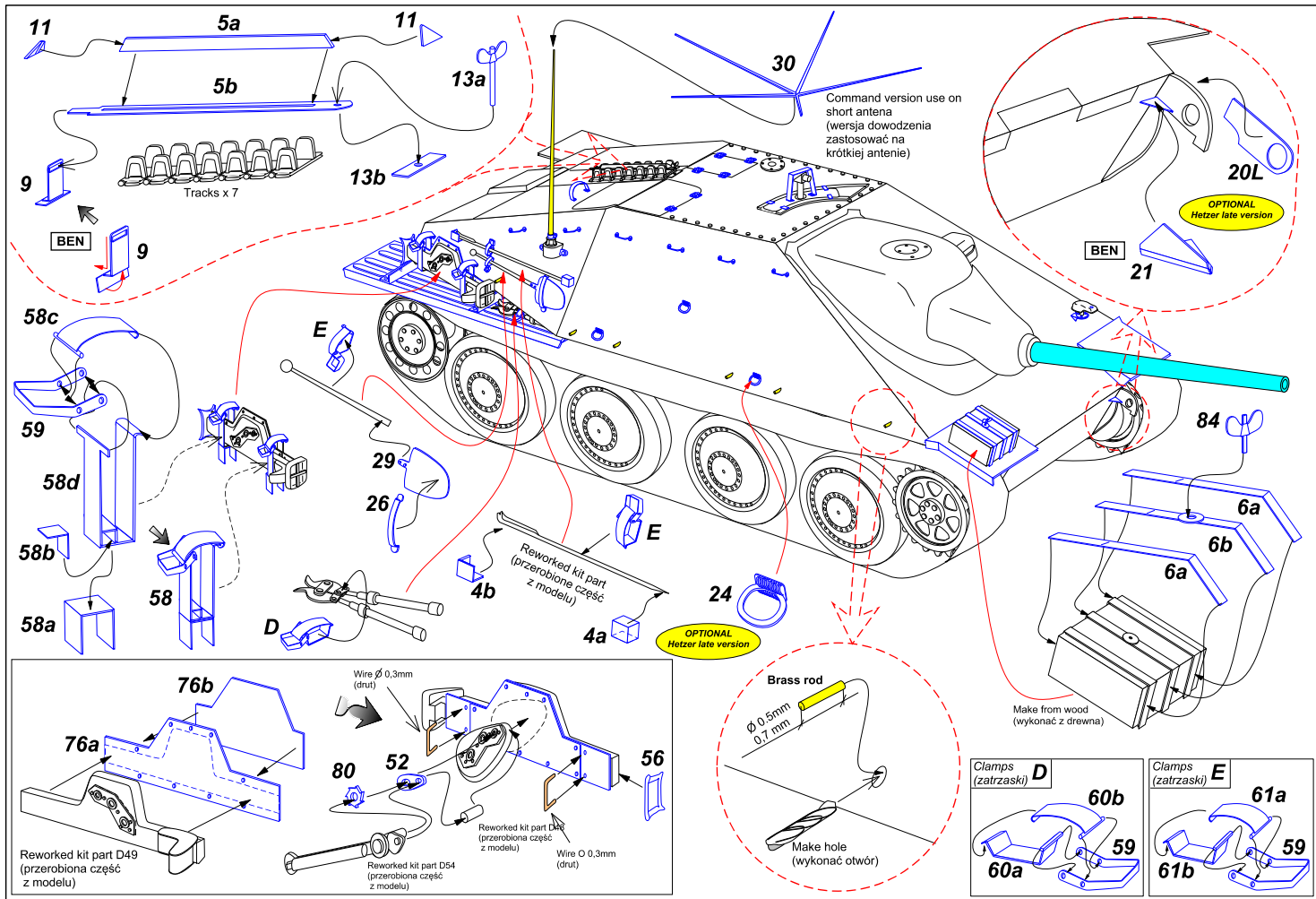

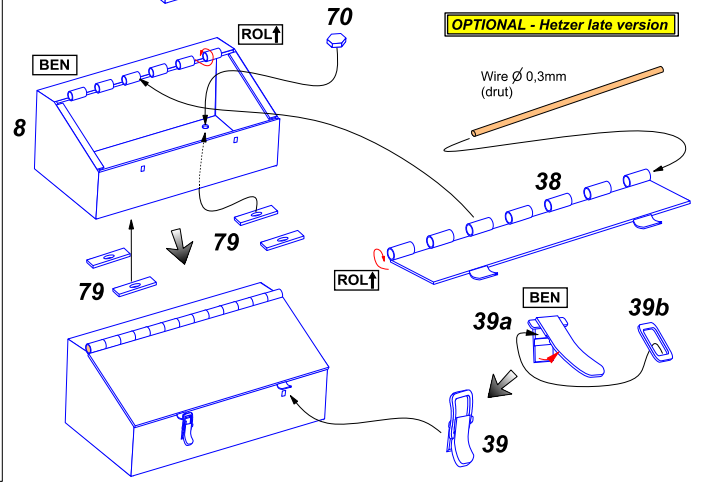
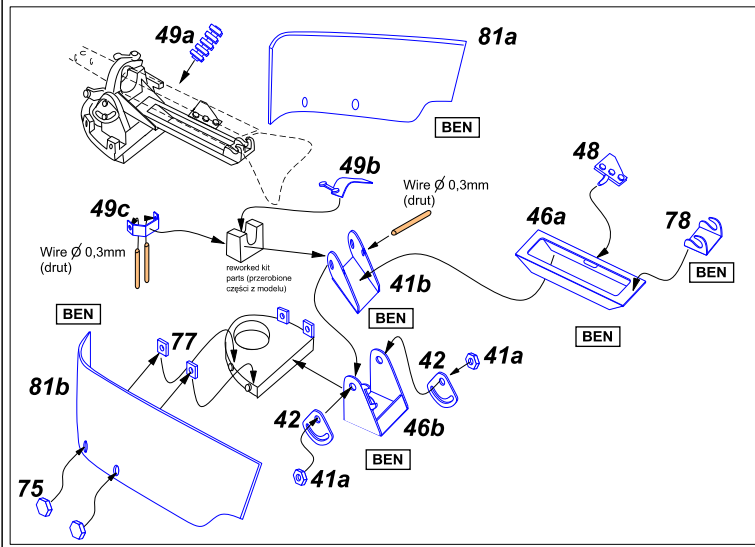
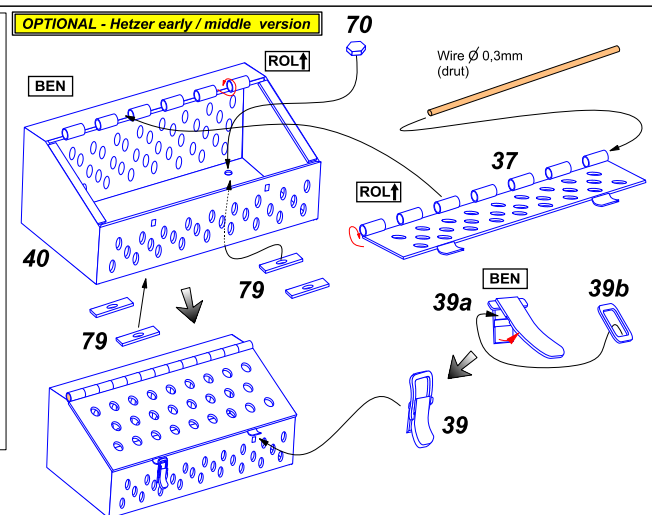
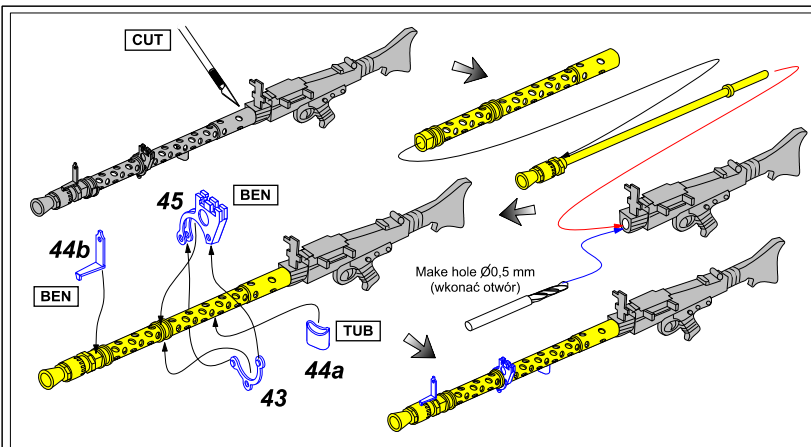

OPTIONAL - Hetzer early / middle version

