

Douglas XF5D-1 Skylancer

1/72 scale resin model kit

#AA-2055

In 1947, based on the German Lippisch's delta wing design, Douglas designed and produced an excellent F4D-1 Skyray. After five years of its operation, Douglas engineers collected the weakness and created a new improved fighter, the F4D-2N. The U.S. Navy interested the concept, two prototypes were ordered to Douglas. As it was actually very different with the F4D-1 Skyray, although it was outwardly similar, a new designation F5D-1 Skylancer was given. The F5D-1 was powered by the same engine as used in F4D-1. During its first flight in 1956, it exceeded sound speed easily. The F5D-1 was judged an outstanding interceptor but lost production contract to the Vought F8U-1 Crusader by political motives rather than the technical reasons. It was because Douglas had many military airplane orders from the Navy at that time. After Navy's cancellation, four airplanes were proceeded with various Military tests until 1961. Then two were grounded and two transferred to NASA. It was finally retired in 1970.

- Specifications:**
- Wingspan - 33ft.6in.
 - Length - 53ft.9in.
 - Height - 14ft.10in.
 - Powerplants - 1x Pratt & Whitney J57-P-8 turbojet
 - Crew - 1
 - Max speed - 990 mph
 - Armament - 4x 20mm cannon (planned on wing)

The F5D-1 had performed as the chase plane for the flight tests of the NASA HL-10 lifting body program.

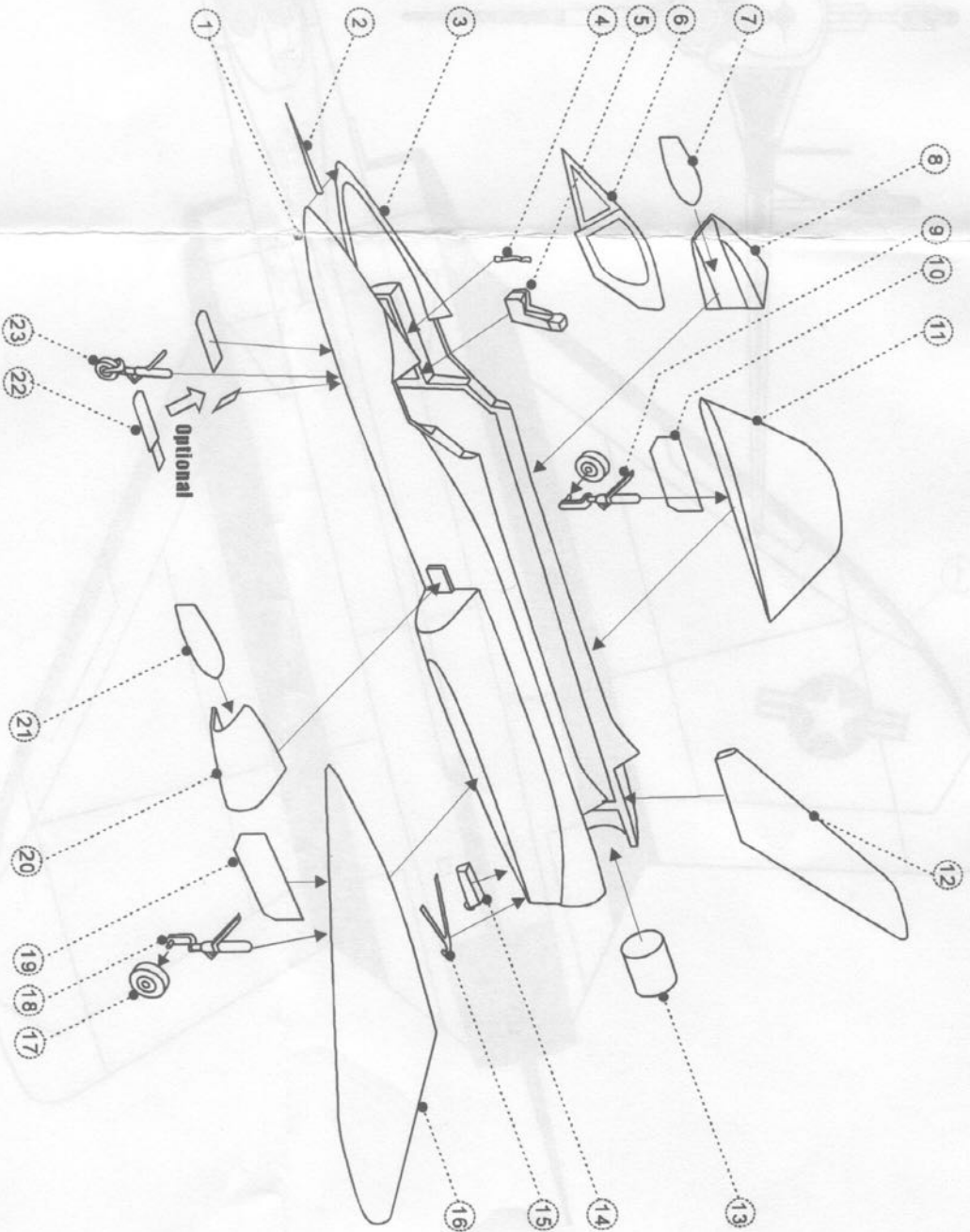
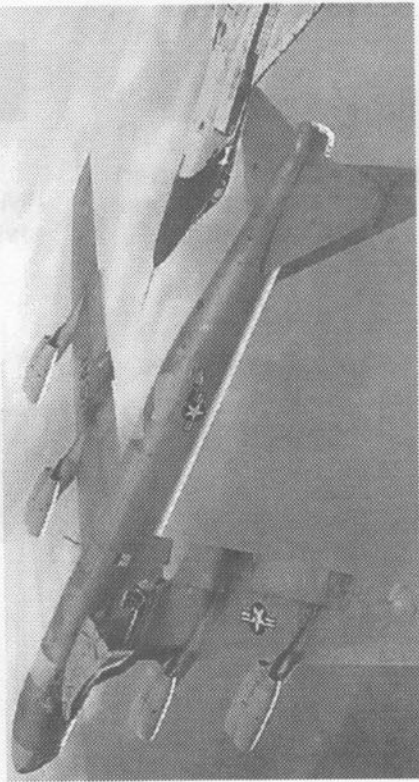

- 1 Port Fuselage x 1
- 2 Pitot tube x 1
- 3 Starboard fuselage x 1
- 4 Control lever x 1
- 5 Pilot seat x 1
- 6 Canopy x 1
- 7 Starboard splitter plate x 1
- 8 Starboard jet intake x 1
- 9 Starboard main landing gear x 1
- 10 Starboard main gear door x 1
- 11 Starboard main wing x 1
- 12 Fin x 1
- 13 Engine nozzles x 1
- 14 Reinforce wheel x 1
- 15 Arresting hook x 1
- 16 Port main wing x 1
- 17 Main wheel x2
- 18 Port main landing gear x 1
- 19 Port main gear door x 1
- 20 Port jet intake x 1
- 21 Port splitter plate x 1
- 22 Nose gear door x 1
- 23 Nose landing gear x 1

ANIGRAND
CRAFTS WORK

PO Box 40, Texaco Road, NT,
Hong Kong
E-mail : email@anigrand.com
Web : <http://www.anigrand.com>

Painting & Decals



White
(Overall)
(Landing Gears)
(Gears bays)

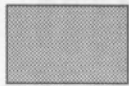

Aluminium silver
(Wing leading edges)



Flat black
(Tires)



Burn Iron
(Engine nozzles)



Mid grey
(Cockpit interior)
(Anti-glare panel)
(Fin strip)



Red
(Fin)
(Wing roots)
(Jet intakes)

