

# 涂装同标贴指示 Painting & Marking guide

**B**

H | 12 | 33   H | 309 | 309   H | 79 | 39   H | 3 | 1   H | 4 | 3

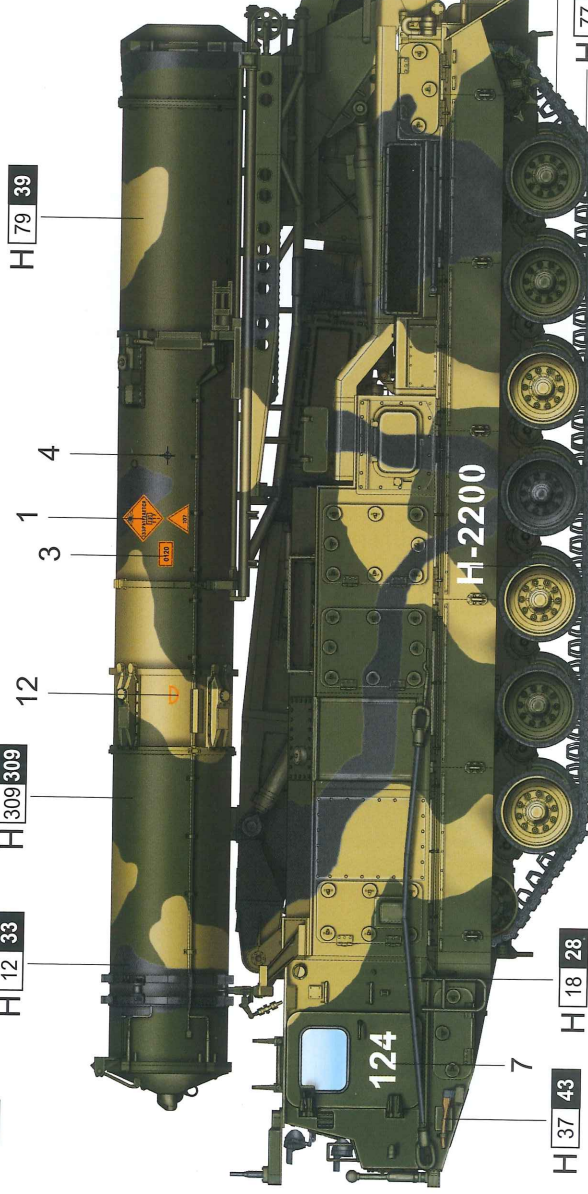

H | 37 | 43   H | 18 | 28

H | 77 | 137

H | 309 | 309   H | 12 | 33



H | 12 | 33

H | 309 | 309   H | 79 | 39

H | 12 | 33

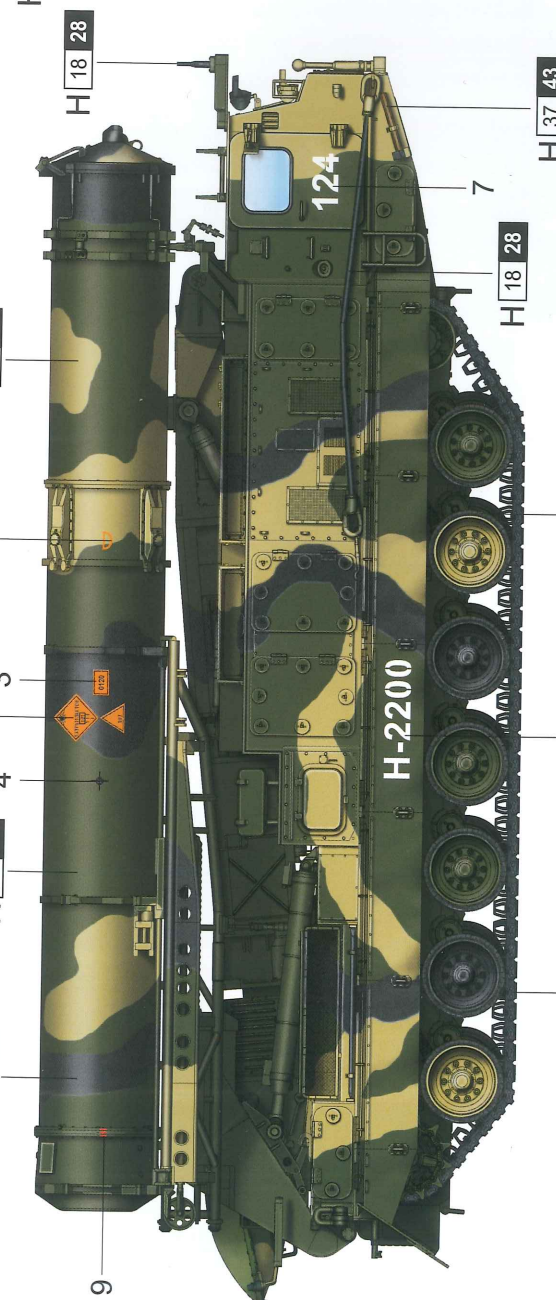

H | 18 | 28

H | 77 | 137

H | 18 | 28

H | 37 | 43

H | 309 | 309

H | 309 | 309

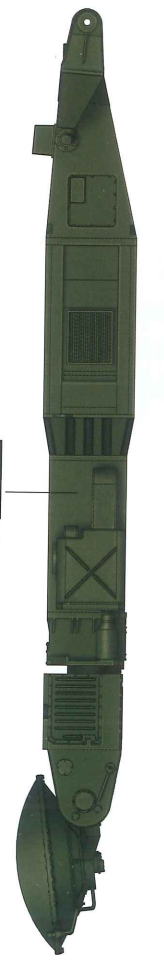

H | 315 | 315

H | 4 | 4

H | 3 | 3

H | 304 | 304

H | 304 | 304

H | 3 | 3

H | 4 | 4

H | 315 | 315



14

6

13

19

19

6

6



19   19

Color	Mr.Hobby	Acrycion	Vallejo	Model Master	Tamiya	Humbrol	Color
Steel 黑铁色	H   18   28	N   18	864	1402	-	-	Light Gull 灰色
Tire Black 胎黑色	H   77   137	N   77	-	-	-	-	Khaki Green 卡其绿色
Flat Black 消光黑	H   12   33	N   12	950	1749	XF1	33	Olive Drab 橄欖色
Wood Brown 木棕色	H   37   43	N   37	983	1701	-	186	Red 红色
Forest Green 绿色	H   309   309	N   309	893	1710	XF58	116	Yellow 黄色
							Sandy Yellow / Dark Yellow 砂黄色

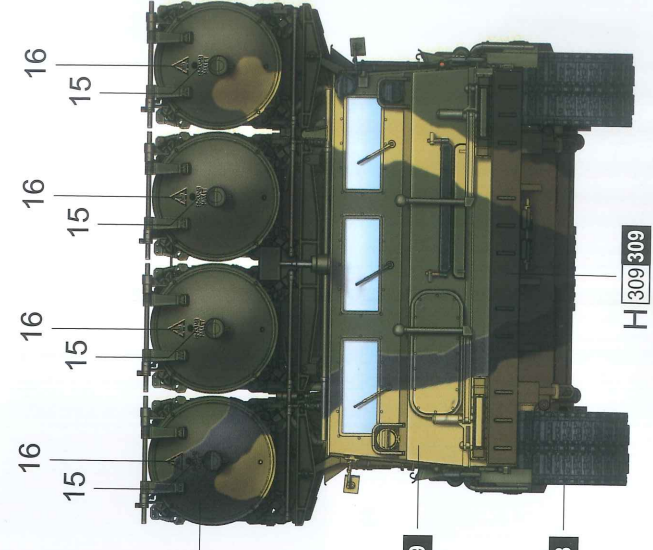

H | 309 | 309

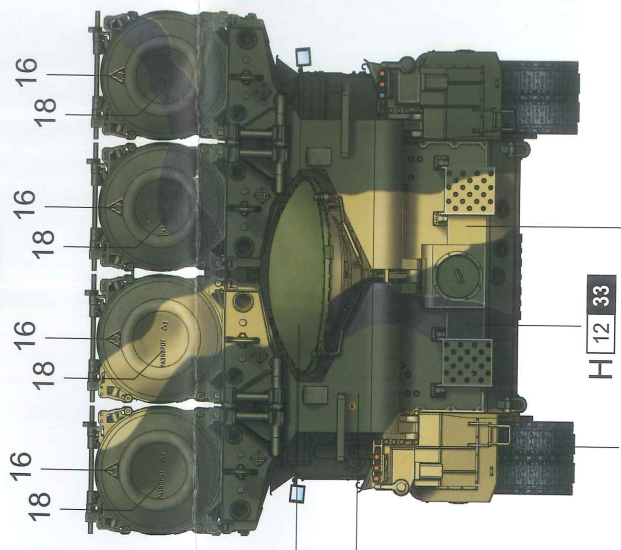

H | 12 | 33

H | 18 | 28

H | 79 | 39



# 涂装同标贴指示 Painting & Marking guide

**A**

## PAINT REFERENCE COLOR

Color	Mr.Hobby	Acrycion	Vallejo	Model Master	Tamiya	Humbrol	Color	Mr.Hobby	Acrycion	Vallejo	Model Master	Tamiya	Humbrol
Steel 黑铁色	H 18 28	N 18	864	1402	—	—	Light Gull 灰色	H 315 315	N 315	843	1730	—	129
Tire Black 胎黑色	H 77 137	N 77	—	—	—	—	Khaki Green 卡其绿色	H 80 54	N 80	924	—	XF51	195
Flat Black 消光黑	H 12 33	N 12	950	1749	XF1	33	Olive Drab 橄榄色	H 304 304	N 304	887	1711	XF62	155
Wood Brown 木棕色	H 37 43	N 37	983	1701	—	186	Red 红色	H 3 3	N 3	908	1503	X7	19
Forest Green 绿色	H 309 309	N 309	893	1710	XF58	116	Yellow 黄色	H 4 4	N 4	953	1514	X8	69
							Sandy Yellow (Dark Yellow) 砂黄色	H 79 39	N 79	824	—	XF59	93

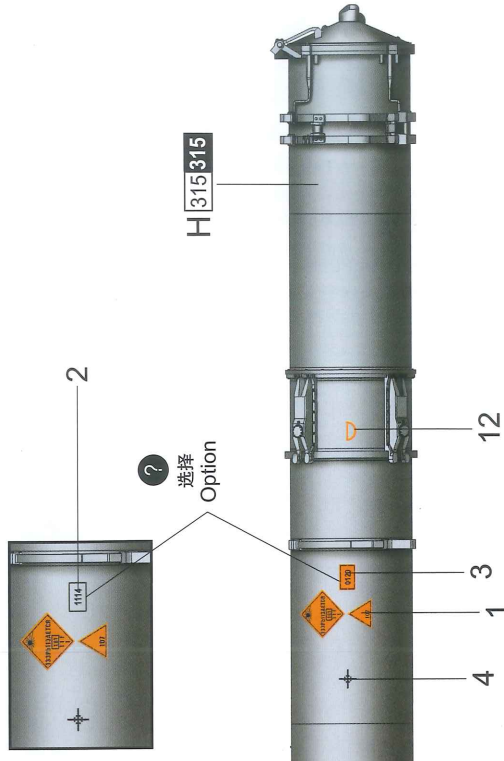
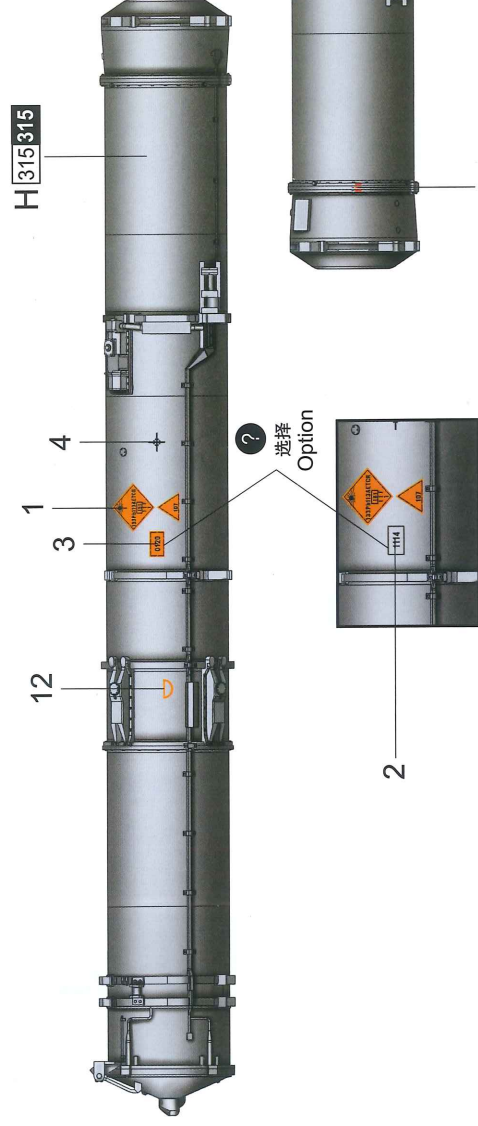

24

闭合状态  
Close

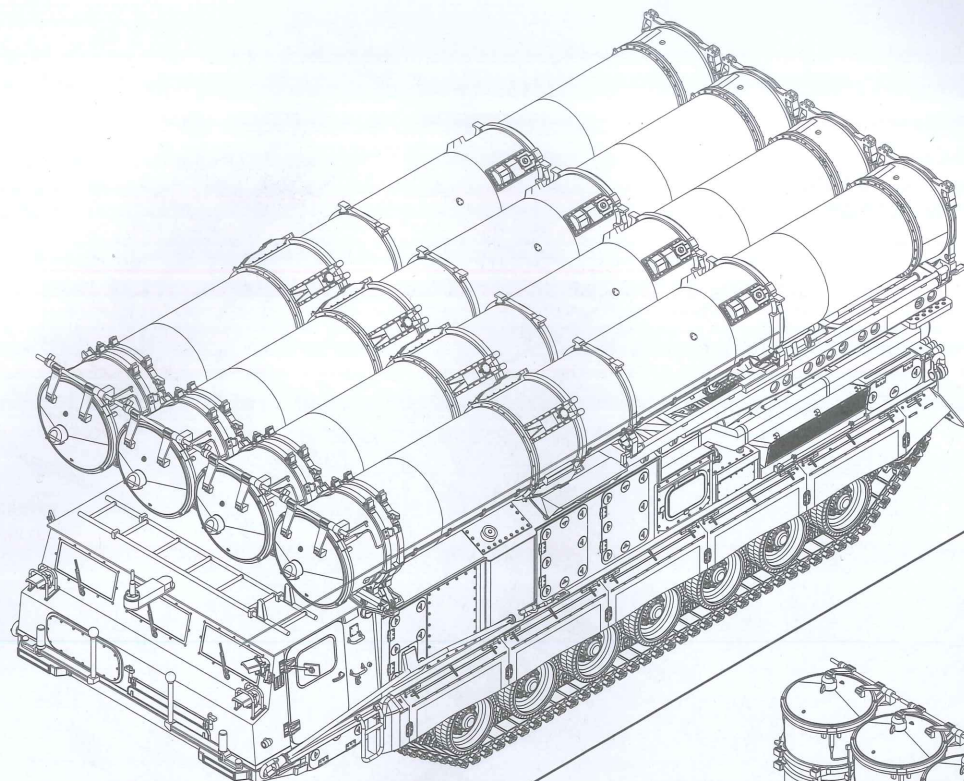

展开状态  
Open

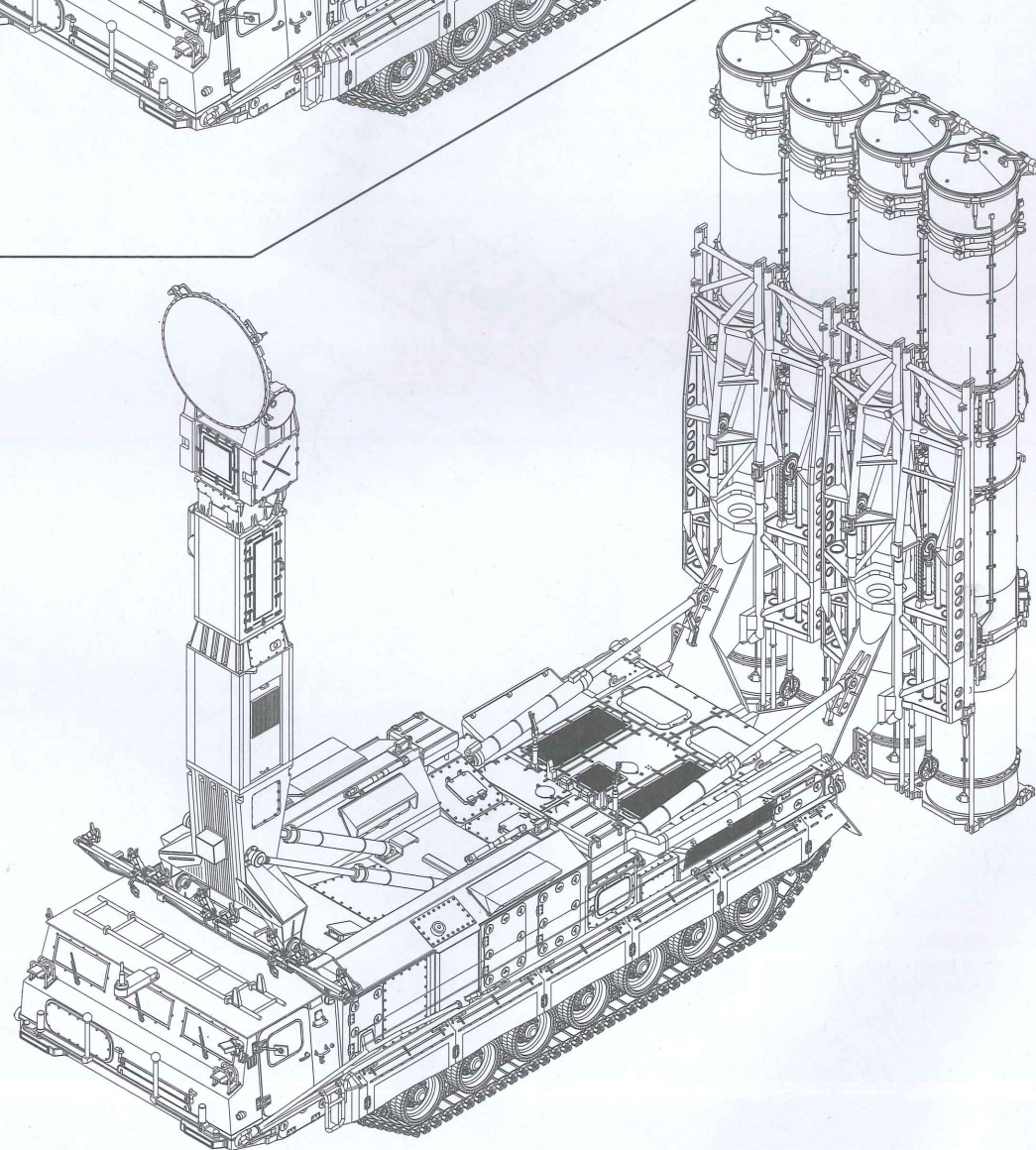

09519

20

1/35 SCALE

ITEM NO.:09519

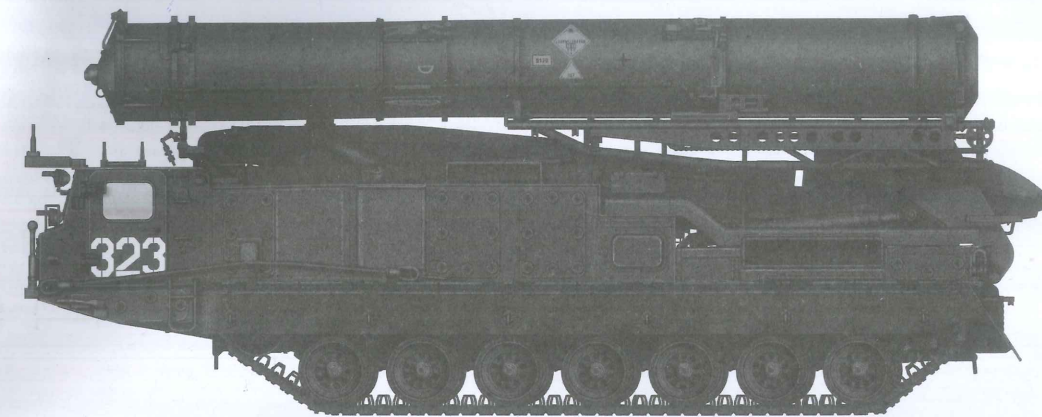

## Russian S-300V 9A83 SAM

### 俄罗斯S-300V 9A83导弹发射车

#### READ BEFORE ASSEMBLY:

- Study and understand these instructions thoroughly before beginning assembly
- When needed, remove photo-etch parts carefully using a modeling knife or photo etch sprue cutter, being careful not to damage or lose small parts.
- Take extra care in handling photo etch parts in order to avoid injury
- Apply instant cement sparingly to photo etch parts where instructed
- Tools recommended(not included in kit):Plastic and instant cements, sprue cutters,long nose pliers,modeling knife, small files, tweezers, pin vise & scissors. Soft cloth and sandpaper will also assist in construction
- Glue and paint are not included in the kit. Use plastic cement and hobby paints only. Color guide for purchasing paint is included in the kit.

#### 装配之前仔细阅读

- 小心用模型锉刀锉平所有零件表面的注射浇口。
- 小心用刀片切下蚀刻片零件，不要遗失小零件。
- 用强力快干胶水粘合蚀刻片零件和金属轴。过量快干胶水使用可能导致可动零件会粘住，小心涂胶。
- 取蚀刻片时应特别注意安全，防止利边划伤手指。
- 某些零件表面需贴水上贴纸，请选择在装配的同时进行。
- 推荐模型工具(自备)：胶水，水口剪刀，长咀钳，刀片，锉刀，镊子，钳，钻，剪刀，瞬间快干胶。
- 软布同砂纸同时也应该是必备工具。
- 请使用塑料胶水和油漆，模型内不含。



配重  
Weight



使用强力胶  
Cyanoacrylate glue



钻孔  
Make hole



切除  
Cut / Remove



贴纸  
Decal



锉平  
File / Sand



选择  
Option



不涂胶水  
No cement



弯曲  
Bend



先装  
Install it first

#### 水贴纸的使用:

- 1.从水贴上剪下印花;
- 2.将印花放入温水中浸10秒，然后放在干净布上。
- 3.拿着印花纸板将印花移到模型上;
- 4.手指蘸水将印花移到适当的位置;
- 5.用软布轻压印花直至水干，气泡消失

#### DECAL APPLICATION

- 1.Cut decals from sheet as needed
- 2.Dip the decal in warm water for about 10 seconds and then place on soft clean cloth.
- 3.Hold the decal backing sheet edge and gently slide the decal onto the model in its proper position.

- 4.While still wet,decal can be adjusted for better fit on model by dampening it gently with your finger.
- 5.When placed in the proper position,gently press decal down with a soft cloth until excess water and air bubbles are gone.
- 6.Allow decal to dry completely before handling model

09519

1

部品图  
Parts

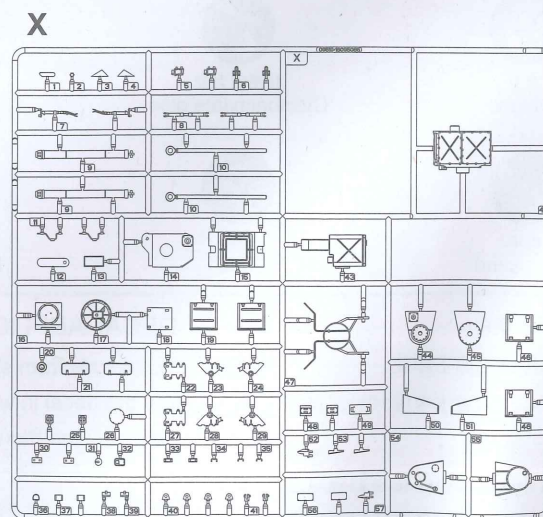
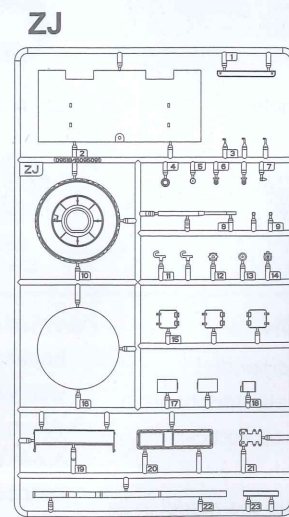
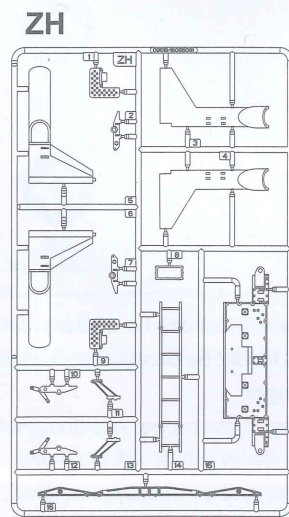
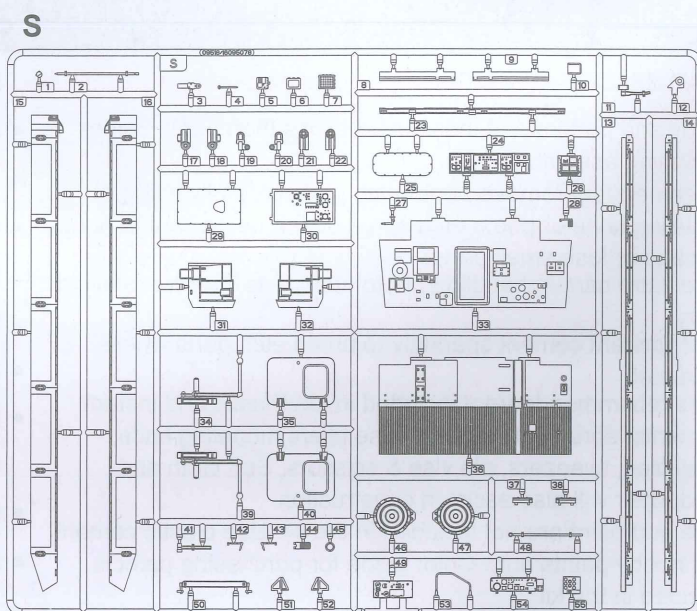
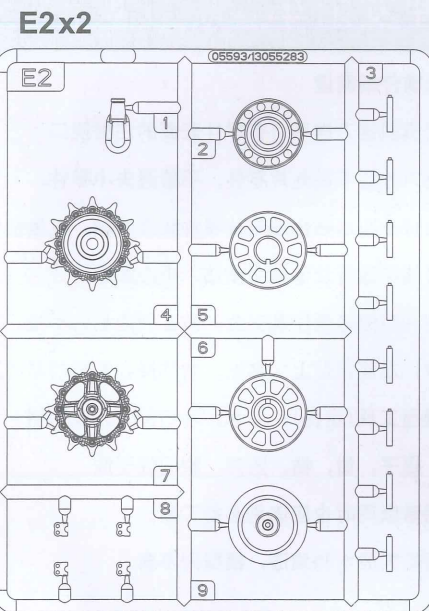
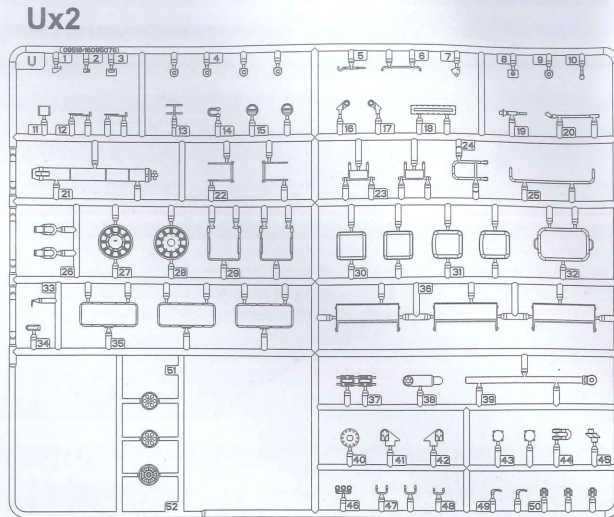
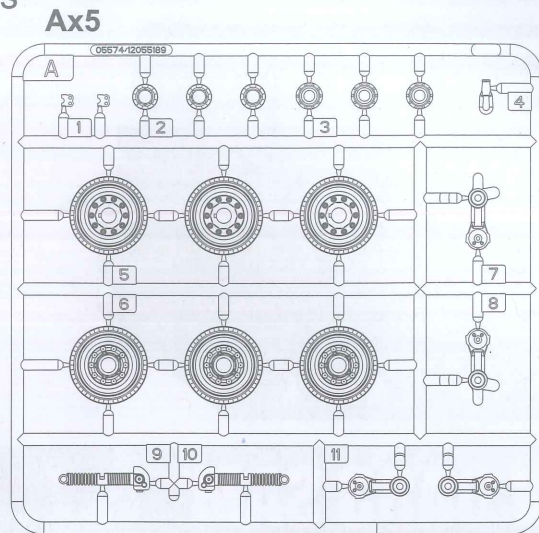

部品图  
Parts

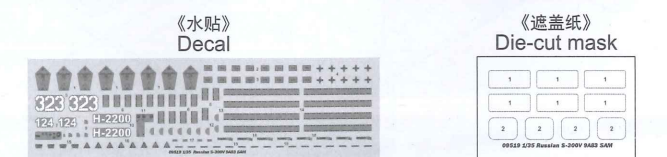
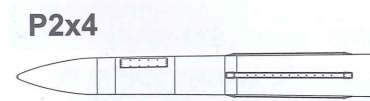
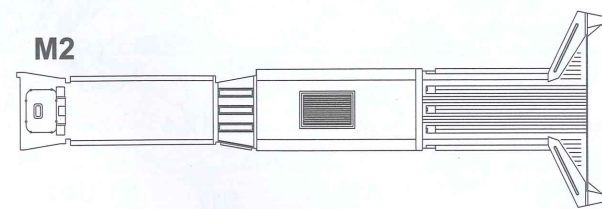
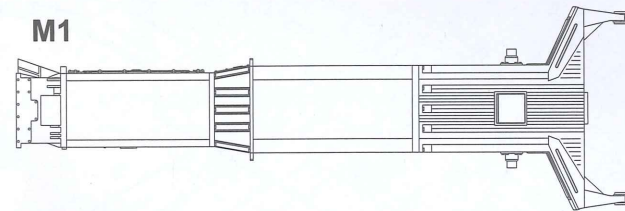
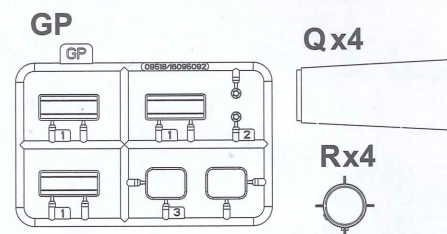
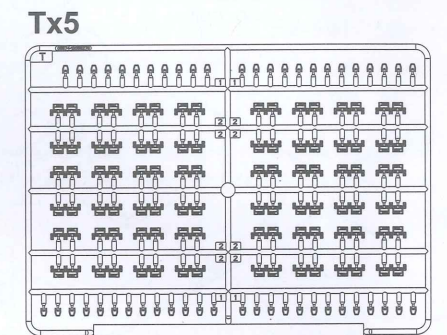
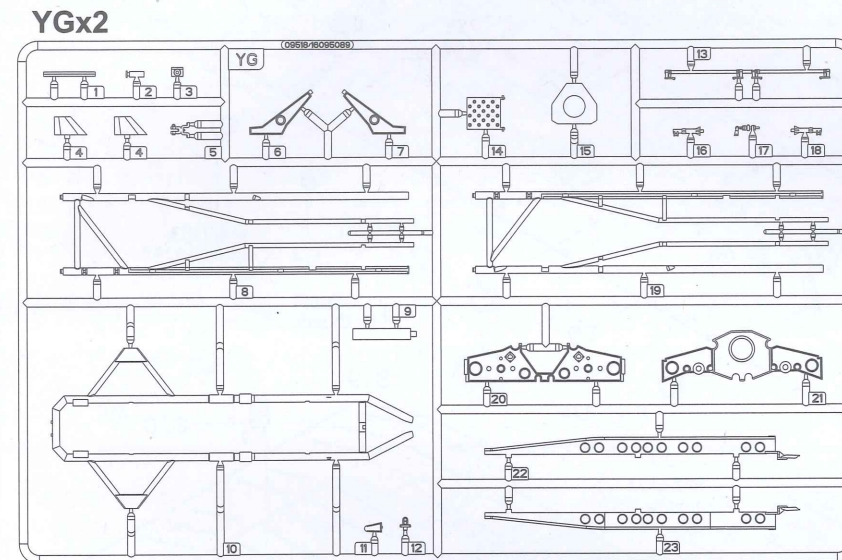
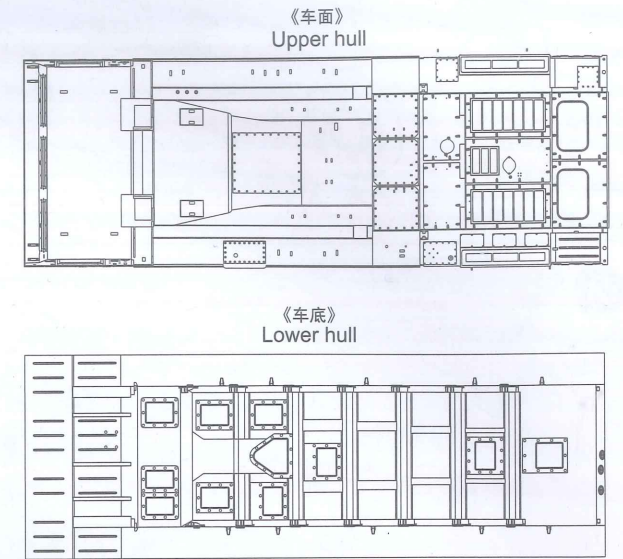
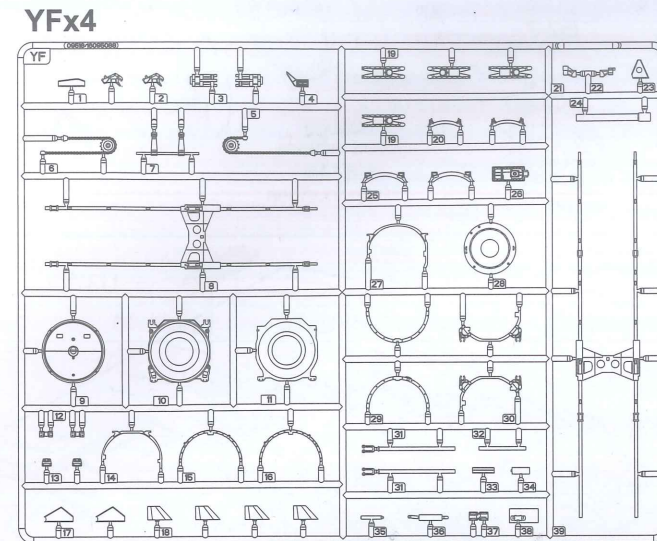

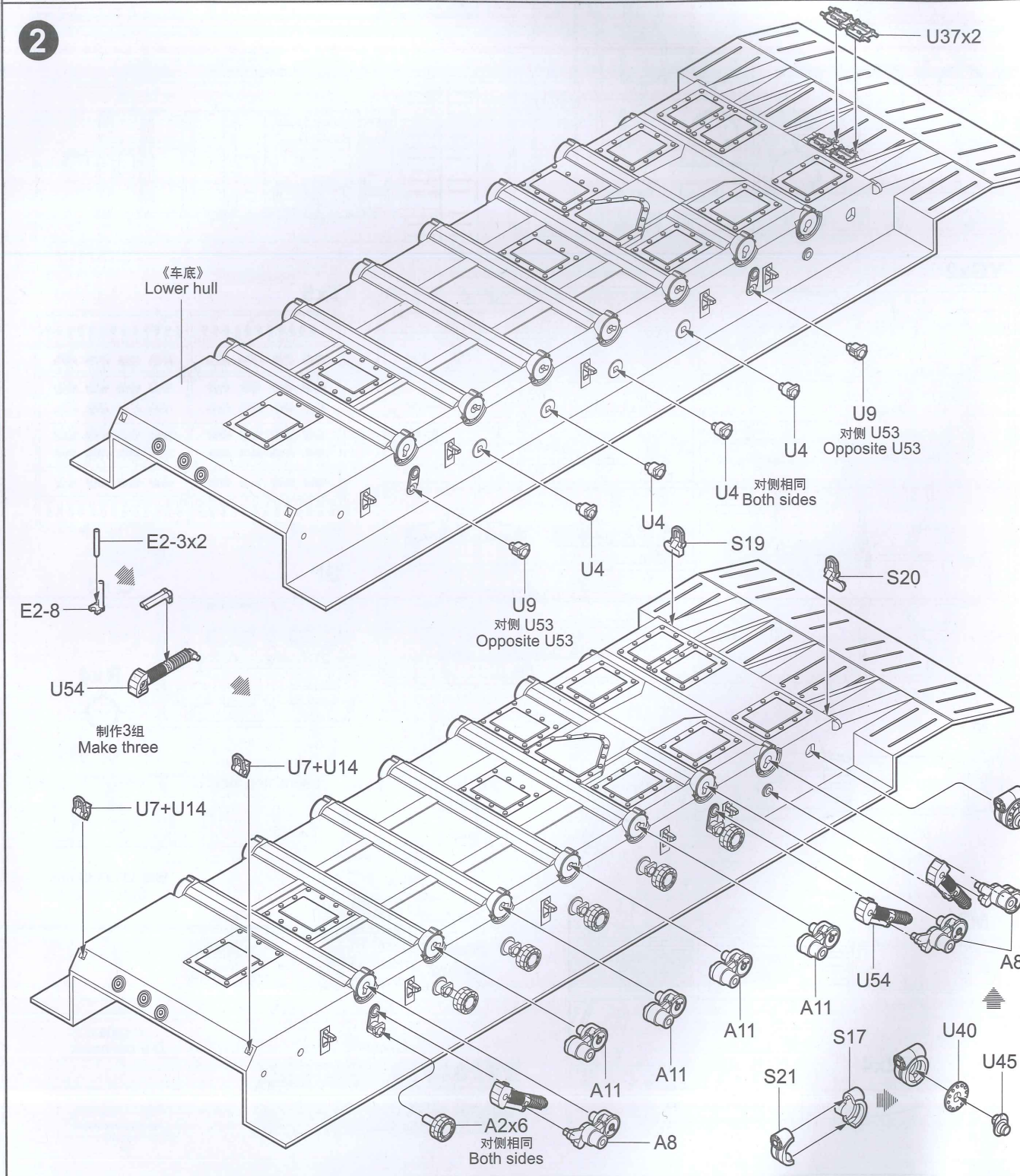
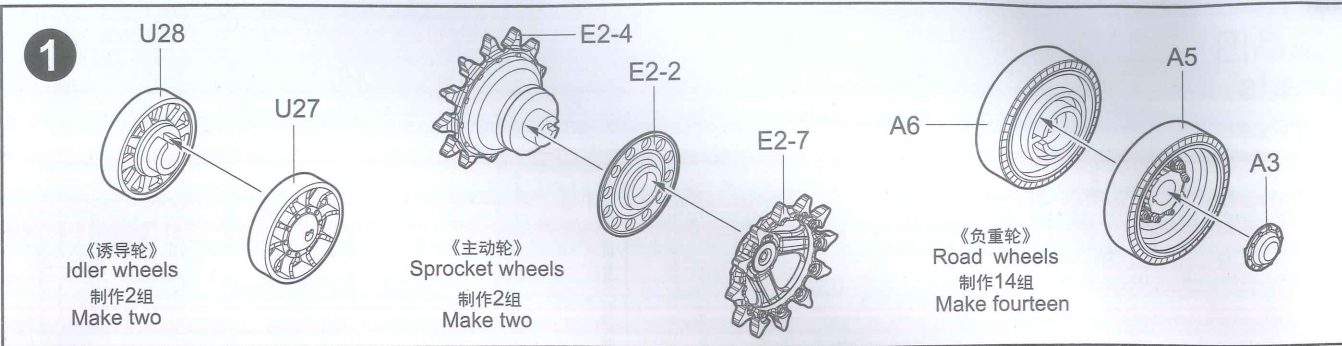

09519

4

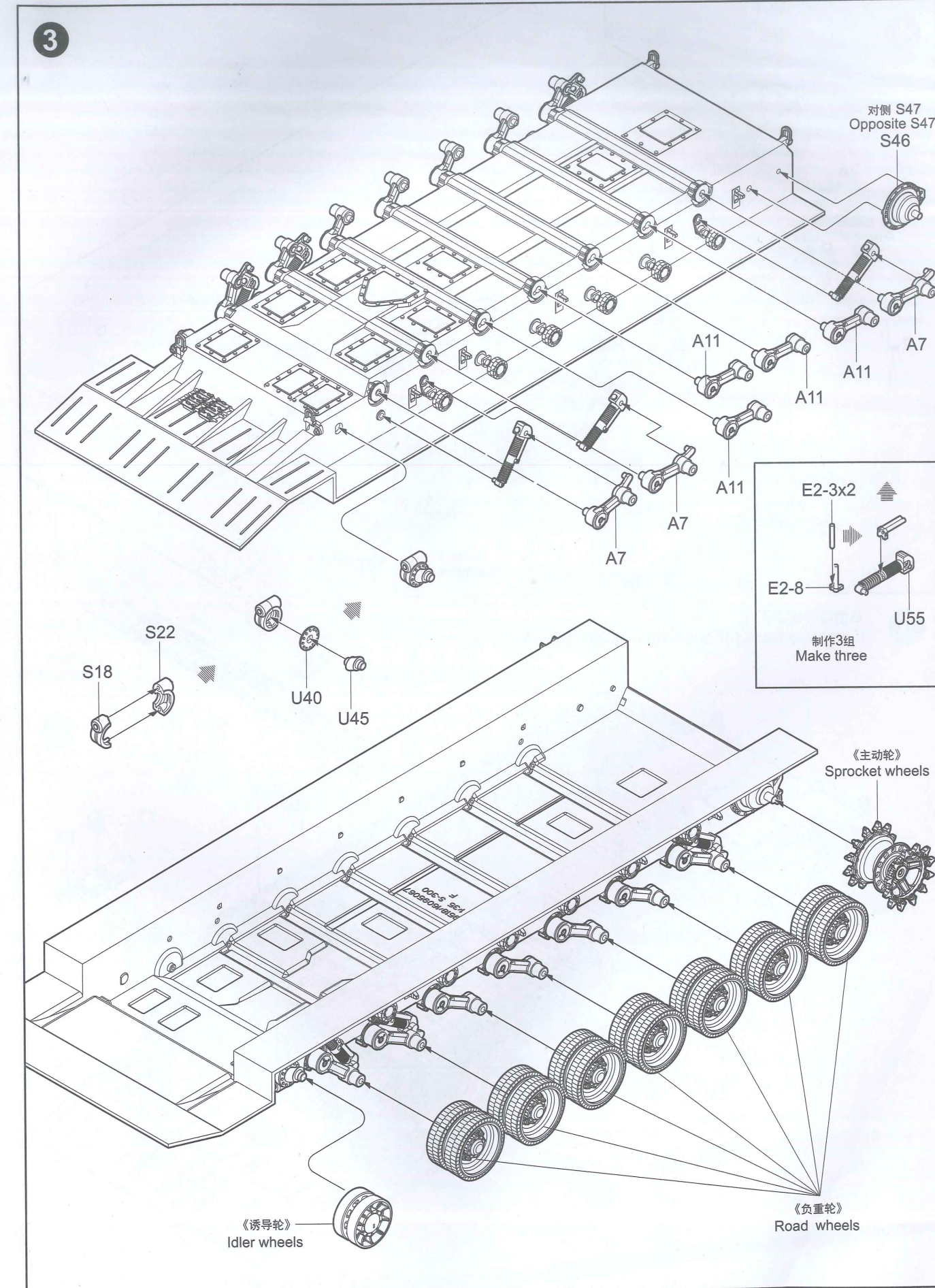

09519

5

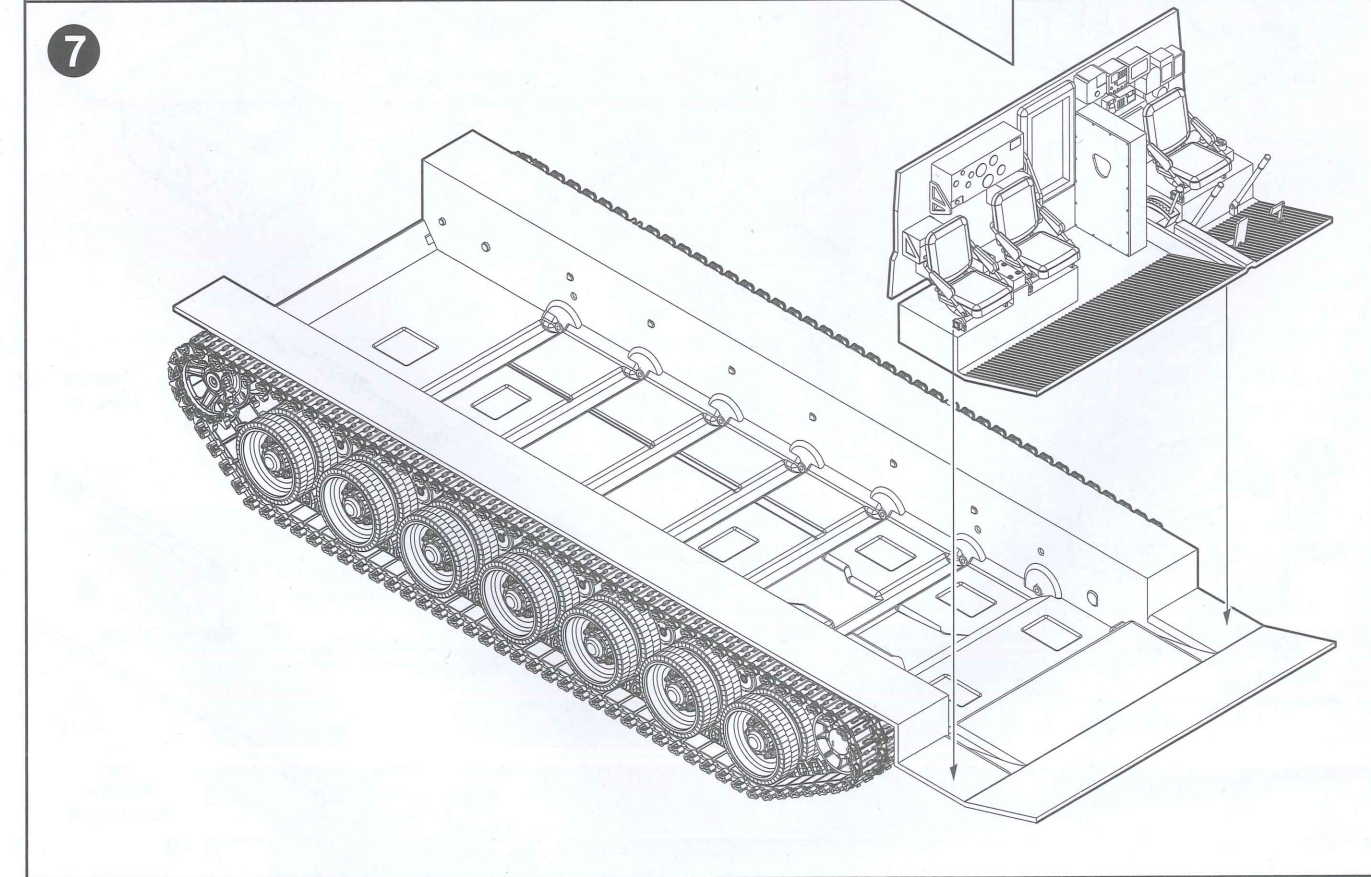
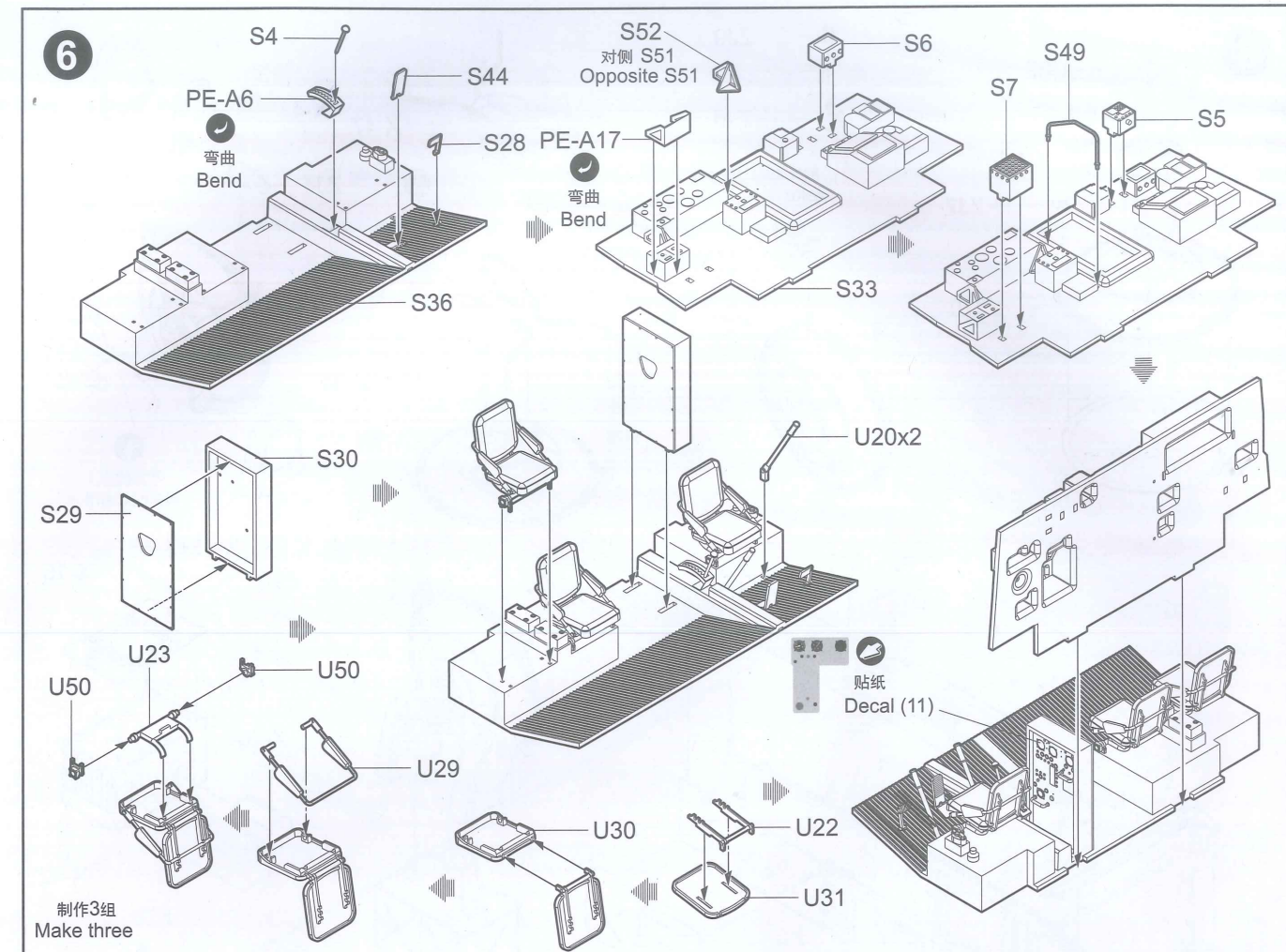
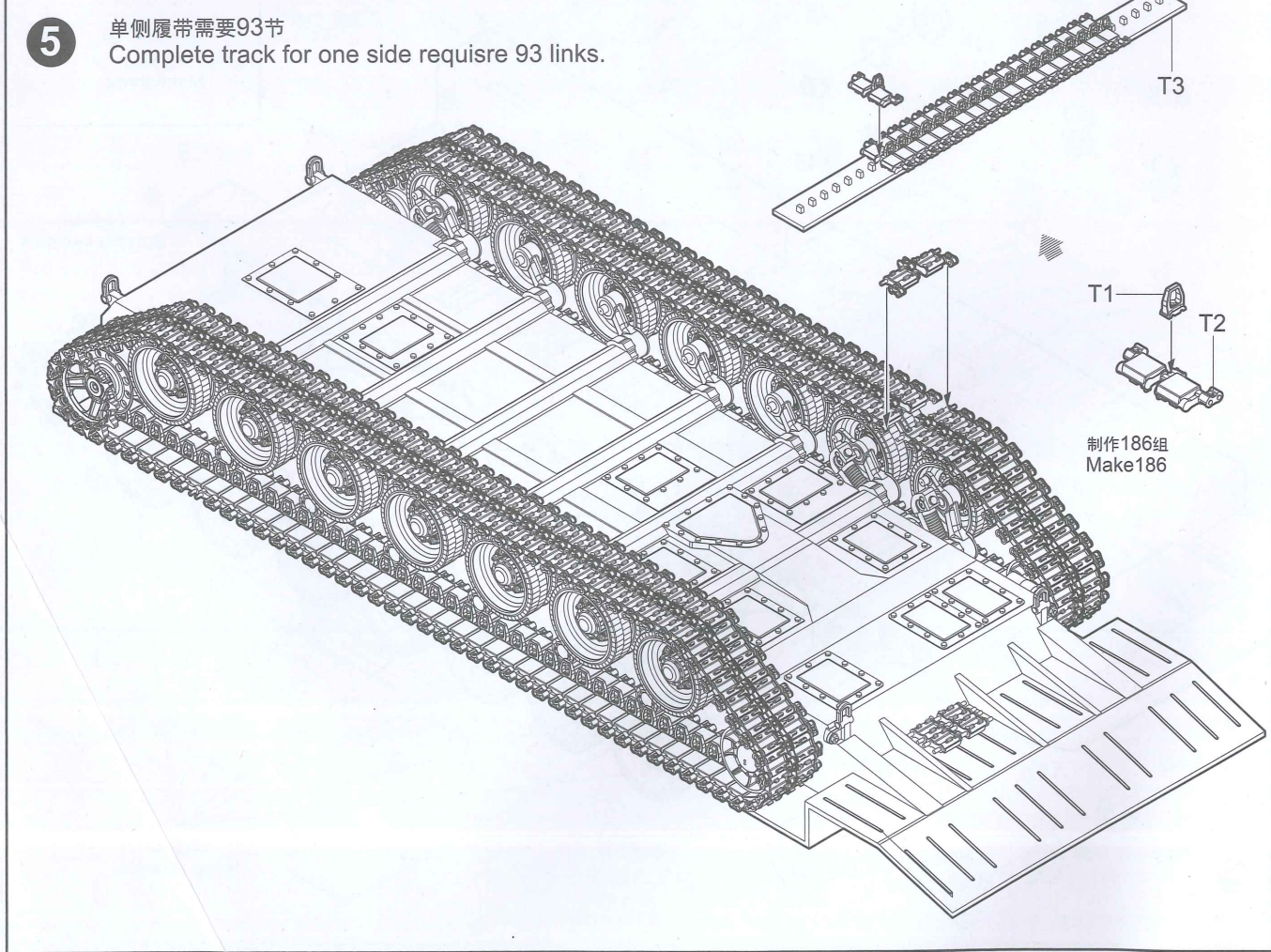
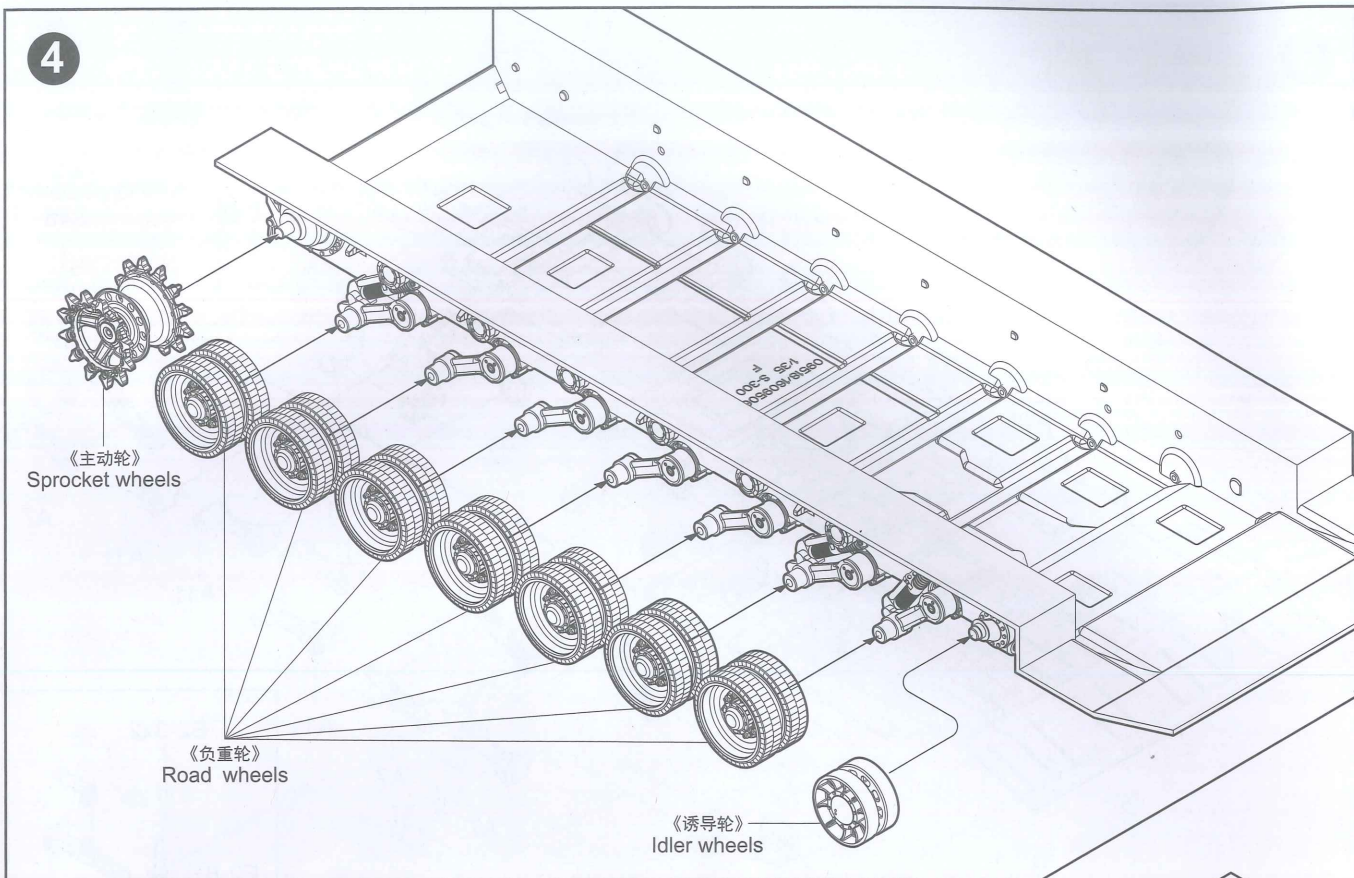

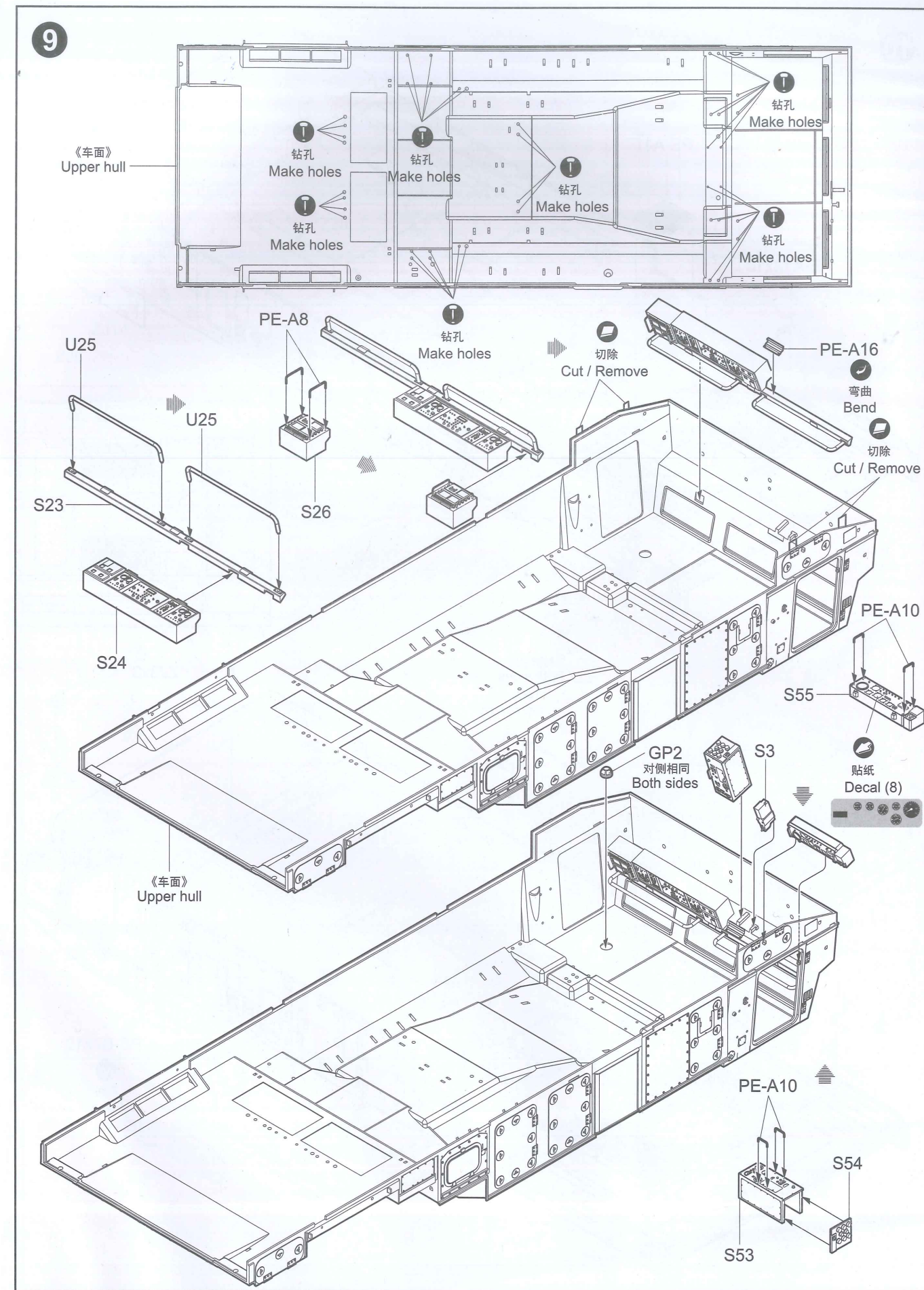
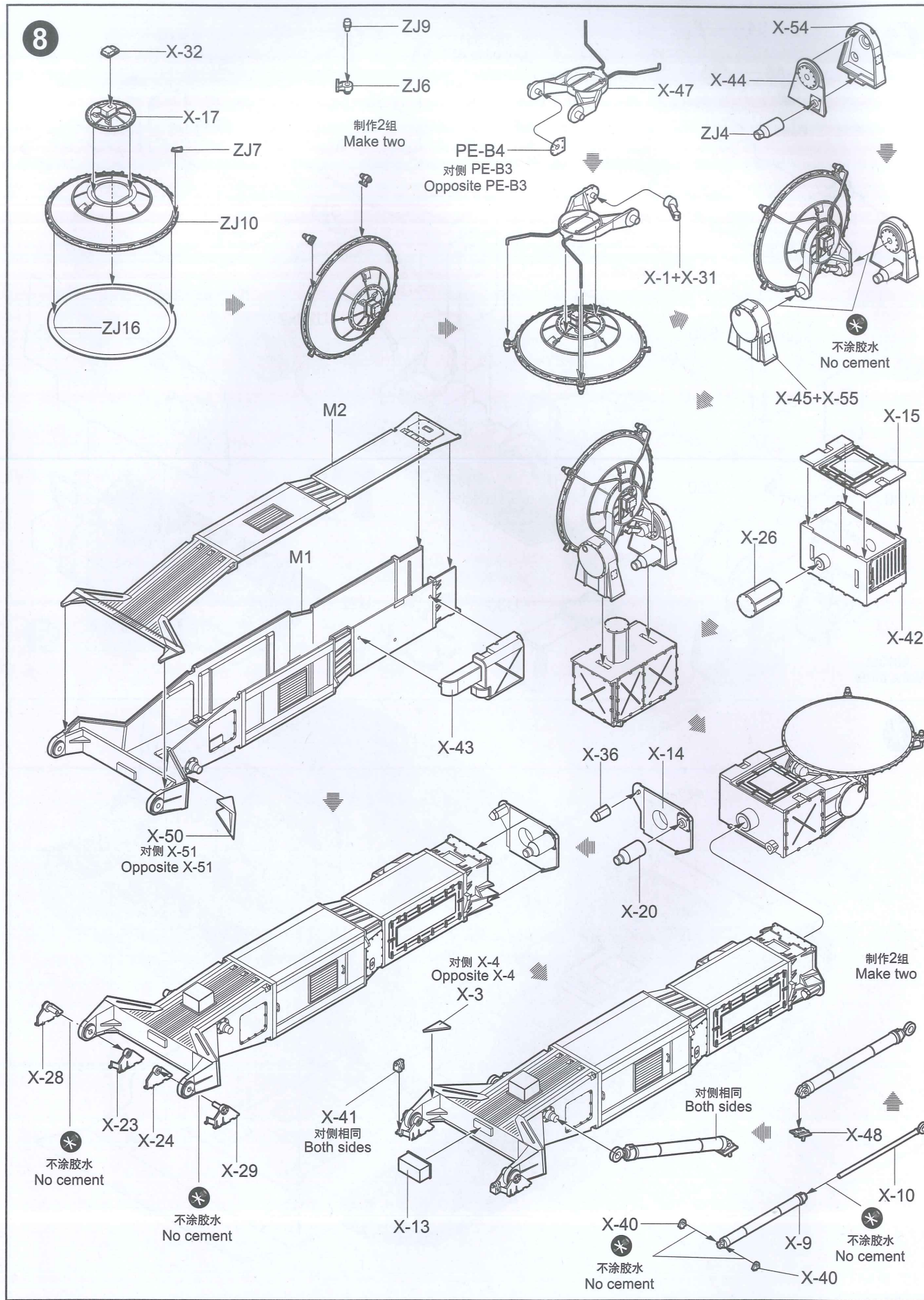

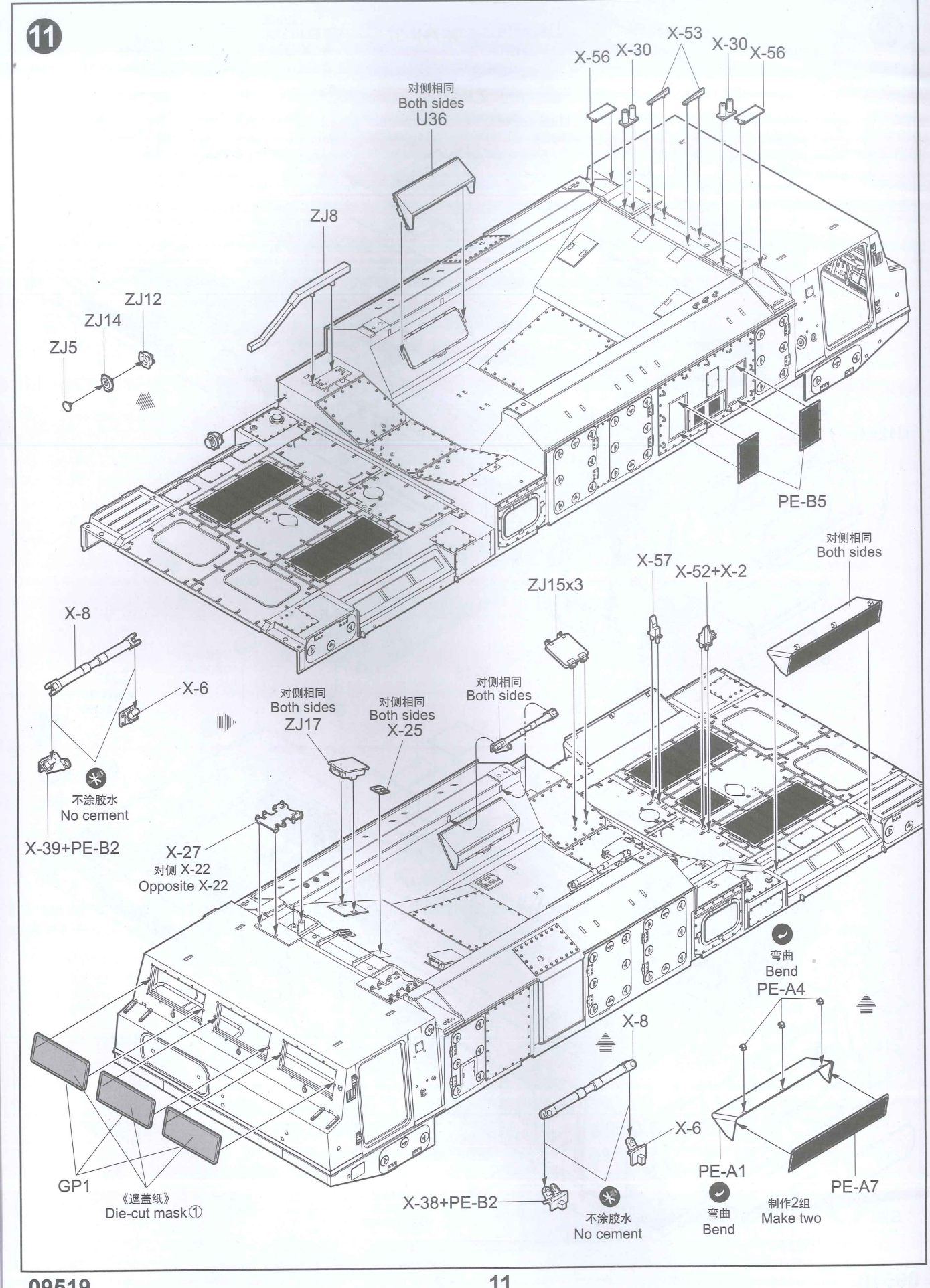
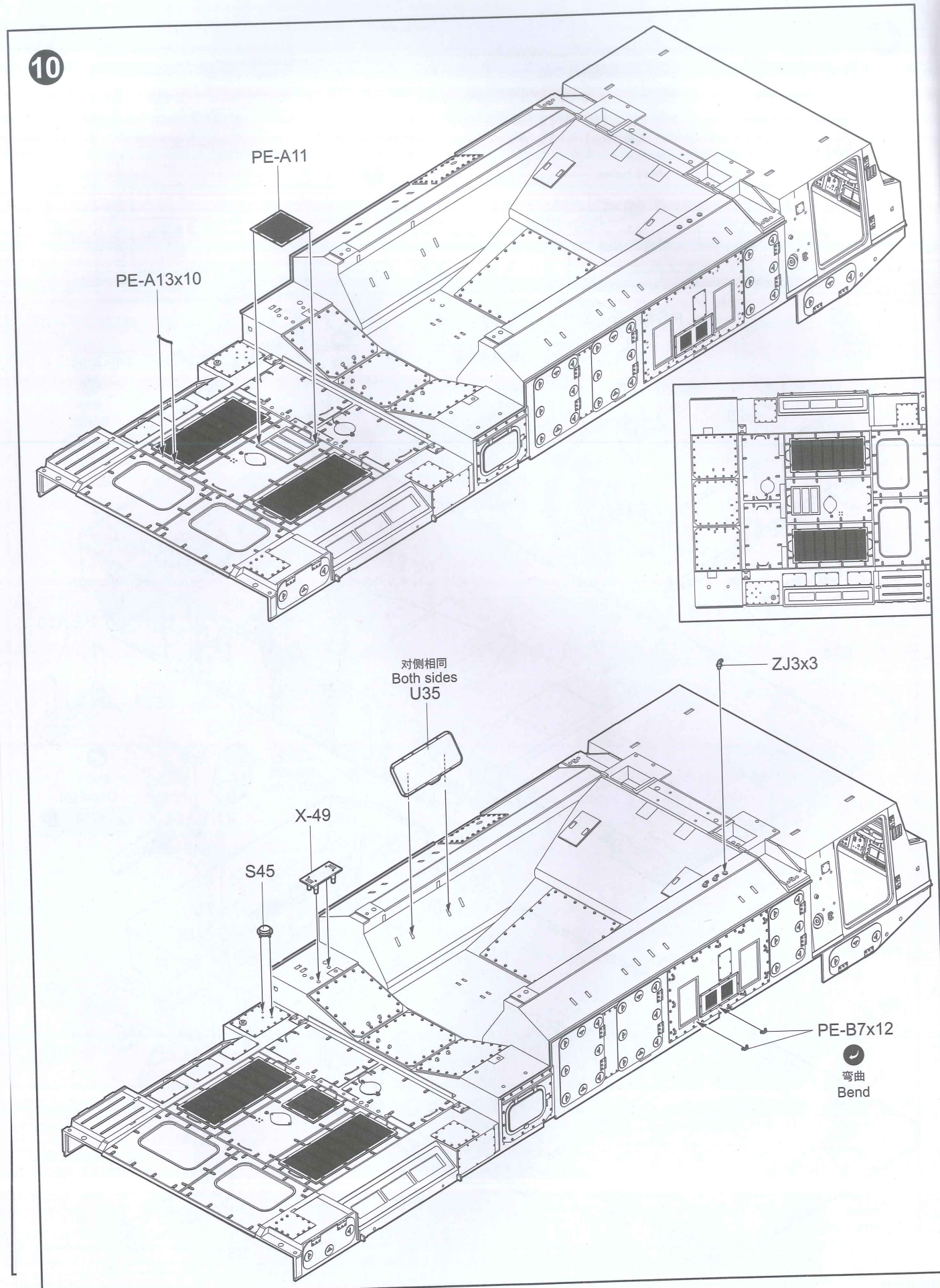



12

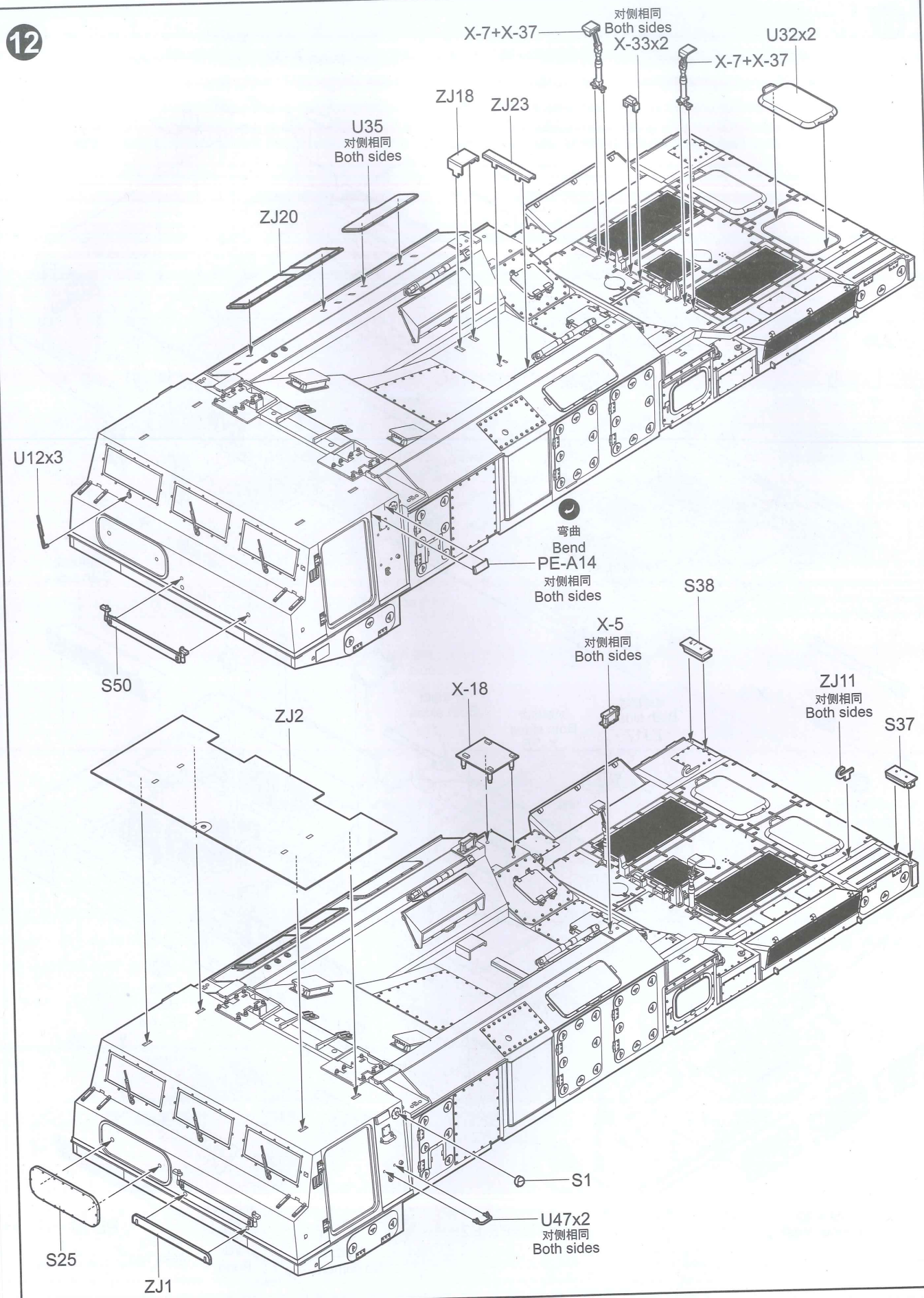

09519

12

13

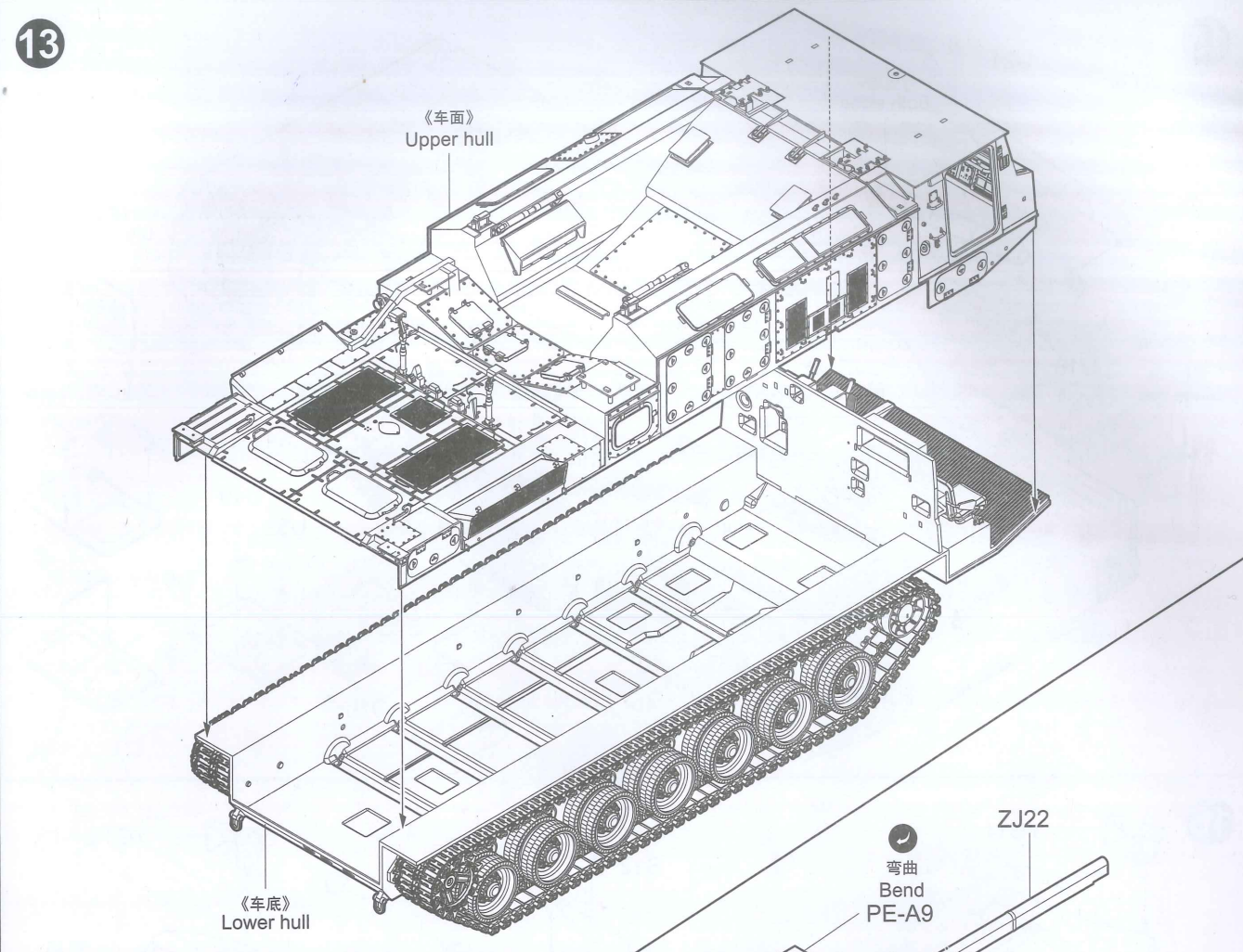

14

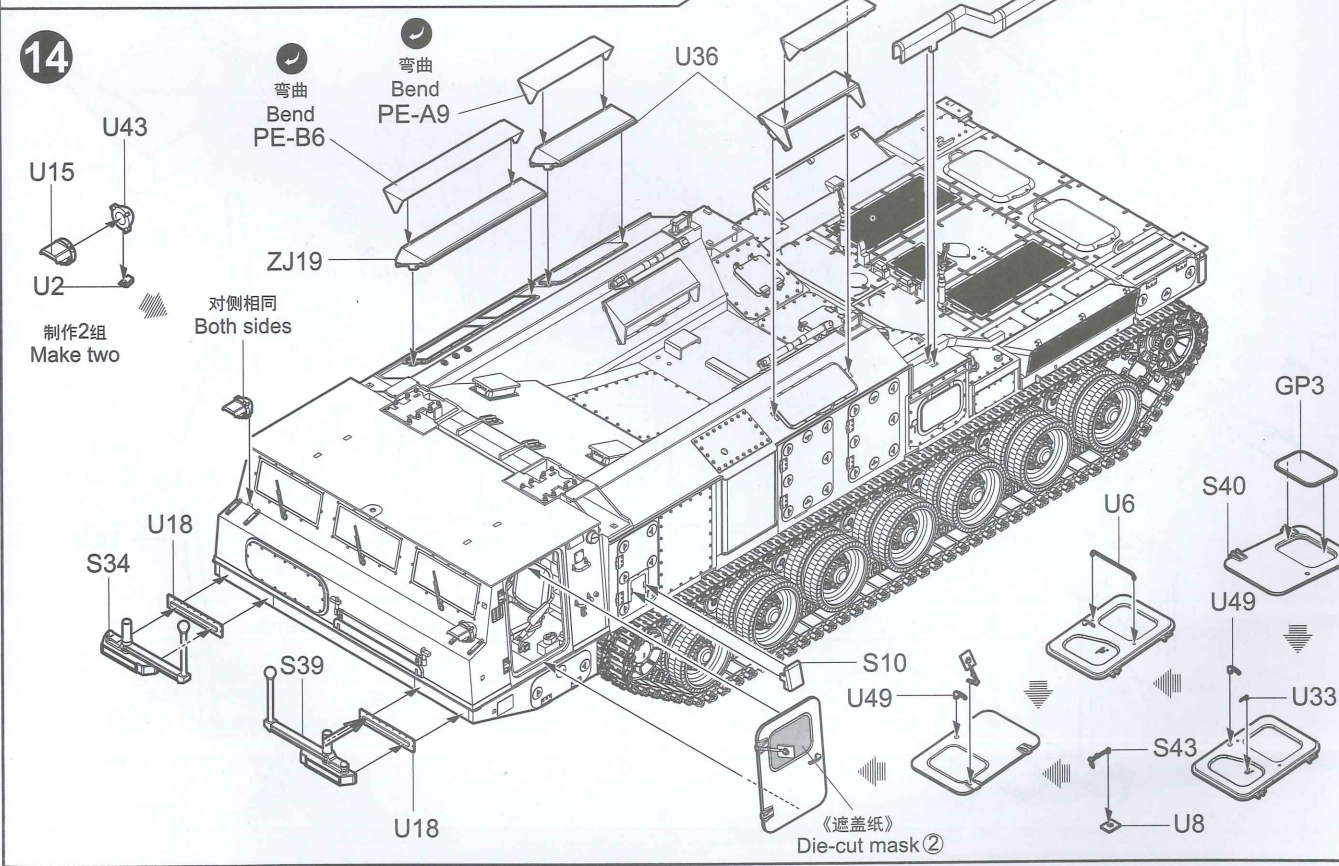

09519

13

15

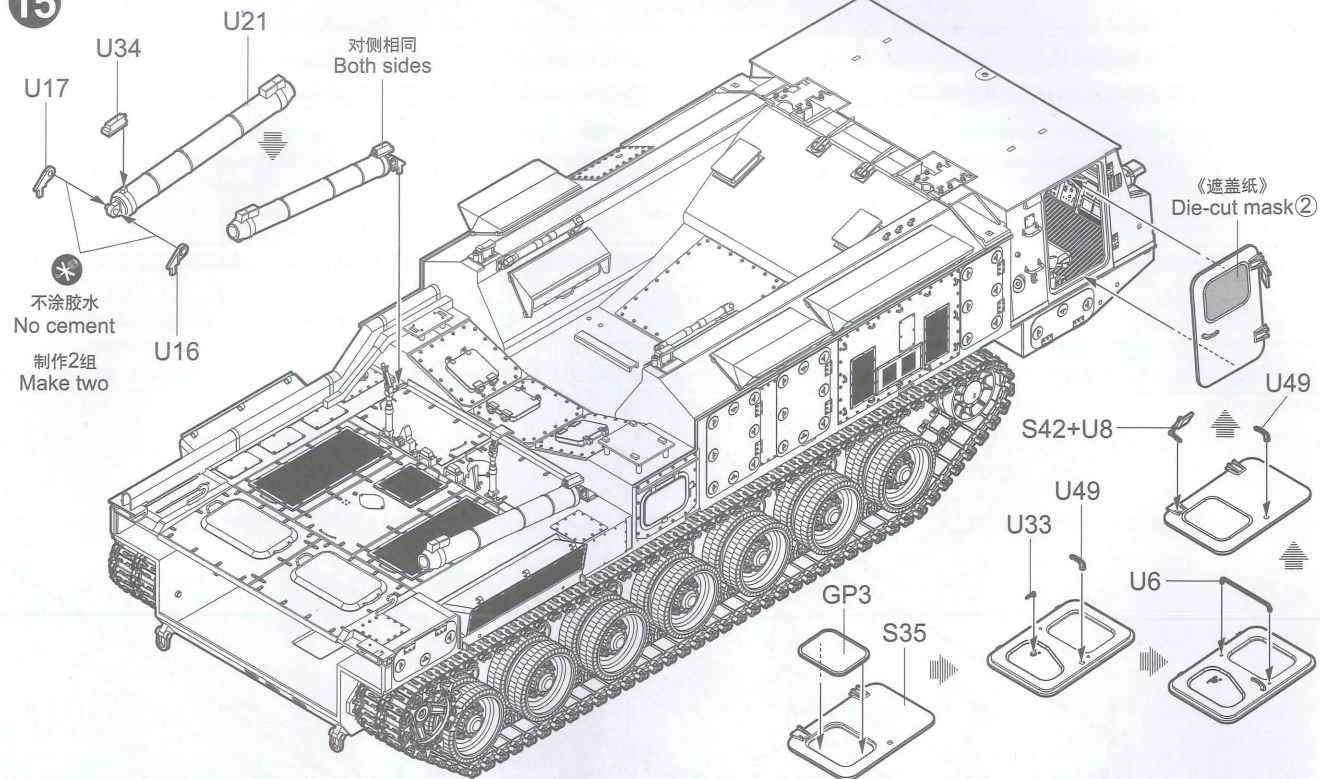

16

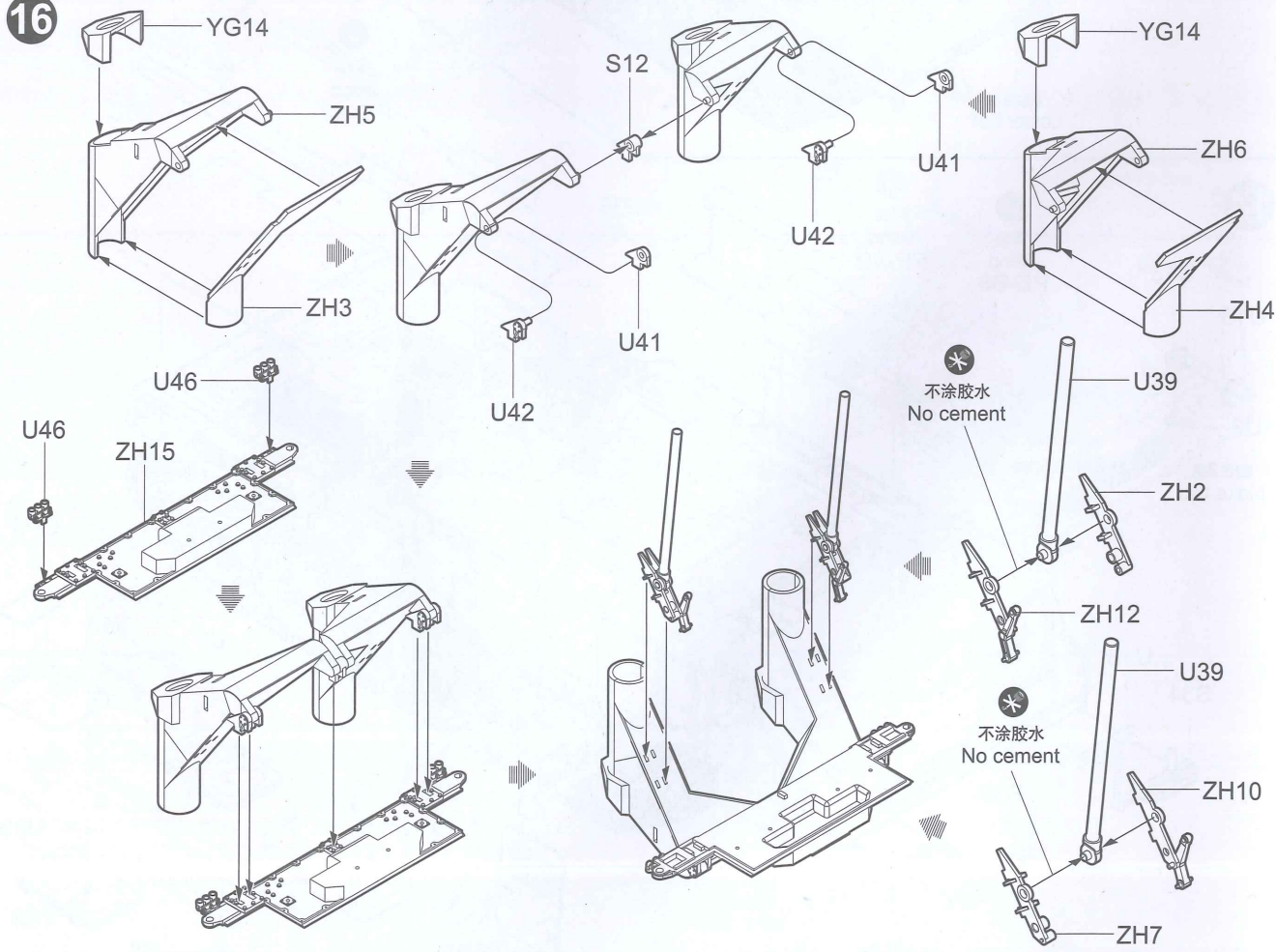

09519

14

17

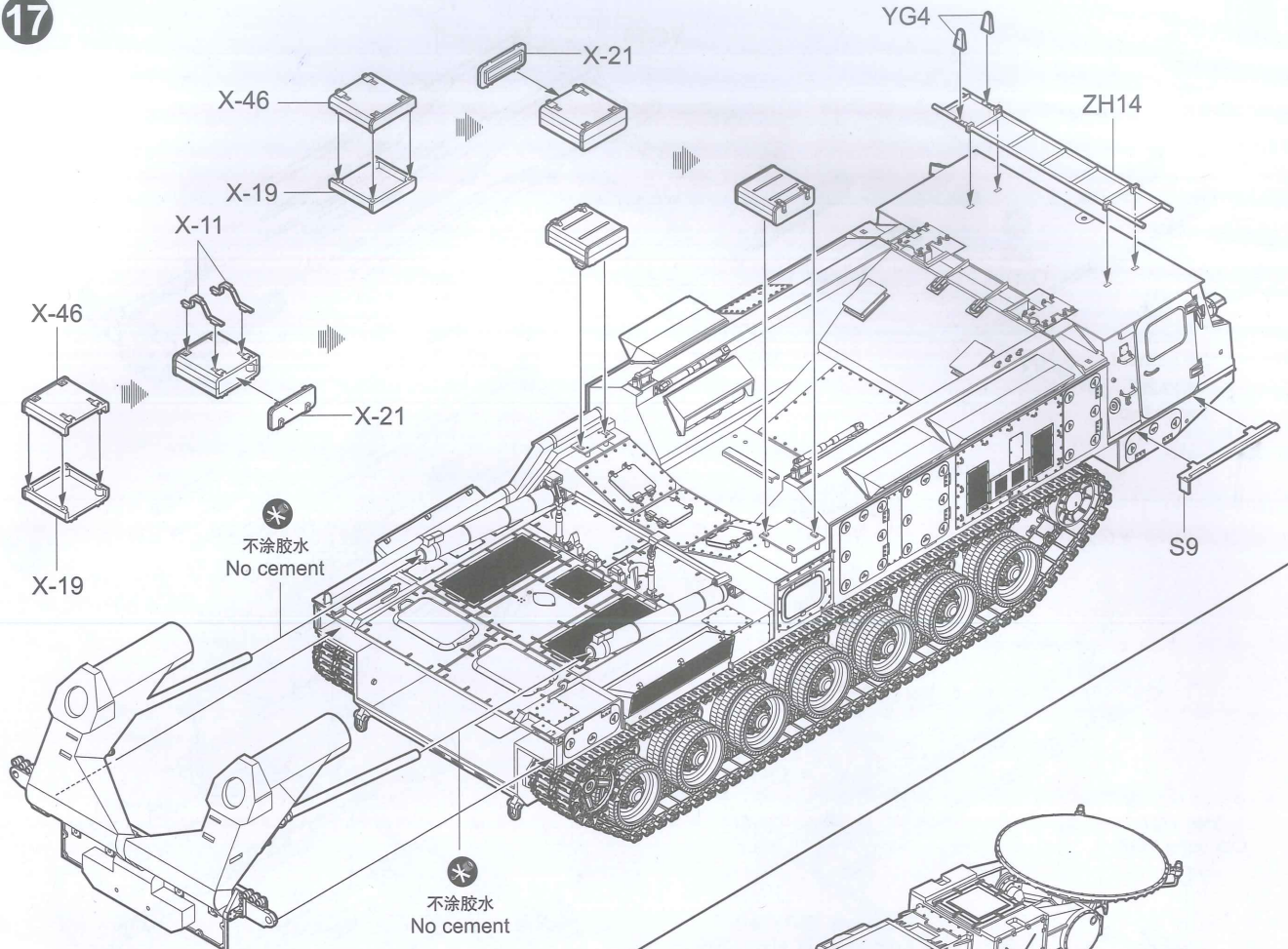

18

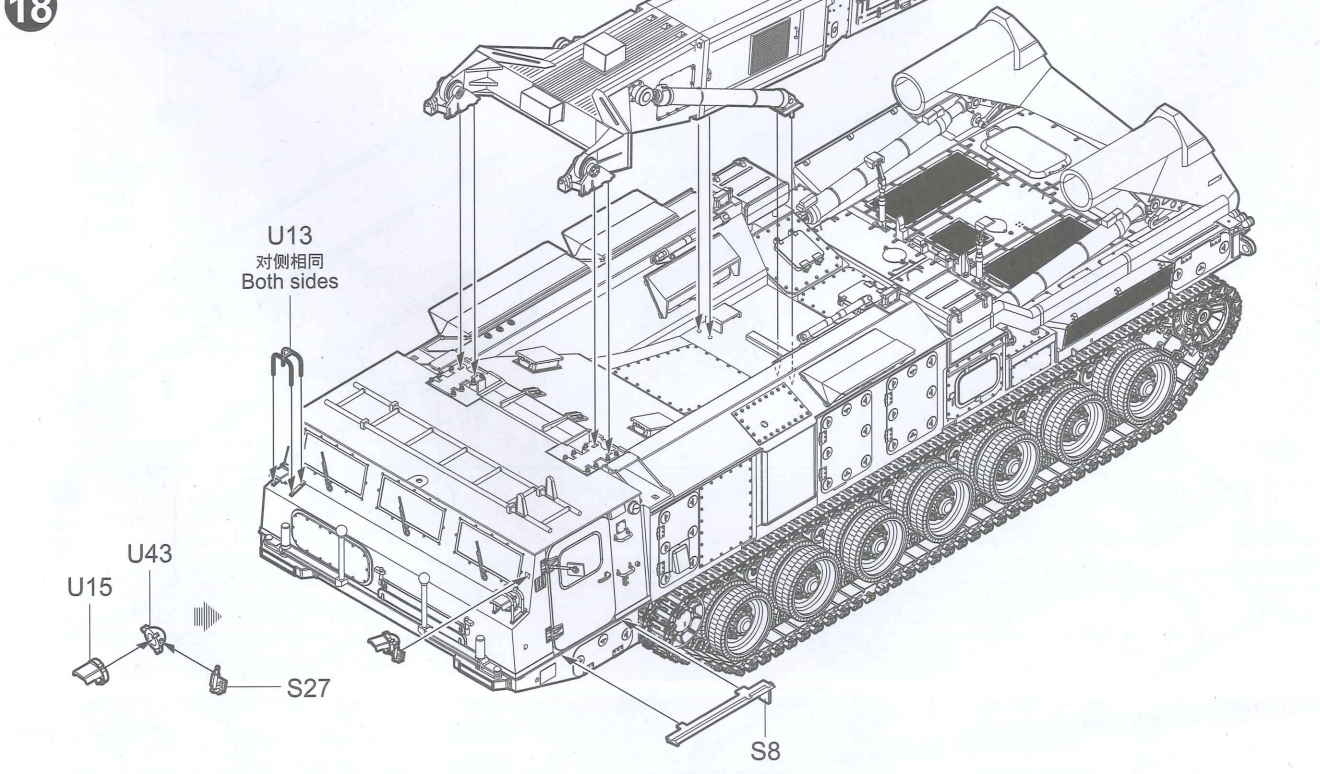

09519

15

