

Curtiss XP-60C / E

1/72 scale resin model kit

#AA-2064

In 1940, Curtiss proposed a initial design for the eventual replacement for the P-40 to the USAAF. It was inverted the continental engine to the P-40 fuselage and tail assembly. This proposal was accepted and a contract for two prototypes, XP-53 was issued. At the end of 1940, USAAF modified order to install the XP-53 with British Merlin engine. The prototype was redesignated XP-60. Due to the delivery delay of the Merlin engine, the Allison engine was considered and the airplane was redesignated XP-60. In 1942, the order was changed again to produce one XP-60B with Wright engine and one XP-60C with Chrysler engine. For performance improvement, Curtiss changed to install the Pratt & Whitney radial engine with contra-rotating propeller in the XP-60C. In January 1943, the XP-60C made its first flight and was generally satisfactory. It led to the XP-60B installing with the same Pratt & Whitney engine but changed with the four-bladed propeller. It was redesignated XP-60E. The XP-60E made its first flight in May 1943 but performed poorly. In May 1944, Army discontinued all the works on the project as the P-47 and the P-51 satisfied all the Army's needs at the time.

Specifications:

Wingspan-	41ft.3in.
Length-	34ft.1in.
Height-	12ft.4in.
Engine-	1x Pratt & Whitney R-2800-10 (XP-60E) 1x Pratt & Whitney R-2800-53 (XP-60C)
Crew-	1
Max speed-	405 mph
Armament-	4x 0.5in. machine gun

The XP-60C first flew on January 27, 1943



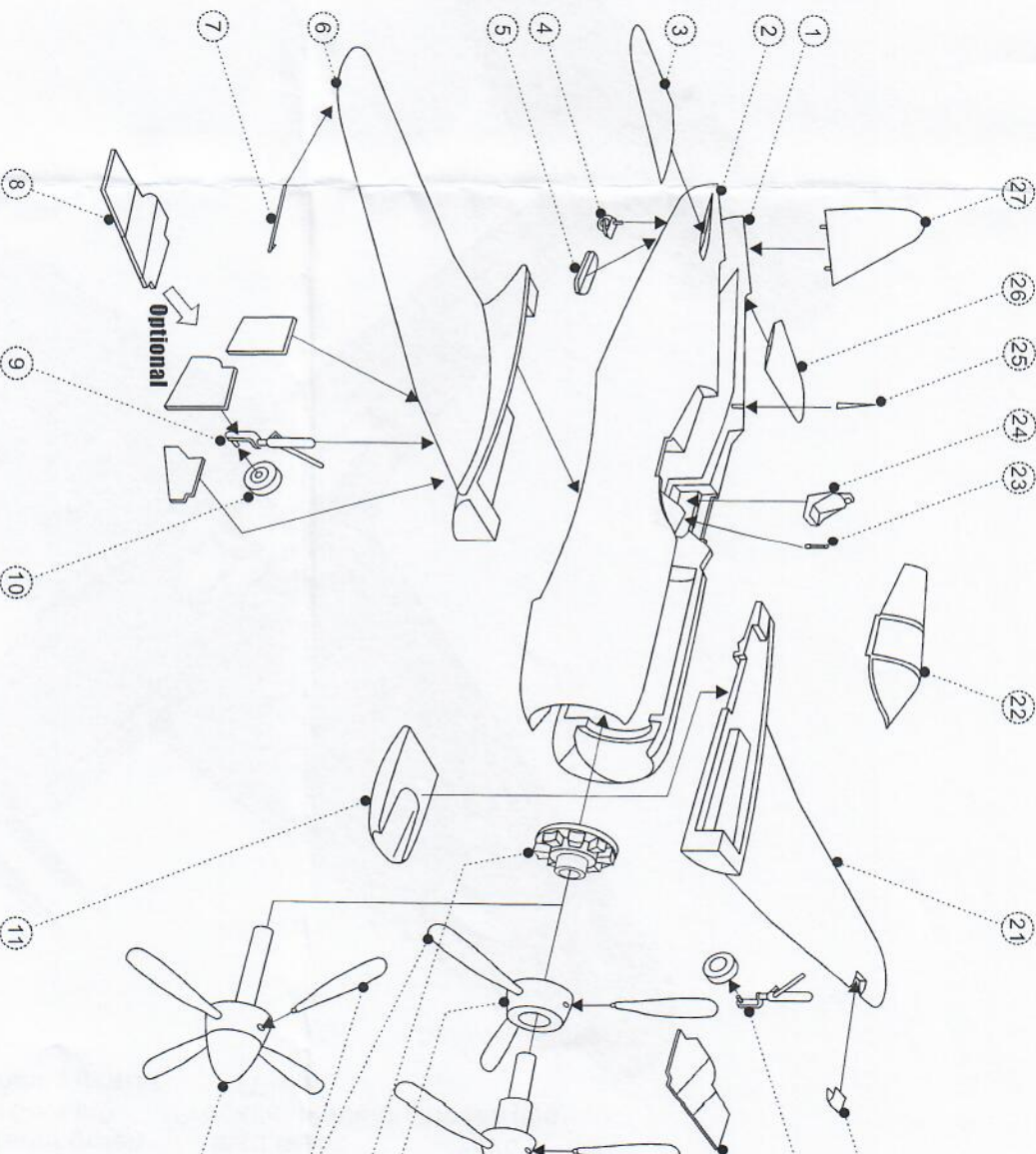

ANIGRAND
CHAPTISWORK

PO Box 40, Texaco Road, NT, Hong Kong.
E-mail : email@anigrand.com
Web: www.anigrand.com

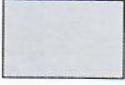
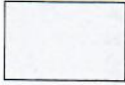
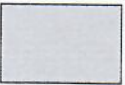

- 1 Port fuselage x 1
- 2 Starboard fuselage x 1
- 3 Starboard tail plane x 1
- 4 Tail landing gear x 1
- 5 Tail gear door x 1
- 6 Starboard main wing x 1
- 7 Aerial x 1
- 8 Starboard main landing gear door x 1
- 9 Starboard main landing gear x 1
- 10 Main wheel x 2
- 11 Engine cooler air intake x 1
- 12 E model propeller spinner x 1
- 13 Shorter propeller blade x 4
- 14 Engine insert x 1
- 15 Aft C model propeller spinner x 1
- 16 Fore C model propeller spinner x 1
- 17 Longer propeller blade x 3
- 18 Port main gear door x 1
- 19 Port main landing gear x 1
- 20 Landing lights cover (transparent part) x 1
- 21 Port main wing x 1
- 22 Canopy x 1
- 23 Control lever x 1
- 24 Pilot seat x 1
- 25 Antenna x 1
- 26 Port tail piece x 1
- 27 Fin x 1

Painting & Decals

-  Olive drab (Plane top)
-  Mid grey (Plane bottom)
-  Interior green (Cockpit) (Landing gears)
-  Matt Black (Propeller blades) (Blades tips) (Tires)
-  Yellow (Blades tips)

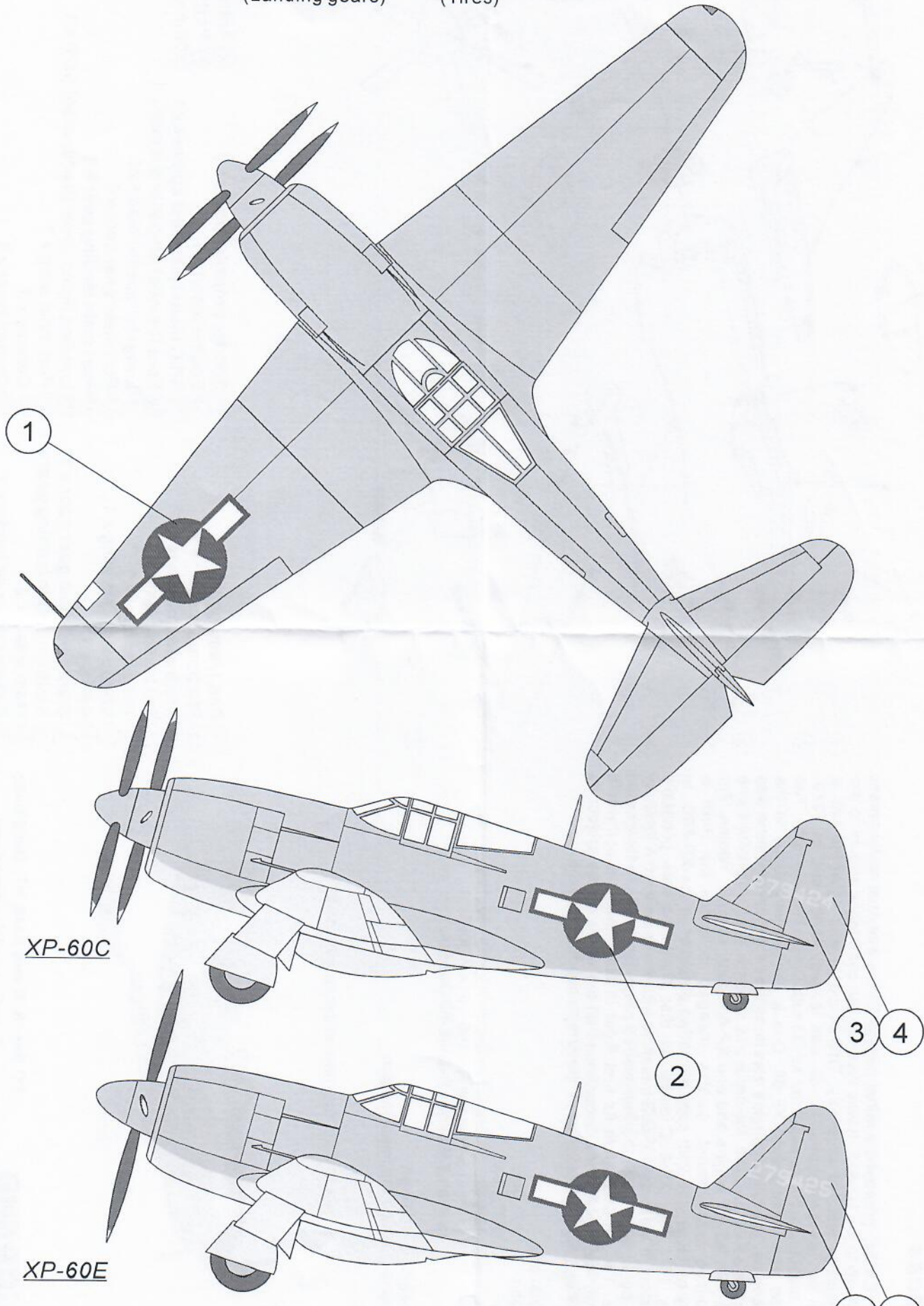

XP-60C

XP-60E