



MARTIN B-57B INTRUDER

W 131-000

© 1988 REVELL INC., WINDY, ILL. U.S.A.

1:72 (1/32)

The Martin B-57B joined the U.S. Air Force in 1955, and by 1964 this British designed bomber was in the forefront of the USAF. As a low-level ground support bomber, the Intruder is outstanding. It can carry 3,000 lbs. of bombs on a rotary bomb bay door, and 3,000 additional lbs. of underwing weapons.

The Intruder is one of the few American combat planes to be designed in a foreign country. While the British were testing the English Electric Canberra, the U.S. Air Force was attracted by the performance of this light bomber. The Canberra's thick, stubby wings, with the engines nearly buried inside them, were just the opposite of traditional American engineering ideas. But its performance was exactly what the U.S. Air Force wanted.

The B-57's tandem canopy replaces Canberra's "side level" type; otherwise, the Martin version of the Canberra differs little on the outside from its British parent. However, the Intruder structure has been greatly strengthened for ground attack operations.

Many B-17's have been modified into very high altitude reconnaissance planes by increasing the wingspan to 172 feet, more than twice the original span of the bomber. These versions are used in weather and strategic observation missions. Other versions of this remarkably sturdy aircraft are used as trainers and for target-towing.

MARTIN B-57B INTRUDER SPECIFICATIONS

DIMENSIONS:	Wingspan - 64 feet Length - 65 feet 6 inches
POWERPLANT:	Two Wright J67-W-5 7,200 hp. three engine
PERFORMANCE:	Maximum Speed: 580 mph Range: 2,300 miles Service Ceiling: 49,000 feet
ARMAMENT:	Two 20 mm cannon 6,000 lbs. of bombs

GET YOUR TOOLS READY:



KNIFE TO DETACH AND TRIM PARTS FILE TO REMOVE EXCESS PLASTIC



TWEEZERS TO PICK UP AND HOLD SMALL PARTS



TAPE AND CLOTHES PINS TO CLAMP AND HOLD PARTS UNTIL THEY ARE DRY



PAINT BRUSH TO APPLY TO TOOTHPICK POINT BRUSH OR PIN TO APPLY TO



DO NOT DETACH PARTS UNTIL YOU ARE READY TO USE THEM! PARTS ARE TO BE HELD TOGETHER UNTIL YOU LOOK FOR THE SLUGS ON THE RIGHT TO PUT ON OR PART TOGETHER.

★ ★ ★ BEFORE YOU BEGIN ★ ★ ★

FIRST, FIT PARTS TOGETHER and TRIM EXCESS PLASTIC. THEN, APPLY CEMENT SPARINGLY. Too much cement will damage your model. Use a toothpick, pin or small paint brush to apply cement.

IF YOU WISH TO PAINT YOUR MODEL — See PAINTING on all steps for color suggestions.

- Paint small parts before detaching from runner.
- Start with the lighter colors.
- Scrape off paint where cement is to be applied. Cement will not work on paint.

PILOTS & FUSELAGE ASSEMBLY

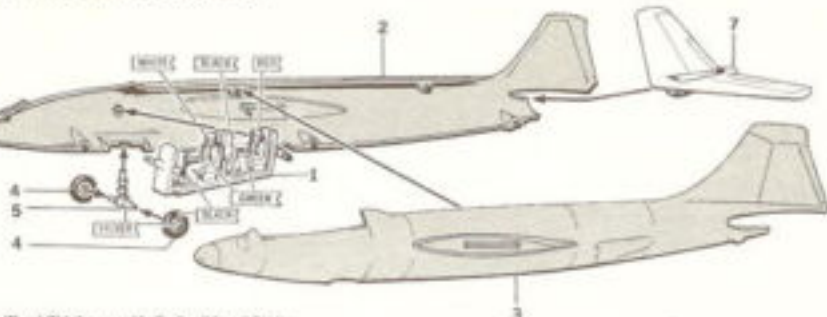

Paint Parts (1), (4) and (5) before assembly. Use Revell Revell Paints.

1. Cement PILOTS Part (1) to RIGHT FUSELAGE (2).
2. Cement LEFT FUSELAGE (3) to RIGHT FUSELAGE.

NOTE: IF YOU WISH TO MAKE AN "ON FLIGHT" VERSION SKIP THE LANDING GEAR.

ASSEMBLY AND CEMENT ALL GEAR DOORS CLOSED.

3. Press TWO NOSE SLUGS (4) into NOSE GEAR (5) and cement to FUSELAGE.
4. Cement UNDERCARRIAGE (6) AND (7) to FUSELAGE.

2 RIGHT WING ASSEMBLY

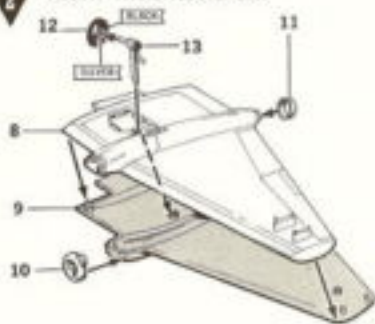

Paint Details (12), (13) and (15) before assembly.

1. Cement RIGHT WING BOTTOM (8) to TOP HALF (9).
2. Cement 811 ENGINE MOUNT (10) and EXHAUST CAP (11) to WING.
3. Cement MAIN GEAR WHEEL (12) to RIGHT MAIN GEAR STRUT (13) then cement STRUT to WING.

LEFT WING ASSEMBLY

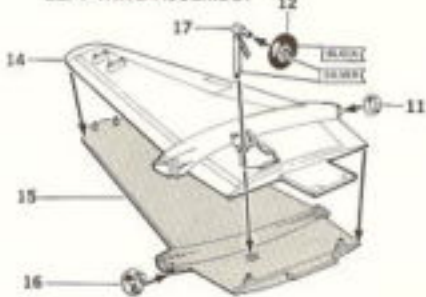

1. Cement LEFT BOTTOM WING (14) to TOP WING HALF (15).
2. Cement ENGINE MOUNT (16) and EXHAUST (17) to WING.
3. Cement MAIN GEAR WHEEL (12) to LEFT MAIN GEAR STRUT (11) and cement to WING.

3 WING INSTALLATION

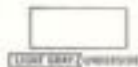

1. Cement RIGHT and LEFT WING ASSEMBLIES from Step 2 to FUSELAGE.
2. Cement LEFT WING TANK TOP (22) and BOTTOM (23) together. Cement TANK to LEFT WING TOP.
3. Cement RIGHT WING TANK TOP (20) and BOTTOM (21) together. Cement TANK to RIGHT WING TOP.
4. Cement two WING GEAR DOORS (25) to FUSELAGE.
5. Cement MAIN LANDING GEAR DOORS, (18), (19), (20) and (21) to WINGS.
6. Paint bottom surfaces of WINGS, FUSELAGE, STABILIZERS and TANK LIGHT GRAY.

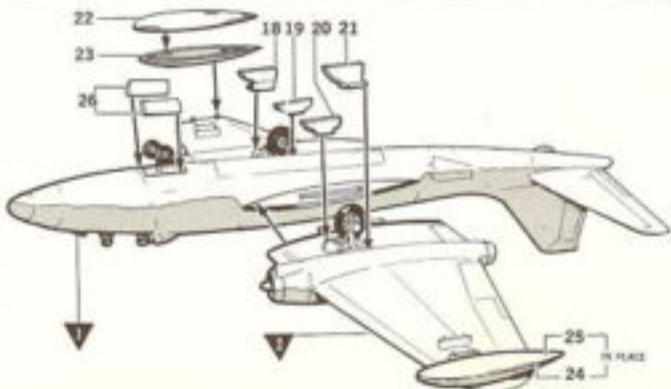

4 FINAL ASSEMBLY



1. Paint TAN and LIGHT GREEN patches on the top surfaces.
2. Install DECALS following instructions on back of decal sheet.
3. Cement Clear COCKPIT CANOPY to FUSELAGE.

