

AMT667



highly detailed 1:537 scale plastic assembly model kit

STAR TREK

U.S.S. RELIANT™ NCC-1864
ASSEMBLY INSTRUCTIONS



GENERAL ASSEMBLY: This highly detailed kit features precision-tooled parts for ease of assembly, but care and patience must be exercised to achieve optimal results. It is recommended that the builder examine the instructions carefully and do a **dry test fit of parts before applying cement**. You will find this very helpful, as it will allow you to gain a clear understanding of how the parts fit together in order to best plan painting and final assembly.

SUB-ASSEMBLIES: Note that this kit is intended to be built in sub-assemblies. This makes building the kit far more manageable. It is very important to note that you will also find it extremely advantageous to **apply paint and decals to sub-assemblies before completing final assembly**. Please see the other side of this instruction sheet for details on paint and marking decal placement. A full set of aztec paneling decals are available separately. Check with your regular source for hobby supplies or check in at round2models.com for availability.

KEY TO NUMBERING SYSTEM

- 1 Opaque plastic part (1-27)
- 100 Clear plastic part (101-109, 201 & 202)
- 1 Step number (1-7)

round2models.com
STARTREK.COM

SKILL LEVEL 2 AGE 10+ CEMENT REQUIRED PAINT REQUIRED

1 ENGINE NACELLES

PORT

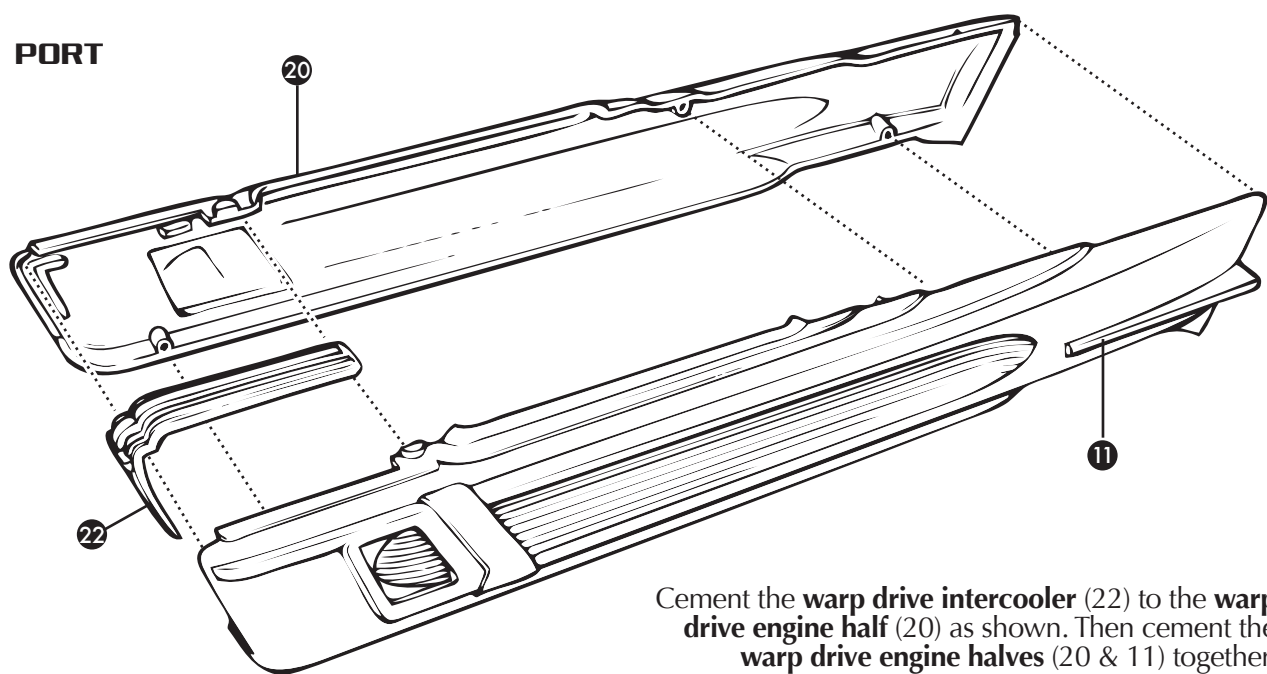

Cement the **warp drive intercooler** (22) to the **warp drive engine half** (20) as shown. Then cement the **warp drive engine halves** (20 & 11) together.

STARBOARD

Cement the **warp drive intercooler** (22) to the **warp drive engine half** (12) as shown. Then cement the **warp drive engine halves** (12 & 21) together.

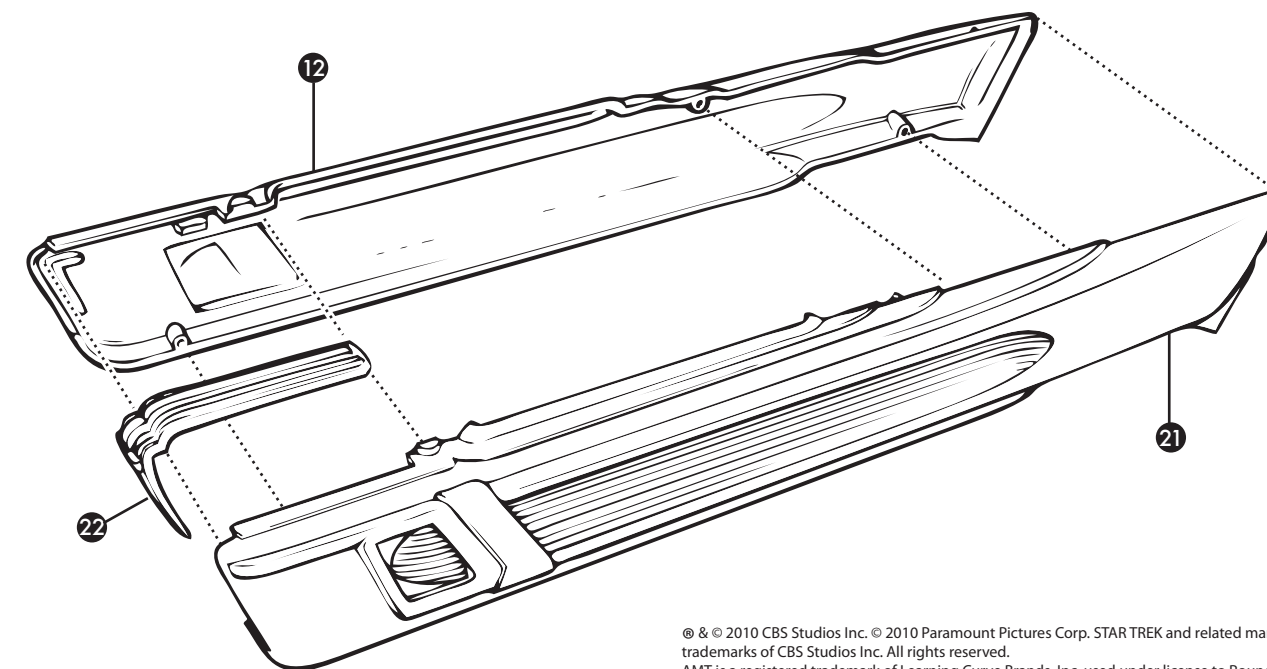

2 PYLONS

PORT

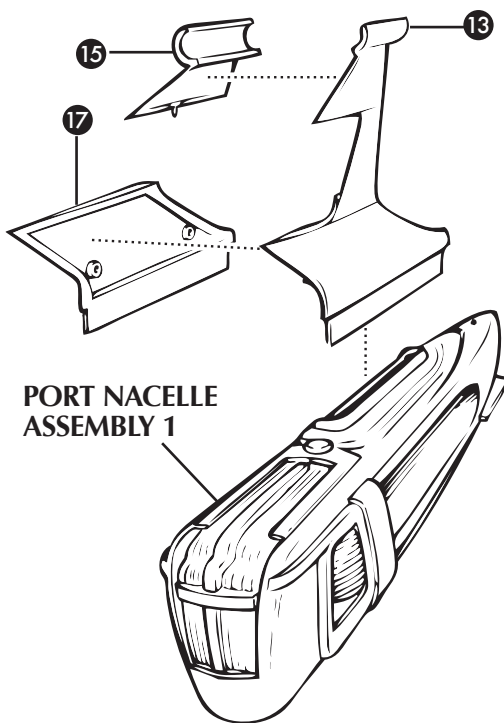

PORT NACELLE ASSEMBLY 1

Cement the **upper inner pylon** (15) and **lower inner pylon** (27) to the **outer pylon** (13). Cement the **assembled pylon** to the **assembled port engine nacelle**.

STARBOARD

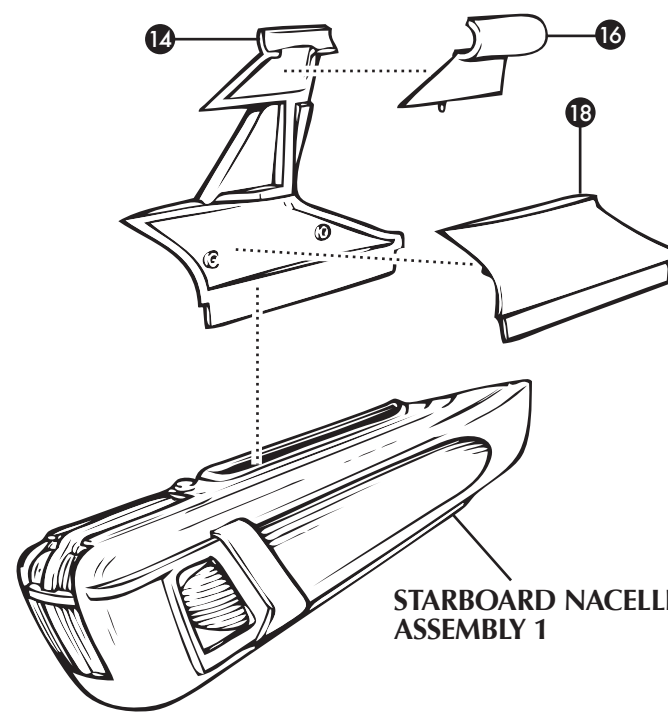

STARBOARD NACELLE ASSEMBLY 1

Cement the **upper inner pylon** (16) and **lower inner pylon** (18) to the **outer pylon** (14). Cement the **assembled pylon** to the **assembled starboard engine nacelle**.

3 FORWARD HULL

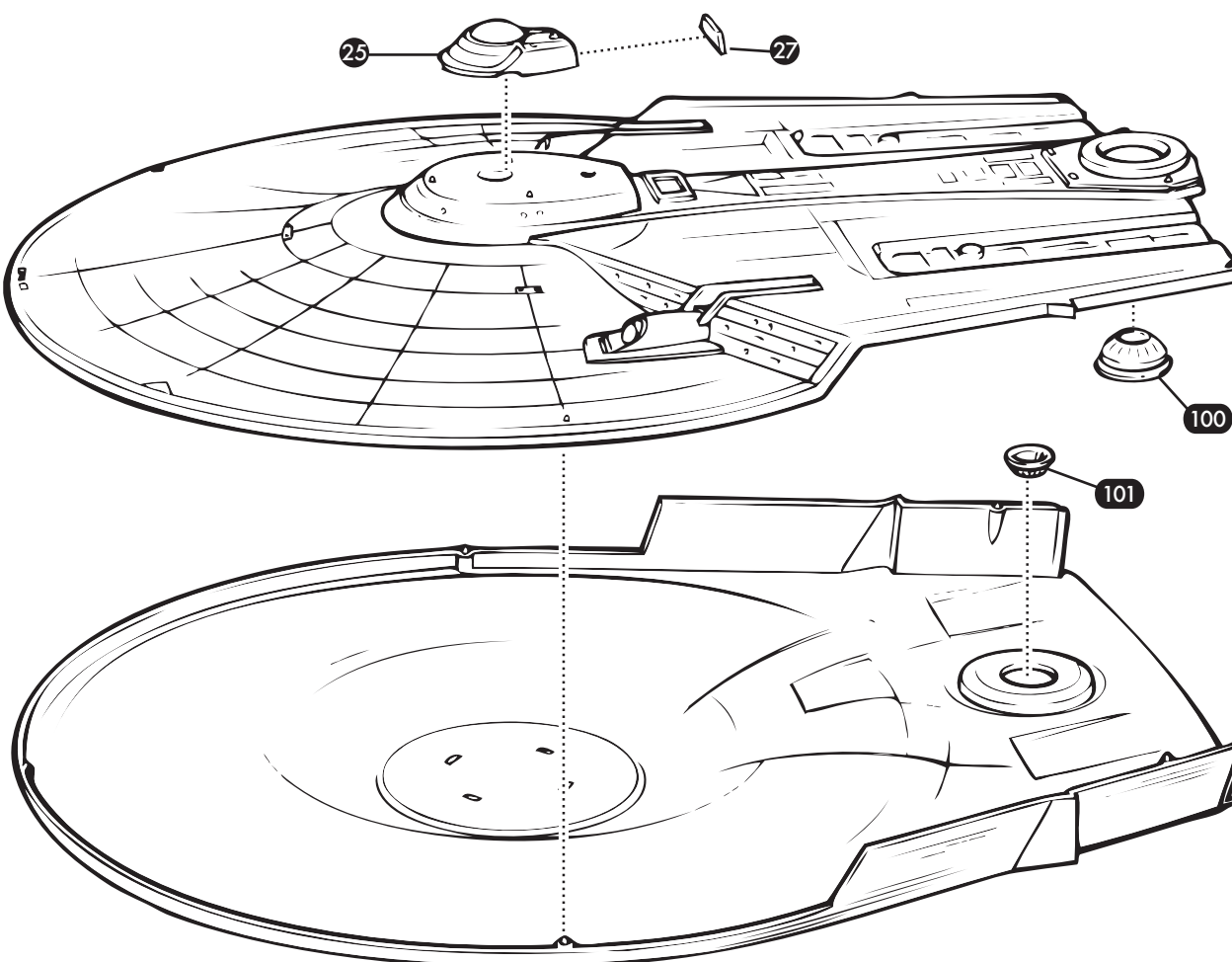

Cement the **lower impulse drive core** (101) to the **lower hull** as shown. Then cement the **upper impulse drive core** (100) to the **upper hull** (14). Cement the **upper hull** to the **lower hull**. Then cement the **docking port** (27) to the **bridge dome** (25). Then cement the **assembled bridge dome** to the **assembled hull**.

4 AFT HULL

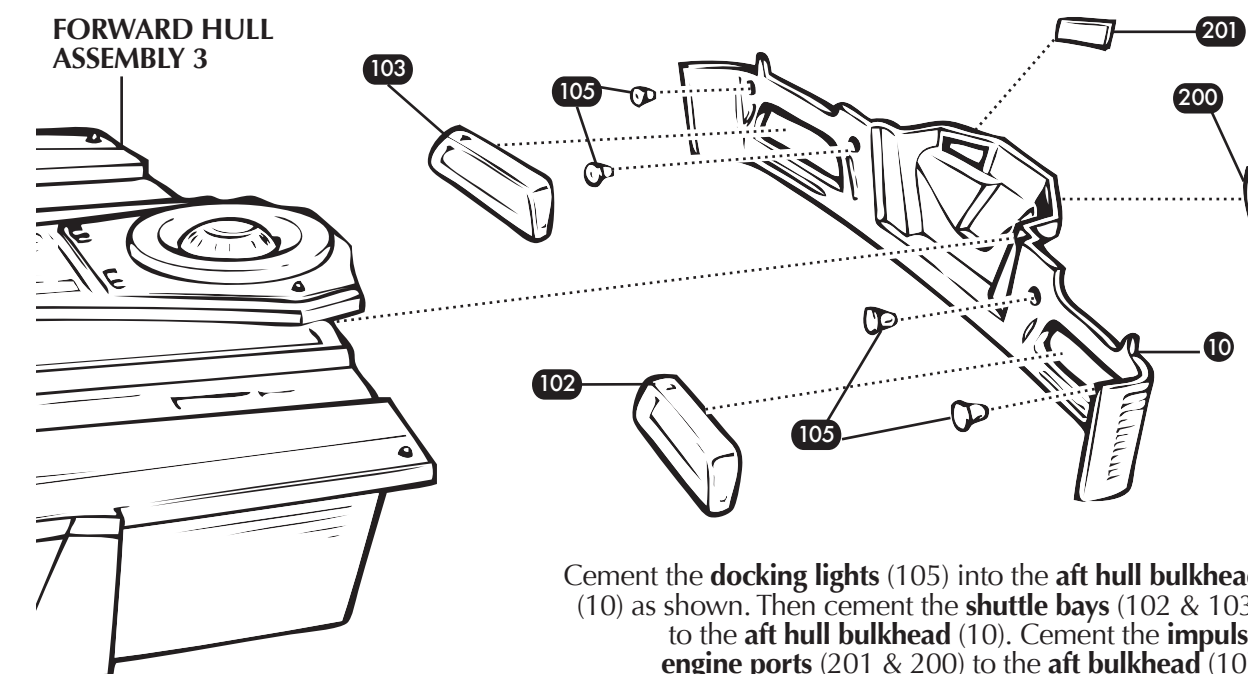

Cement the **docking lights** (105) into the **aft hull bulkhead** (10) as shown. Then cement the **shuttle bays** (102 & 103) to the **aft hull bulkhead** (10). Cement the **impulse engine ports** (201 & 200) to the **aft bulkhead** (10).

5 LOWER HULL

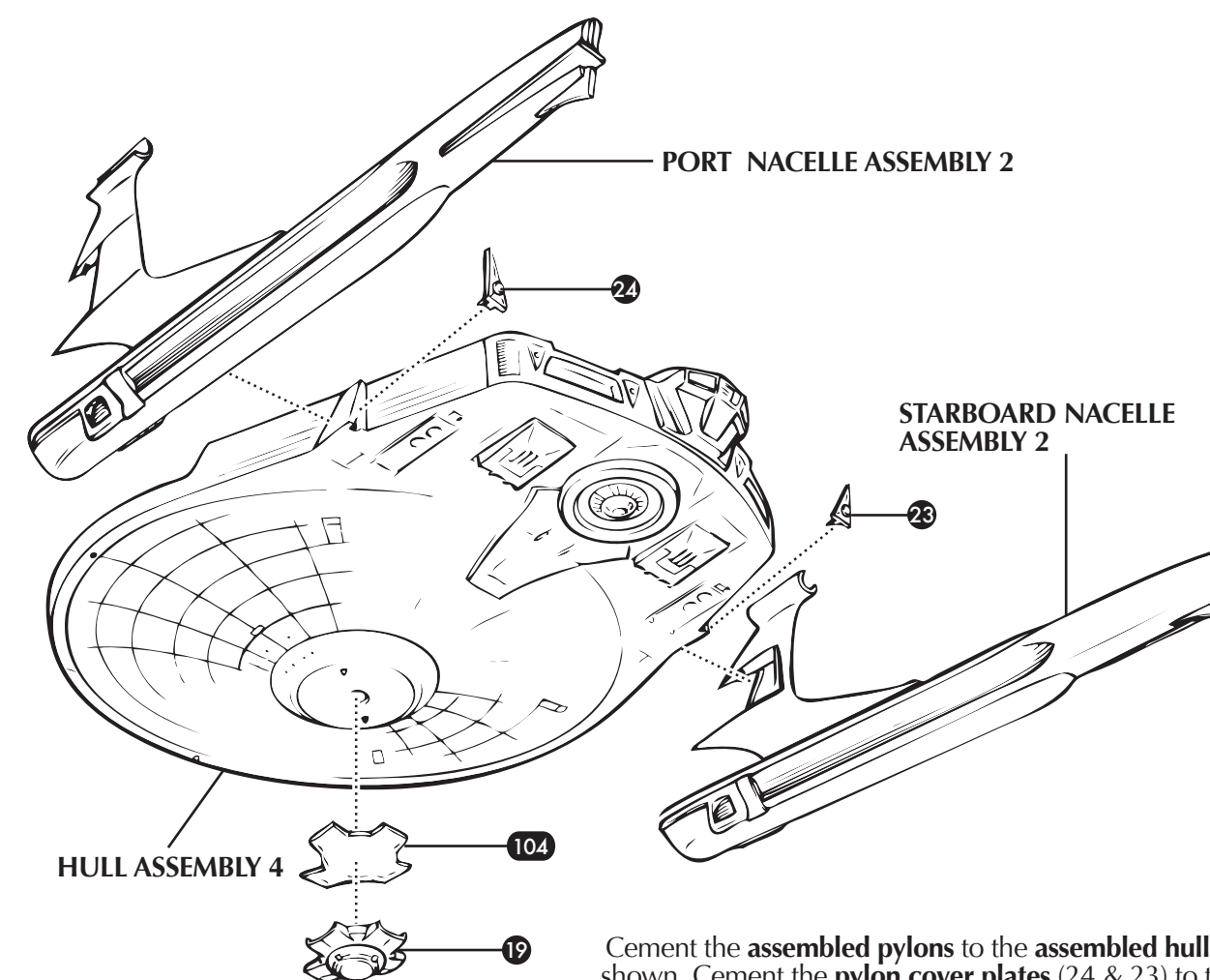

Cement the **assembled pylons** to the **assembled hull** as shown. Cement the **pylon cover plates** (24 & 23) to the **assembled pylon assemblies**. Then cement the **lower sensor dome** (19) to the **clear sensor dome insert** (104). Cement the **sensor dome** to the **assembled hull**.

6 SENSOR ARRAY

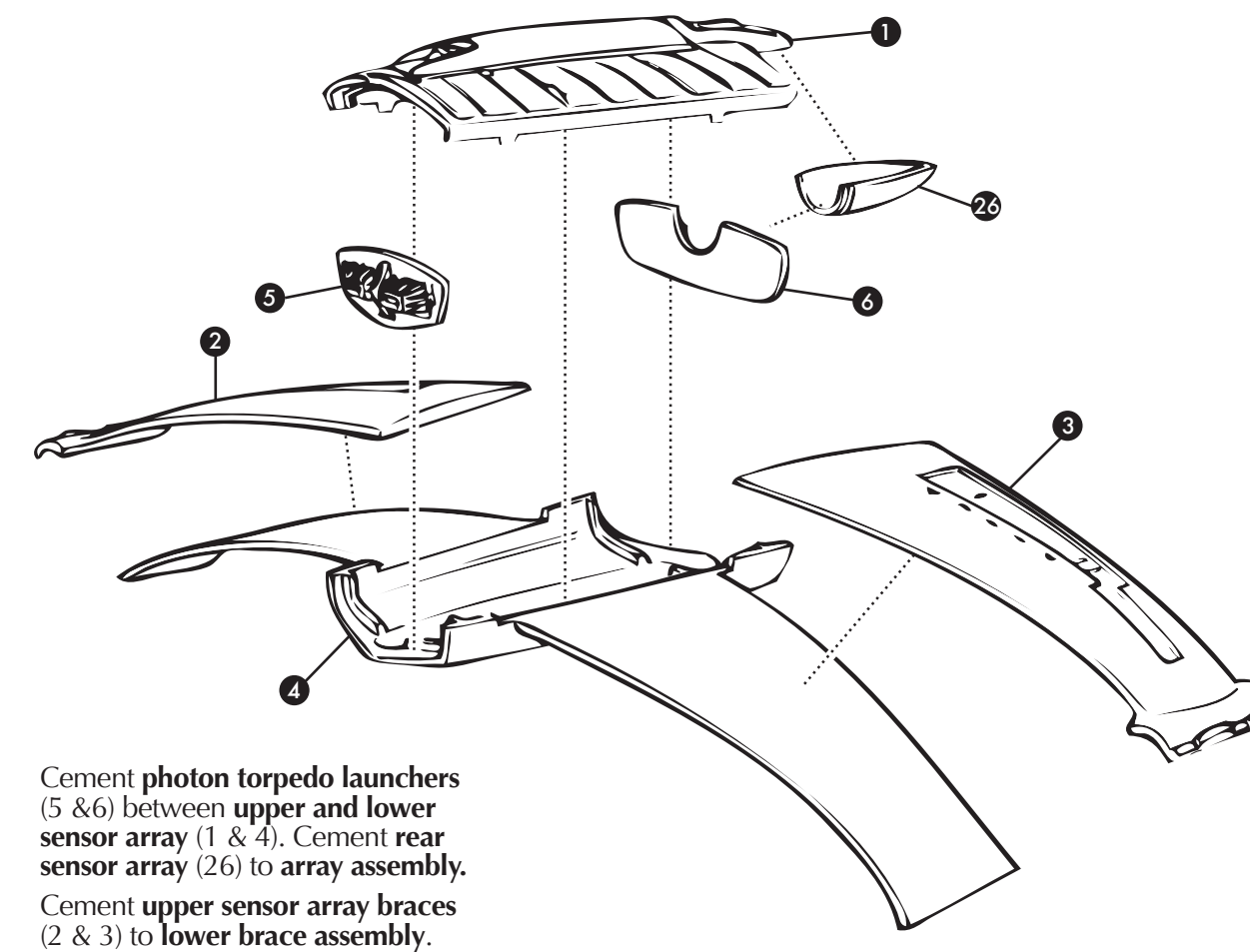

Cement **photon torpedo launchers** (5 & 6) between **upper and lower sensor array** (1 & 4). Cement **rear sensor array** (26) to **array assembly**. Cement **upper sensor array braces** (2 & 3) to **lower brace assembly**.

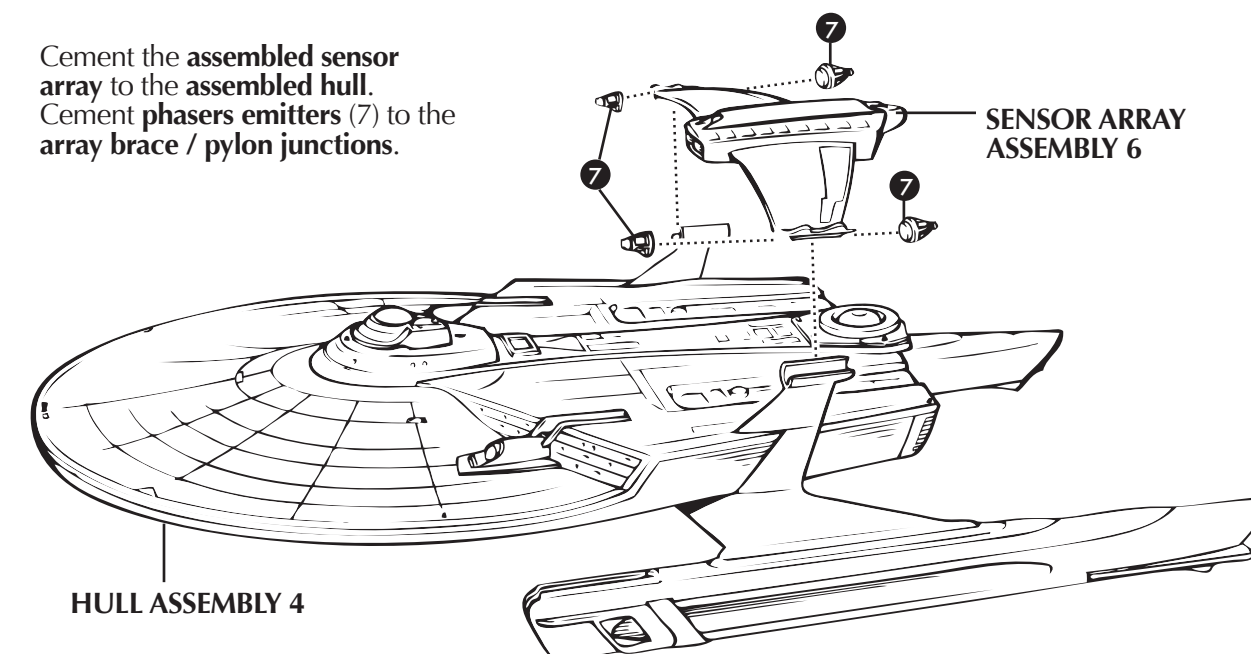

7 FINAL ASSEMBLY



Cement the **assembled sensor array** to the **assembled hull**. Cement **phasers emitters** (7) to the **array brace / pylon junctions**.

PAINT & DECAL INSTRUCTIONS

KEY TO SYMBOLS

- 20** Decal number
- A** Paint color
-  Paint area
-  Cut decal

- A** Duck Egg Blue Model Master #1722
- B** Light Ghost Gray Model Master #1728
- C** Flat Black Model Master #1749
- D** British Crimson Model Master #2009
- E** Insignia White Model Master #1745
- F** Intermediate Blue Model Master #1720
- G** Aluminum Testors #1181
- H** Flat Yellow Testors #1169
- I** Gloss Black Model Master #1747
- J** Copper Testors #1251
- K** Green Model Master #1734
- L** Insignia Red Model Master #1705

