

QF 25pdr Field Gun w/No.27 Ammunition Limber (Trailer)

1/35 SCALE

QF 25磅MK.II/I型野战炮及27号弹药拖车

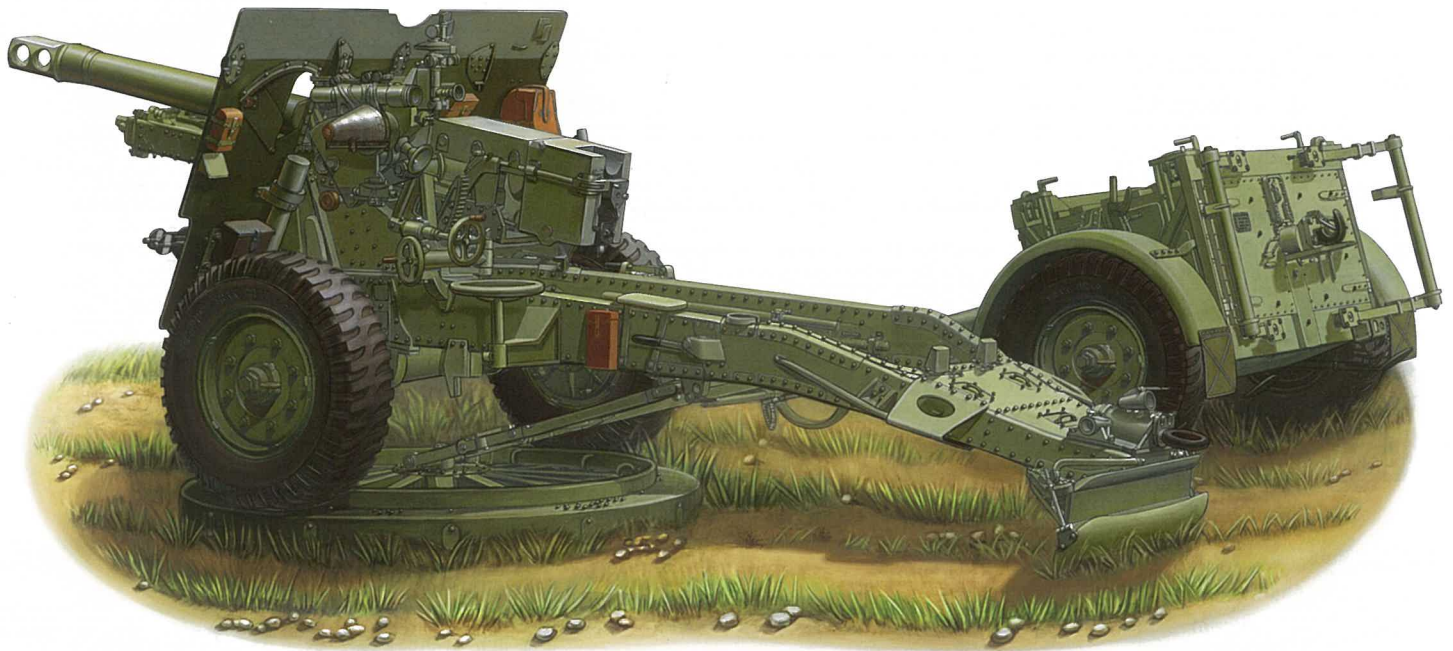

The 25 Pounder Field Gun was designed to replace two WWI vintage guns, the 18 Pounder Field Gun and the 4.5 inch Howitzer. This new weapon was 3.45 inch (87.6mm) caliber and fired a 25 lbs (11kg) shell, the mounting allowed both direct fire and high-angle fire, thus filling the role of the two older guns. However the really outstanding feature was the rapid fire that could be achieved, up to 8 rounds per minute. To rush the gun into service, 25 Pdr barrels were mounted on 18 Pdr carriages, this becoming the 18/25 Pdr Mkl. The production gun with designed carriage was designated the MkII, and entered service in 1940, usually towed by a Morris Quad artillery tractor. By 1943 it was decided to add an anti-tank round, which needed a higher power charge. As a result the gun was fitted with a muzzle brake, becoming the MkII/I when modified, or MkIII if built as new. The 25 Pounder Field Gun served with all British and Commonwealth forces during WWII, and Korea, and served into the 1990's with some armies.

Information & research by Phil Greenwood

Als Ersatz für zwei Waffen aus dem ersten Weltkrieg, (18 Pfünder/84mm Feldgeschütz und 4,5 Zoll/114,3mm Haubitze) wurde das 25 Pfünder Feldgeschütz entwickelt. Diese neue Kanone mit dem Kaliber 87,6mm konnte ein 11kg schweres Projektil verschießen. Da sie für Flach- wie auch für Steilfeuer geeignet war, erfüllte sie beide Aufgaben der veralteten Typen. Auch waren mit dem neuen Modell bis zu acht Schuss pro Minute möglich. Um die 25 Pfünder schnell in den Dienst zu stellen, wurden die ersten Rohre auf 18 Pfünder Lafetten montiert. Diese Kombination nannte man 18/25 Pdr Mkl. Die fertige Version mit passender Lafette wurde dann als MkII bezeichnet und 1940 in Dienst gestellt. Als Zugmaschine war gewöhnlich ein Morris C8 (Quad) vorhanden. Ab 1943 wurde auch ein Geschoss zur Panzerabwehr mit einer stärkeren Treibladung verwendet. Das erforderte die Montage einer Mündungsbremse. Nachgerüstete Geschütze wurden MkII/I genannt, die werksseitig gelieferten MkIII. Das 25 Pfünder Feldgeschütz diente in der britischen Armee sowie in vielen Heeren der britischen Kolonien während des zweiten Weltkrieges, im Koreakonflikt sowie in einigen Ländern bis in die 1990er Jahre.

Deutsche Übersetzung © Michael Knoblich

25 磅野战炮被设计出来是用来替换那些一战老旧的 18 磅野战炮和 4.5 英寸榴弹炮。这款新武器的口径是 3.45 英寸 (87.6mm)，其能发射 25 磅 (11 公斤) 弹药，该炮能直接射击和高角射击，因而可充份替补上述两款老旧之火炮角色。然而其真正显著的特点是它的速射能达每分钟 8 发。当投入服役时，此炮是被装在原 18 磅炮的炮架上，简称为 18/25 磅 I 型。后来专用的炮架被设计出来并正式量产，称为 II 型，并且在 1940 年投入服役，通常由‘摩利士’火炮牵引车拖曳。在 1943 年时其功能被添加为可发射反坦克弹药，因而炮口需添加一个制退器，称为 II/I 型或叫新造的 III 型。在二战期间 25 磅野战炮服务于所有英国和其联邦军队内及后来的韩战中，甚至后来某些国家军队还使用这种炮至上世纪 90 年代。

ILLUSTRATION 图示说明:

CORRECT METHOD FOR APPLYING DECALS : HINWEISE ZUM ANBRINGEN DER DECALS 正确使用水贴纸的方法:

1. Clean model parts surface with wet cloth. Entsprechende Stellen am Modell feucht reinigen.
将需要贴水贴之部位表面擦干净。
2. Cut out the decal parts and dip them in cold water for 15 ~20 seconds. Decal ausschneiden und für 15-20 Sek. ins Wasser legen.
将所需之贴纸剪下泡在清水里约15至20秒。
3. Place it on correct position of the model kit. Decal an der richtigen Stelle auflegen.
将湿透之贴纸取出置放于正确之位置旁。
4. Slide off the decal from the base paper on to the model kit surface with a cotton stick. Decal mit Wattestäbchen festhalten und Papier darunter wegziehen.
用棉花棒轻推贴纸表面使其从底纸滑出至模型表面之正确位置。
5. When decal get dry then complete. Decal mit Papiertuch andrücken und trocknen.
待其自然干透后即完成。

ICON INSTRUCTION: 图标说明:



Open Hole
Loch bohren
钻孔



Remove
Abtrennen
切除



2 Sets needed
Vorgang wiederholen
同样的制作二组



Bend
Biegen
曲折



Optional
Auswahl
可以选择采用



Apply Decal
Decal anbringen
贴水贴纸



Instant Glue For Metal
Sekundenkleber verwenden
瞬间接着剂,金属用



Fill Hole
Verspachteln
把孔填平



Do not cement
Nicht kleben
不用粘合

COLOR SUGGESTION: FARBTABELLE: 涂装指引:

Color	涂料表	MR. Hobby	Hobby Color	Humbrol	Tamiya	
Steel	Stahl	黑铁色	H-18	C-28	53	/
Aluminium	Aluminum	铝色	/	/	56	XF-16
Wood brown	Hoizbraun	木棕色	/	/	110	/
Copper		铜色	H-11	C-10	11	XF-6
Leather brown		皮革棕色	/	/	62	XF-62
Dark yellow	Dunkelgelb	深黄色	H-78	C-38	66	XF-62
Tyre black	Reifenschwarz	轮胎黑	H-77	C-137	85	/
Flat black	Reifenschwarz	消光黑	H-12	C-33	33	XF-1
Sand No.65		65号沙色	/	/	63	XF-60
Silver	Silber	银色	H-8	J-8	11	X-11
Olive drab		橄榄绿	H-78	C-38	66	XF-62
Semi-Gloss Black	Schwarz Seidenmatt	半光黑色	/	C-82	/	/
Red	Rot	红色	H-3	C-3	19	X-7
Flat white	Matt Weiss	消光白	H-11	C-62	34	XF-2

READ BEFORE ASSEMBLING: VOR ZUSAMMENBAU LESEN: 组装必读:

- Carefully Study instruction before assembling. Anleitung studieren und verständlich machen. 组装前请阅读清楚制作指引。
- Keep plastic model glue and tools away from children. Kleber, Farben, Werkzeuge und Plastiktüten von Kindern fernhalten. 胶水,油漆及工具勿让小孩接触。
- Do not use cement or paint near open flame or sparks. Kleber/Farbe nicht in Nähe von offenen Flammen. 胶水及油漆勿接触火种。
- Do not work in closed room. Nur in ausreichend belüfteten Räumen arbeiten. 勿在密封地方制作模型。

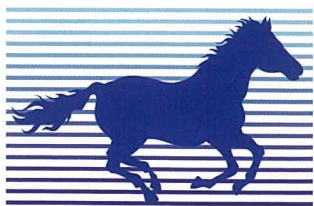

BRONCO

Bronco Models

Copyright © 2011

Made in China

中国制造

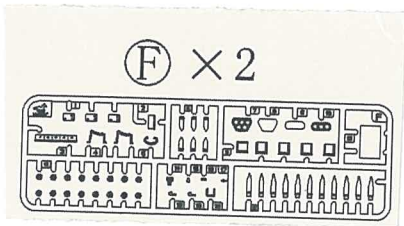

Ⓕ × 2

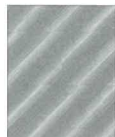

No use parts
不要部件

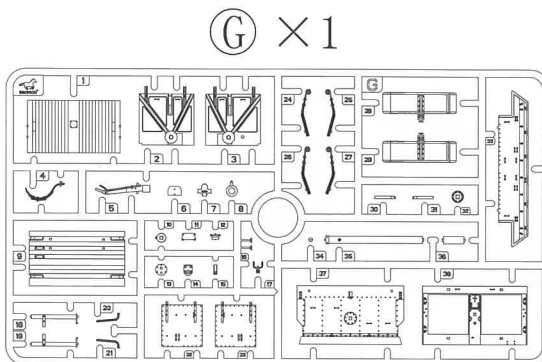

Ⓖ × 1

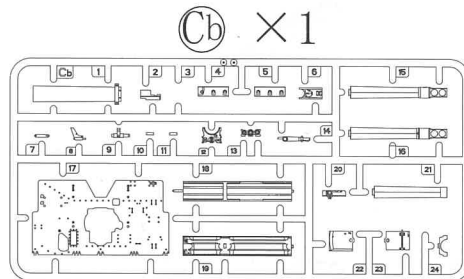

Ⓒb × 1

Ⓐ × 1

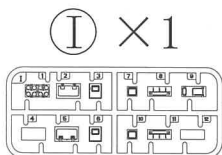
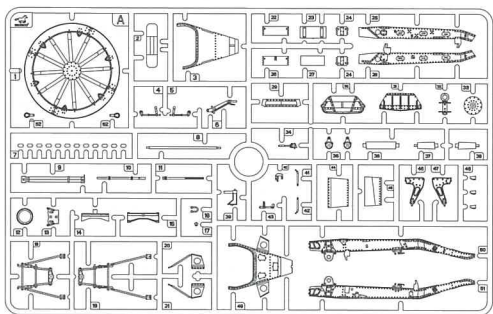

Ⓘ × 1

Ⓔ × 4

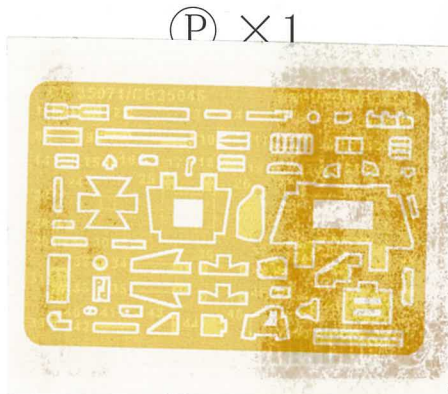
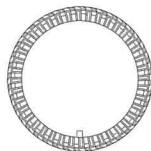

⒫ × 1

Ⓑ × 1

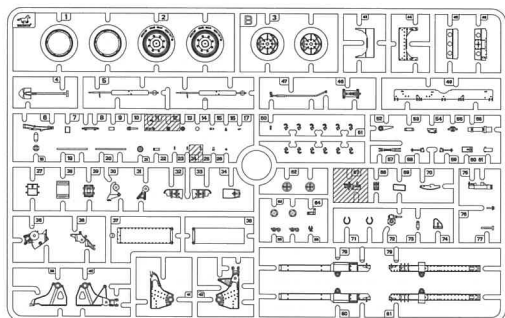

⒫b × 1

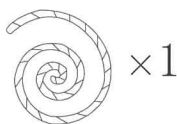

× 1



DECAL × 1

Ⓕ × 2

DECAL × 1



DECAL × 1

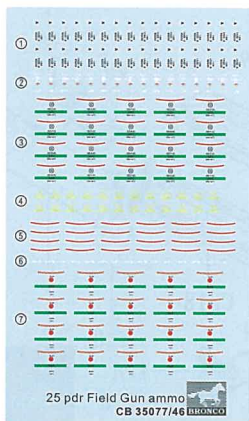
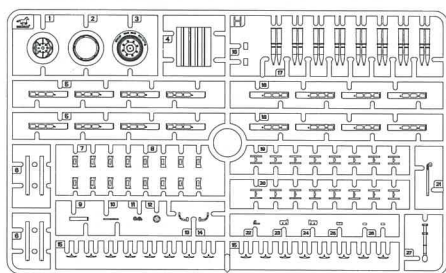

CB35046

ILLUSTRATION 图示说明:

1

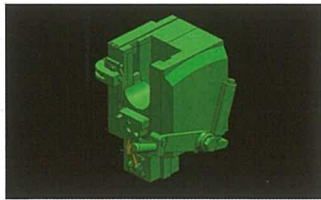
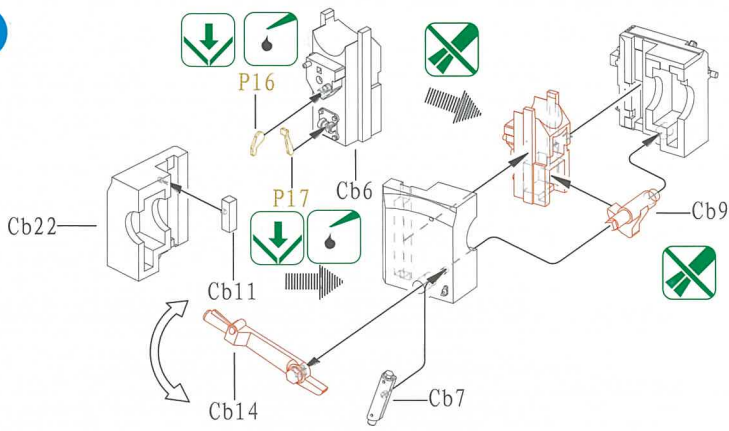

1

Cb runner part
Cb版流道零件

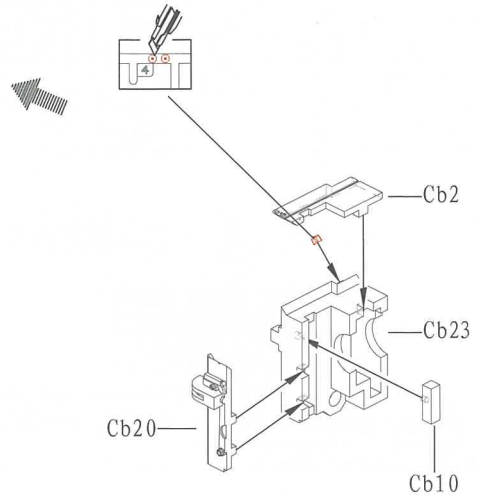

2

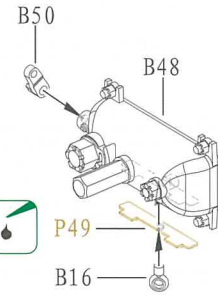
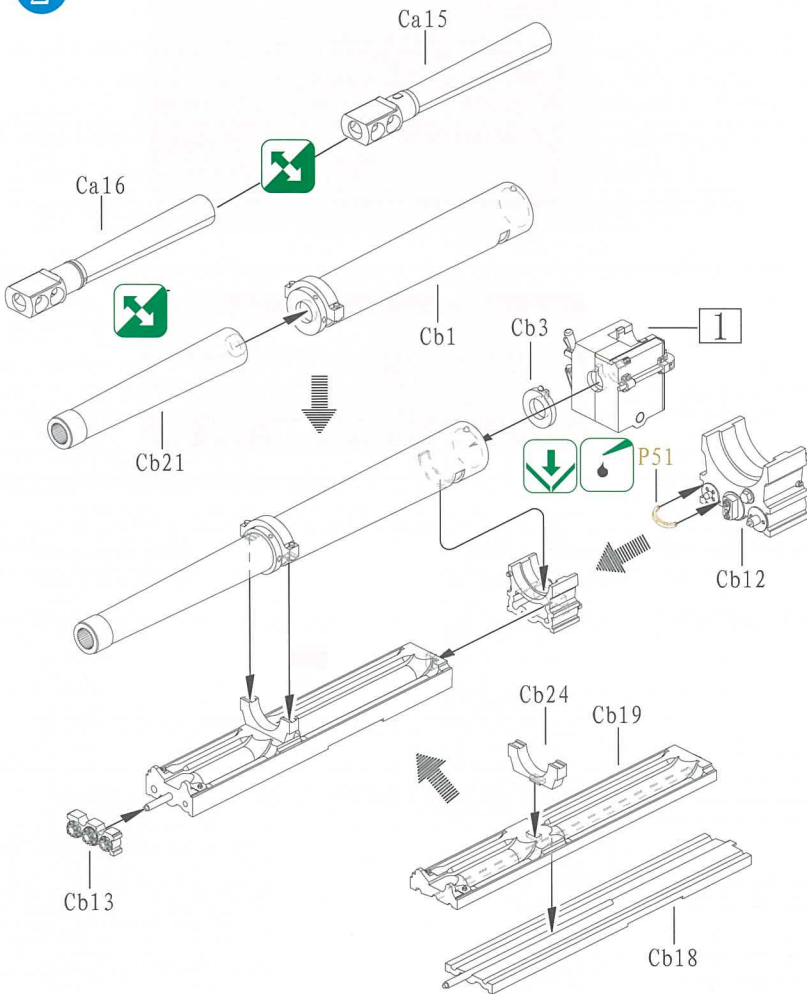

2

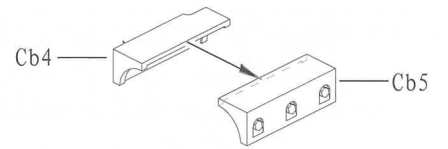

3

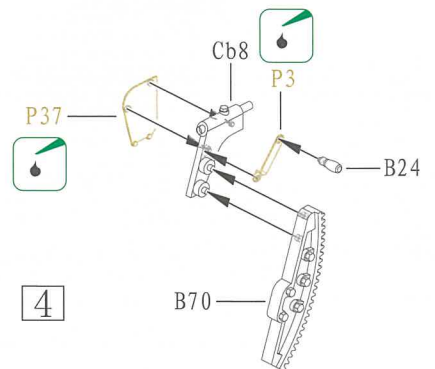

4

3

可选择方案一或方案二：方案一选择绿色编号件
方案二选择蓝色编号件

Option 1 or Option 2: Option 1 close the green number item
Option 2 close the blue number item

Option 1:
方案一:

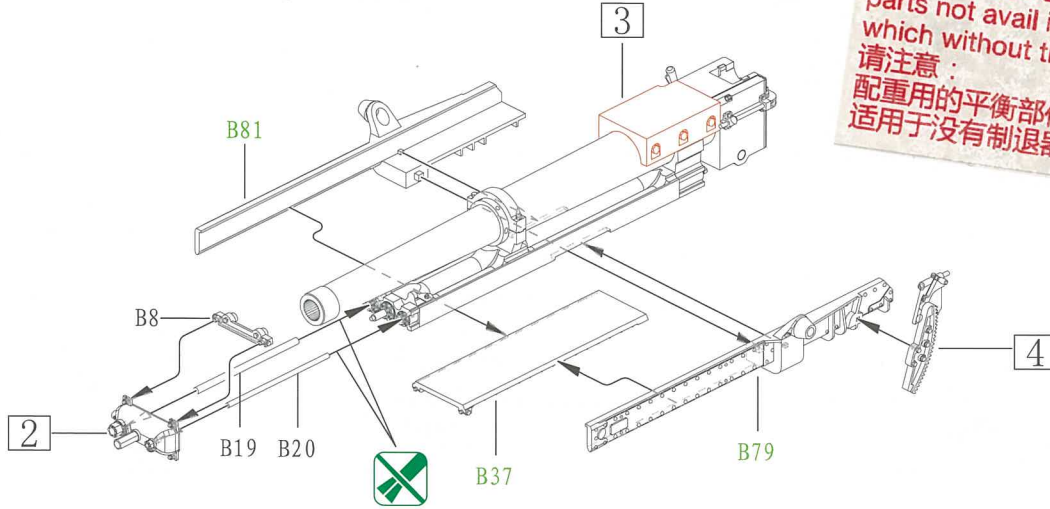

Caution:
Cb4 and Cb5 counterweight parts not avail in early version which without the muzzle Brake
请注意：
配重用的平衡部件Cb4和Cb5不适用于没有制退器的早期型

4

Close
关闭

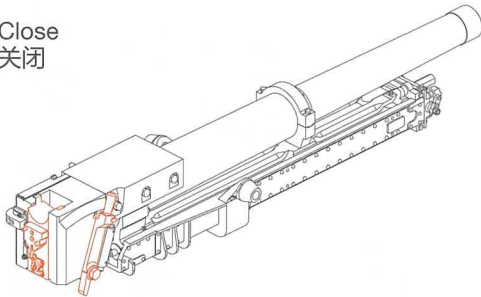

Open
开启

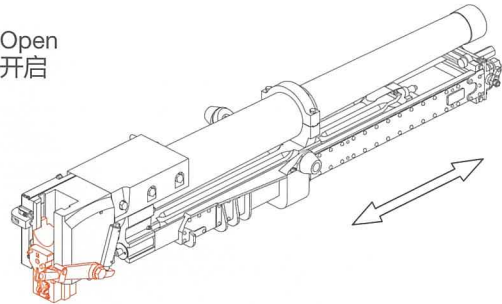

5

5

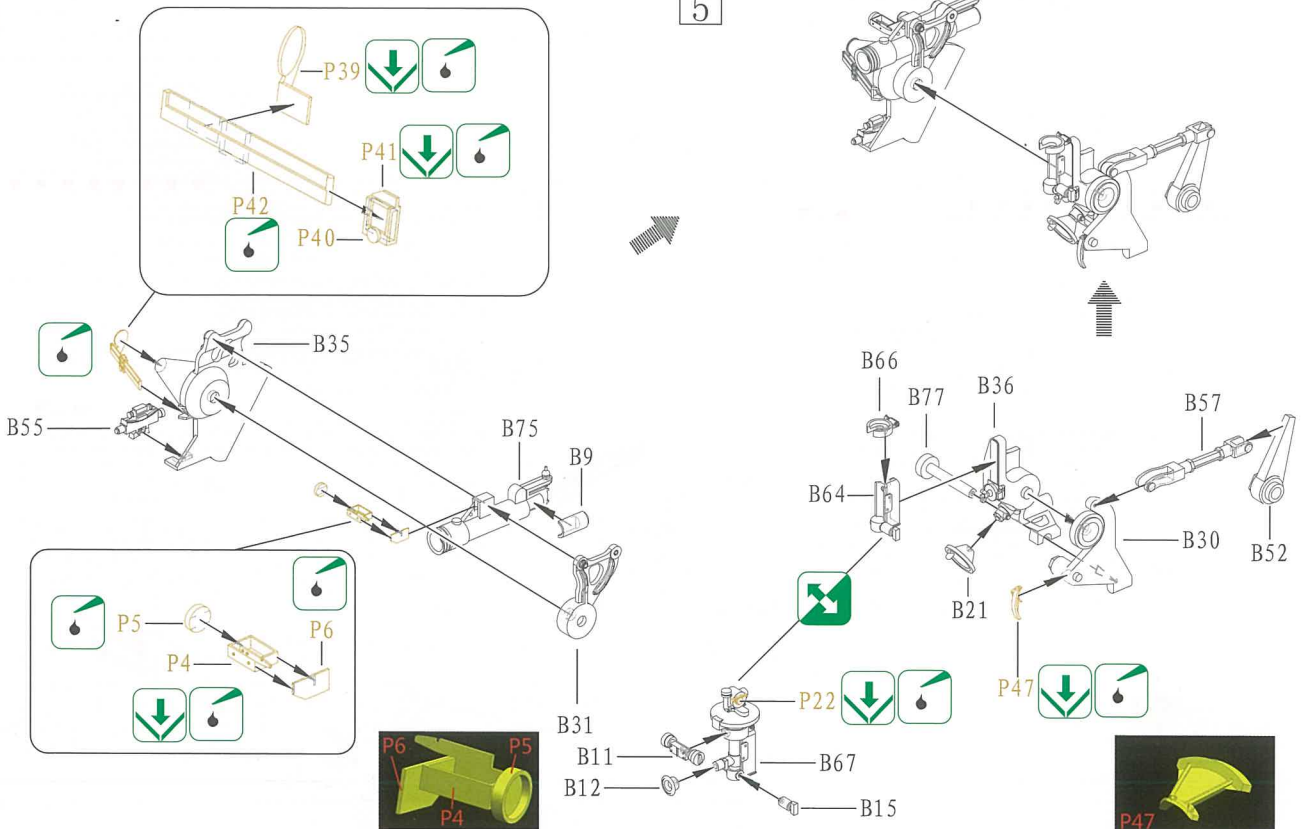
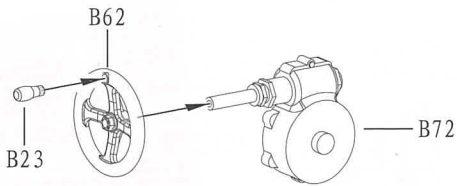
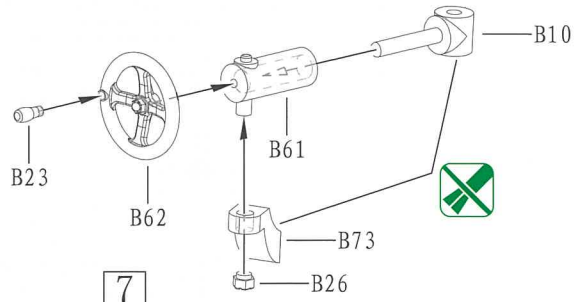

ILLUSTRATION 图示说明:

6



6



7

7

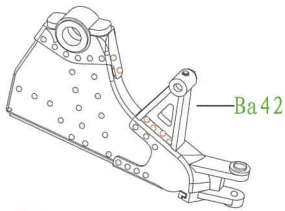

B runner part
B版流道零件

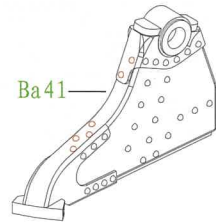
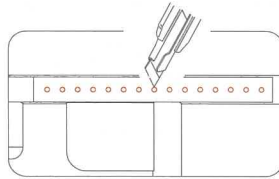

8

★ Caution: Make the pipe by the plastic frame channel with the heat of fire.
注意：制作用流道加热拉丝。

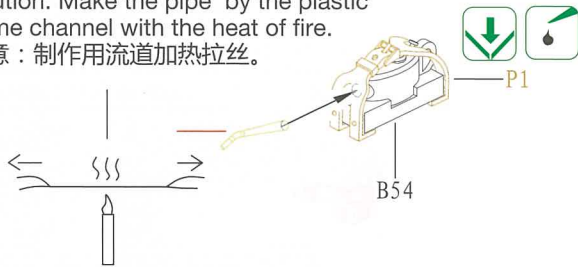

8

9

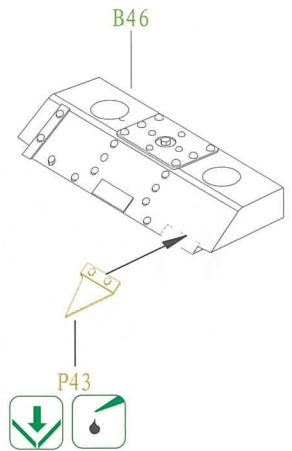

9

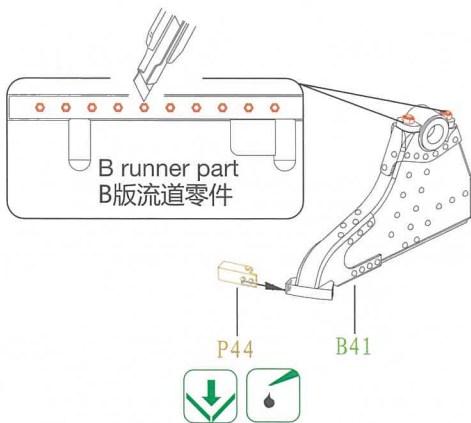

10

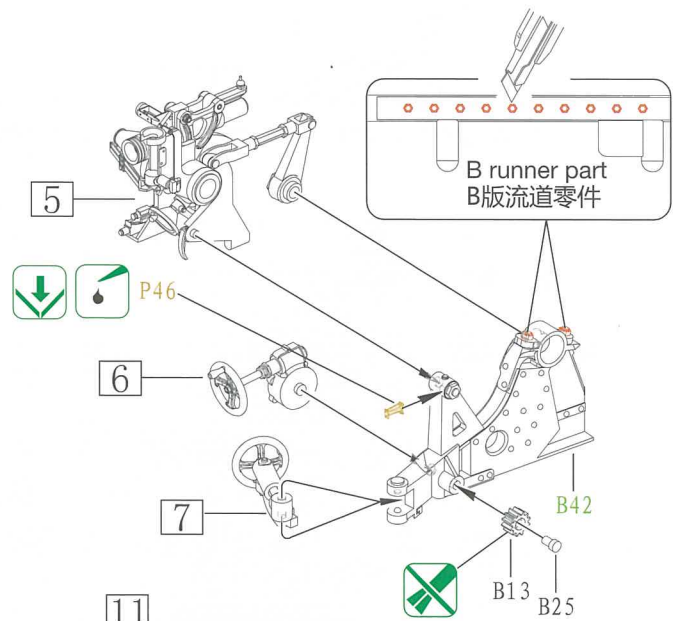

11



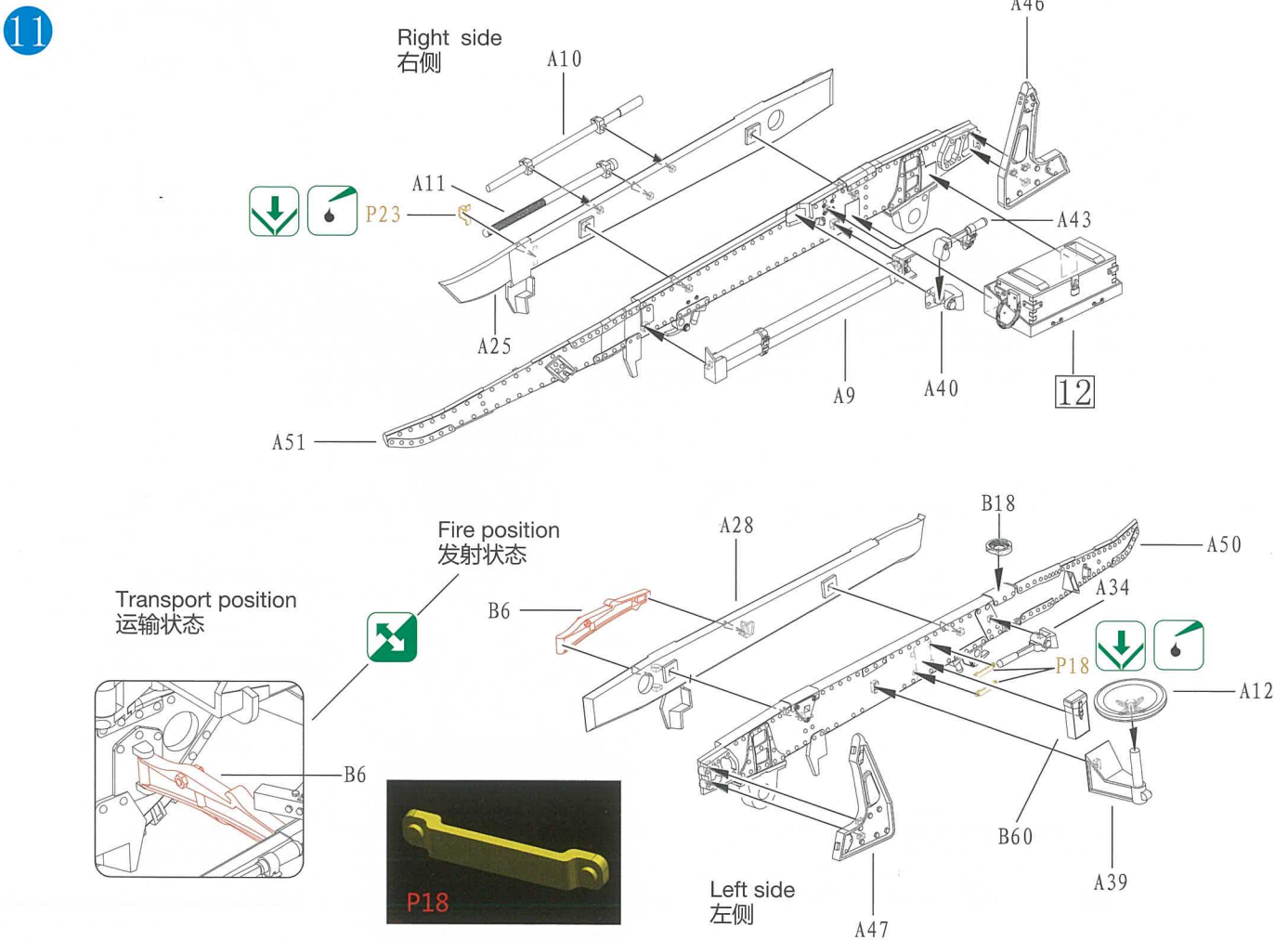
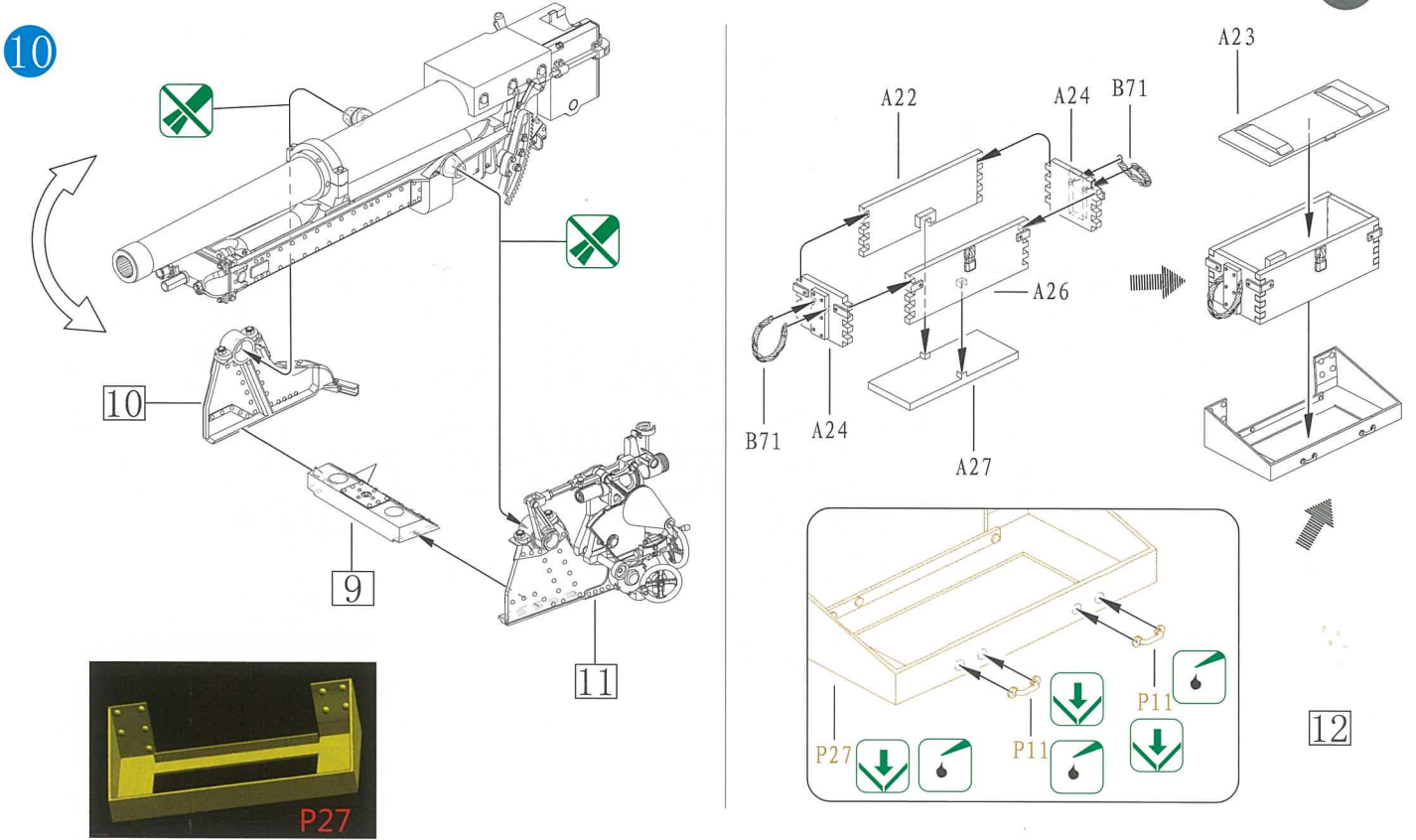
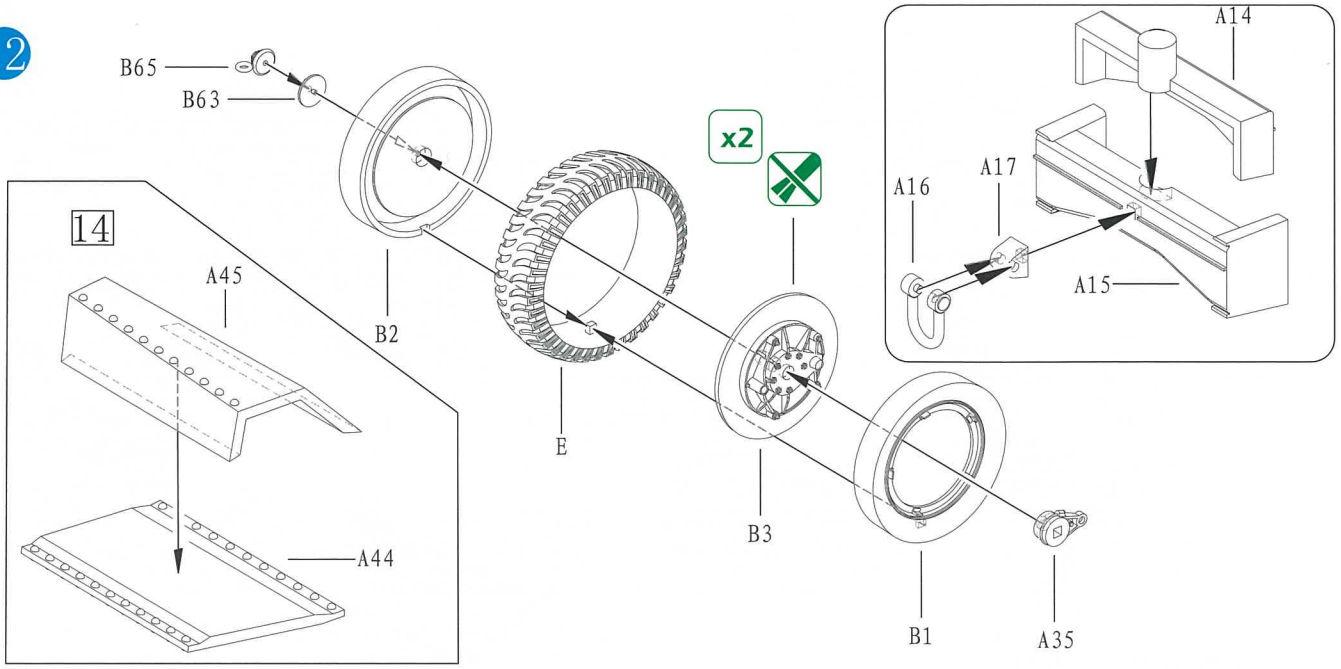
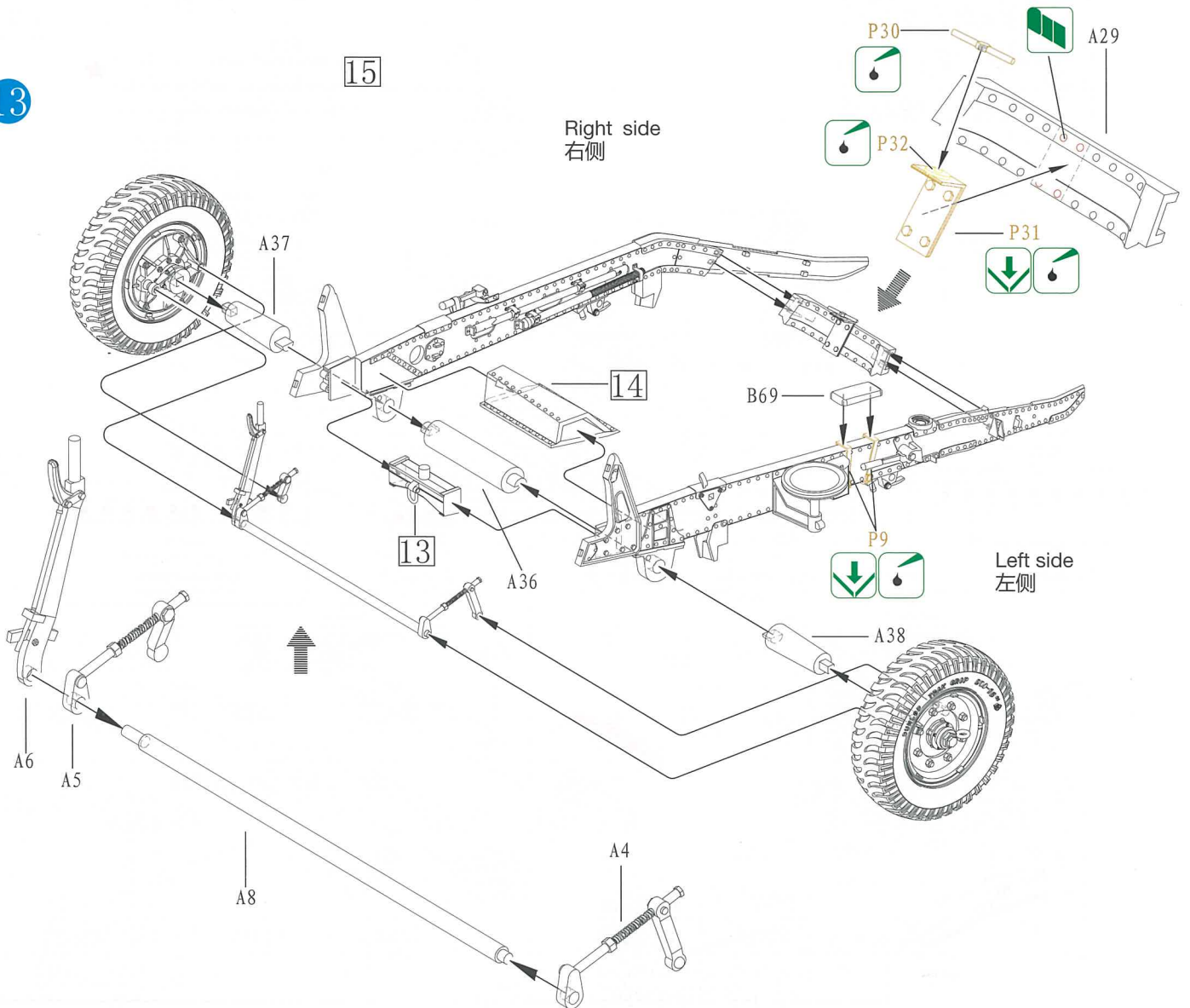

ILLUSTRATION 图示说明:

12



13



14

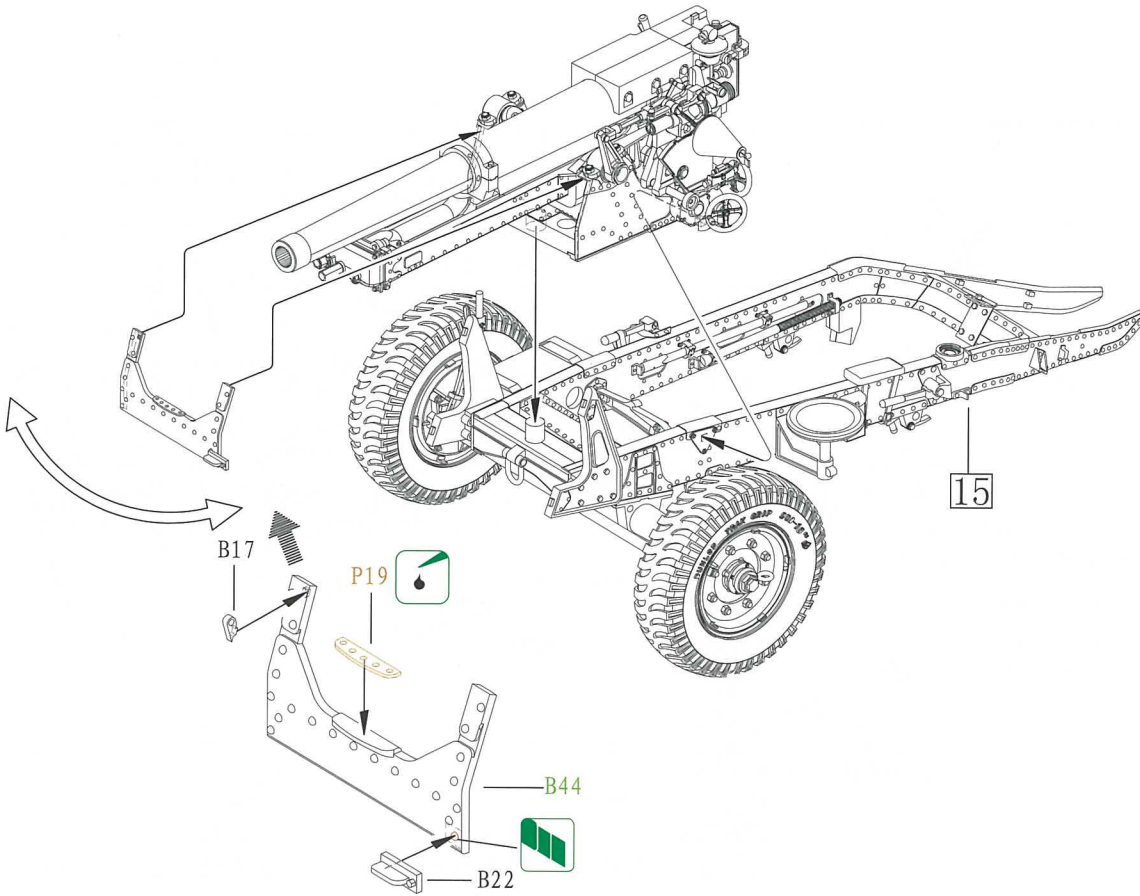

15

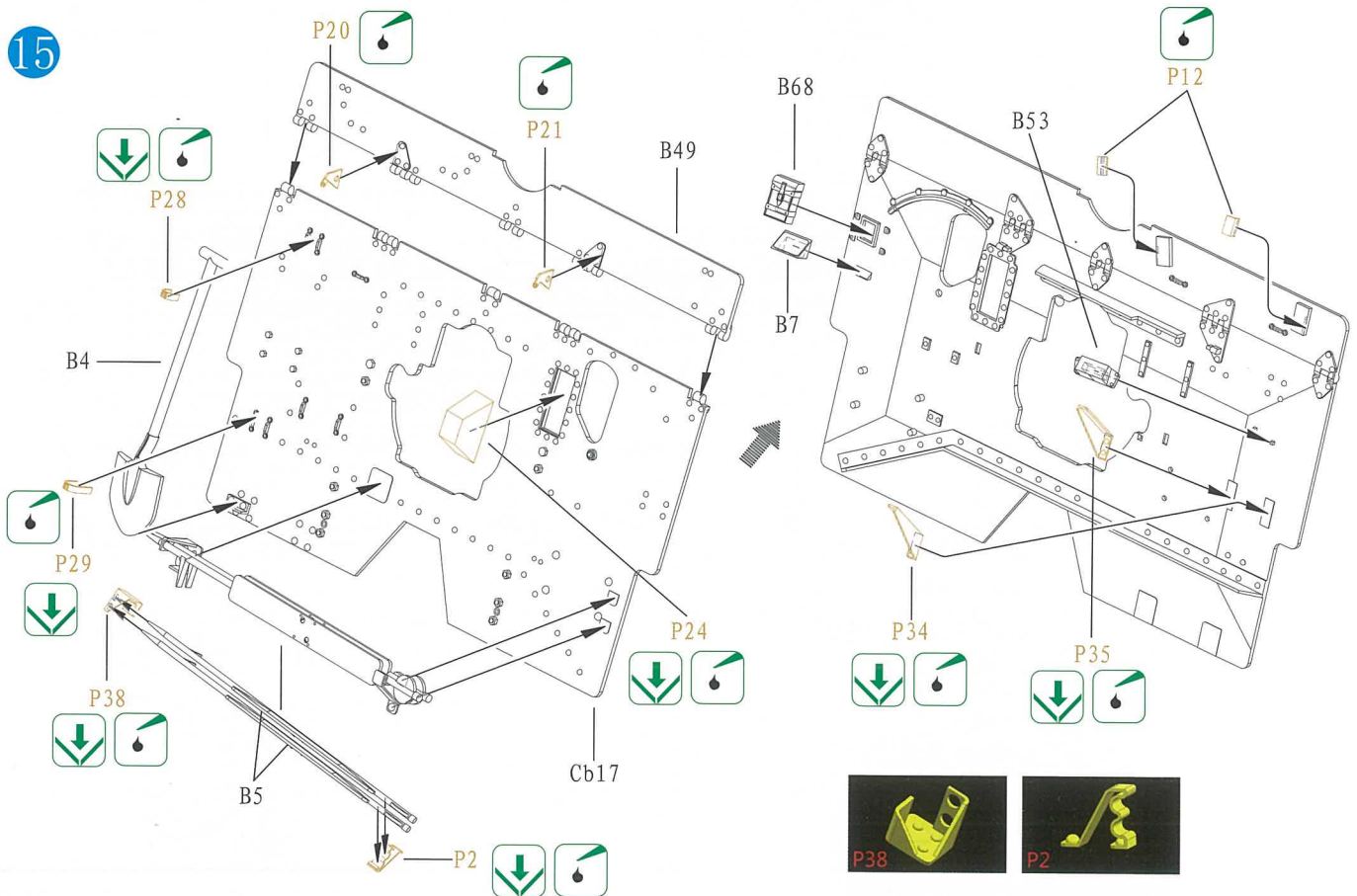

16

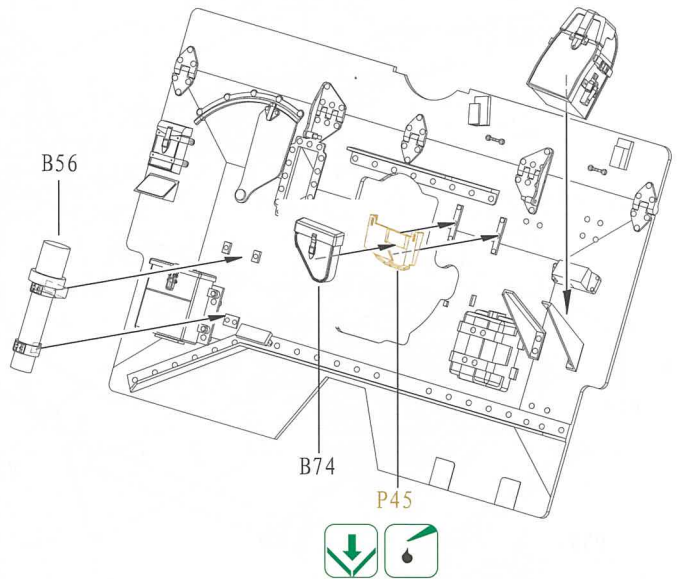
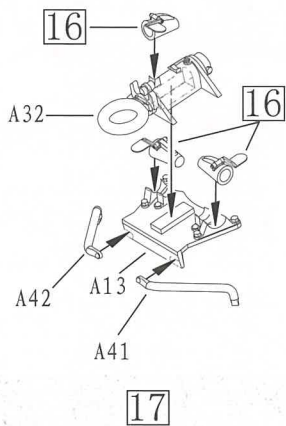
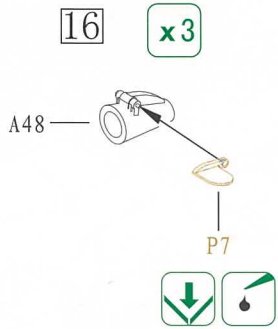
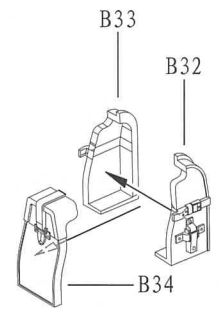
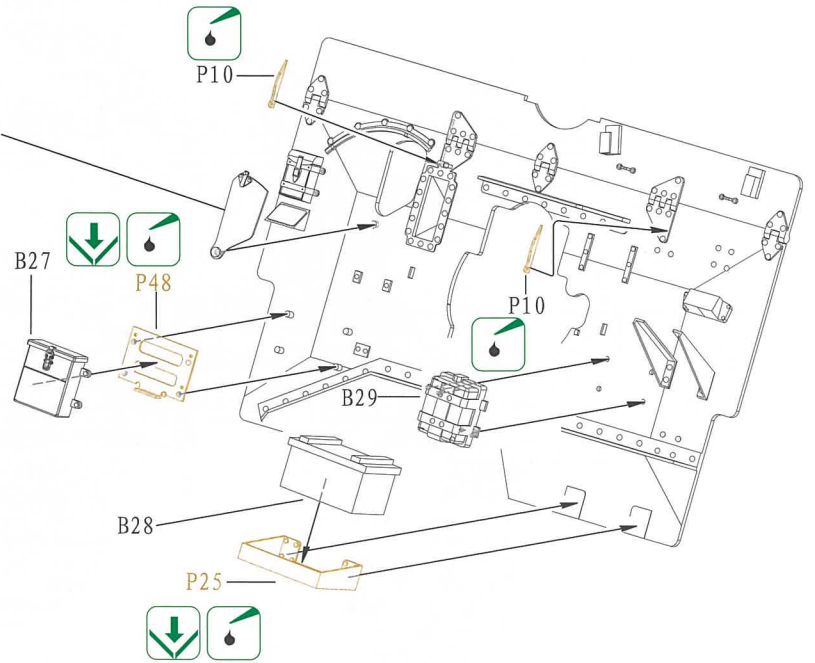
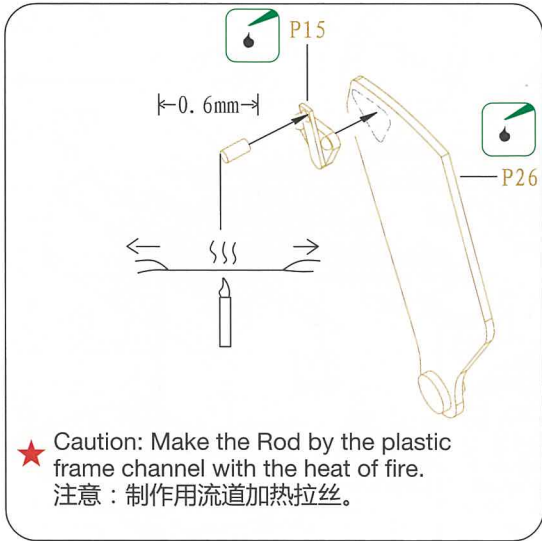

18



17

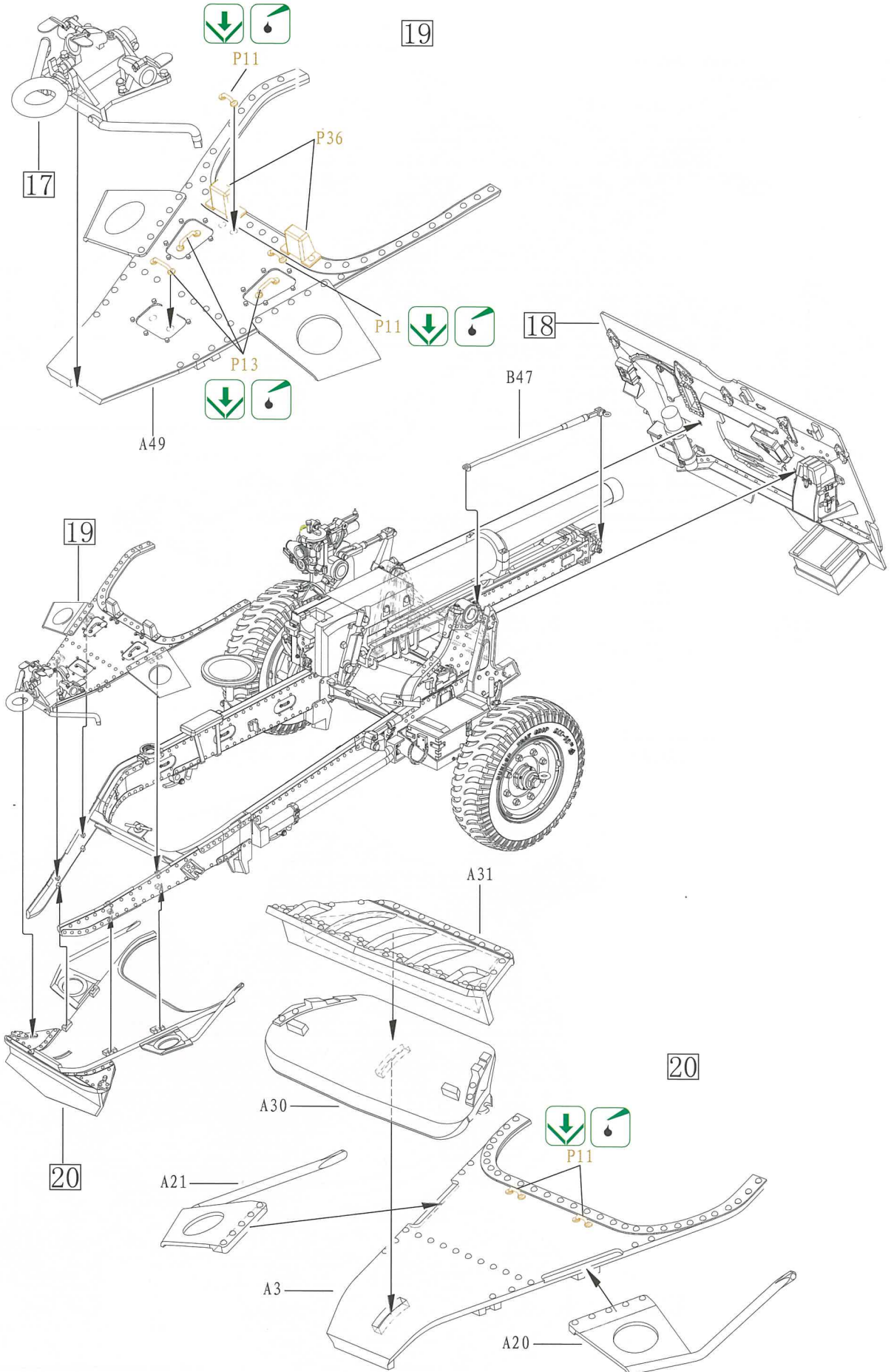
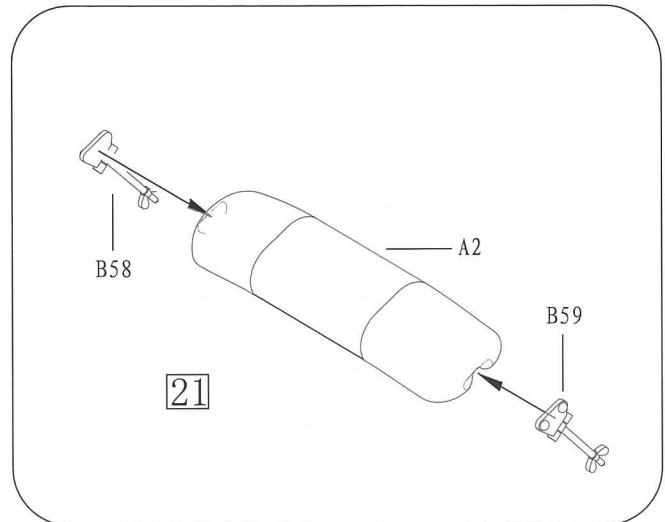
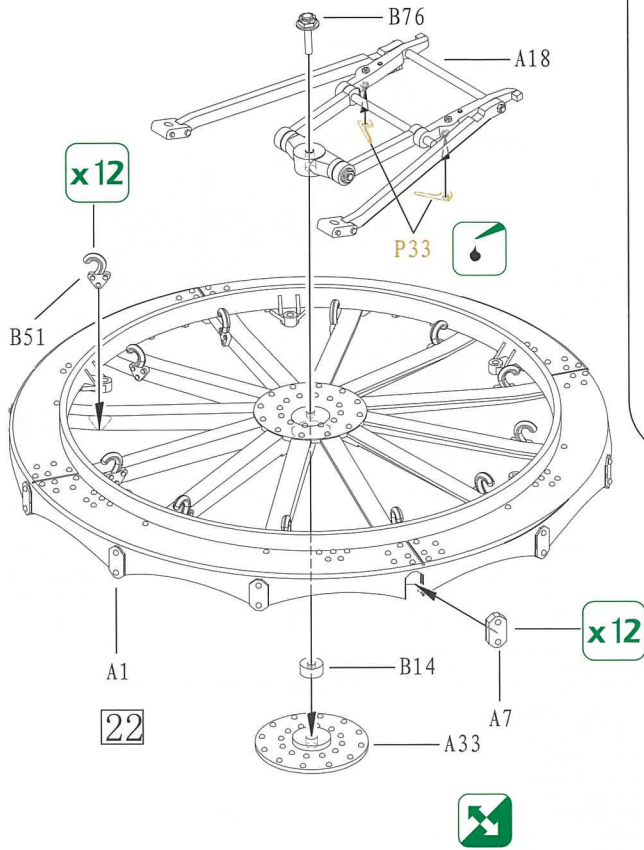

ILLUSTRATION 图示说明:

18

Transport position
运输状态



Fire position
发射状态

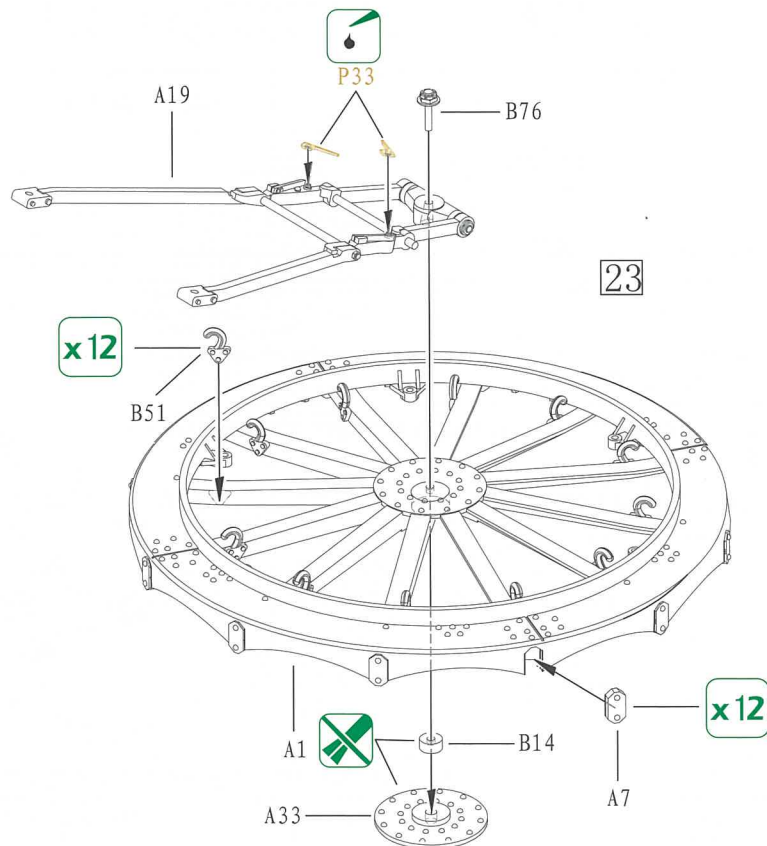

19

Transport position
运输状态

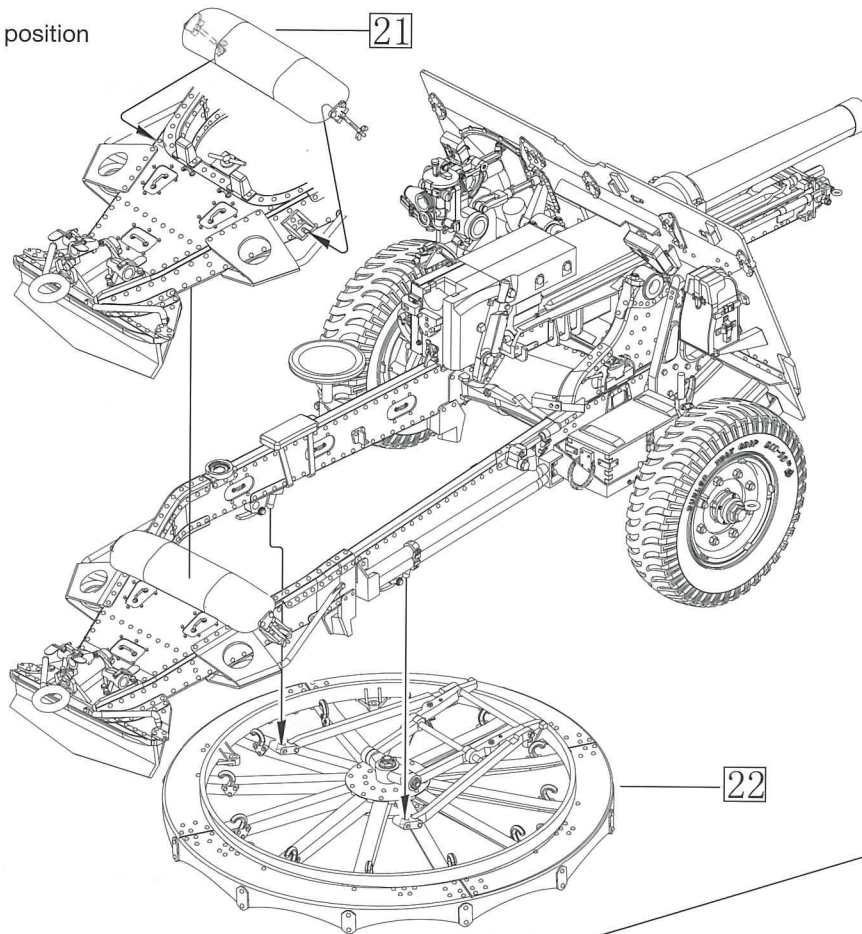

Fire position
发射状态

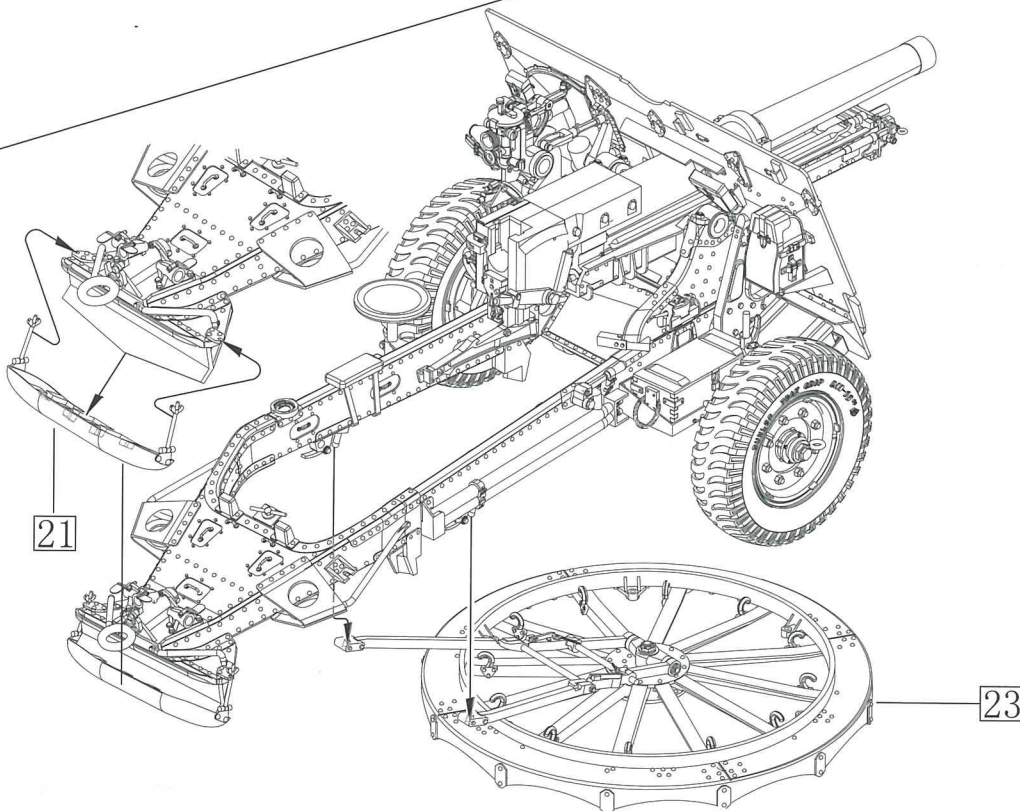
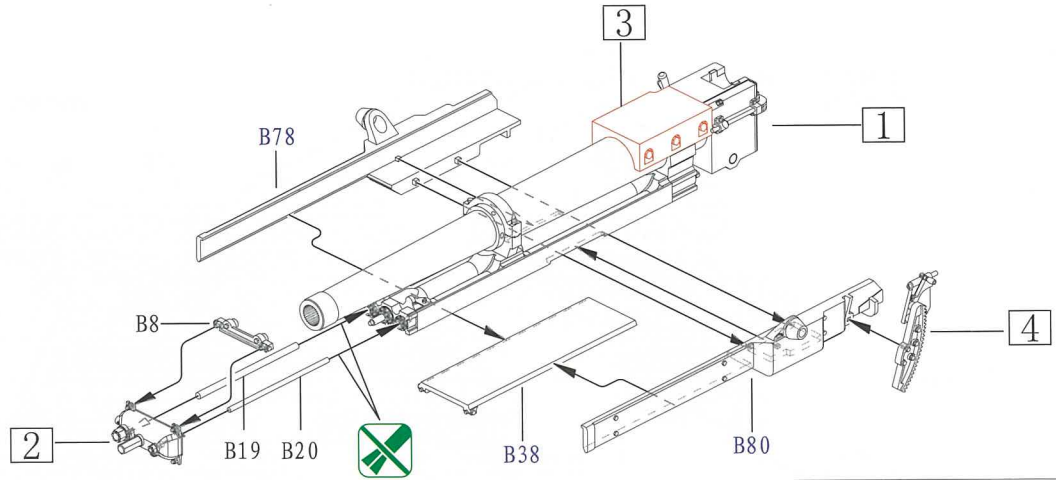

ILLUSTRATION 图示说明:

20

Option 2:
方案二:



21

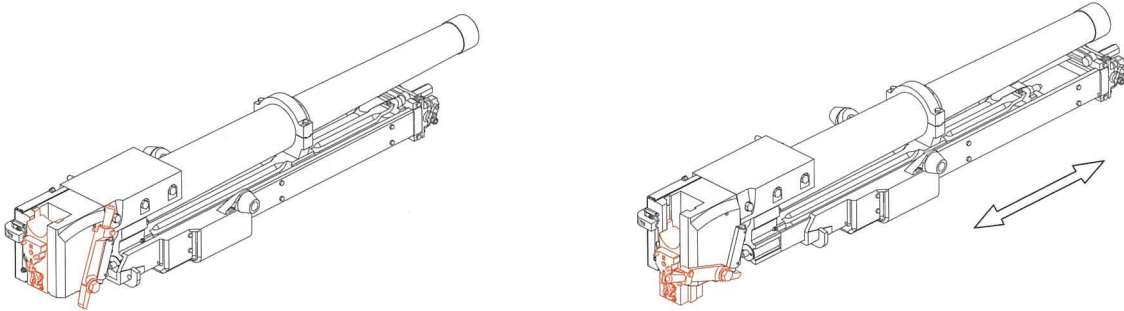

22

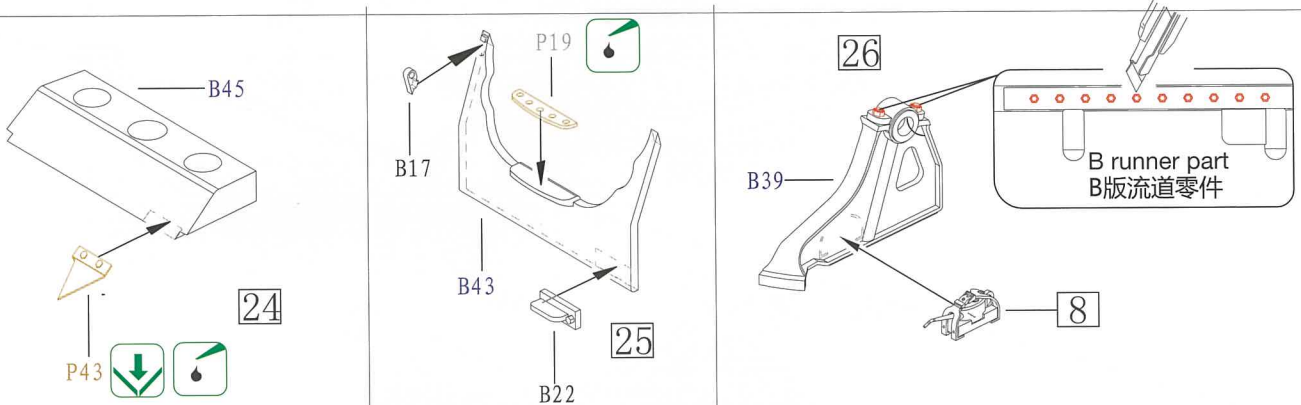

23

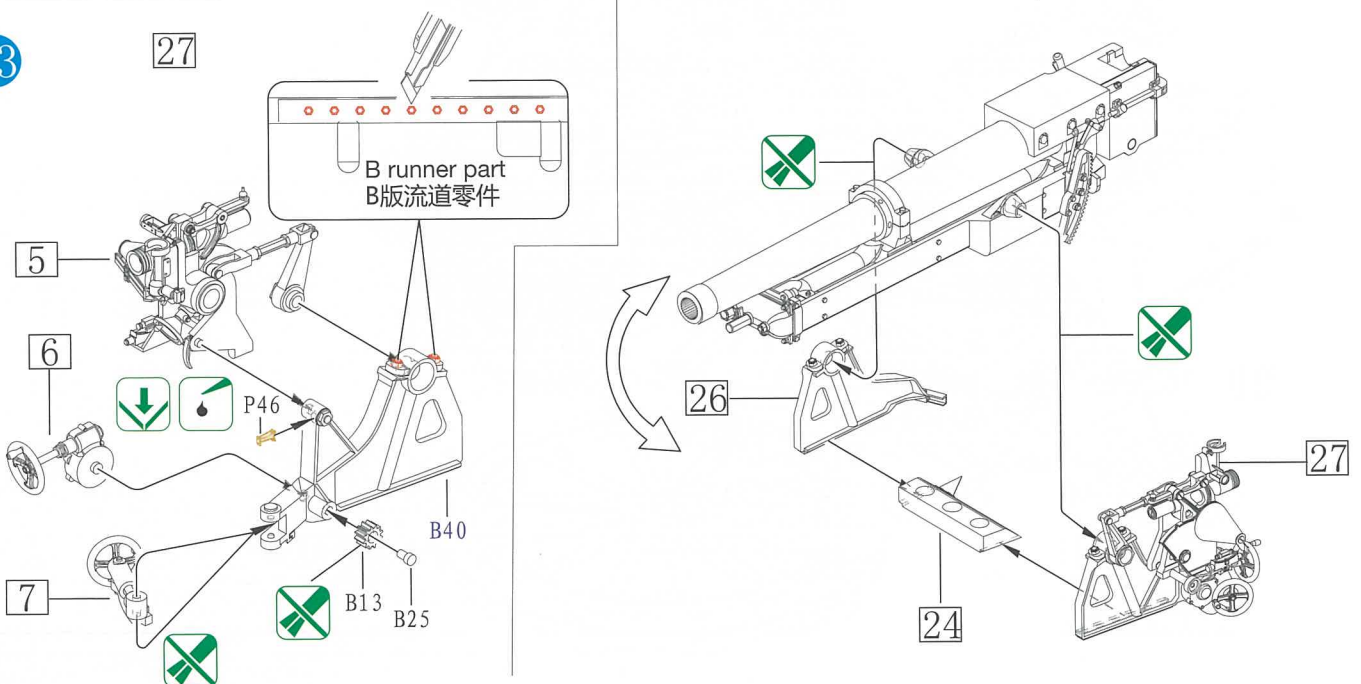

24

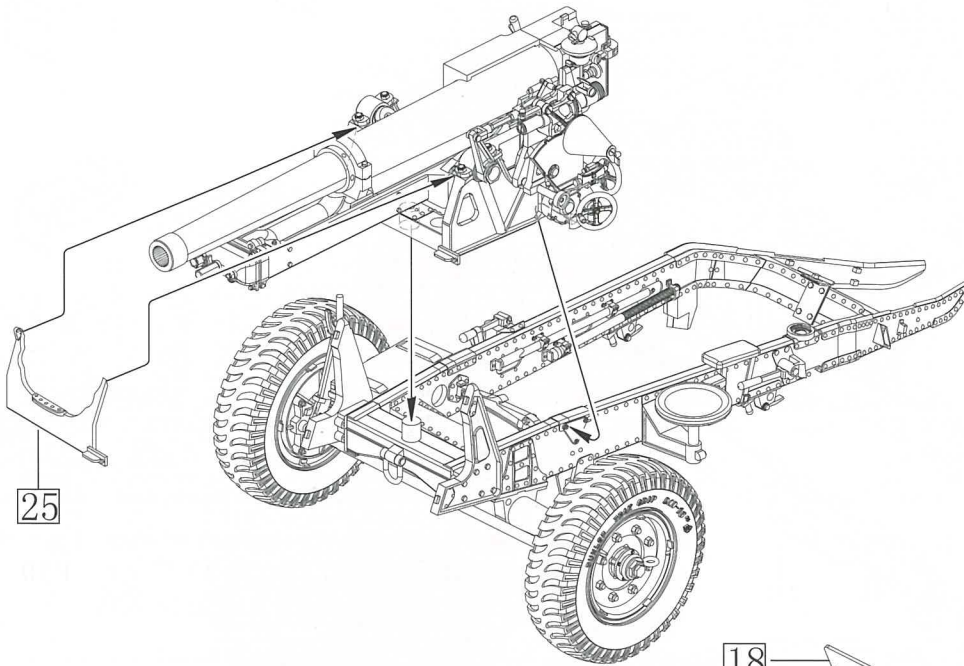

25

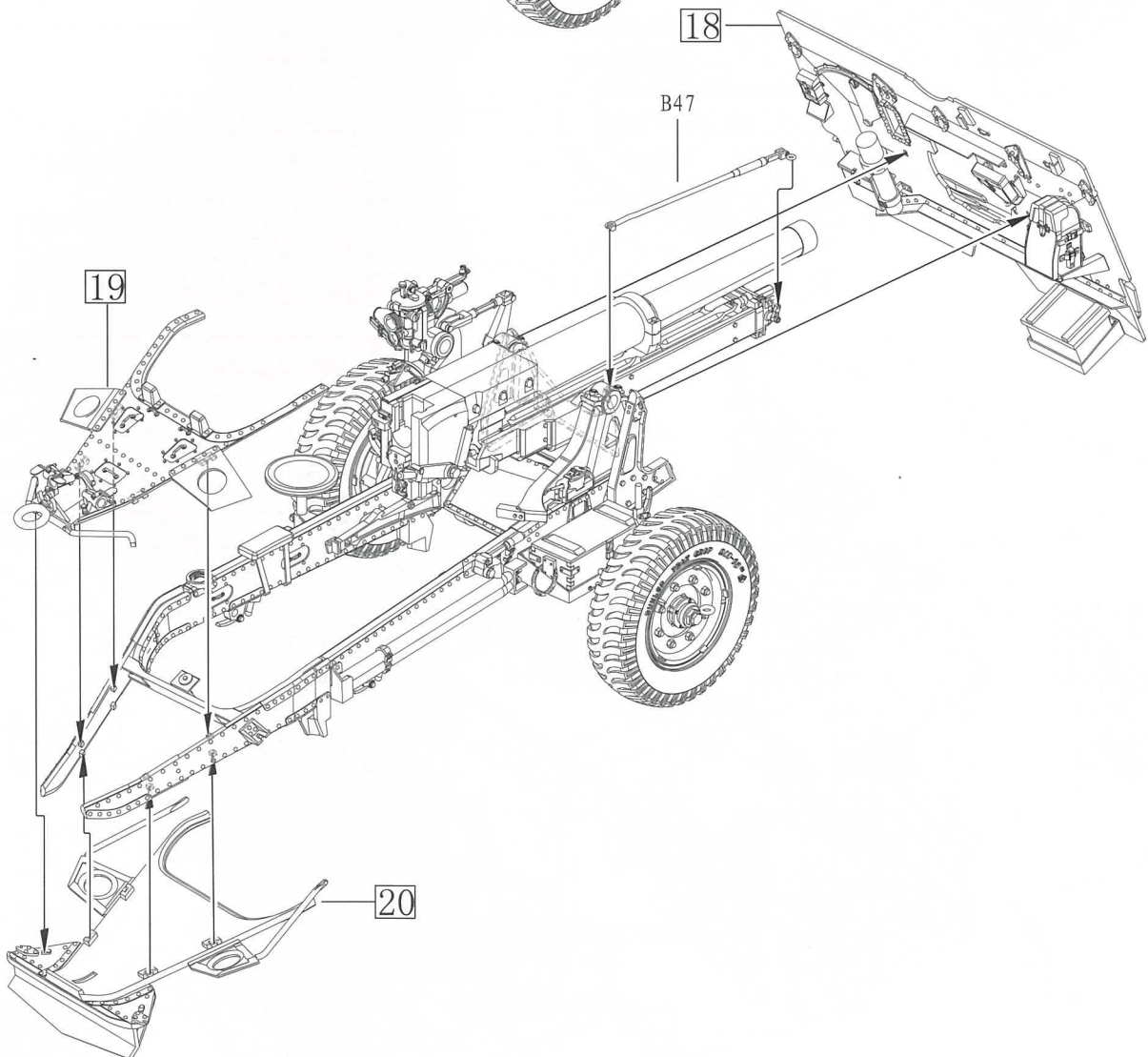

26

Transport position
运输状态

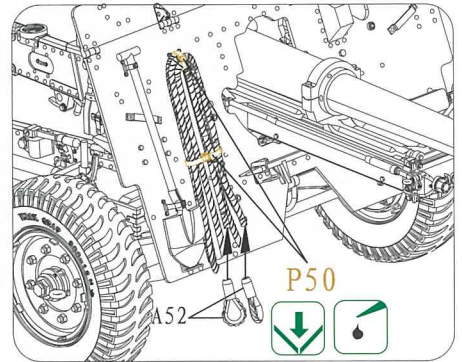
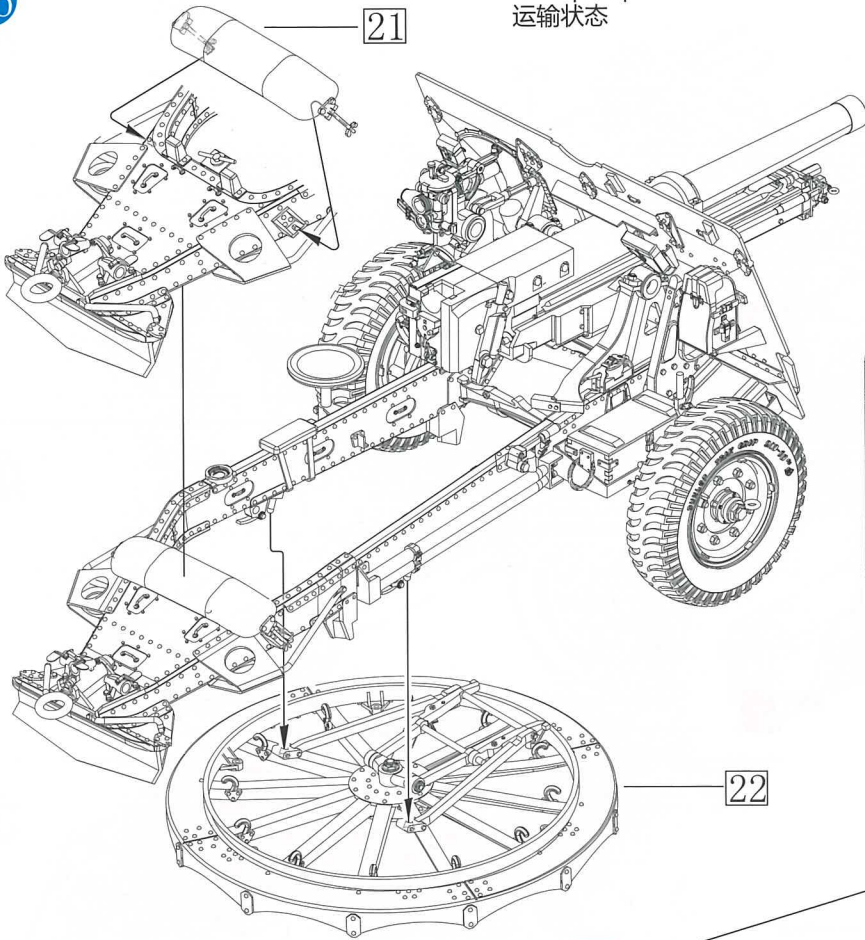

Fire position
发射状态

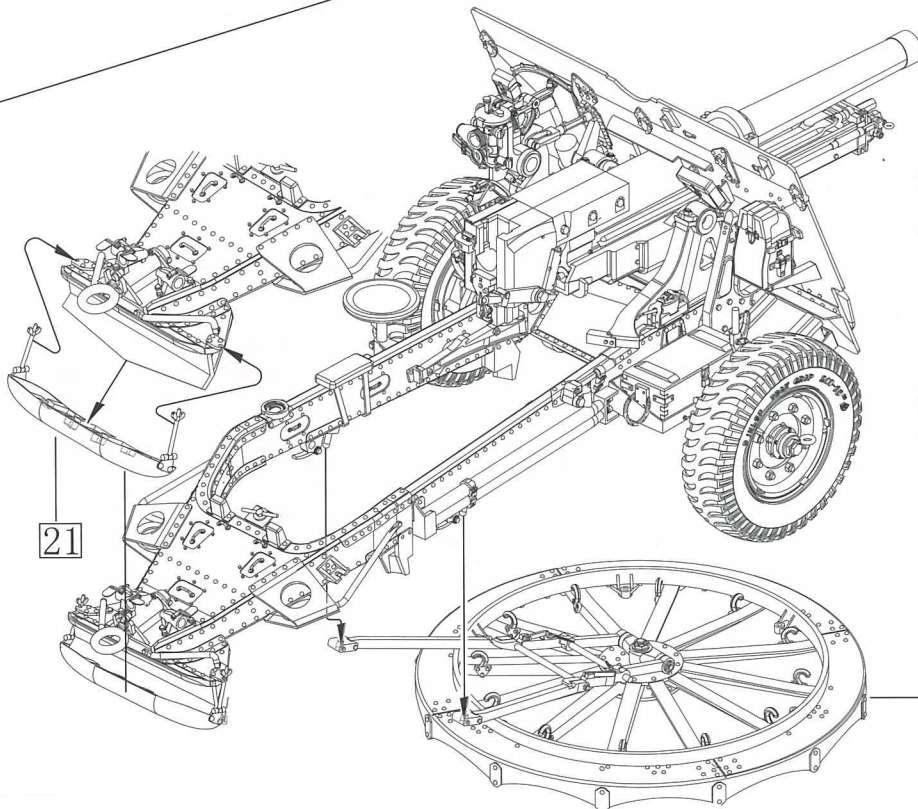

27

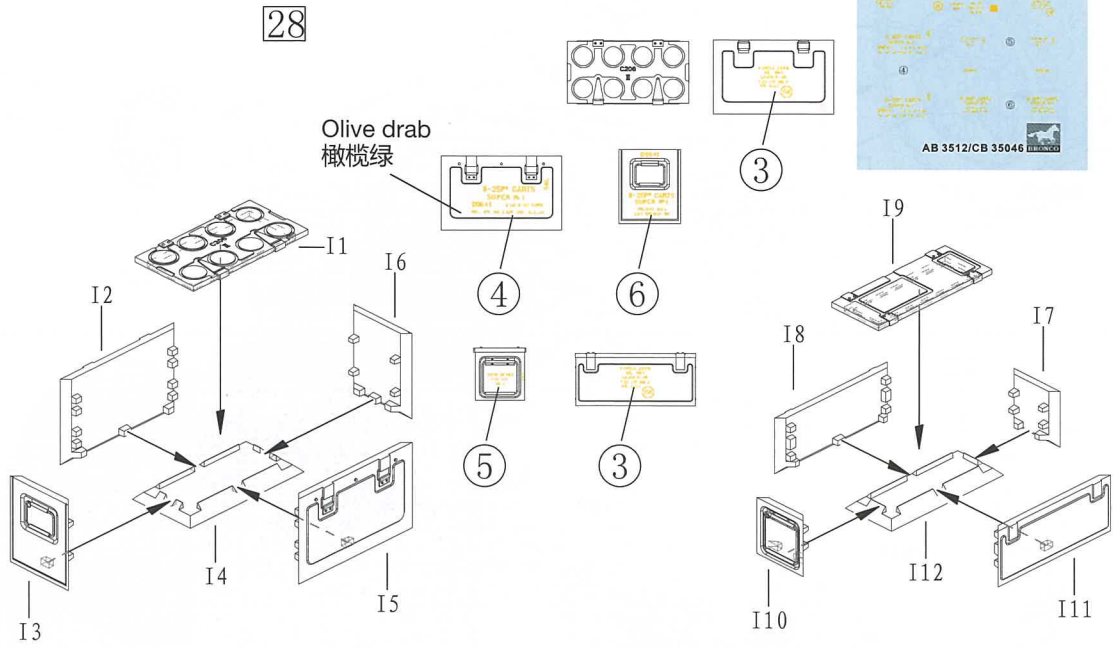

28

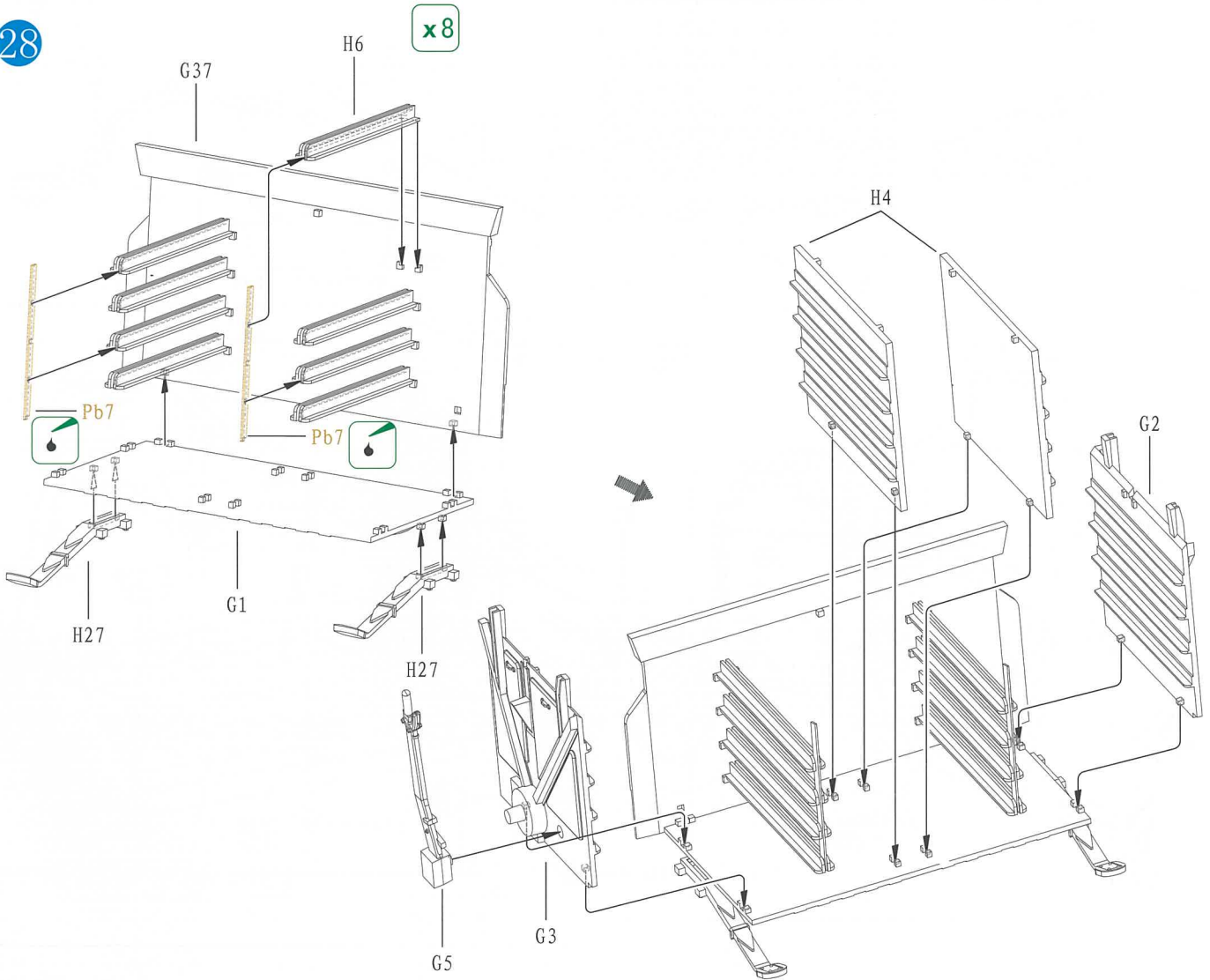
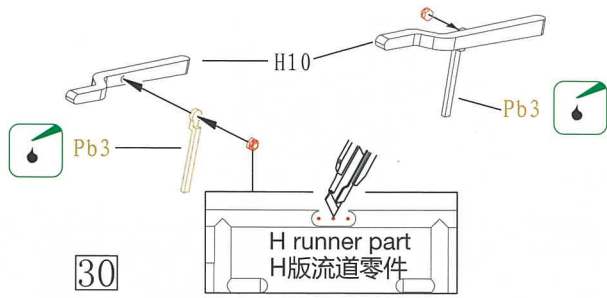
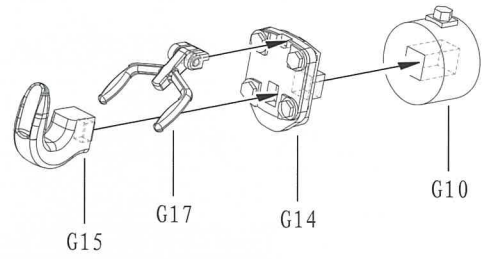

ILLUSTRATION 图示说明:

29



31



30

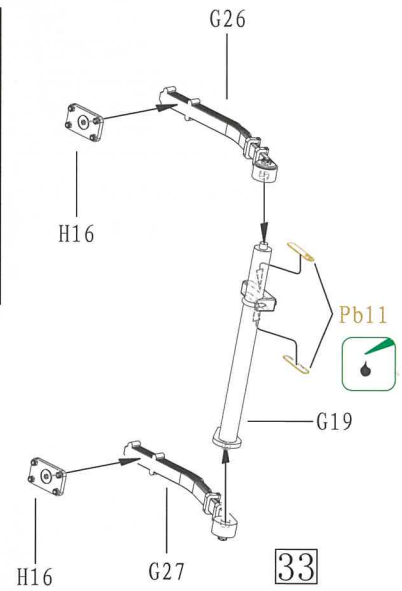
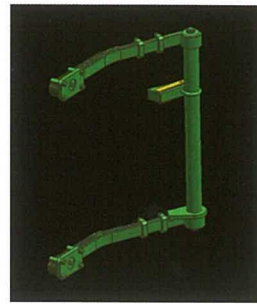
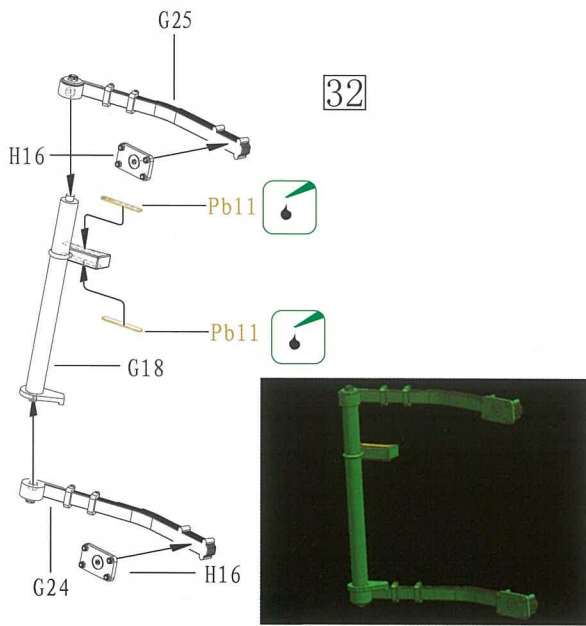

31

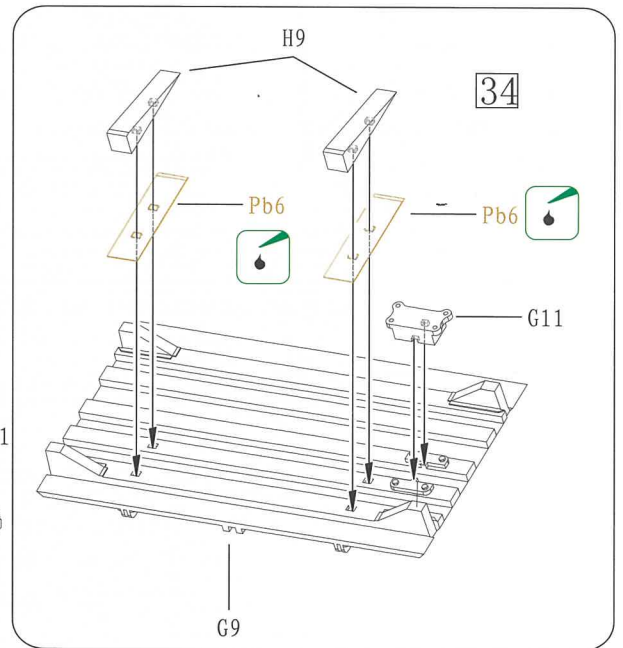
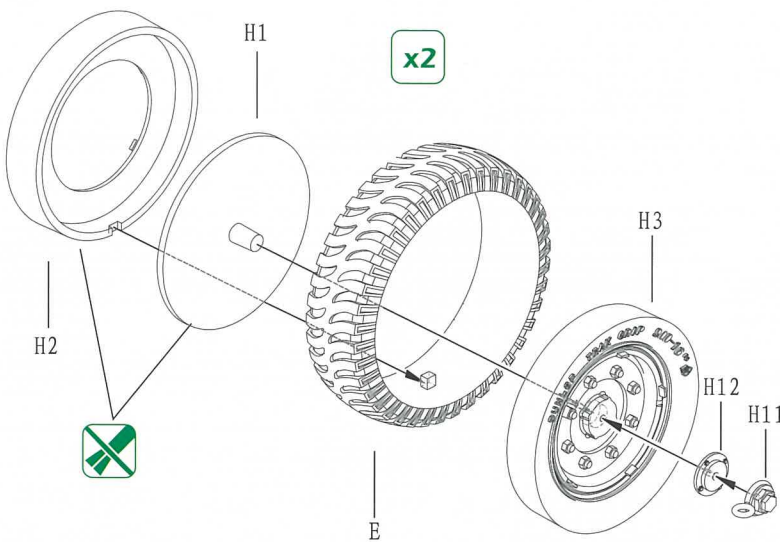

32

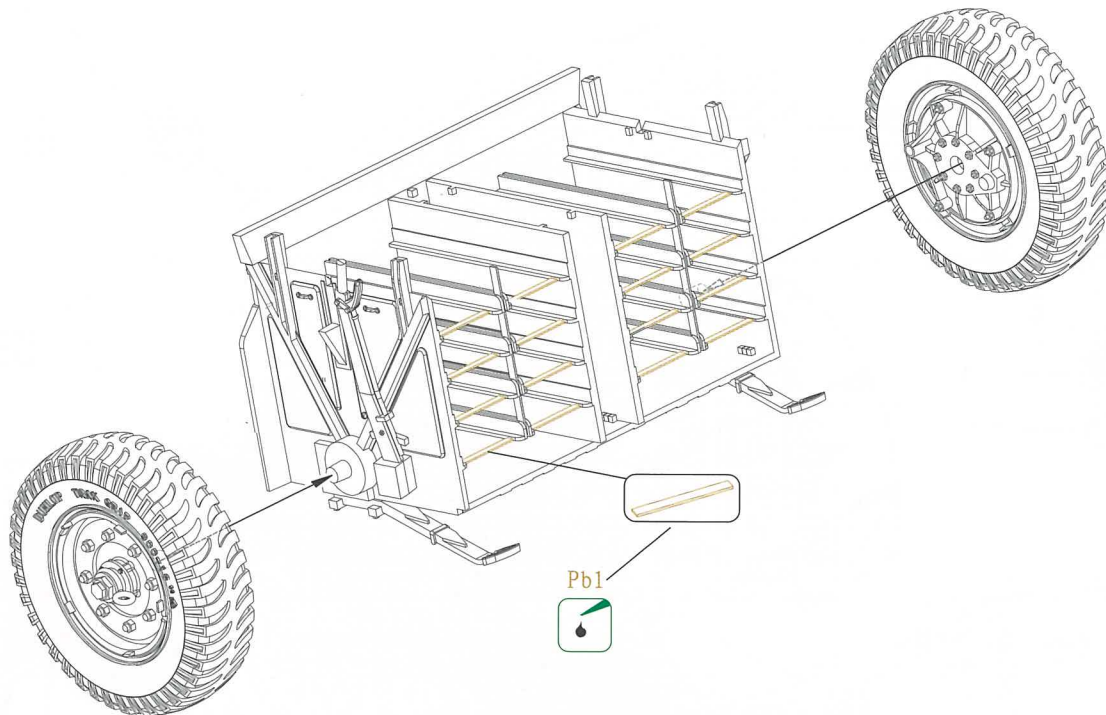

33

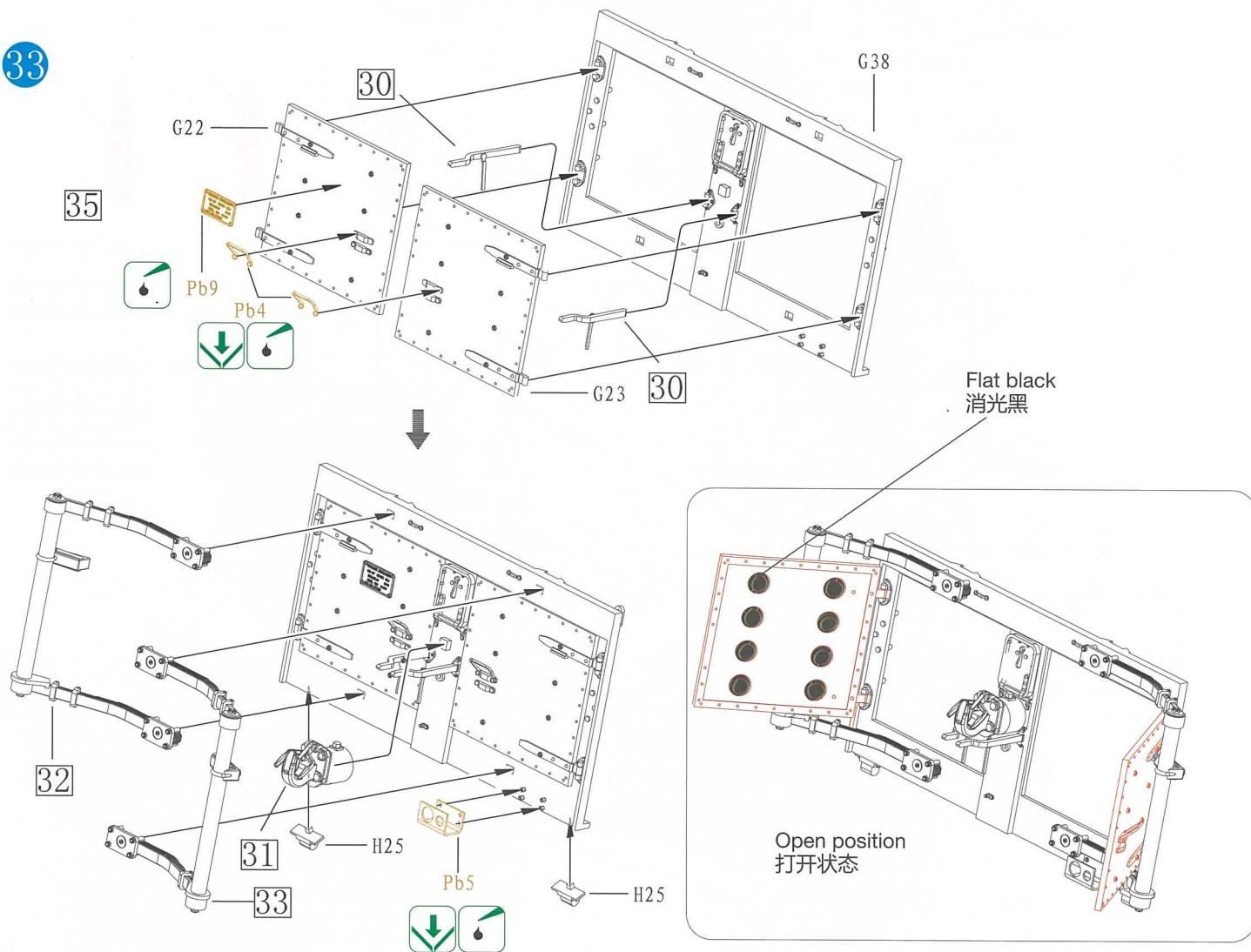

34

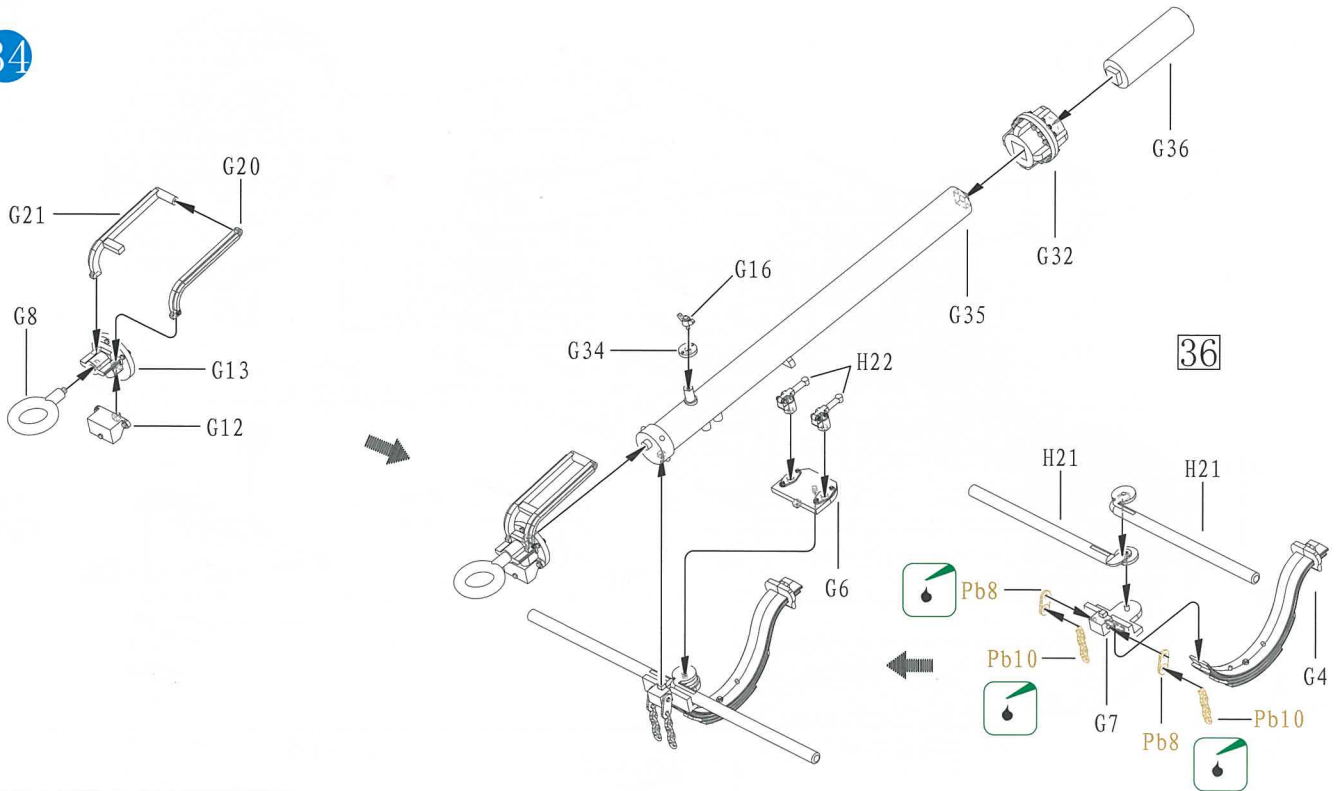

35

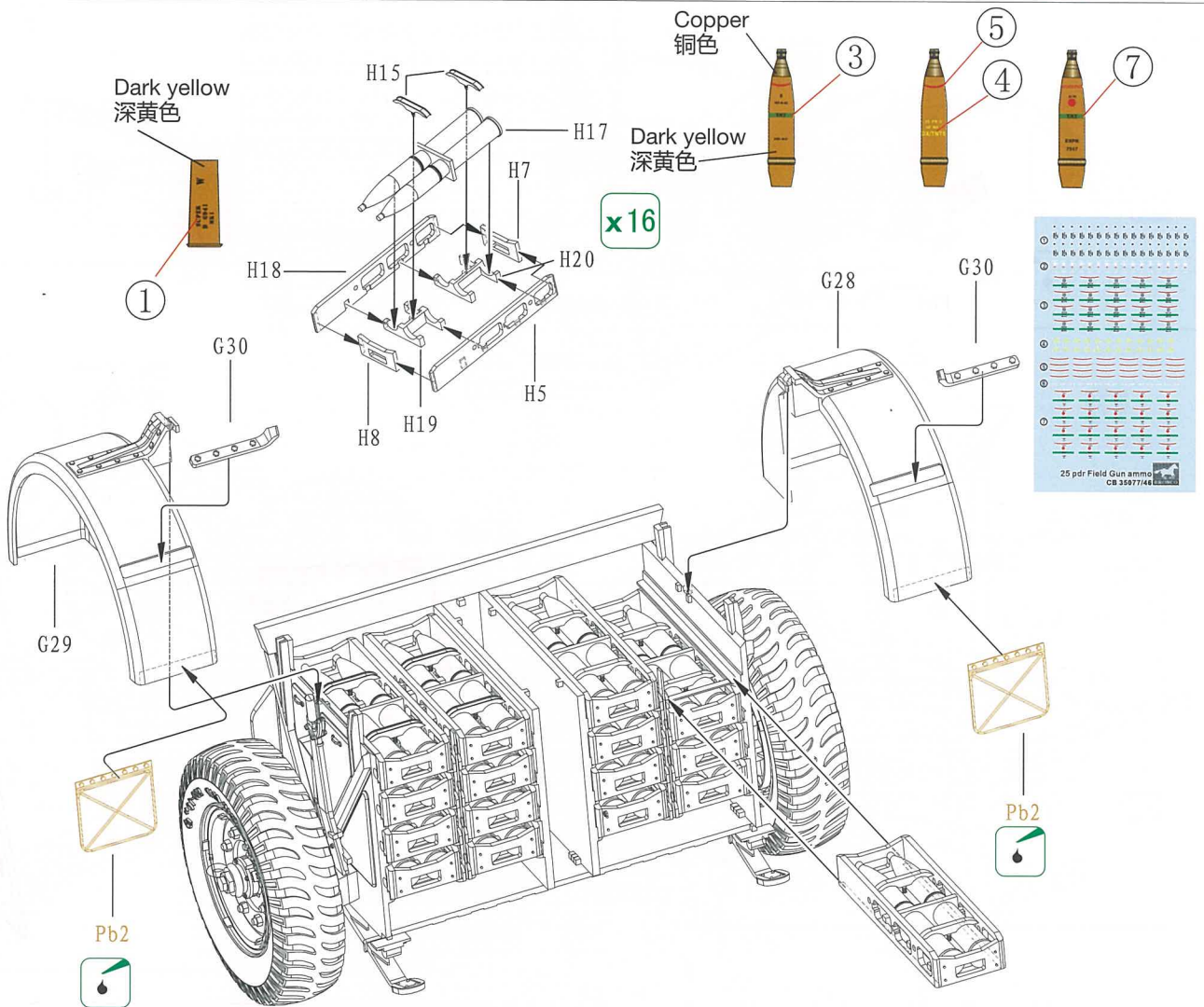

36

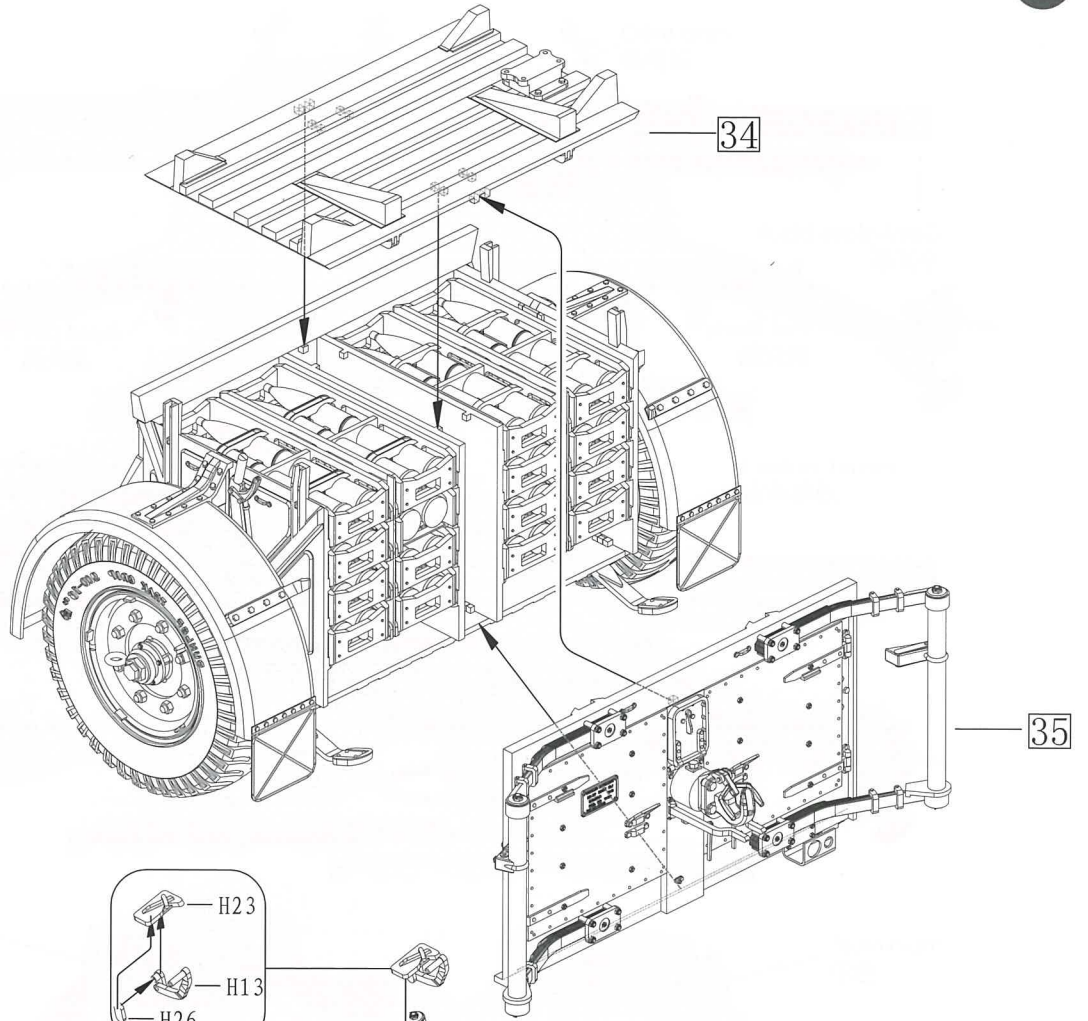

37

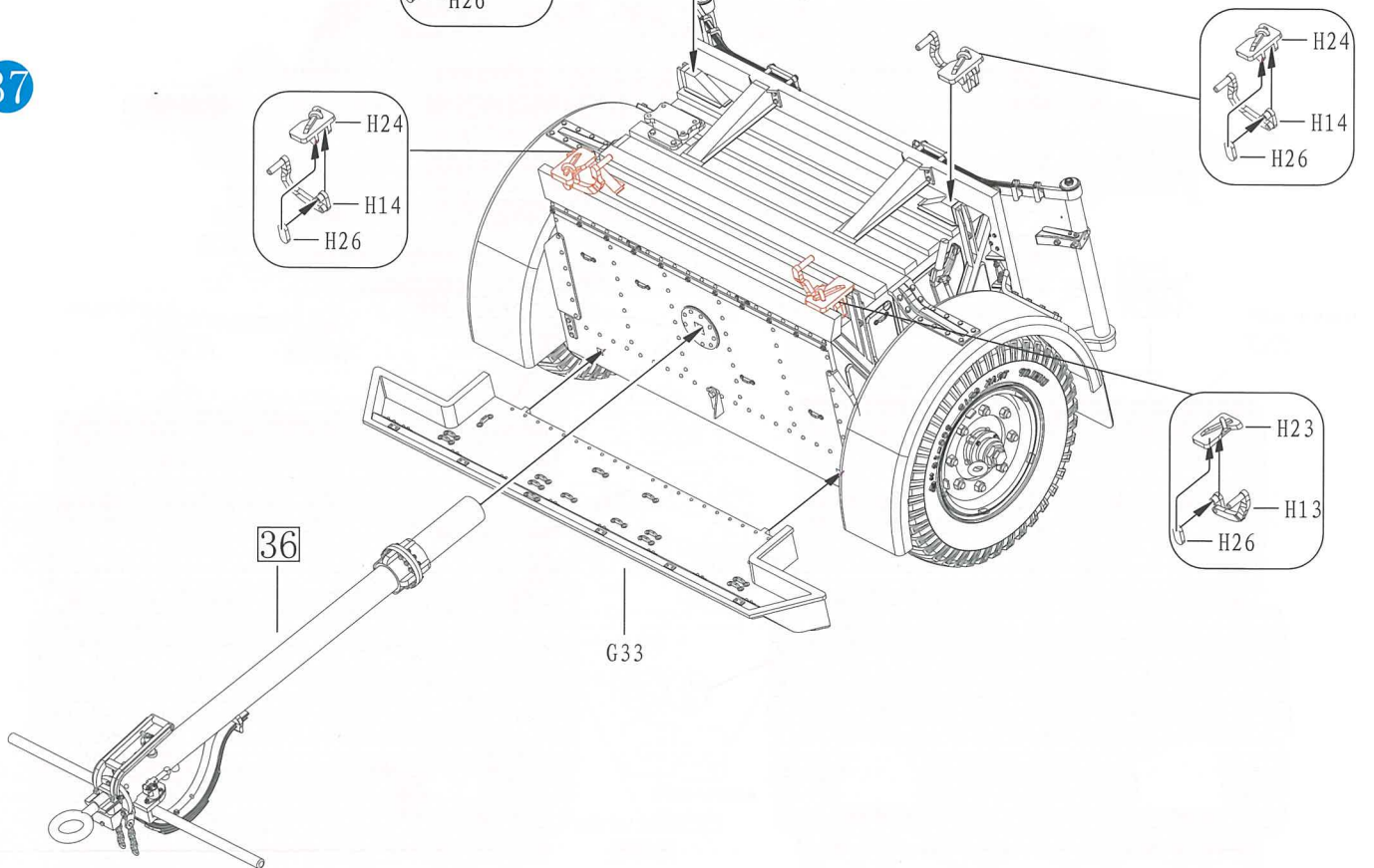

DECAL & COLOUR GUIDE 水贴及涂色指示:

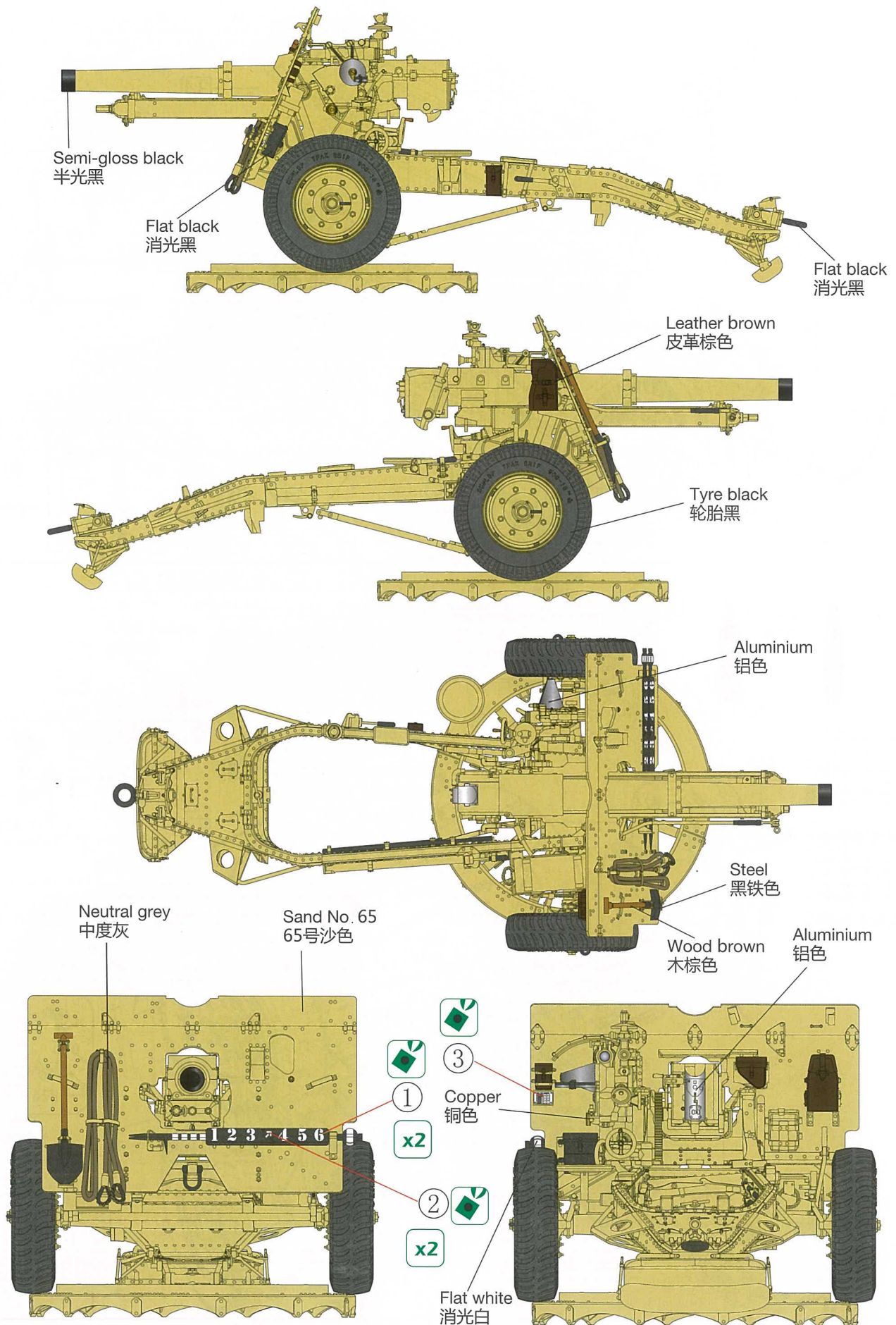

DECAL & COLOUR GUIDE 水贴及涂色指示:

Early version
早期型

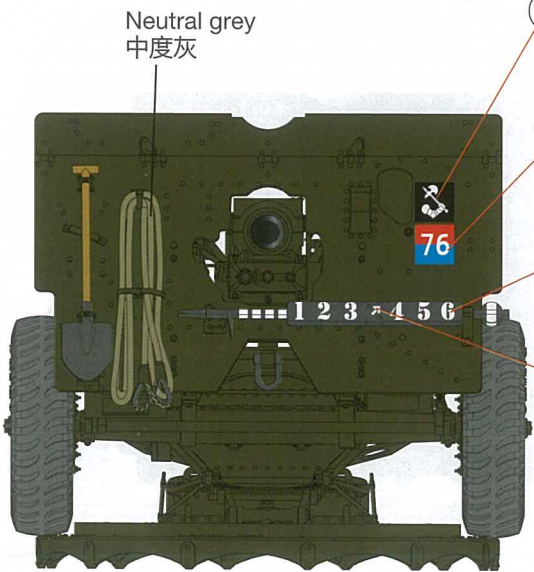
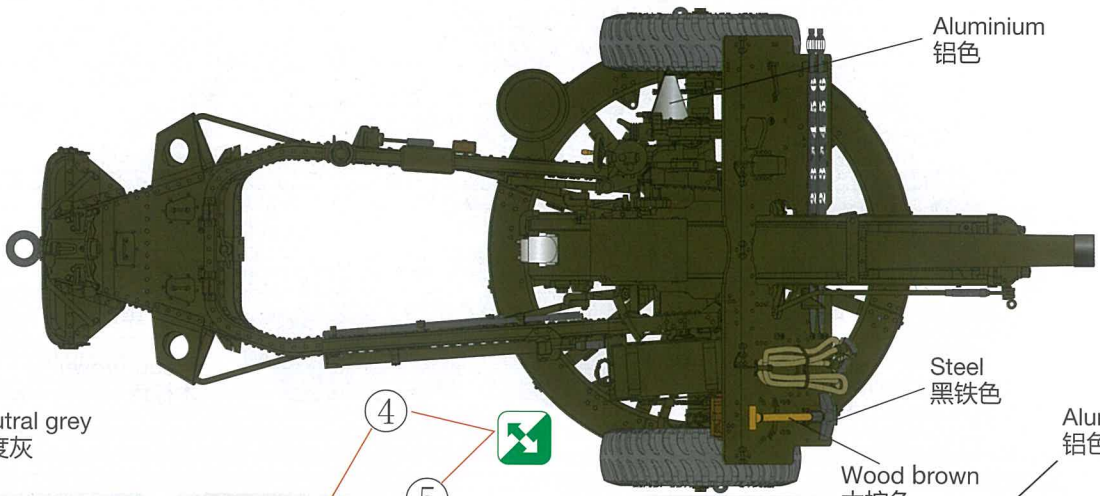
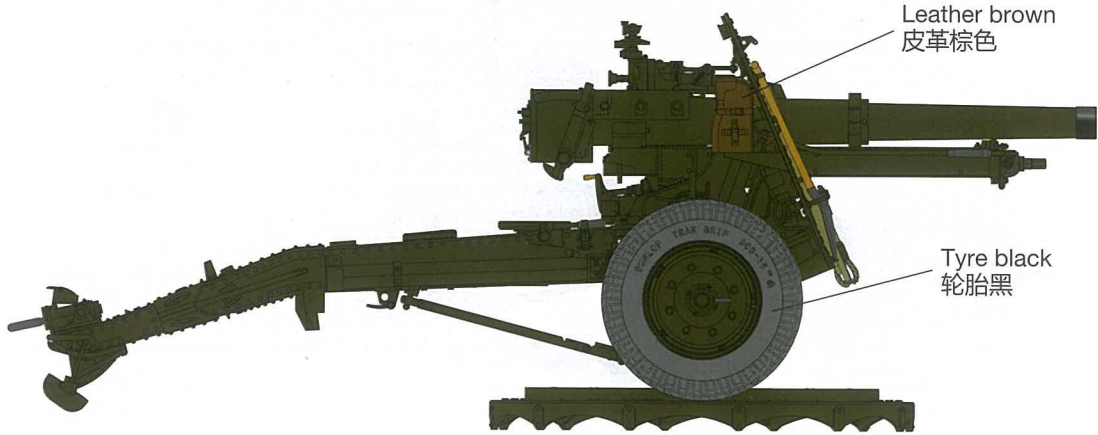
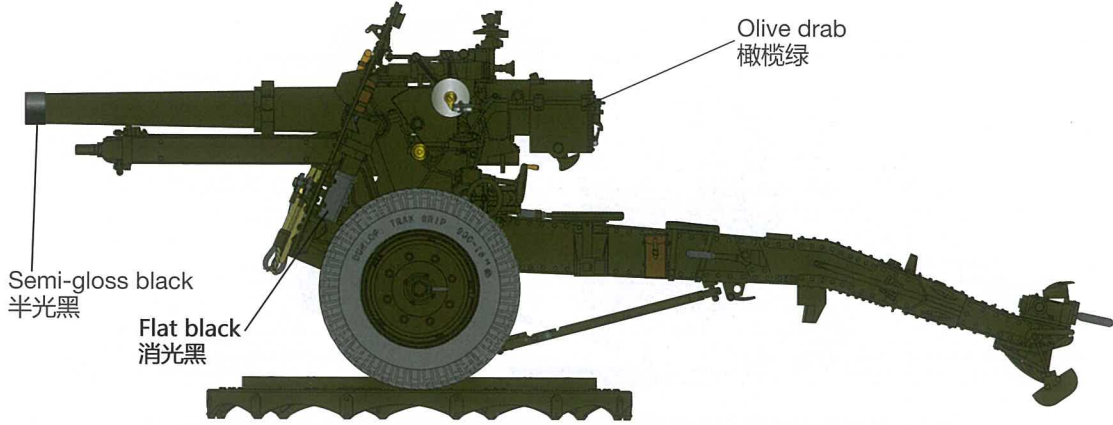

- ④
- ⑤
- ③
- ①
- x2
- ②
- x2

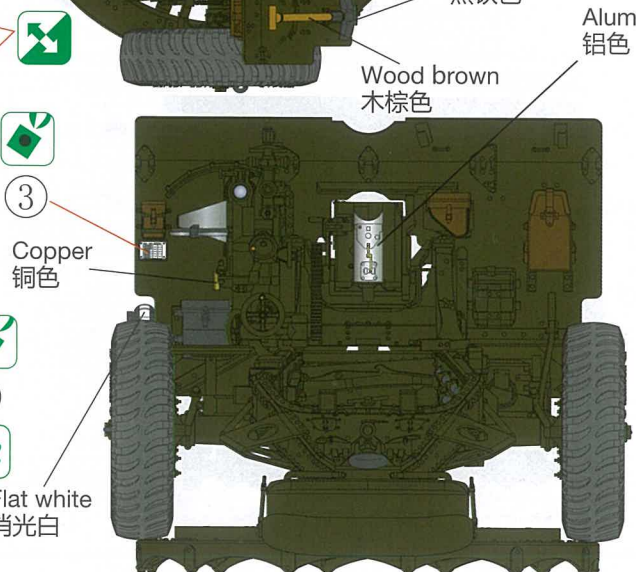

DECAL & COLOUR GUIDE 水贴及涂色指示:

Late version
后期型

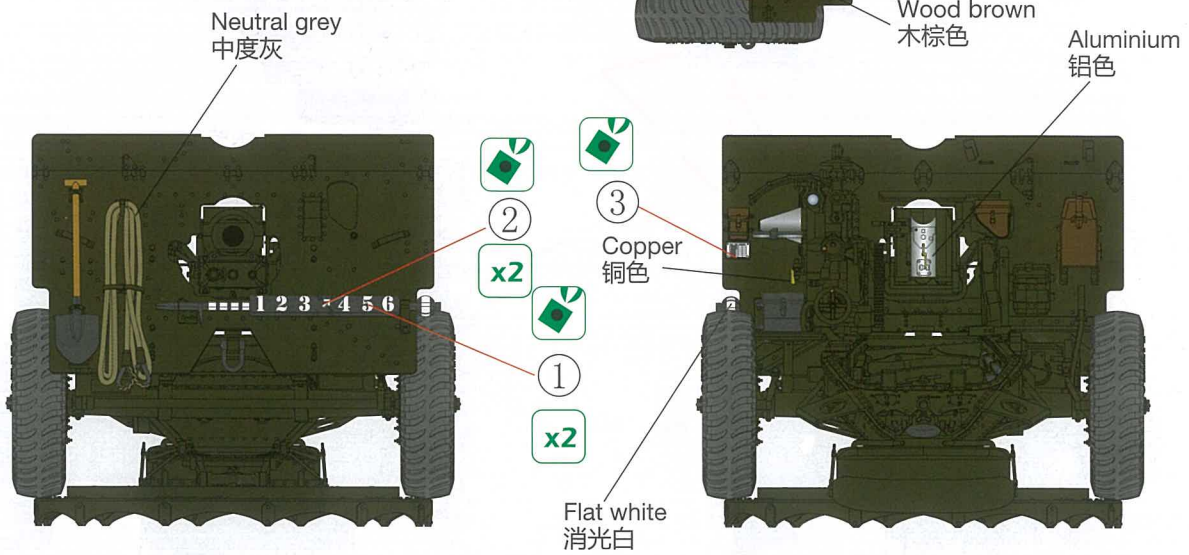
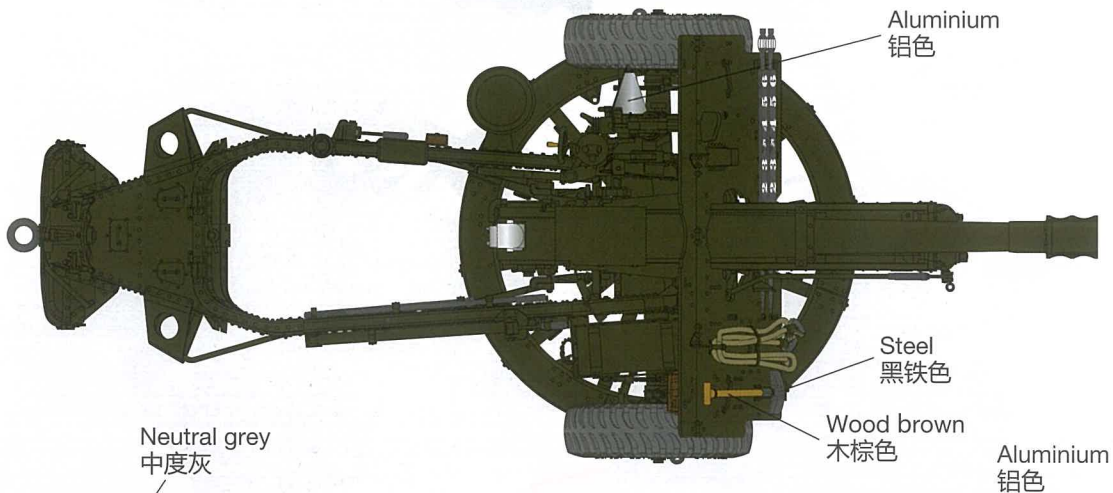
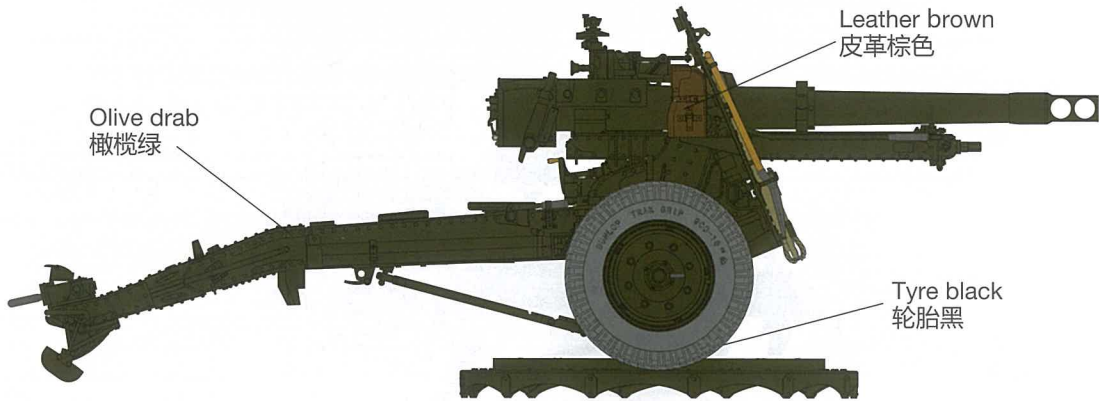
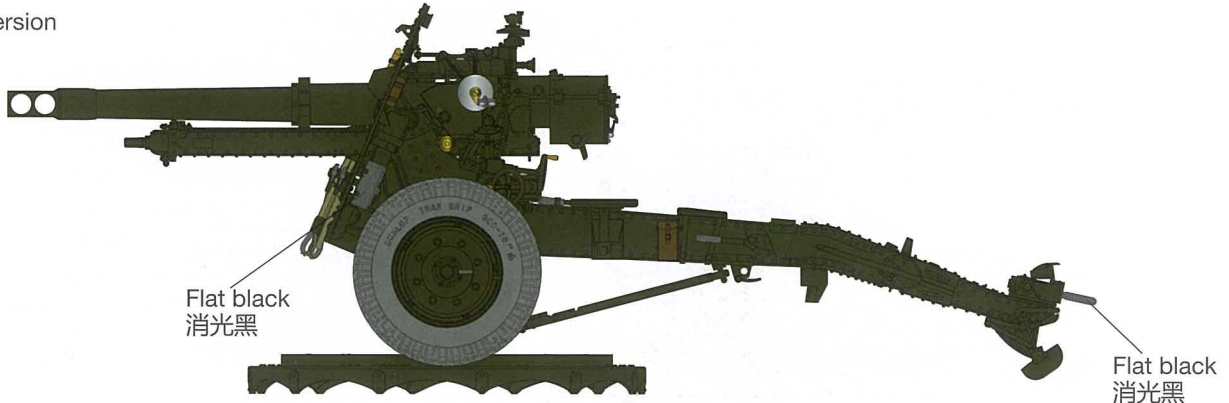

DECAL & COLOUR GUIDE 水贴及涂色指示:

Late version
后期型

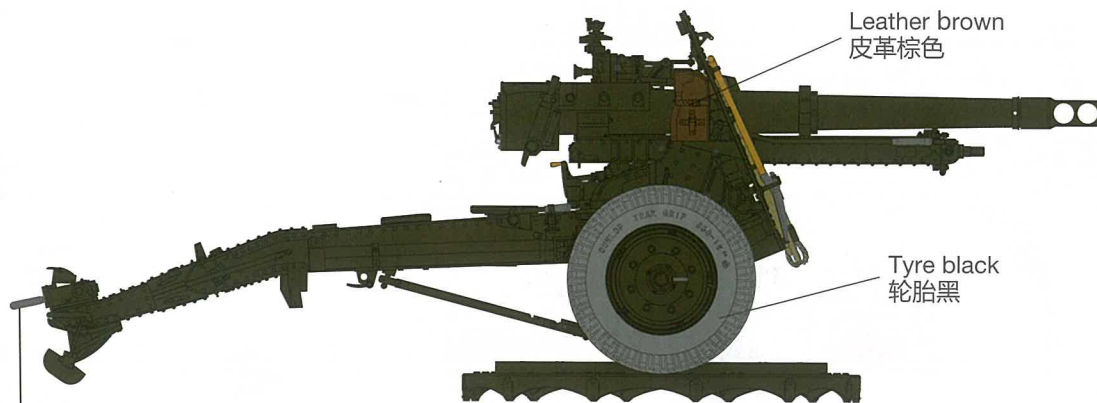

Flat black
消光黑

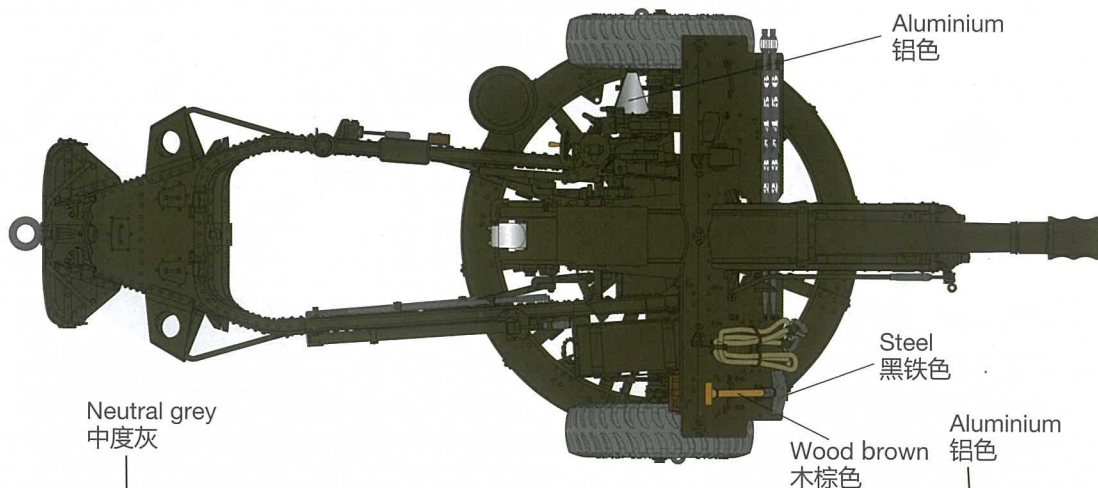
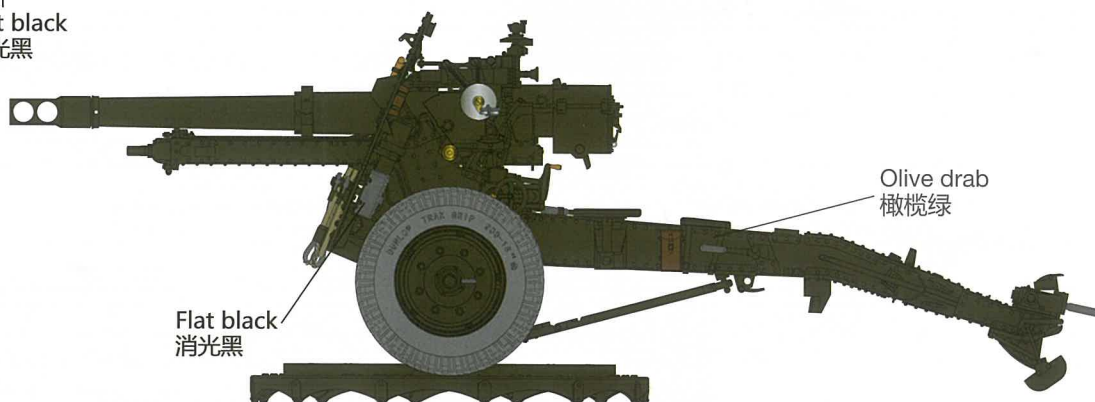

Neutral grey
中度灰

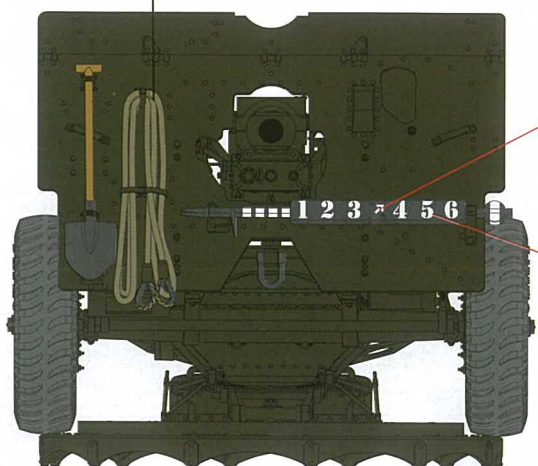

②

x2



③

x2

①

x2

Flat white
消光白

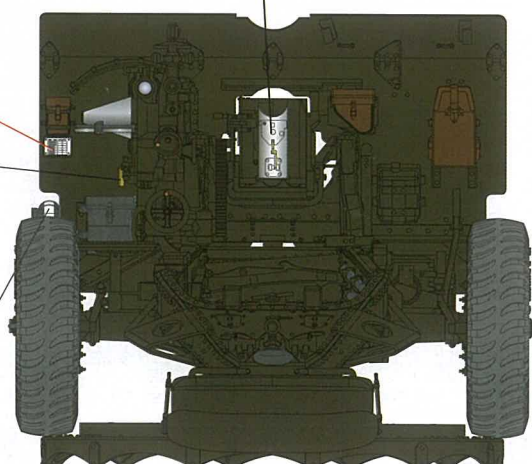

Copper
铜色

Flat white
消光白

★ We recommend the below book to your good partner when assembly our kit.

R 049

BRITISH 25PDR FIELD GUN

František Kořán, The Garrison

In Detail



BRITISH 25PDR FIELD GUN IN ARTILLERIEMUSEUM
BRASSCHAAT AND IN THE GARRISON COLLECTION

WWP[®]
WINGS & WHEELS
PUBLICATIONS

PHOTO MANUAL FOR MODELERS[®]

