



RS
MODELS

F-4/F-4A LIGHTNING 1/72 SCALE

The F-4 was a purpose built photographic reconnaissance version of the P-38 Lightning, built on the production line at the same time as the P-38E and F. The P-38E featured a revised nose wheel, which provided more space for gun ammunition. The same space allowed Ninety nine F-4-1s were built, based on the P-38E. They carried two K-17 fixed vertical cameras in place of the guns. Unlike the standard P-38E, the F-4-1 could carry external fuel tanks. The F-4-1 was the first version of the Lightning to see active service, with the 8th Photo Reconnaissance Squadron in Australia, beginning in April 1942.

Twenty F-4As were built, based on the P-38F airframe. They could carry a wider range of cameras than the F-4-1, including forward and side mounted oblique cameras. Different aircraft carried different combinations of cameras and had different camera windows built into the nose.

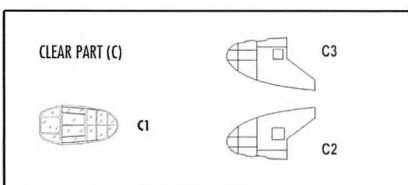
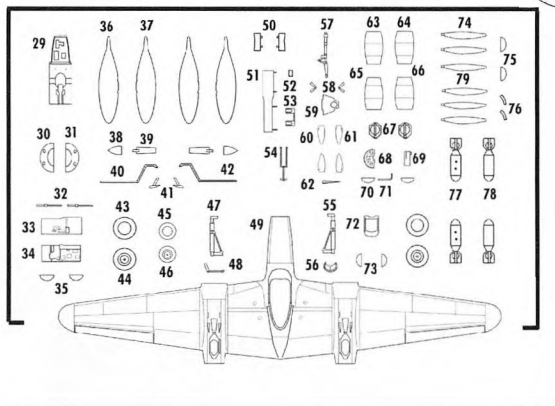
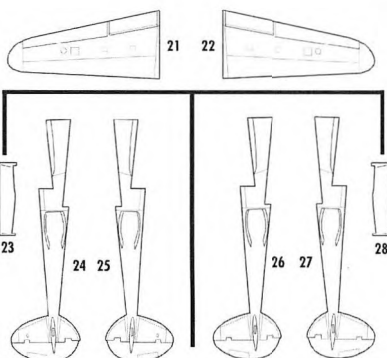
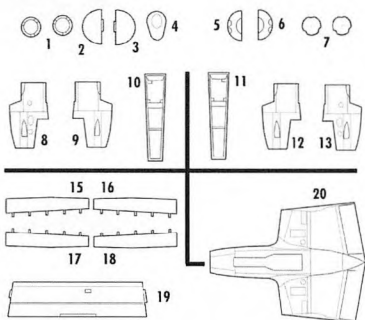

COLORS

a Černá Black	h Červená Red
b Interiér: žlutá Zinc Chromate	i Bílá White
c Stříbrná Silver	j Žlutá Yellow
d Plátno Linen	k Pneumatiky Tyres Black
e Kůže Leather	l Rzezář Rust
f Hliníková Aluminium	m Tmavě šedá Dark Grey
g Chromová Chrome	n Kovová Gun metal

LEGEND



ohnout bend vtřínové lepidlo cyanoacrylate glue odstranit remove upravit reduce vrtat open hole vyřebit scotch build obtlisk decal barva color film

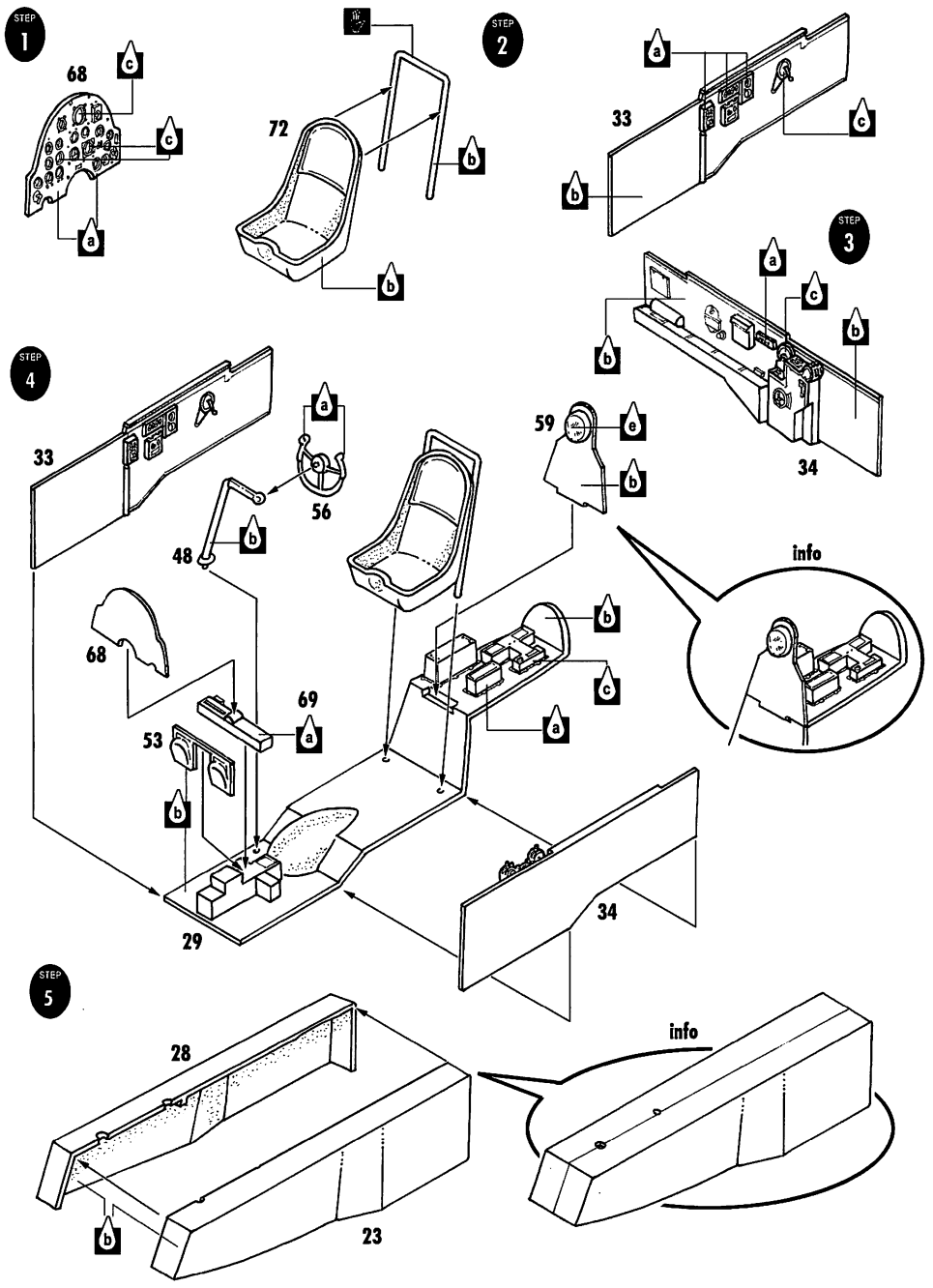

STEP 6

zatemelit / putty



vyrobit
scrach build



u obtiskové verze
Foto Jo
decal version



upravit
reduce

(WEIGHT)



upravit
reduce

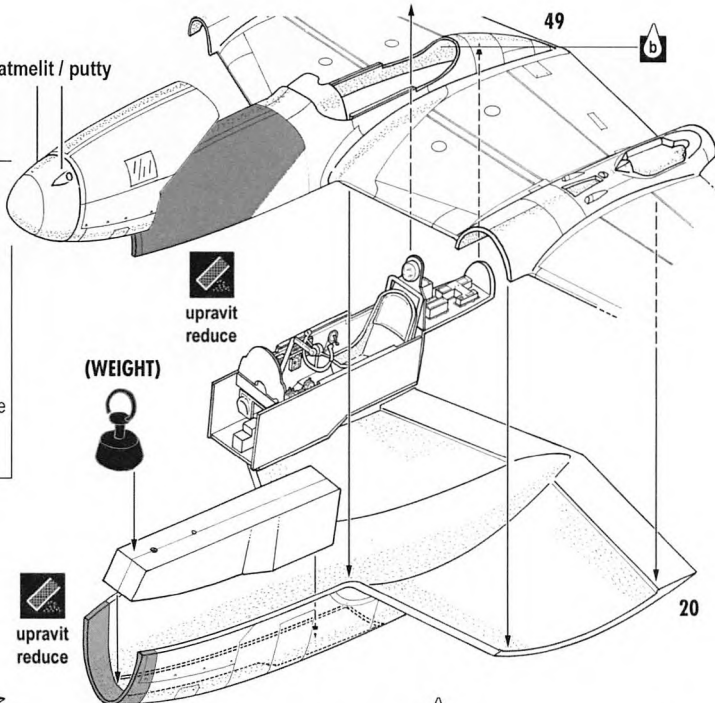

64

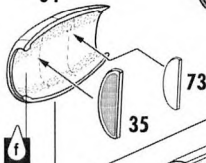

24

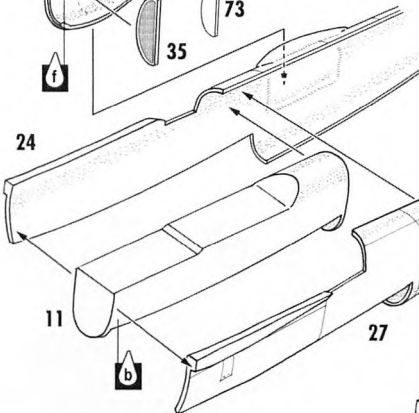

11

27

a

35

a



63

(LEFT TAIL STRUCTURE)

STEP 8

66

f

a

75

70

70

65

26

10

b

25

f

STEP 7

(RIGHT TAIL STRUCTURE)

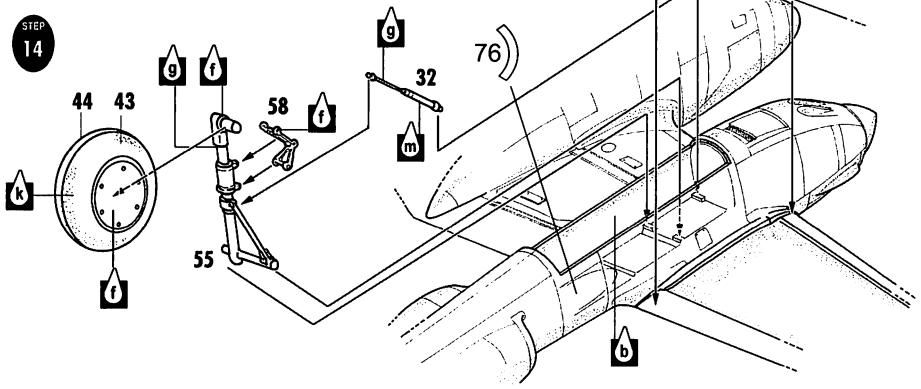
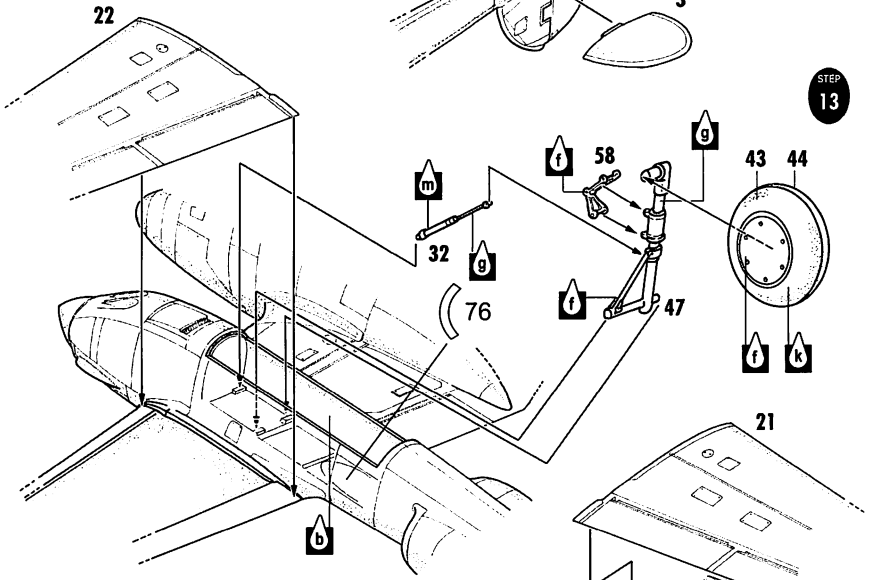
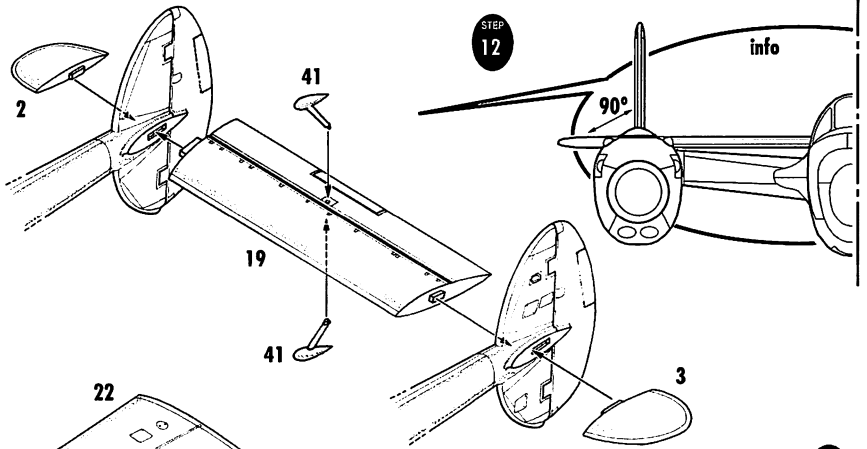

STEP 15

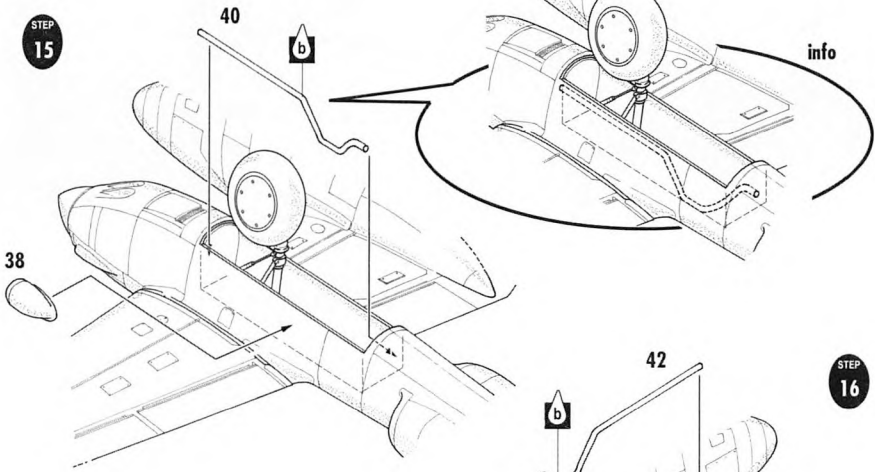

STEP 16

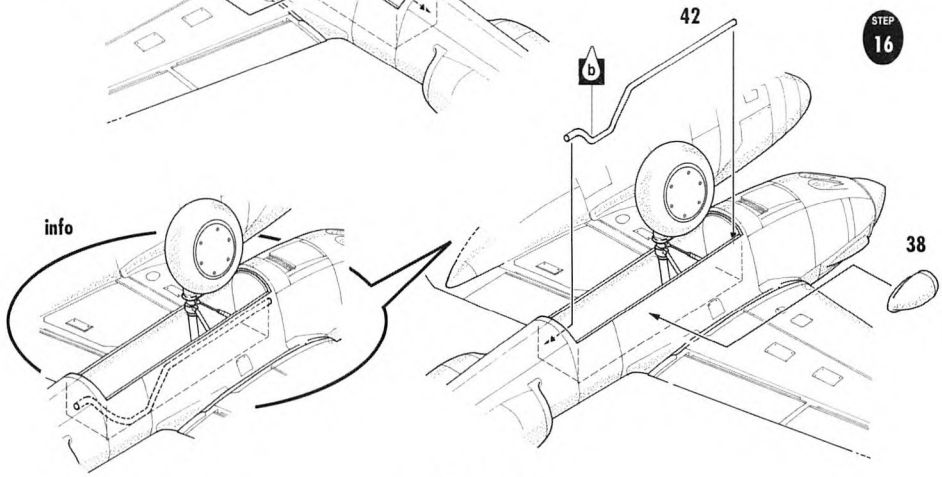

STEP 17

STEP 18

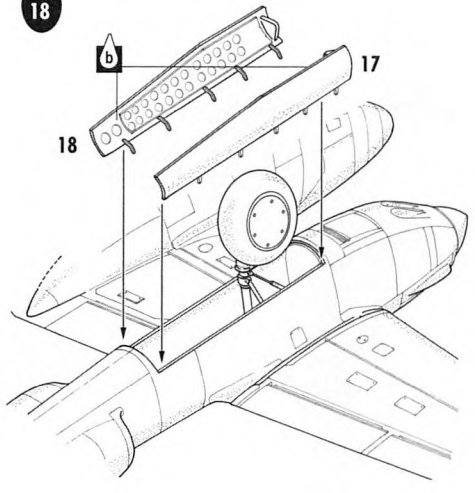
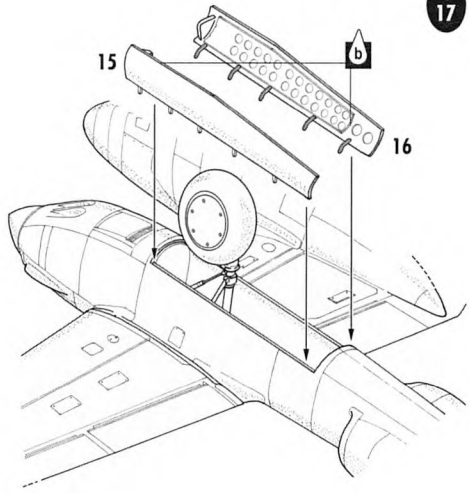

Drop tanks position

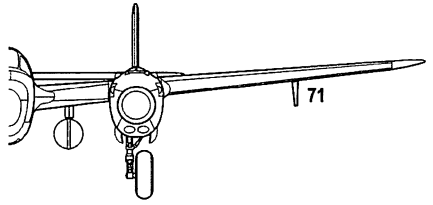
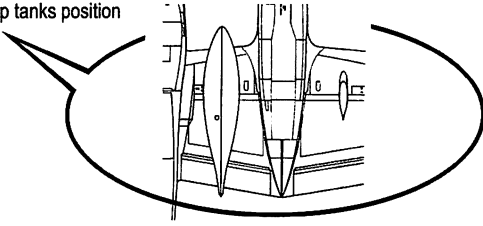

STEP 19

?

STEP 20

?

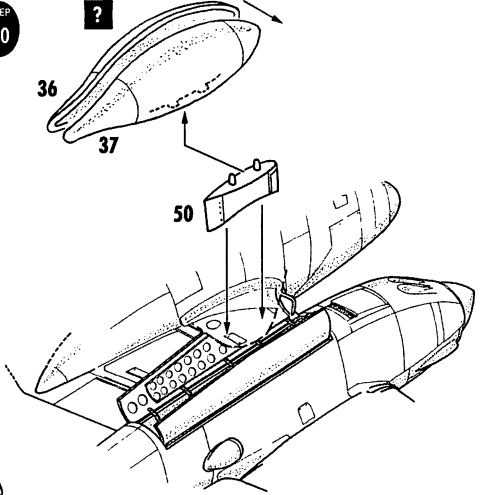
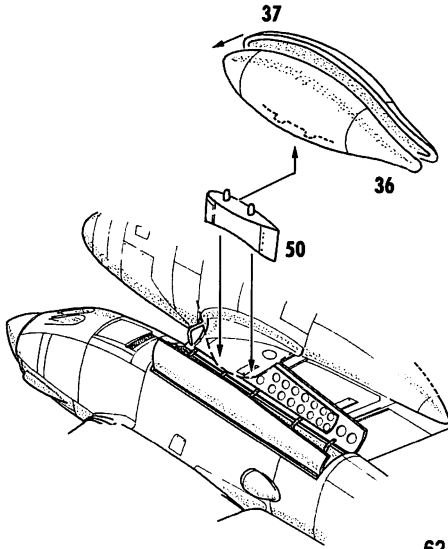

STEP 21

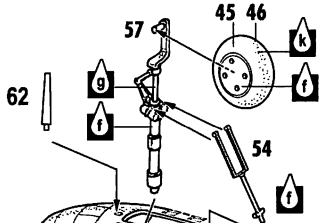

STEP 22

CP1

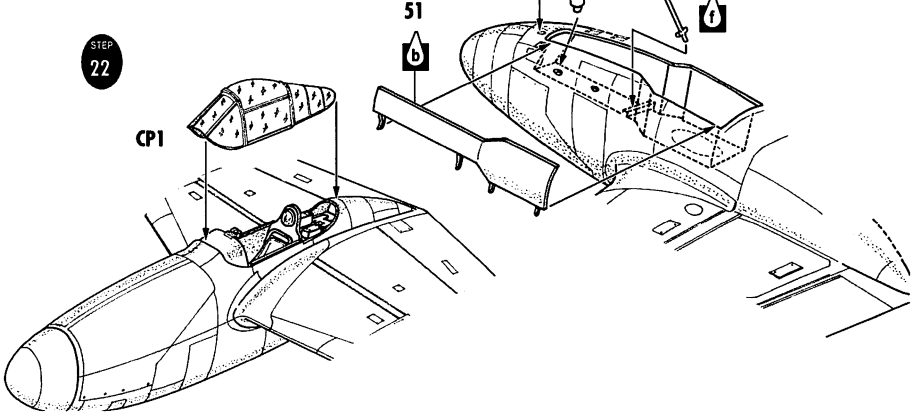

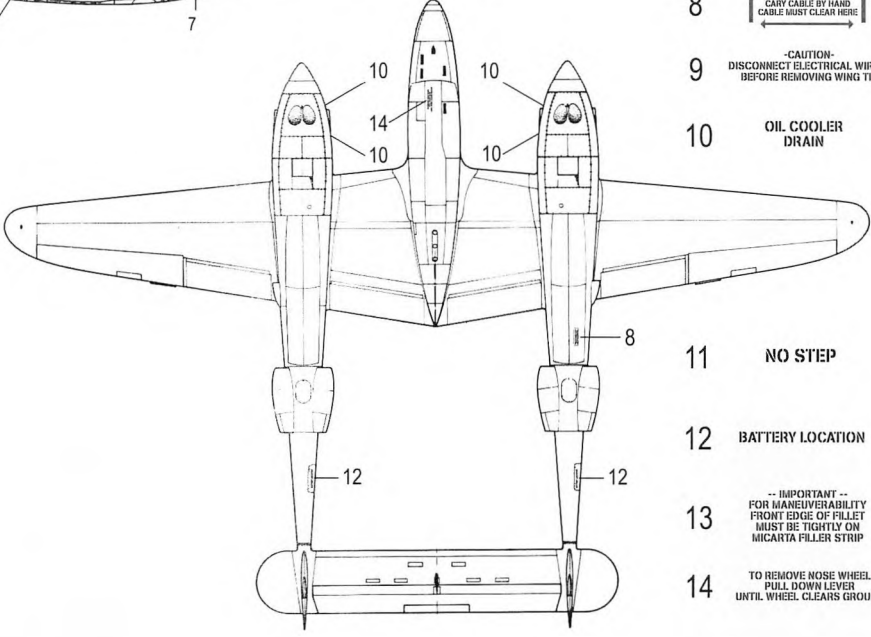
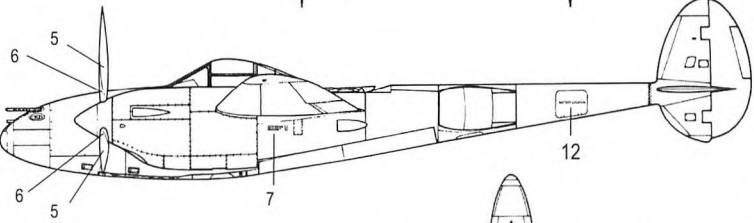
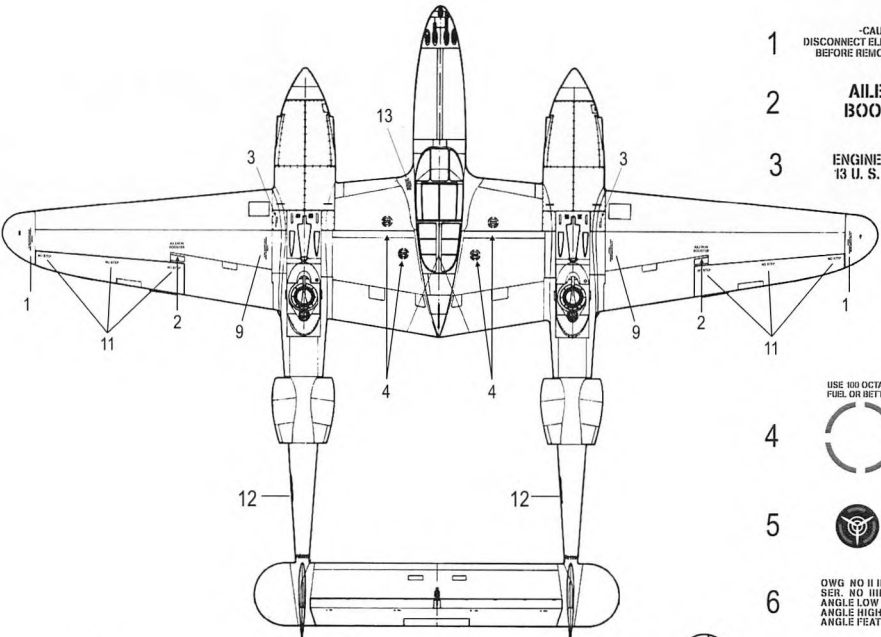

1 -CAUTION-
DISCONNECT ELECTRICAL WIRING
BEFORE REMOVING WING TIP

2 **AILERON
BOOSTER**

3 **ENGINE OIL
13 U. S. GALLONS**

USE 100 OCTANE
FUEL, OR BETTER



6 **OWG NO II III IIII
SER. NO IIII II IIII
ANGLE LOW 23.0
ANGLE HIGH 27.7
ANGLE FEATHER 87.5**

7 **FURTHEST FORWARD LOAD 148.10
GROSS WT. WHEELS DOWN 151.85
GROSS WT. WHEELS UP 154.71
FURTHER AFT LOAD 26.10**

8 **WHEN REMOVING BATTERY
CARRY CABLE BY HAND
CABLE MUST CLEAR HERE**

9 -CAUTION-
DISCONNECT ELECTRICAL WIRING
BEFORE REMOVING WING TIP

10 **OIL COOLER
DRAIN**

11 **NO STEP**

12 **BATTERY LOCATION**

13 **-- IMPORTANT --
FOR MANEUVERABILITY
FRONT EDGE OF FILLET
MUST BE TIGHTLY ON
MICARTA FILLER STRIP**

14 **TO REMOVE NOSE WHEEL
PULL DOWN LEVER
UNTIL WHEEL CLEARS GROUND**

① F-4A-1-LO, 3rd Photo Group, Laghouat, Algeria, April 1943

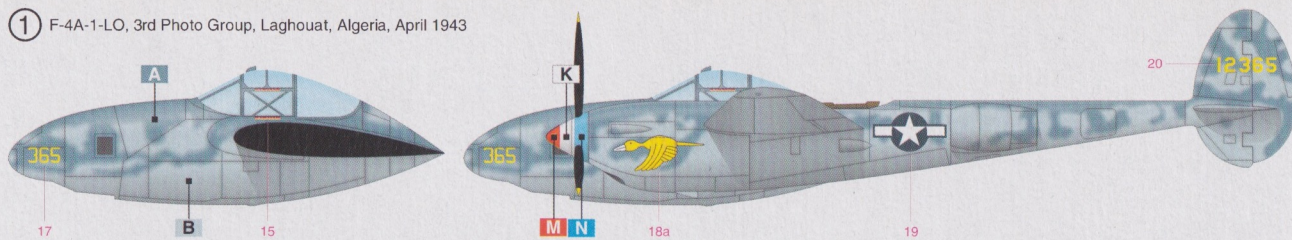

② F-4-LO, of No 1 PRU, RAAF, Coomalie Creek, Australia, 1943

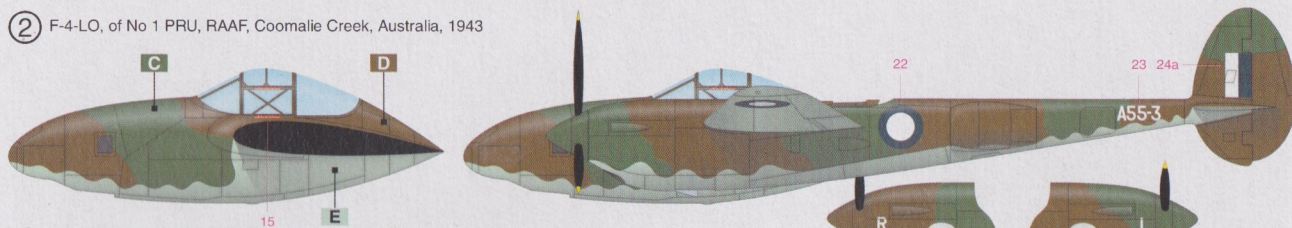

③ F-4-LO, of 8PRS, Port Moresby, 1943. Later No.75 Sq, RAAF

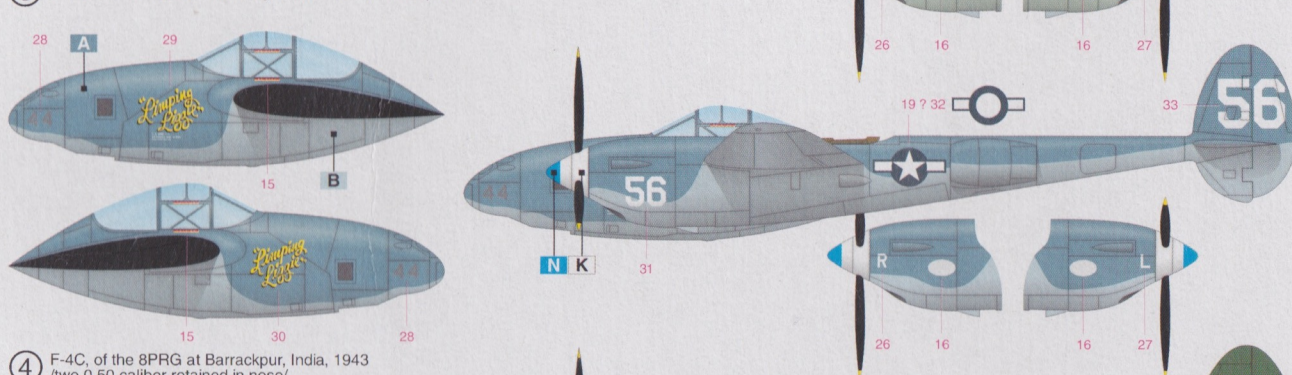

④ F-4C, of the 8PRG at Barrackpur, India, 1943
/two 0.50 caliber retained in nose/

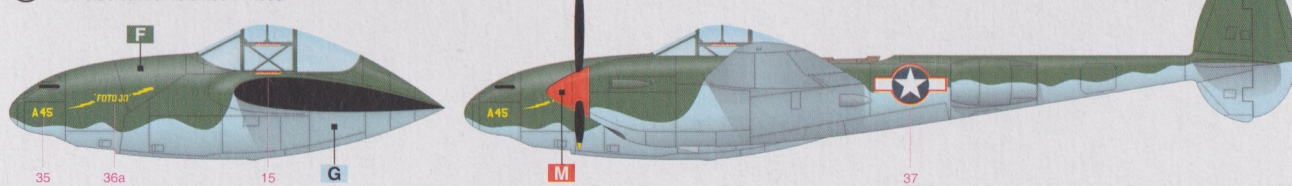

⑤ F-4-1-LO, armament replaced by K17 cameras, North Africa, January 1943

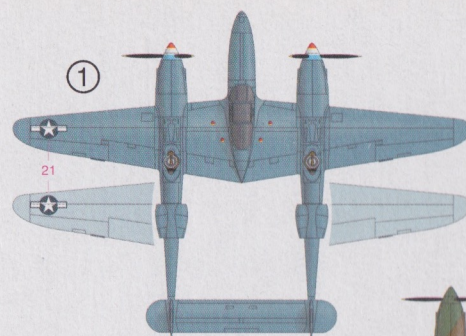
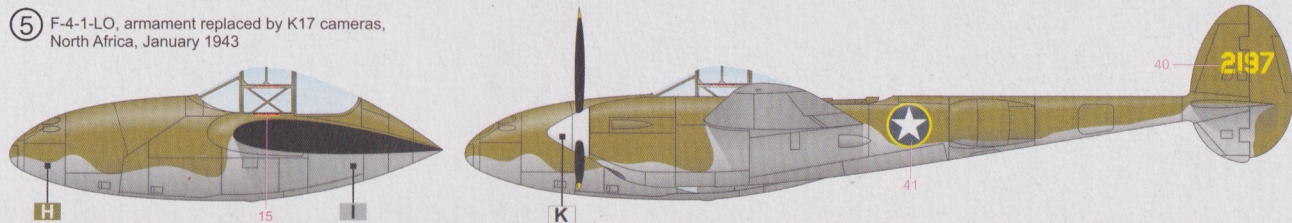

- H** Olive Drap
- I** Neutral Gray
- J** Světle šedá / Light Grey
- K** Bílá / White

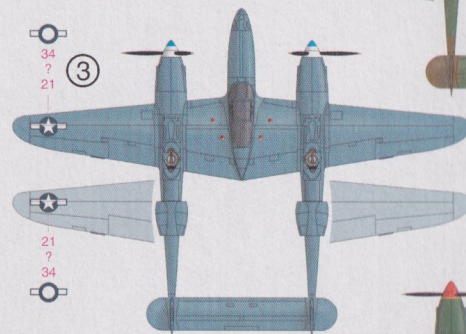

- L** Žlutá / Yellow
- M** Červená / Red
- N** Modrá / Blue
- O** Černá / Black

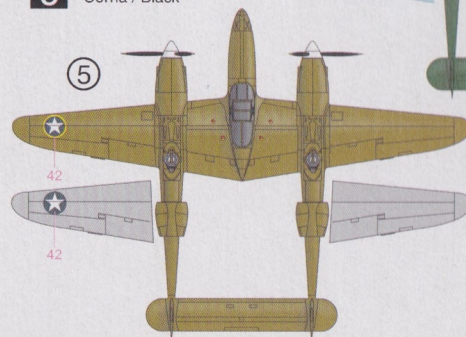

- A** Modrošedá / Bluegrey
- B** Světle šedá / Light Grey
- C** Tmavě zelená / Foliage Green
- D** Tmavě hnědá / Earth Brown
- E** Sky Blue (RAAF)
- F** Tmavě zelená / Dark Green
- G** Světle modrá / Light Blue

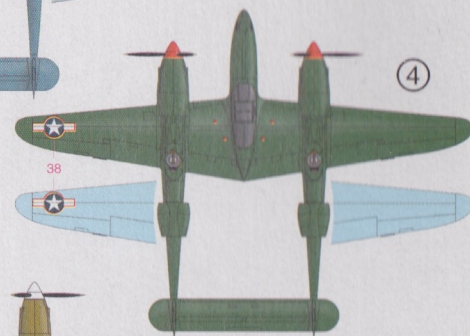
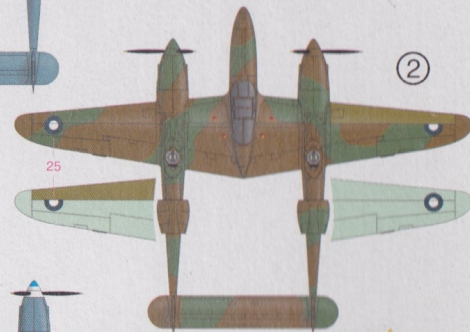

U lomu 7
795 01 Rýmařov
rsmodels@rsmodels.cz
www.rsmodels.cz
Czech Republic