

**INDY 500 PACE CAR**

**KIT 2975**

1/25 SCALE MASSTAB 1:25 ESCALA 1/25 1/25 ESCHELLE

2975M 0200



Official Licensed Product  
*Ford Motor Company*

The all-new 1994 Mustang could certainly be called "The Car That Has It All". Not only is it graced with beautiful new styling from the ground up, but it has also earned Motor Trend magazine's coveted Car of the Year title as well as being invited to pace the 1994 Indianapolis 500 Mile Race.

This year marks the third time a Mustang has been chosen to pace the Indy 500, the last time being 15 years ago when racing legend Jackie Stewart piloted a 1979 Cobra around the track.

Many enthusiasts are applauding the new Mustang as a return to the heritage and excitement of the original car and this new '94 convertible, with it's unique pace car styling certainly conjures up images of that first pony car pacing the 1964 Indy 500 race thirty years ago.

Have fun building your replica of the Mustang pace car. Your finished model will be a piece of history you can be proud of.

**READ THIS FIRST**

- Study the assembly drawings.
- Each plastic part is identified by a number.
- In the assembly drawings, some parts will be marked by a star (\*) to indicate plated plastic.
- Scrape plating from areas to be cemented
- Check the fit of each piece before cementing in place.
- Do not use too much cement to join parts.
- Use only cement for polystyrene plastic.
- Models may be painted to match photos on box.
- Allow paint to dry thoroughly before handling parts.
- Scrape paint from areas to be cemented.
- For better paint and decal adhesion, wash the plastic parts in a mild detergent solution Rinse and let air dry.

**LEA ESTO ANTES DE EMPEZER**

- Estudie los dibujos de ensamblaje.
- Cada pieza de plástico se identifica por un número.
- En los dibujos de ensamblaje, algunos números de las piezas están marcados con una estrella (\*) para indicar plástico laminado.
- Raspe el laminado de las superficies que serán pegadas.
- Verifique que cada pieza encaje bien antes de posición.
- No use demasiado pegamento para unir las piezas.
- Use únicamente pegamento para plástico de poliestireno.
- El modelo puede pintarse de acuerdo con las fotografías de la caja.
- Permita que se seque la pintura completamente antes de tocar las piezas.
- Raspe la pintura de las superficies que serán pegadas.
- Para una mejor fijación de la pintura y de las calcomanías lávese las piezas plásticas en una solución de detergente suave. Enjuague y dejense secar al aire.

**ALLGEMEINE HINWEISE**

- Die Anordnung der Bauteile ist den Zeichnungen der Anleitung ersichtlich.
- Jedes Plastikteil ist durch eine Nummer gekennzeichnet.
- Beschichtete Teile sind in den Zeichnungen mit einem Stern (\*) bezeichnet.
- Die Beschichtung muss von allen Klebestellen vorher entfernt werden.
- Die Teile vor dem Verkleben ungeleimt zusammenhalten um ihrem Passitz zu prüfen.
- Klebstoff nicht zu dick auftragen.
- Nur Modellbaukleber für Polystyrol verwenden.
- Man Kann das Modell nach den Fotos auf der Schachtel anstreichen.
- Bemalte Teile vor der Weiterverwendung gut trocknen lassen.
- Die Farbe muss von allen späteren Klebestellen abgeschabt werden.
- Damit sie Farbe und die Abziehbilder kleben, sind die Plastikteile in einer milden Seifenlauge zu waschen. Dann abspülen und an der Luft trocknen lassen.

**LISEZ CE QUI SUIT AVANT DE COMMENCER LE MONTAGE**

- Etudier les schémas d'assemblage.
- Chaque pièce plastique porte un numéro d'identification.
- Sur les schémas d'assemblage les pièces dont le numéro comporte une astérisque (\*) sont en plastique chromé.
- Grattez le chromage sur les surfaces à coller.
- Contrôler que chaque pièce soit bien cintrée avant de la coller à sa place.
- N'utilisez pas trop de colle pour réunir les pièces.
- Utilisez uniquement une colle spéciale pour polystyrène.
- Le modèle peut être peint conformément aux photos sur la boîte.
- Laissez sécher la peinture complètement avant de manipuler les pièces.
- Grattez la peinture sur les surfaces devant être collées.
- Pour assurer la meilleure adhésion possible de la peinture et des décalomnies, lavez les pièces de plastique avec une légère solution savonneuse. Rincez et laissez sécher à l'air.

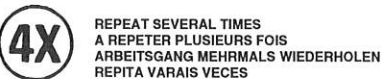
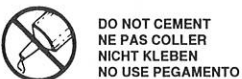

FLAT BLACK	NEGRO APAGADO	GLANZLOSES SCHWARZ	NOIR TERNE
LIGHT IVORY	COLOR DE MARFIL	ELFENBEINWEISS	COULEUR D'IVOIRE
GLOSS BLACK	NEGRO BRILLANTE	GLANZENDES SCHWARZ	NOIR LUSTRE
TURN SIGNAL AMBER METALLIC	AMBAR	BERNSTEINFARBEN	AMBRE
RED	ROJO	ROT	ROUGE
BLUE	AZUL	BLAU	BLEU
TRANSPARENT BLUE	TRANSPARENT AZUL	TRANSPARENT BLAU	TRANSPARENT BLEU
ALUMINUM	ALUMINIO	ALUMINIUMFARBEN	ALUMINIUM
STEEL	METALICO	METALLIC	METALLIC

REVELL-MONOGRAM MODELS, INC. Morton Grove, IL Copyright © 1994 All rights reserved. Made in U.S.A.

If you have any problems building this model, call our modeling tips hotline at: **(800) 833-3570**

# 1 ENGINE ASSEMBLY

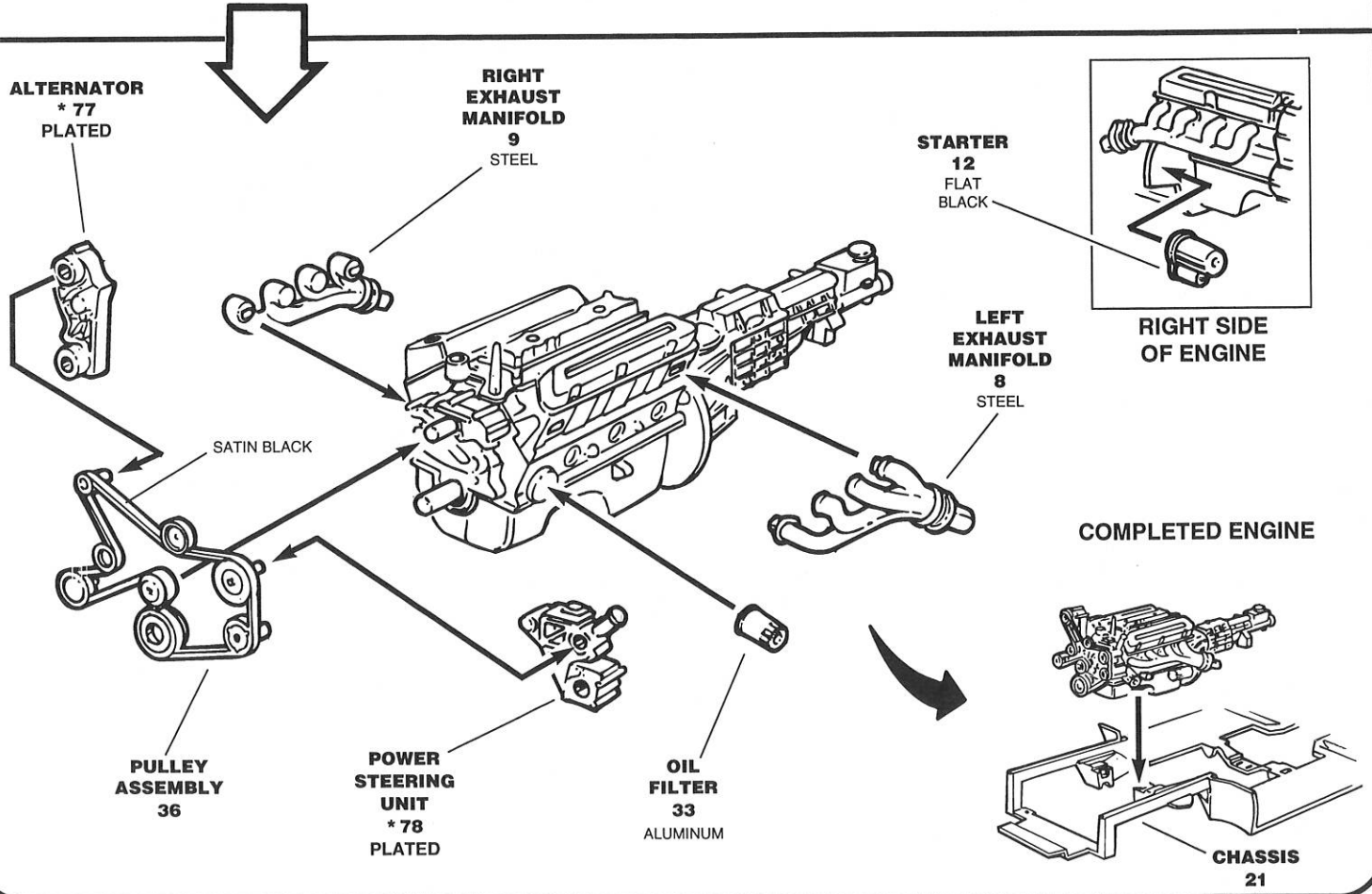
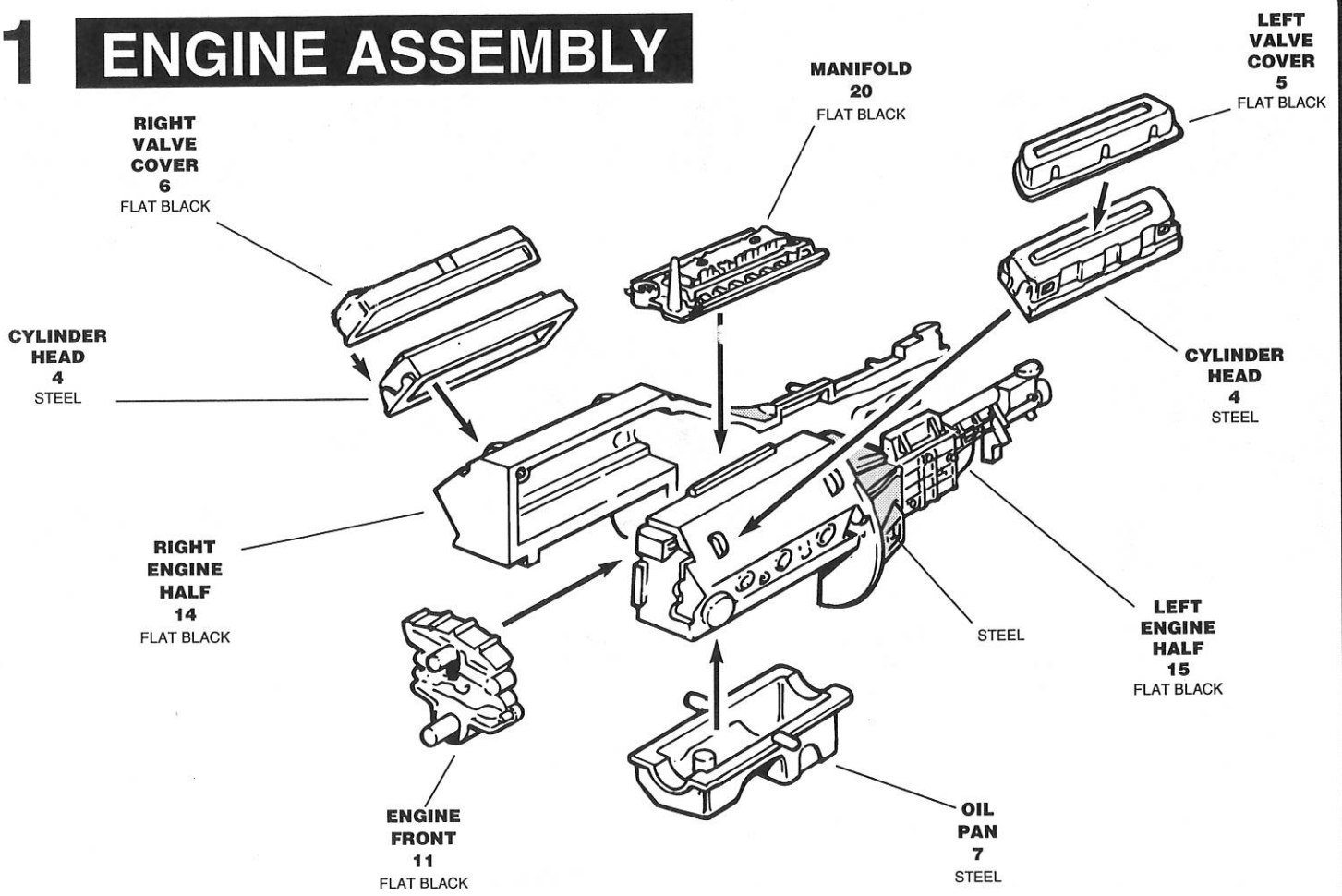

# 2 INTERIOR ASSEMBLY

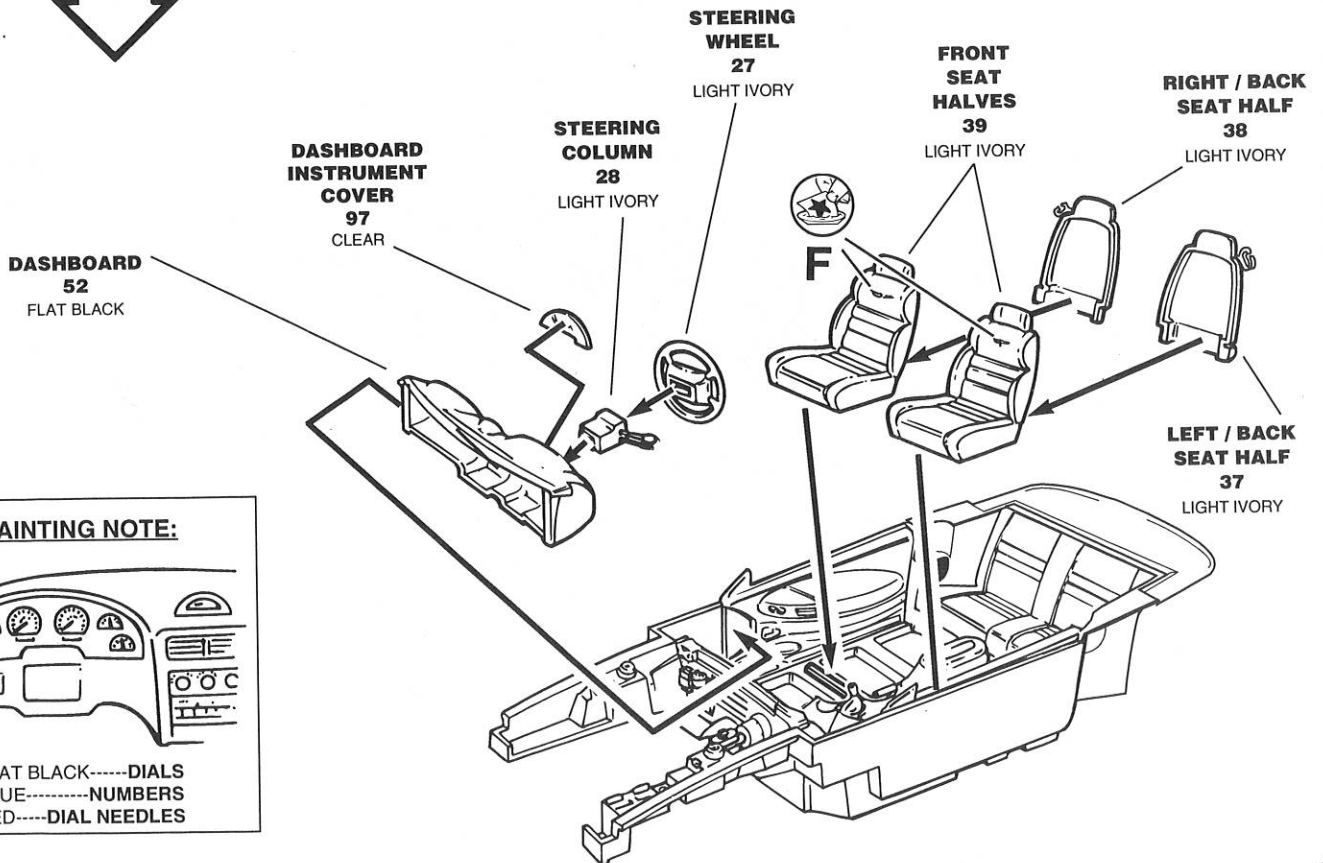
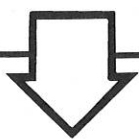
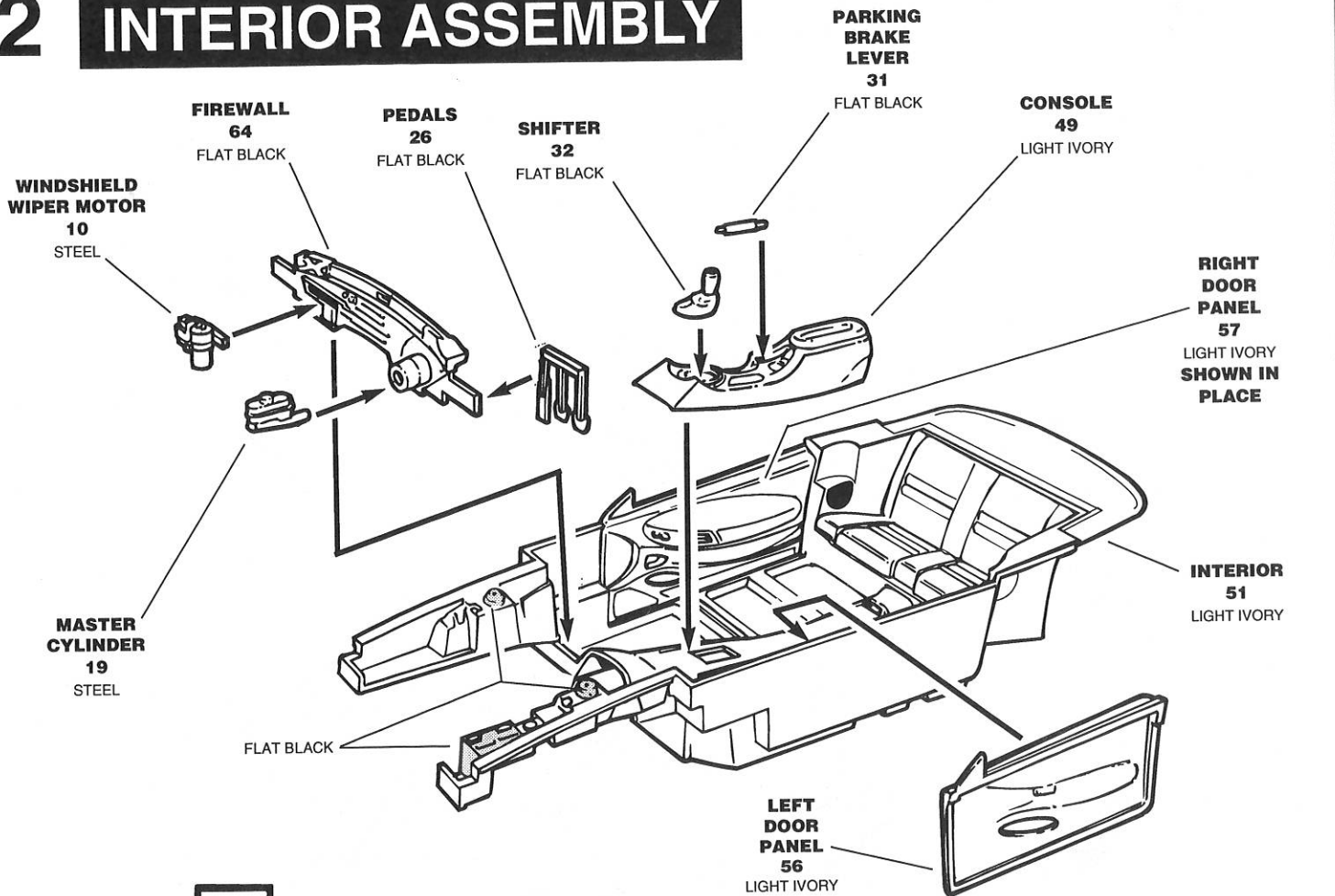

**PAINTING NOTE:**

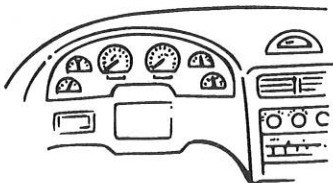

FLAT BLACK-----DIALS  
 BLUE-----NUMBERS  
 RED-----DIAL NEEDLES

# 3 CHASSIS ASSEMBLY / DETAILS

**EXHAUST SYSTEM**  
46  
ALUM INUM

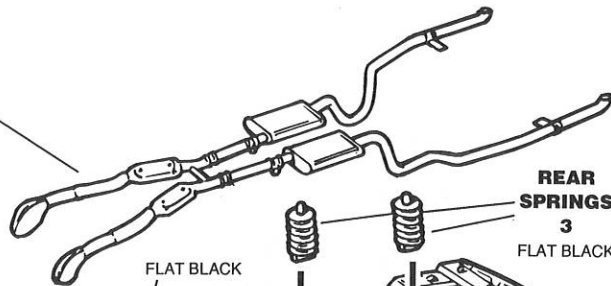

**CHASSIS**  
21

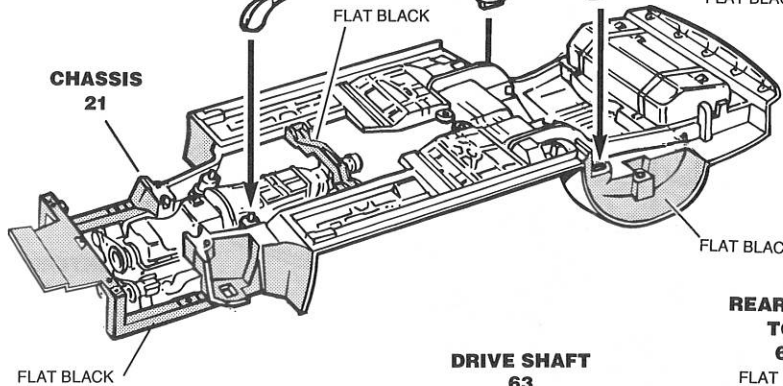

FLAT BLACK

**DRIVE SHAFT**  
63  
STEEL

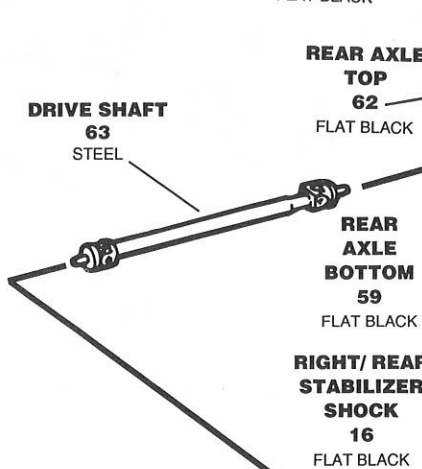

**REAR AXLE TOP**  
62  
FLAT BLACK

**REAR AXLE BOTTOM**  
59  
FLAT BLACK

**RIGHT / REAR STABILIZER SHOCK**  
16  
FLAT BLACK

**COMPLETED REAR SUSPENSION**

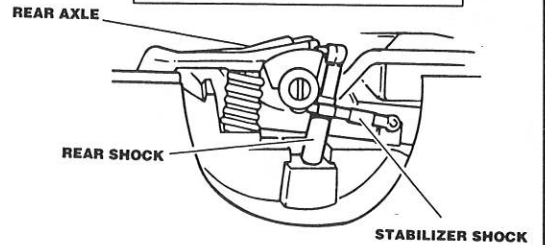

REAR AXLE

REAR SHOCK

STABILIZER SHOCK

**REAR SHOCKS**  
25  
FLAT BLACK

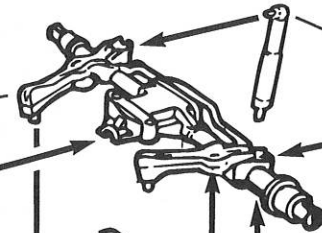

**FRONT SHOCK**  
47  
FLAT BLACK



**LEFT / REAR STABILIZER SHOCK**  
17  
FLAT BLACK



**COMPLETED INTERIOR ASSEMBLY**

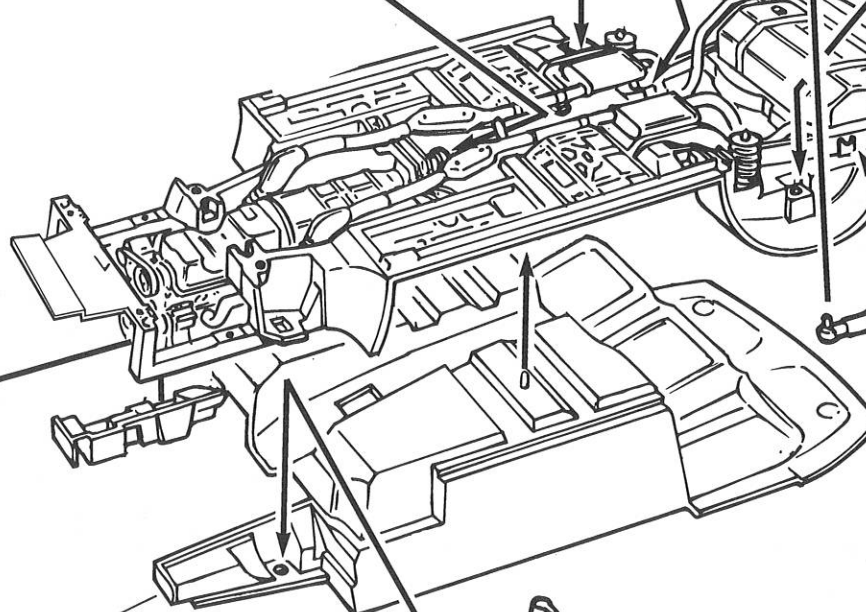

**FRONT SHOCK**  
47  
FLAT BLACK



# 4 SUSPENSION ASSEMBLY

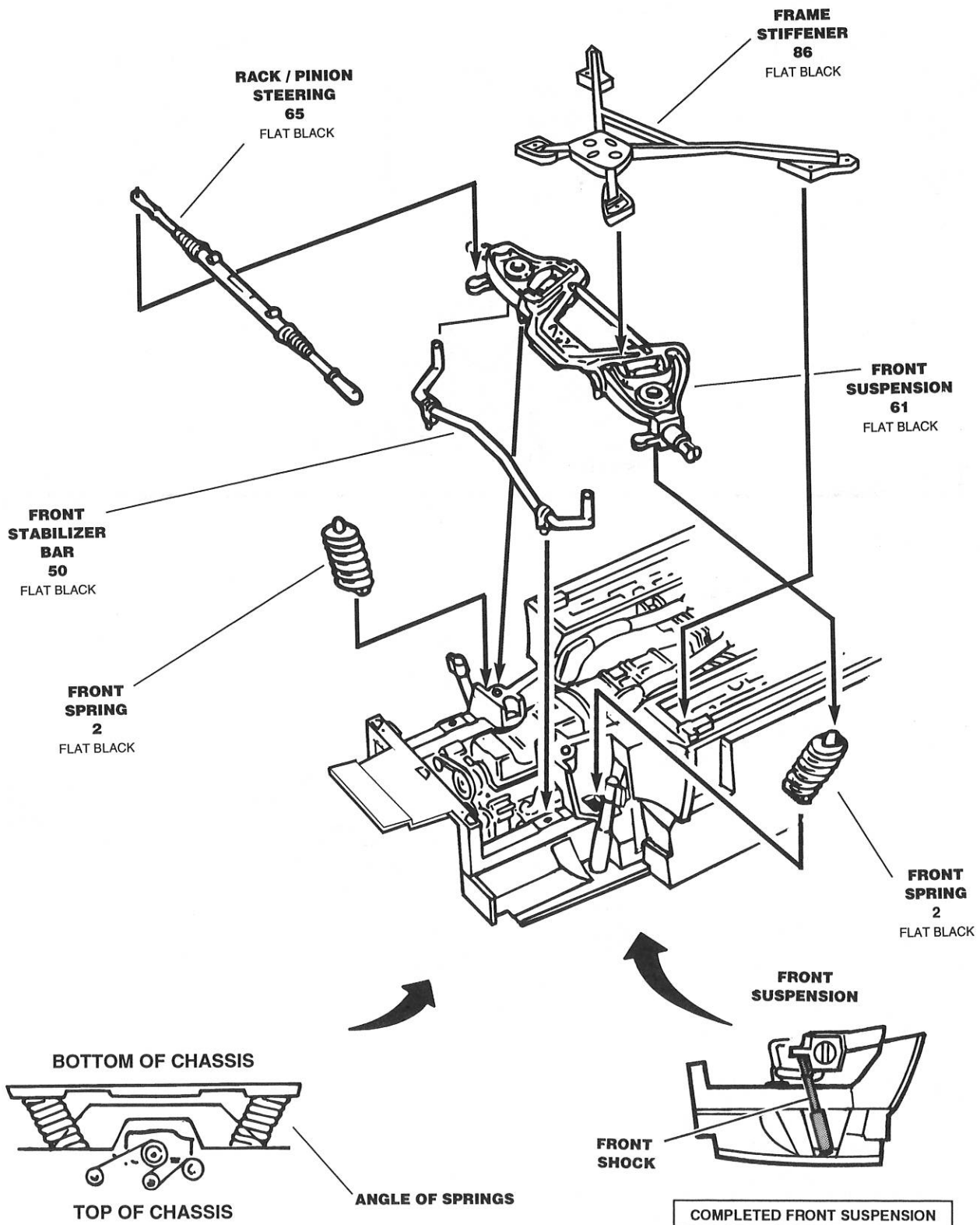

# 5

# FINAL CHASSIS DETAILS

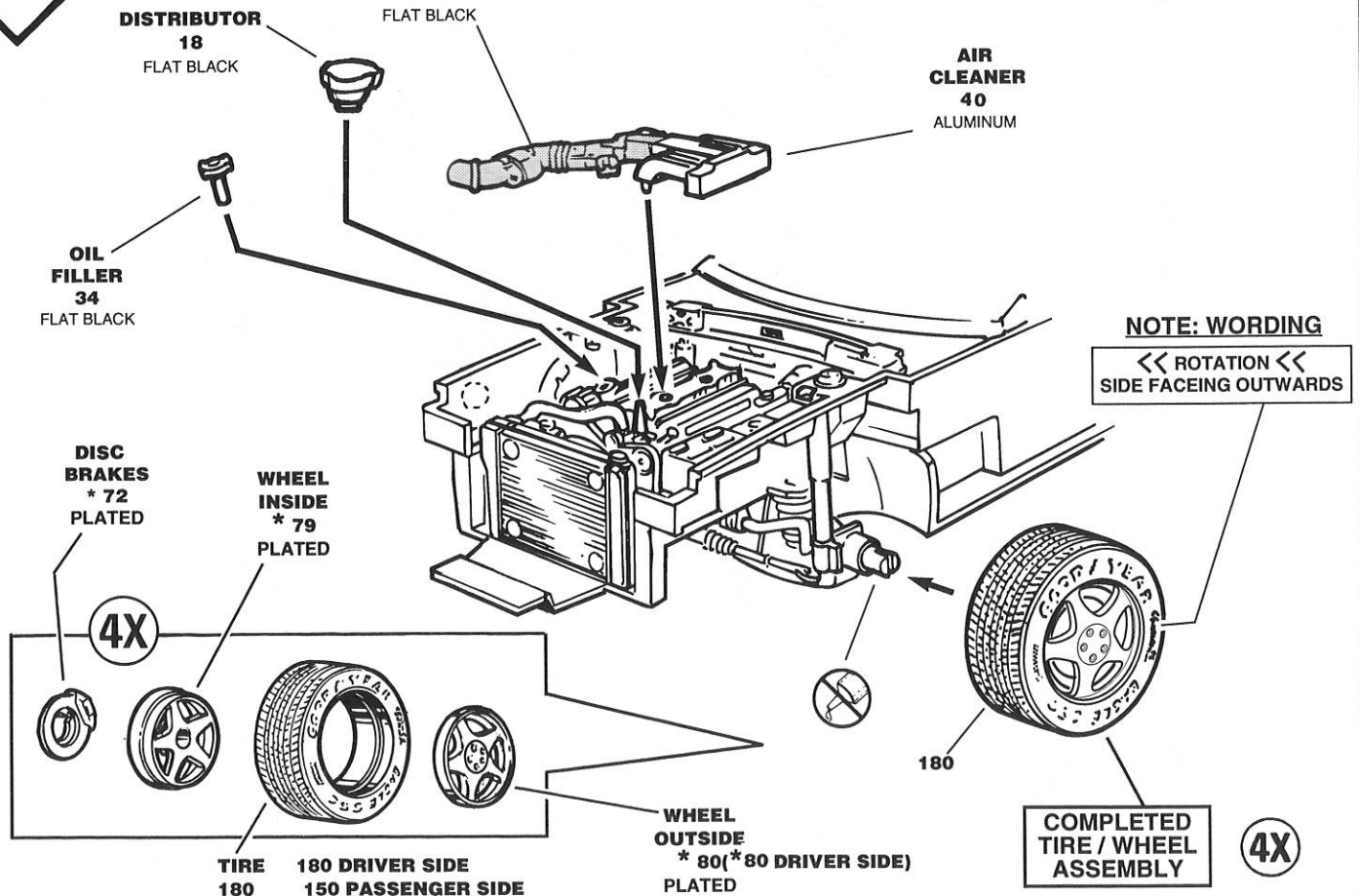
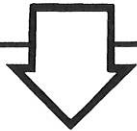
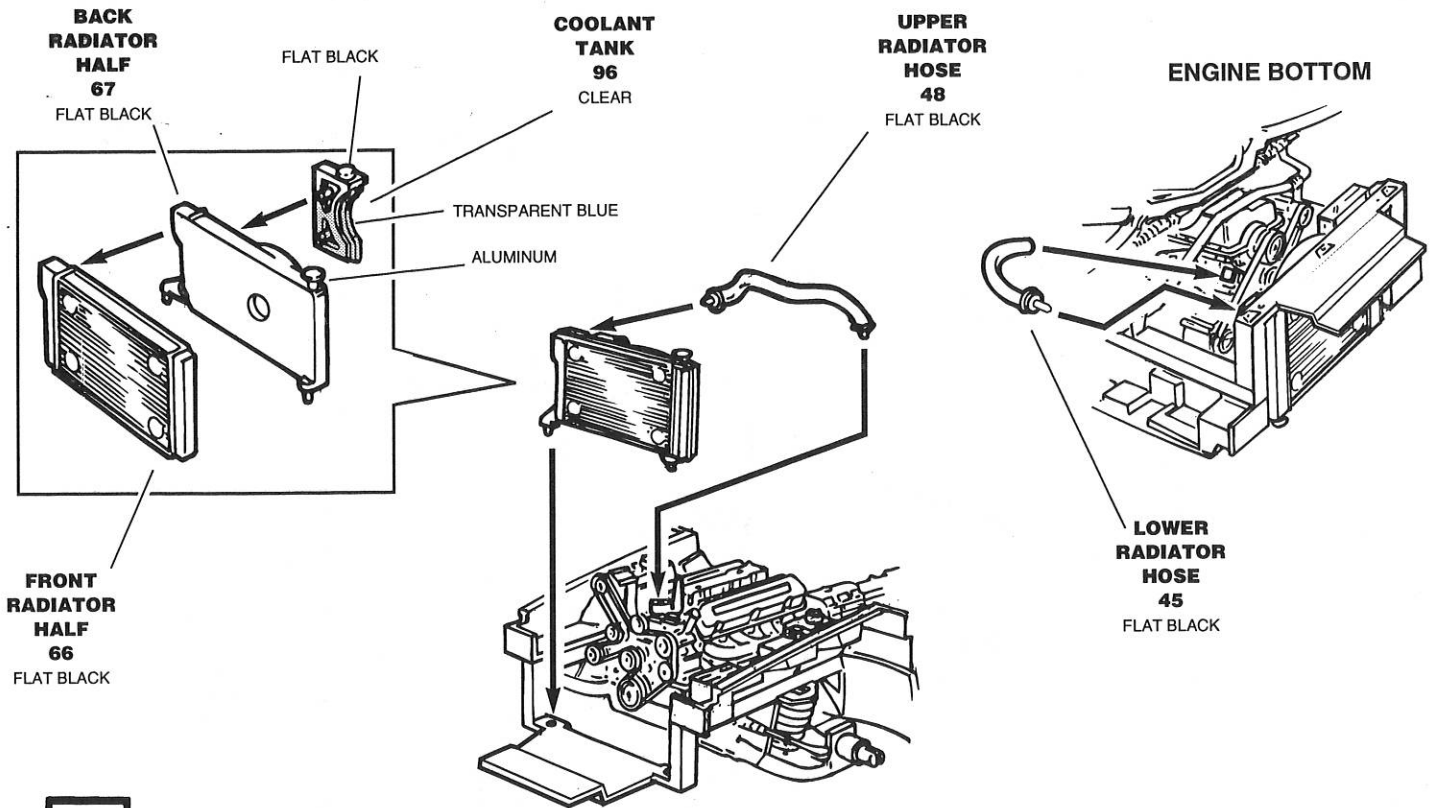

# 6 BODY ASSEMBLY

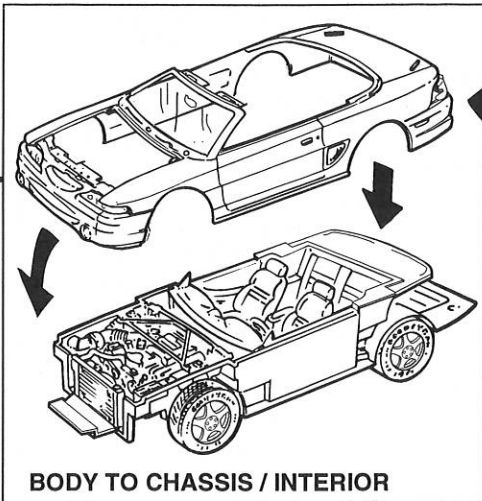
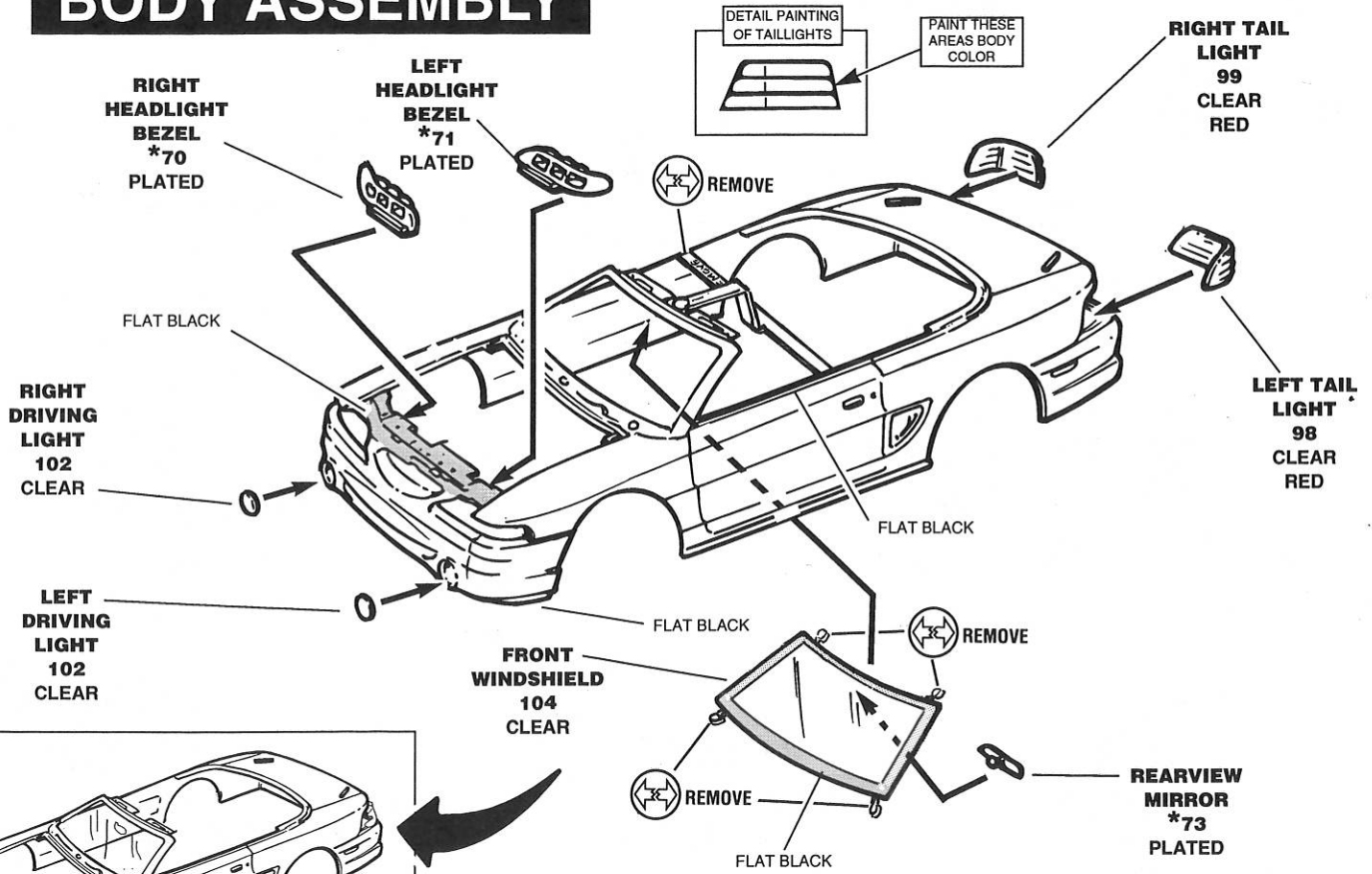

**PAINTING NOTE:**  
FLAT BLACK  
UNDER HOOD

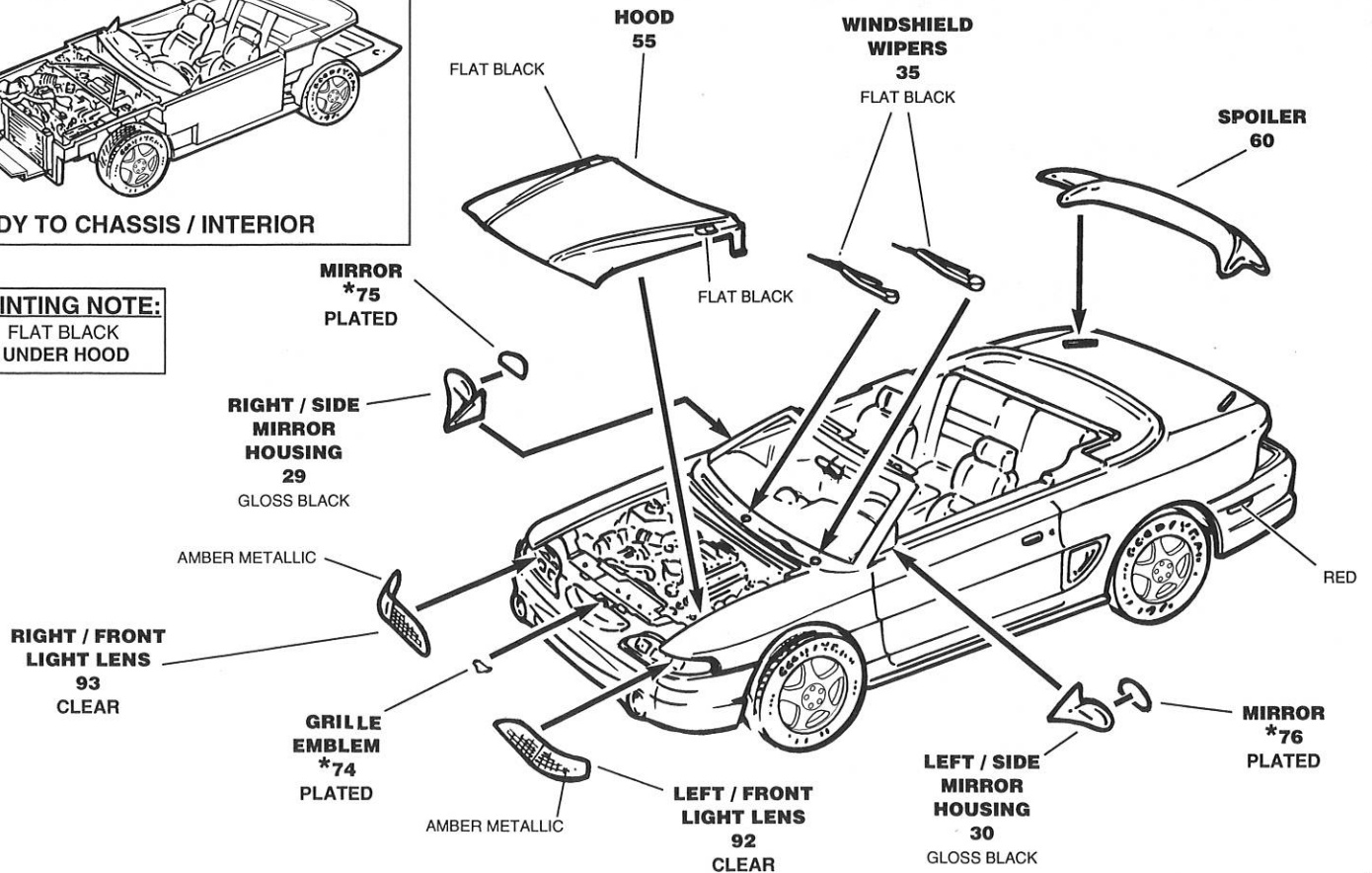

# 7 FINAL ASSEMBLY

NOTE: ADD ROLL BAR ASSEMBLY FOR PACE CAR VERSION ONLY.

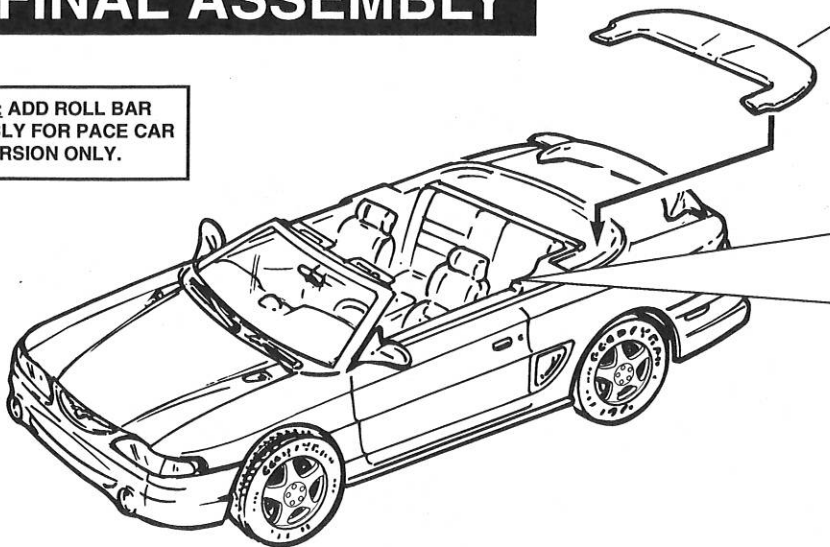

REAR BOOT  
89  
FLAT BLACK

ROLL BAR  
TOP  
87  
GLOSS BLACK

STROBE LIGHT  
103  
CLEAR

ROLL BAR  
BOTTOM  
88  
GLOSS BLACK

ROLL BAR ASSEMBLY

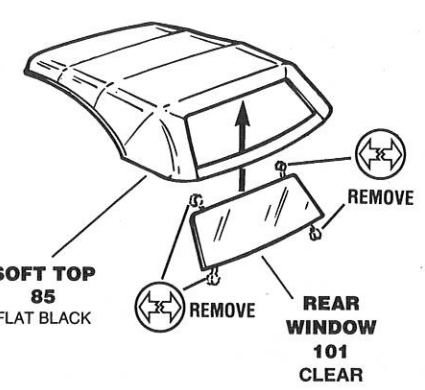

SOFT TOP  
85  
FLAT BLACK

REMOVE

REAR WINDOW  
101  
CLEAR

NOTE: REMOVE THE ROLL BAR ASSEMBLY IF YOU ARE INSTALLING THE SOFT TOP.

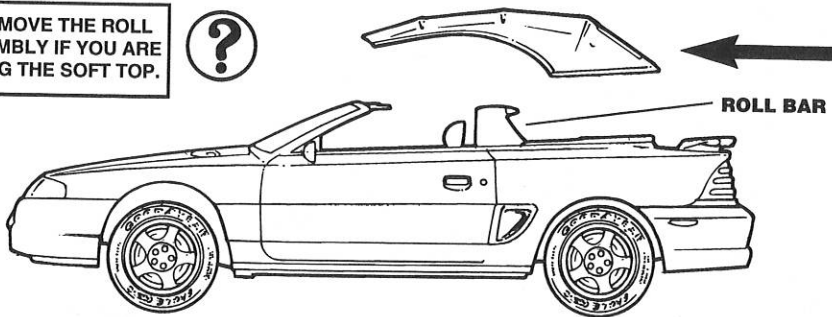

ROLL BAR

THE FOLLOWING REMAINING PARTS ARE NOT USED IN THIS KIT AND MAY BE DISCARDED: CLEAR # 94 & 95, TRANSPARENT RED # 100, 13, & 58.

# 8 APPLY DECALS



Every effort has been made to create and manufacture a model kit that is the finest available. If a part may be missing, please write to:

Monogram Model Kits  
Consumer Service Department  
301 North Third Avenue  
Des Plaines, Illinois 60016

Be sure to include the kit number, part number, description, and your return address.

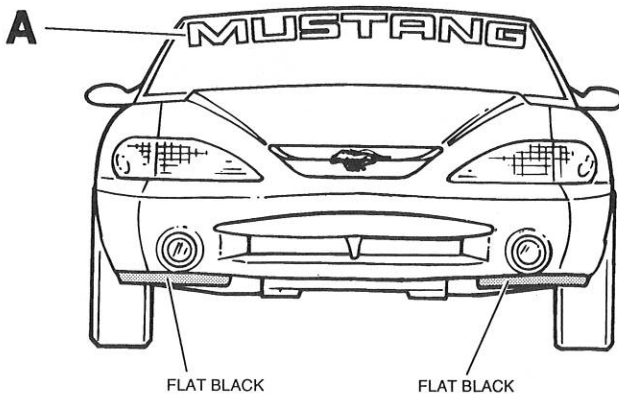

FLAT BLACK

FLAT BLACK

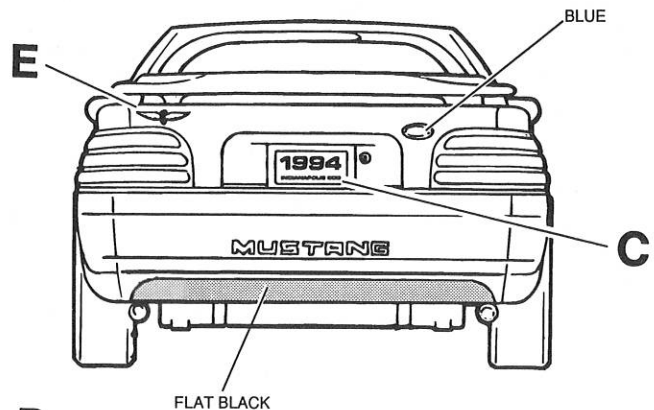

BLUE

FLAT BLACK

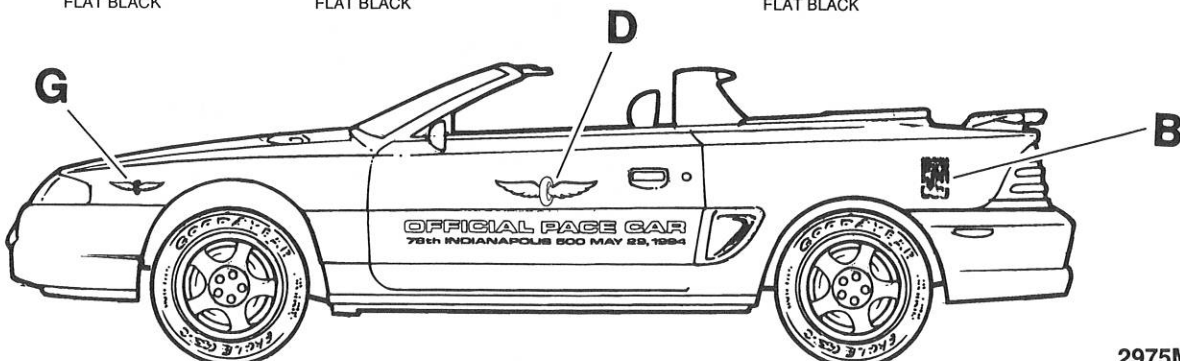

G

D

B

OFFICIAL PACE CAR  
76th INDIANAPOLIS 500 MAY 22, 1994