

C-29A/BAe-125/800

SW 72141

scale 1/72

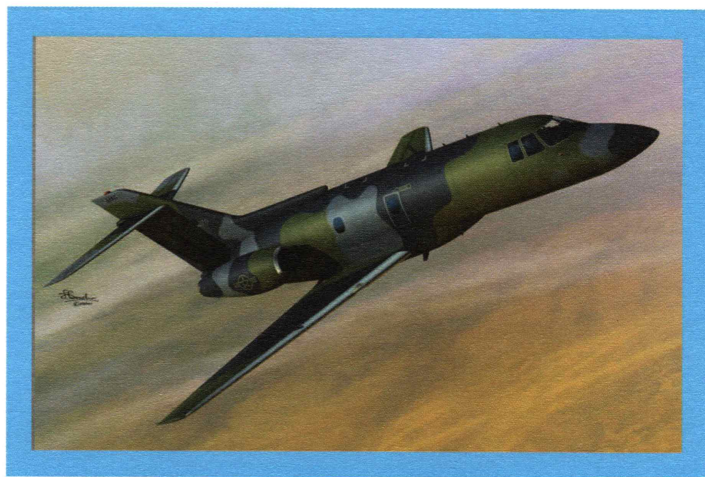

Raytheon Hawker C-29A (BAe 125-800)

The original 125 was a mid-sized business jet originally developed by de Havilland in 1961 as the DH 125 Jet Dragon. The aircraft was a low wing mono-plane design with slightly swept wings and a Bristol Siddeley Viper turbojet engine mounted to each side of the rear fuselage. The first prototype flew on 13 August 1962 and the second prototype fitted out more like a production model flew on 12 December 1962. Produced by Hawker Siddeley who already owned de Havilland, as the HS. 125, the production aircraft had a longer fuselage and greater wingspan and first flew on 12 February 1963. The 125 was continually upgraded with new powerplants, cockpit systems and airframe modifications as technology improved. It also underwent a continual change of ownership over time. From 1993, the aircraft became the Raytheon Hawker 125-800. Wider wingspan, more streamlined nose and windscreen, extended leading edge to fin being some of the improvements. The military C29-A was the USAF version and it replaced the C-140A. The C-29A was used for combat flight inspections and navigation missions at airbases around the world. The aircraft was used in Operation Desert Shield and Operation Desert Storm during the first Gulf War. C-29As were used for war/peacetime, contingency, inspections and evaluations of Air Traffic Control and procedures to ensure safe navigation and guidance for IFR especially at night and in adverse weather conditions. Since 9/11, over 900 sorties and 4,500 hours have been flown. The FAA took over the aircraft in the early 1990s but used USAF crew. The aircraft did not have the range for worldwide deployment, 80% availability, and suffered from wet-wing corrosion. Therefore unable to provide rapid and flexible deployment/support/tasking. Bombardier Challenger 600 (CL-600) are replacing the C-29A and by 2011, the FAA had 4 CL-600 and had retired three C-29A. The other three were to follow.

SWORDMODELS s.r.o. Těšínská 288
739 34 Šenov
CZECH REPUBLIC

www.swordmodels.cz
e-mail: swordmodels@gmail.com

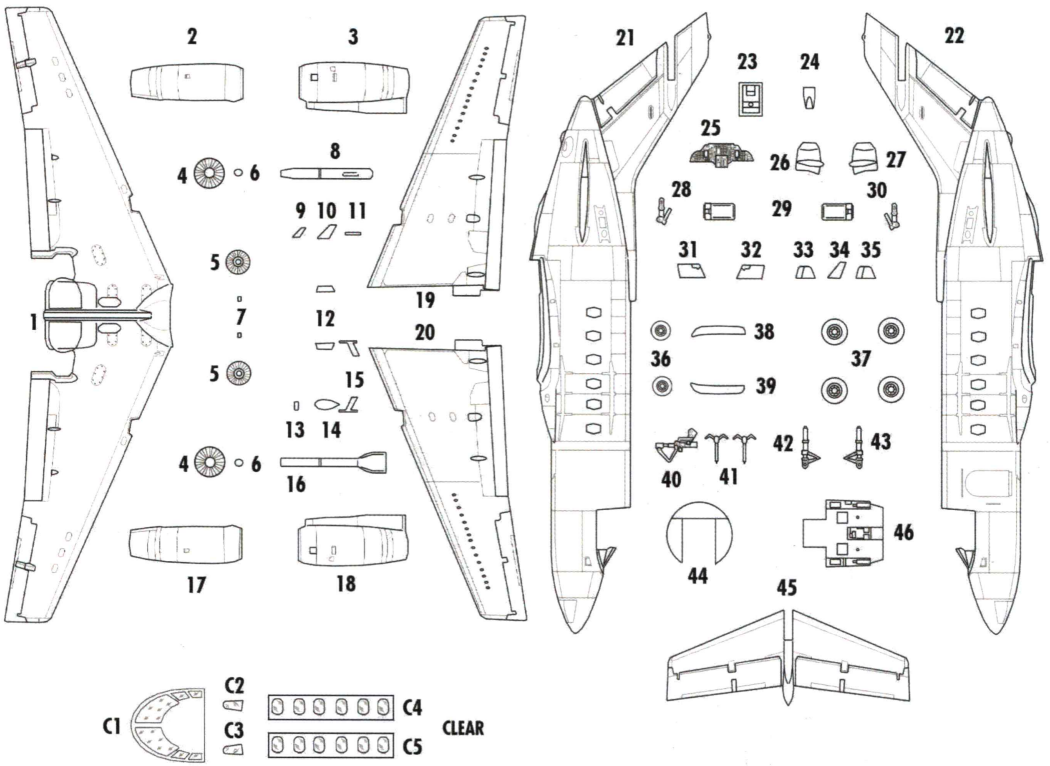

REMOVE



BEND

 OPEN
HOLE

 SCRATCH
BUILD

COLOR

 SYMETRICAL
ASSEMBLY

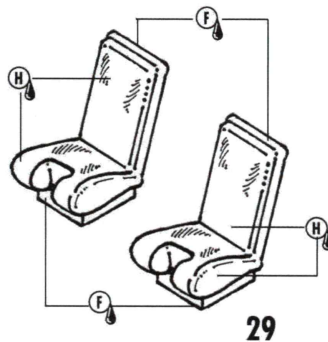
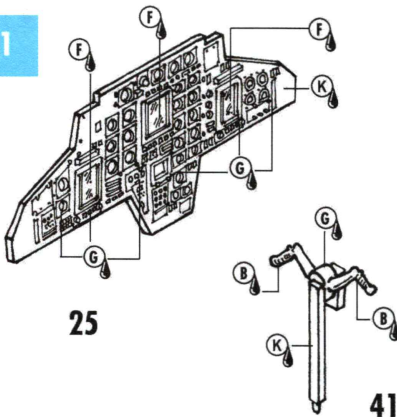

OPTION

 SECOND
GLUE

1

BARVA/COLOR

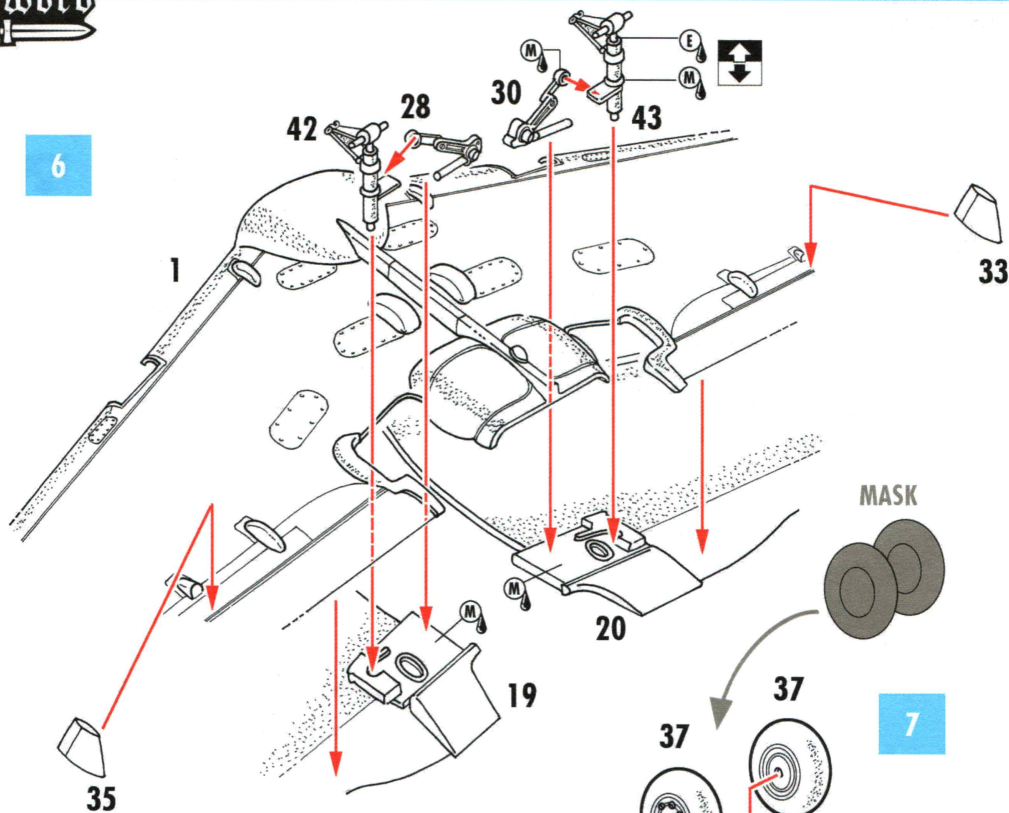
- A** Světla krémová / Light Creamy
- B** Černá/Black
- C** Stříbrná/Silver
- D** Hliníková / Aluminium
- E** Chromová / Chrome
- F** Světle šedá / Light Grey
- G** Tmavá šedá / Dark Grey
- H** Šedá / Grey
- I** Kovová / Gun metal
- J** Barva pneu / Tyres Black
- K** Střední šedá / Medium Grey
- L** Přírodní kov / Natural metal

6

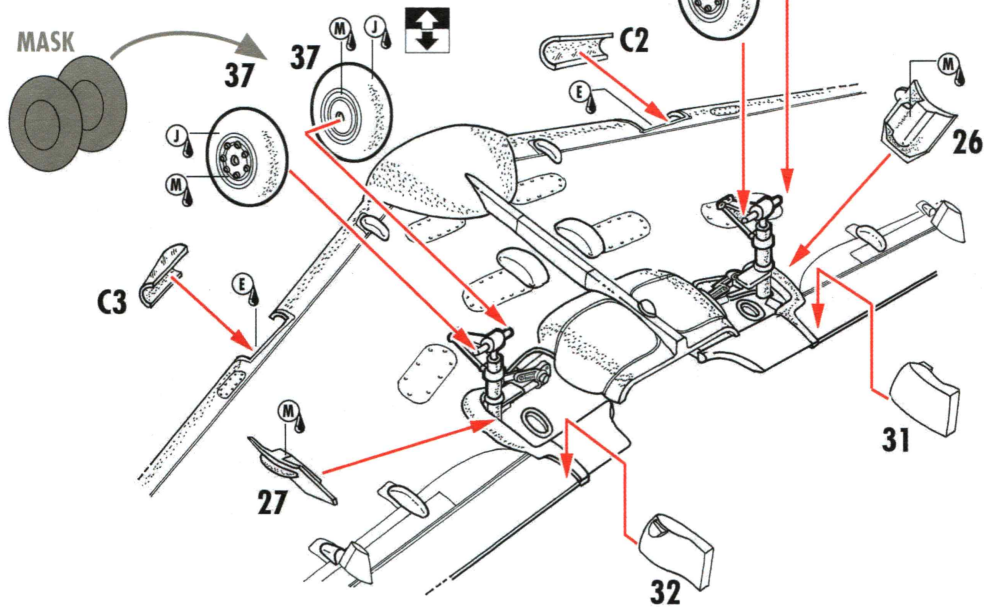

7



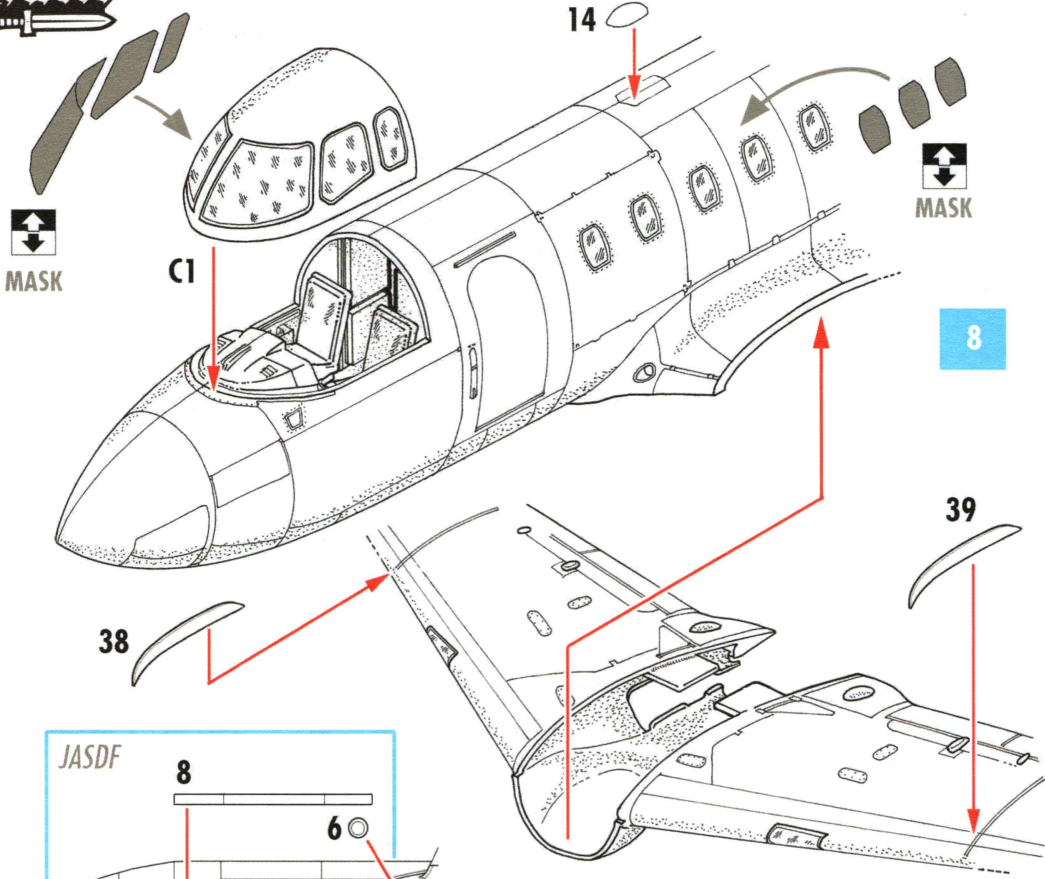

8

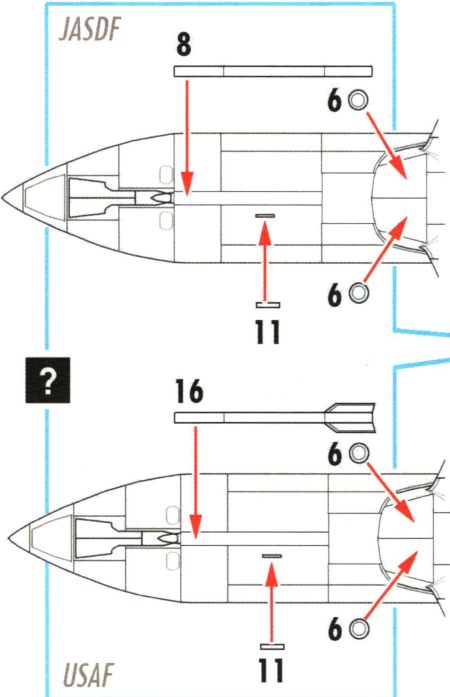

MASK

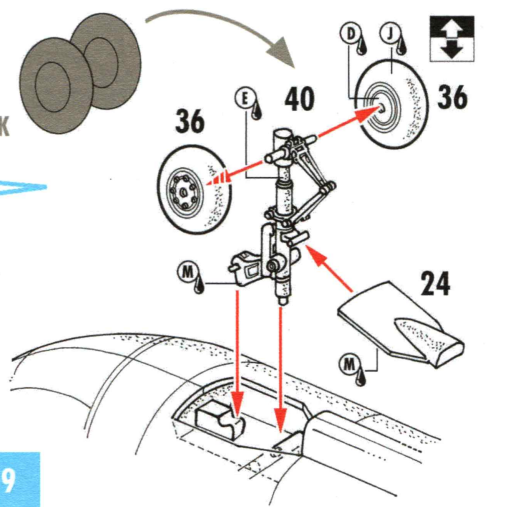

9

10

(4+5+17+18)

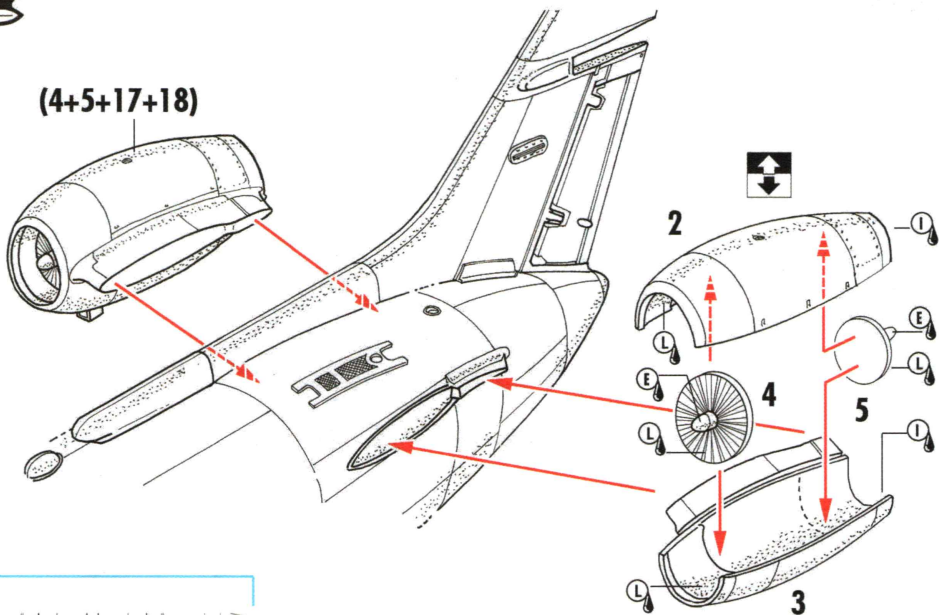

info

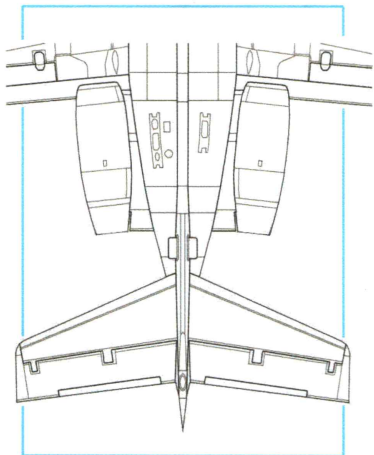

11

12

12

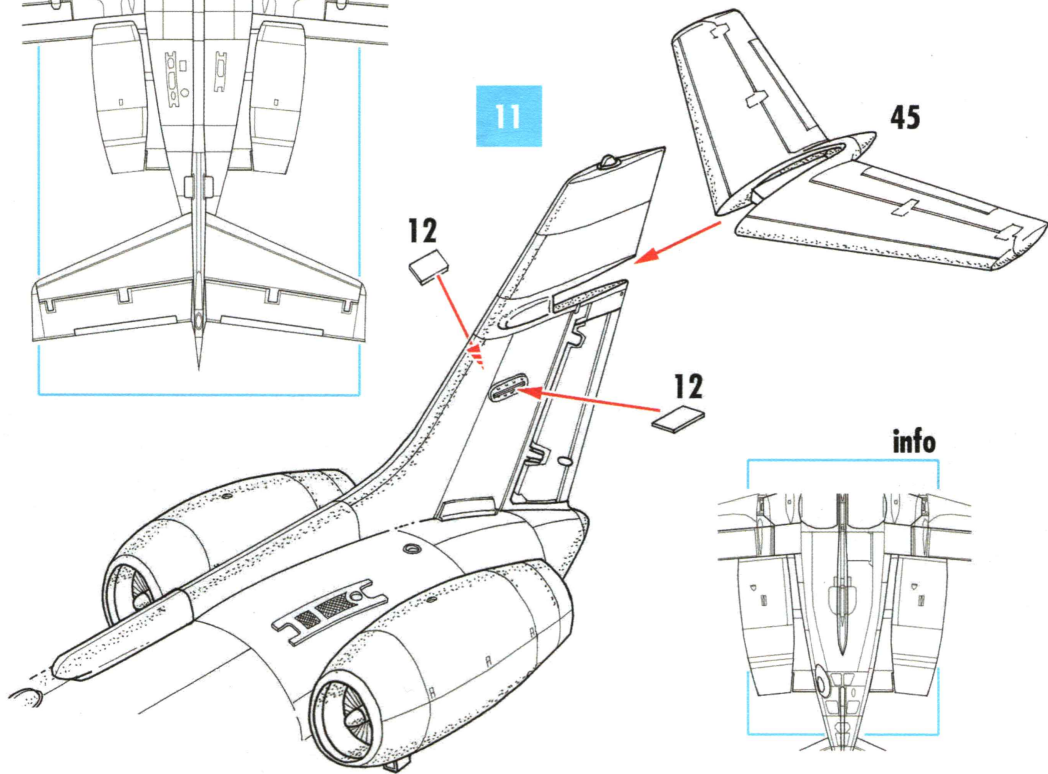

info

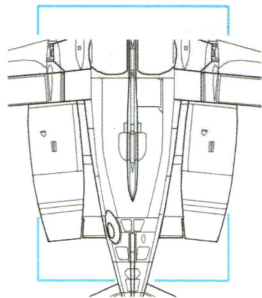

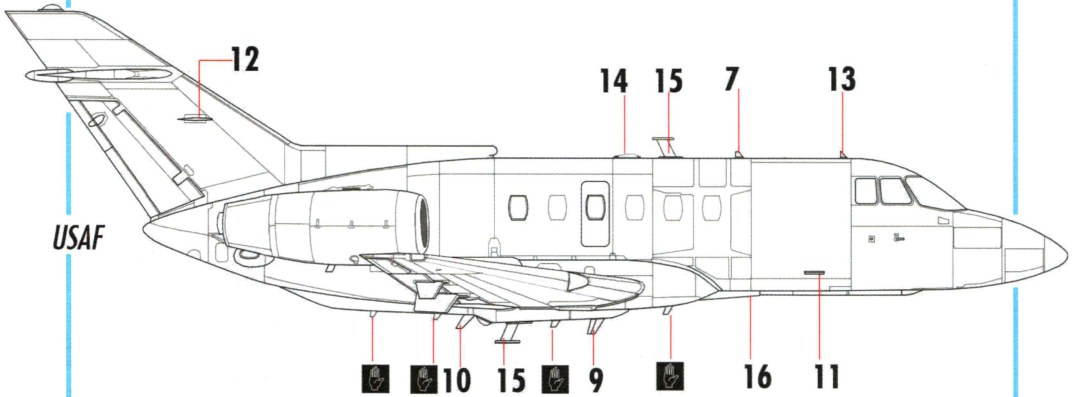
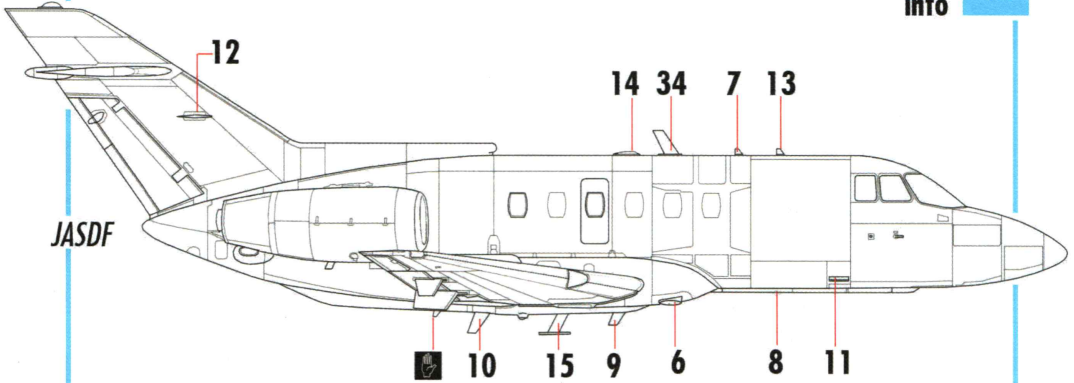

BAe 125/800, 29-3041, JASDF, Flight Check Sq, Miho AB, 2018
U-125 29-3041 航空自衛隊飛行点検隊 美保基地 2018年

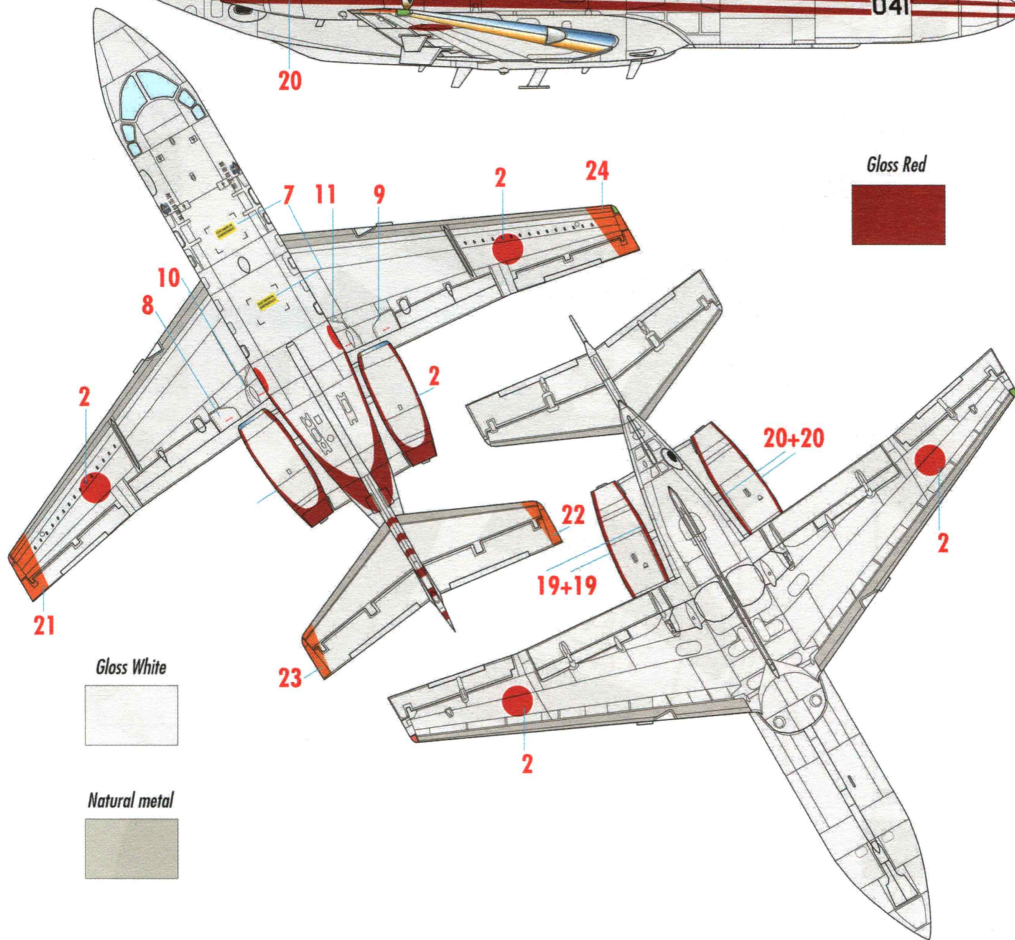
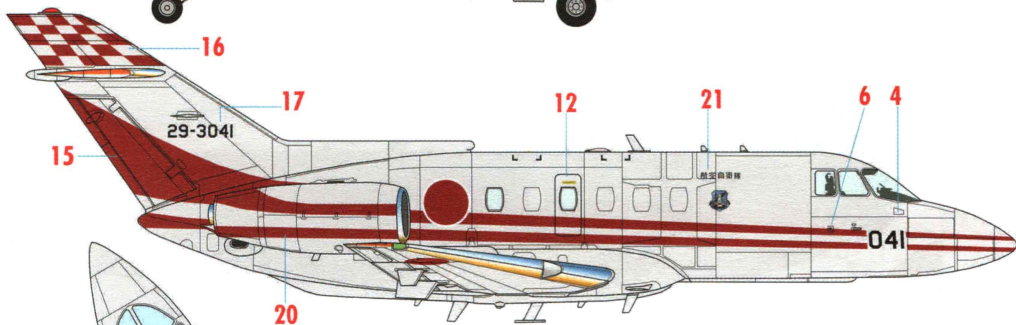

Gloss Red



Gloss White



Natural metal



C-29A, USAF, 88-0270, 1467th, FCS, 1991

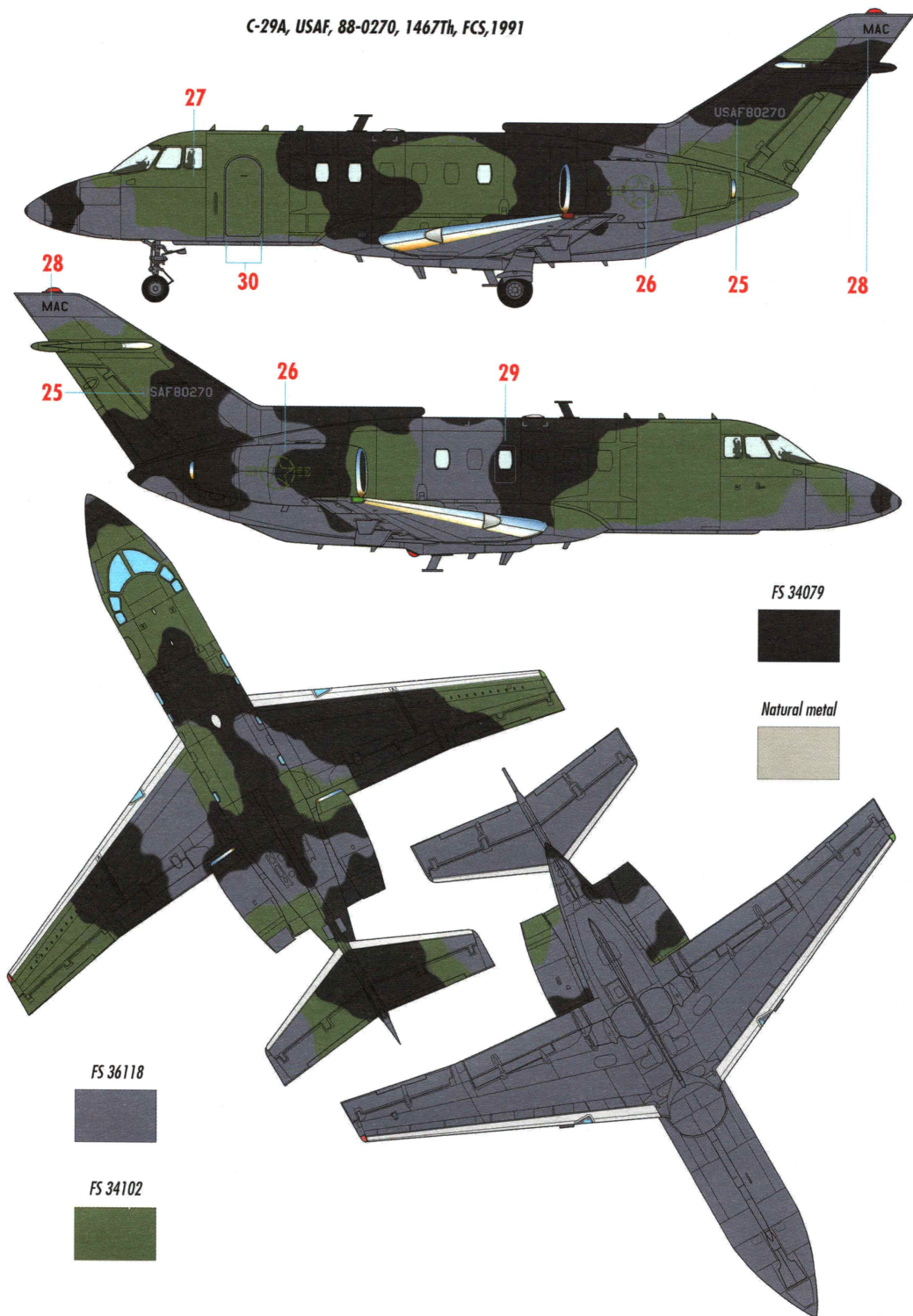

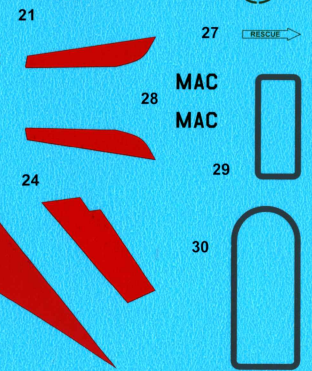
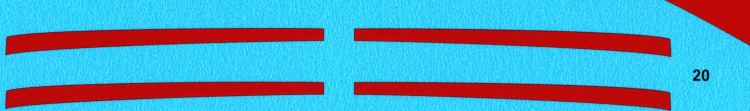
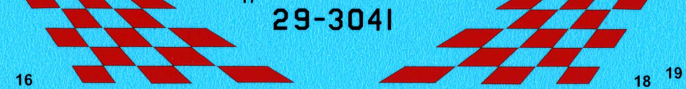
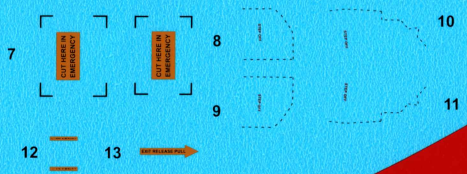
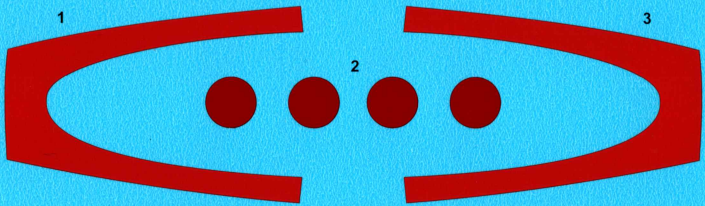

SW72141 C-29A/U-125/ BAe-125/800

Printed by Techmod