

Ling-Temco-Vought XC-142

1/72 scale resin model kit
#AA-2028

In 1950's, many V/STOL aircrafts were built and evaluated by the U. S. military services. Few of the concepts were deemed to have the operational capabilities. Base on these prototypes experiences, the new V/STOL assault transport program was announced. In 1961, a request for proposal of the large cargo airplane was released by Tri-service. Ling-Temco-Vought was awarded, with Hiller and Ryan serving as subcontractors, a contract for five XC-142. It was powered by 4 turbo-shaft engines. The wing could tilt through 100 degrees. The fuselage was designed to carry 32 troops or 4 tons cargo. It made first flight in 1964, followed by trails of cargo flights, paratrooper drops, desert/mountain rescue and carrier operations. The five XC-142 were flown a total of 420 hours. Performance was not as good as expected. Four of them were damaged in hard landings. The program was ended in 1966, one XC-142 was turned over to NASA for research tests until 1970.

Specifications:

Wingspan - 67 ft 6in
Length - 58 ft 2in
Height - 25 ft 8 in
Powerplants - General Electric T64-GE-1 x 4
Crew - 3
Max speed - 431 mph

The gates on fuselage top were opened with the main wing tilting.

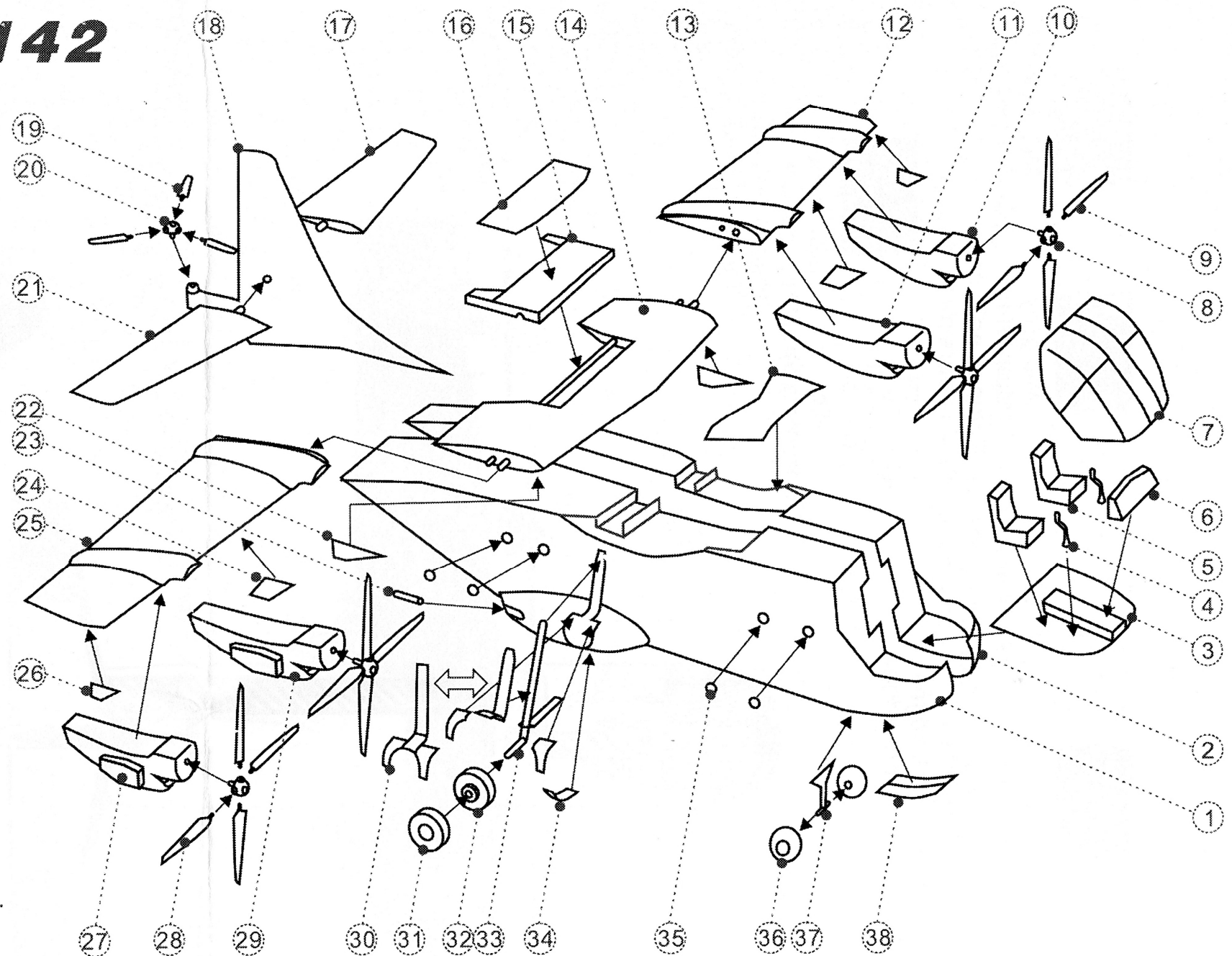

- | | | |
|-----------------------------|------------------------------|----------------------------------|
| ① Starboard fuselage x 1 | ⑭ Middle main wing x 1 | ⑳ Starboard outer nacelle x 1 |
| ② Port fuselage x 1 | ⑮ Main wing hinge x 1 | ㉑ Starboard propeller blades x 8 |
| ③ Cockpit floor x 1 | ⑯ Aft tilting gate x 1 | ㉒ Starboard inner nacelle x 1 |
| ④ Control levers x 2 | ⑰ Port tailplane x 1 | ㉓ Main gear doors x 2 |
| ⑤ Pilot seats x 2 | ⑱ Fin x 1 | ㉔ Outboard main wheels x 2 |
| ⑥ Instrument panel x 1 | ㉒ Tail propeller blades x 3 | ㉕ Inboard main wheels x 2 |
| ⑦ Canopy (clear) x 1 | ㉓ Tail propeller spinner x 1 | ㉖ Main landing gear x 2 |
| ⑧ Propeller spinners x 4 | ㉔ Starboard tailplane x 1 | ㉗ Lower main gear doors x 2 |
| ⑨ Port Propeller blades x 8 | ㉕ Inner flap jacks x 2 | ㉘ Side windows (clear) x 8 |
| ⑩ Port outer nacelle x 1 | ㉖ Generator exhaust pipe x 1 | ㉙ Nose landing wheels x 2 |
| ⑪ Port inner nacelle x 1 | ㉗ Middle flap jacks x 2 | ㉚ Nose landing gear x 1 |
| ⑫ Port main wing x 1 | ㉘ Starboard main wing x 1 | ㉛ Nose gear door x 1 |
| ⑬ Fore tilting gate x 1 | ㉙ Outer flap jacks x 2 | |

ANIGRAND
CRAFTSWORK

PO Box 40, Texaco Road,
NT., Hong Kong.
E-mail : email@anigrand.com
Web : www.anigrand.com

Painting & Decals

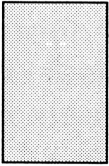
- 

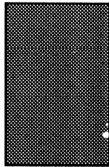





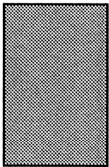

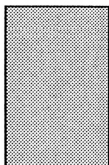

- Light gull grey
(Fuselage bottom)
(Rudder)

Burn Iron
(Engine exhausts)
(Generator exhaust)

Black
(Nose)
(Tires)
(Propellers)
(Main wing fore edges)
(Tailplane/Fin fore edges)

White
(Fuselage top)
(Landing gears)
(Gear bays)

Mid grey
(Main wing)
(Engines nacelles)
(Main gears nacelles)

Mid grey
(Cockpit interior)
- 

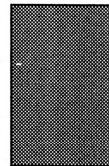

- Dark Grey with black surrounding
(Main wing walk way)

Yellow
(Propellers tips)
(Tailplane tips)
(Fin)

Signal red
(Anti-glare area)
(Main wing tips)
(Tailplane tips)

