

! If you want to "open" this hatch, the lock (21) needs to be additionally secured to the hatch cover (20).

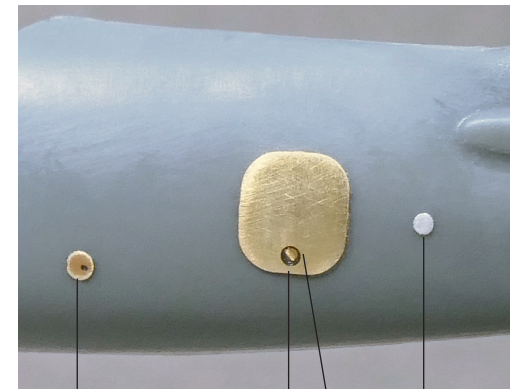

This photo-etched detail set is designed for the delicate Kovozaody kits. We focused on external details, omitted in already available upgrade sets for those kits (Bregun BRL144112, -13, -14 and Marabu Design M14401). Your model can be enhanced even further using Bregun vacformed canopies (BRL14416, -21).

Certain details of this set can also be used in the new North Star resin kit and Zvezda war-gaming model.

Beside the brass fret, we prepared a small decal set with the most visible stencils seen on all versions of La-5. Decals are made using silk print technology (BOA Bodecek Agency) and feature very small amount of transparent base around the graphics.

SO214421

1/144 La-5/F/FN for KovozaVody Prostejov kit

Shelf
Oddity

One of the most prominent features of this set are the exhaust flaps (EX). There were two kinds of exhaust setup among various versions of La-5 – an early collector pipe and later set of single ejector pipes.

Areas of the exhaust flaps existing in your kit need to be removed before proceeding with our PE parts.

For the early setup please use set of parts no. 3L, 3R and 4. The larger flaps (3L, 3R) need to have their end fins folded at 90 deg angle first and then the whole flaps need to be delicately pre-shaped. Both collector pipe fairings (4) need to be pre-shaped separately and then fixed into larger flaps. The collector pipes need to be scratch-built from e.g. stretched plastic tube used in cotton ear-buds.

For the later setup, please use set of parts no. 1L, 1R, 2L and 2R. The sets of single ejector pipes (1L, 1R) need to be pre-shaped and then glued to the fuselage. The larger flaps (2L, 2R) need to have their end fins folded at 90 deg angle first and then again – the whole flaps need to be delicately pre-shaped.

The rear-view mirror (19) is the only internal part present in our set. The photograph of kit's windscreen included here shows the immense (for this scale) thickness of the part. This area of your model will look far better when the vacformed canopy mentioned earlier is used.

The main radio mast is prepared in two versions (16, 17) – check your references when selecting the proper part. Its oval base (15) was always present.

The hinge imitation (13), two tiny air scoops (14) and the radio hatch set (20, 12) complete the fuselage picture.

The smallest circular hatches were made of very thin aluminium foil (check your chocolate packaging).

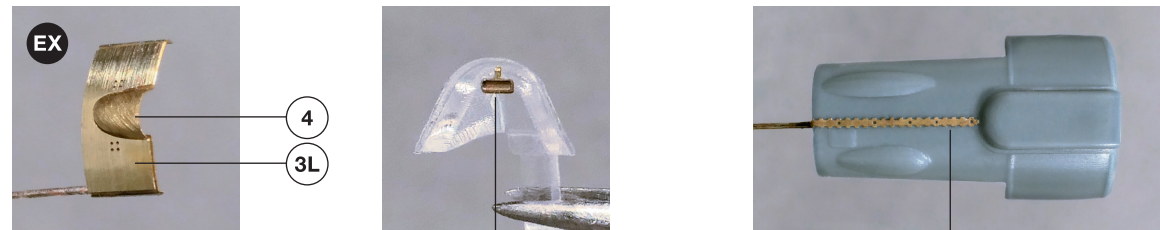
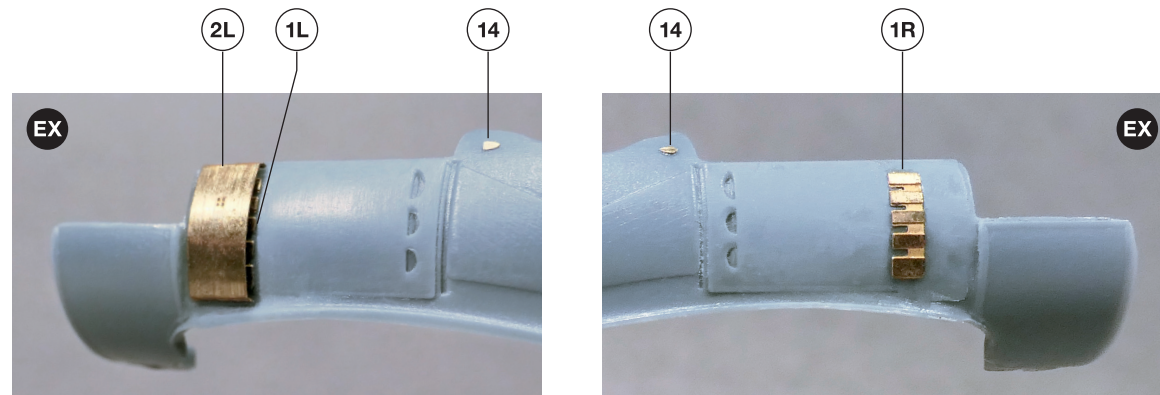

! Single exhaust pipe version.
Use 3R for starboard assembly.

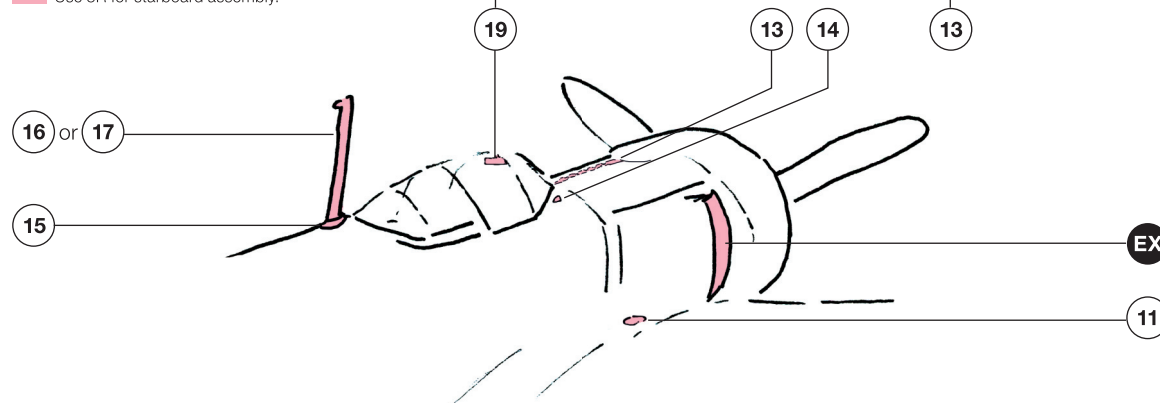

The most prominent detail underside of the airplane, also visible from the side is the oil cooler. The producer of the kit chose to make it solid from the rear. To install the cooling flap (9), the cooler itself needs to be hollowed-out from the back.

The kit's wing is the area which received a lot of our attention too. The very central point of the underside wing has quite an unpleasant plastic sink-mark. Its removal with filler and sanding paper is of course possible but due to small size of the model, we have chosen to prepare the large hatch cover as a set photo-etched parts (5, 6), simply masking the faulty area.

The remaining hatch covers (7, 10, 11) were also prepared as photo-etched to unify their appearance on model surface and to get the additional detail of covers' locks.

It is recommended to sand attached covers using very fine sanding paper to make it look like all the brass panels are mounted flush on the surface.

An oil drain cap (8) and pitot mount (12) are the last touches here. The pitot tube itself should be prepared as 7 mm long piece of 0.2 mm wire. One end of the wire should be sanded down to achieve a conical sharp tip – this end should fit the notch in the pitot mount (12).

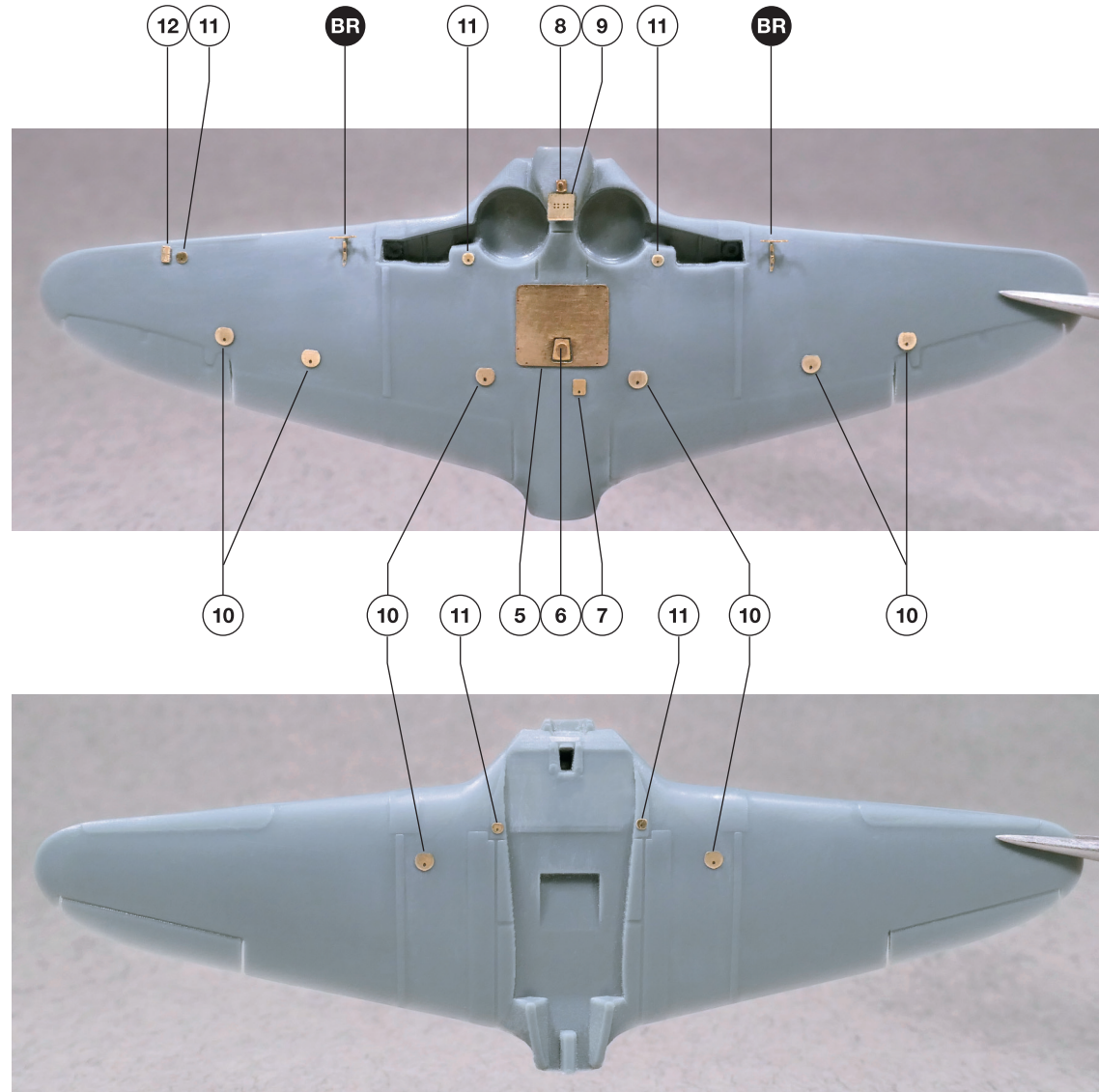

Some airplanes had their bomb racks removed and the oval fairing were fit. The KP kit depicts such state. However on the historical photographs of La-5 the bomb racks are fairly visible. To replicate them parts no.29 and 30 are used. On the rear side of each rack two 0.9 mm long pieces of 0.1 mm wire should be mounted as shown here.

The landing gear legs can be updated with the oleo scissors (24). Please note the scissors are handed.

As the wheel hubs details has been omitted by both KP and the other etch producers, the inner (23) and outer (22) discs can further enhance your model.

The last bit of the model – a tail-wheel – needs a bit of special attention. As this part is rather small, any injection faults are clearly visible. In a few La-5 kits, we have seen both halves of the sprue are misaligned a bit. While in larger scales this would be a non-event, in our beloved 1/144 this may create quite a serious problem. That is why we chose to rebuild the tail-wheel using parts of brass tubes, wire, stainless steel medical syringe needle and a few etched parts.

First of all, the tail-wheel needs to be created in form of sandwich of two inner (25) and two outer discs (26). The visibly uneven circumference of this sandwich gives an impression of tyre thread. Then, the wheel fork (27) needs to be folded into U-shape before further assembly. Please use an axle made of 0.15 mm wire to position wheel and the fork.

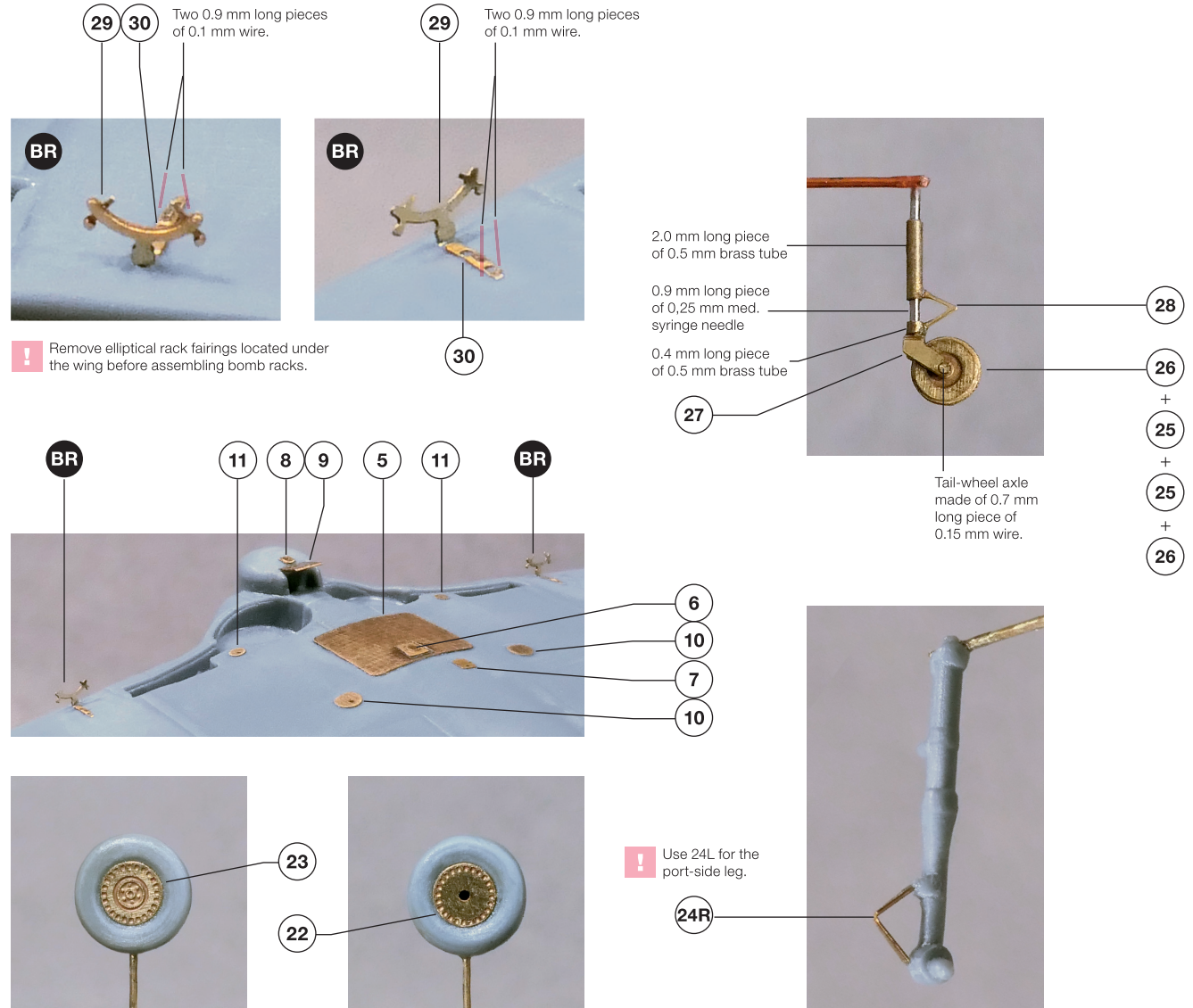

When looking at the decal sheet in KP kit, some of the Lavochkin diamond logos seem to be slightly too big. Also the tail diamonds visible in the later production series are omitted.

To correct this issue and to add earlier Lavochkin logos plus some most visible stencils, we prepared a small decal sheet. Please note that white stencils were used over dark camouflage colours and red – over lighter ones.

Sources:

Lavochkin La-5 – MBI Publishing

! Drawings keep 1/144 scale when printed on A4 size paper without "fit to page" option.

La-5F

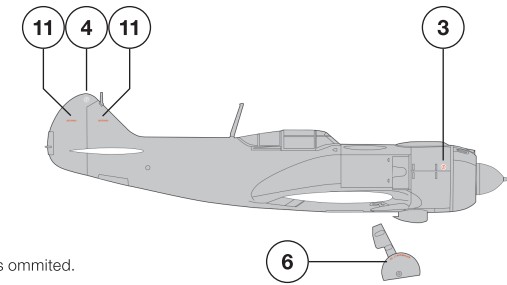
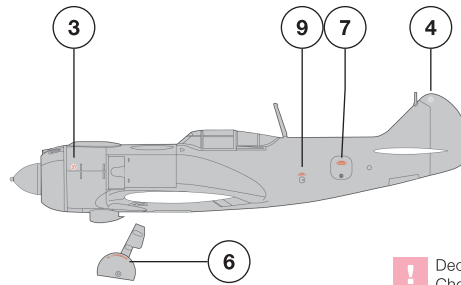

! Decals 2 and 4 were sometimes omitted. Check your references.

! Decals 11 and 12 are interchangeable between all versions of La-5. The same applies to stencils 7 and 8 as well as 9 and 10. Their colour depends on the camouflage colour in their background.

La-5FN

