

Ask for other AIRFIX Models in this Series.

PLEASE OPEN CAREFULLY — INSTRUCTIONS OVERLEAF

The Sea Hawk has been developed and produced by Armstrong Whitworth from the Original Hawker Aircraft design, and is now the standard carrier-borne fighter-bomber in the Royal Navy. It is also in service with the Netherlands and German forces.

The Sea Hawk's original design dates back to 1944, when Hawker Aircraft initiated the design of a single-seater interceptor for the Royal Air Force, resulting in the P.1040. Although this was not adopted by the Air Force the design was adopted to meet Naval requirements and the first prototype flew in September 1947.

The first Sea Hawks were produced by the parent company, which later handed over production to Sir W. G. Armstrong Whitworth Aircraft.

Progressive development by this company resulted in the later versions of the Sea Hawk, strengthened to carry heavy external loads and suitable for the fighter-bomber role. In 1956 the earlier Nene power plant gave place to the more powerful Nene 103, with increased performance, giving a new lease of life to the already well-tried and popular aircraft.

The Sea Hawk is powered by a 5,400 lb.st. Rolls-Royce Nene 103 turbojet, giving a speed of approximately 630 m.p.h. Armament consists of four 20 mm cannon, and the folding wings can carry bombs, rockets and long range fuel tanks. Wing span: 39 ft. Length: 39 ft. 8 ins.

ARMSTRONG WHITWORTH SEA HAWK

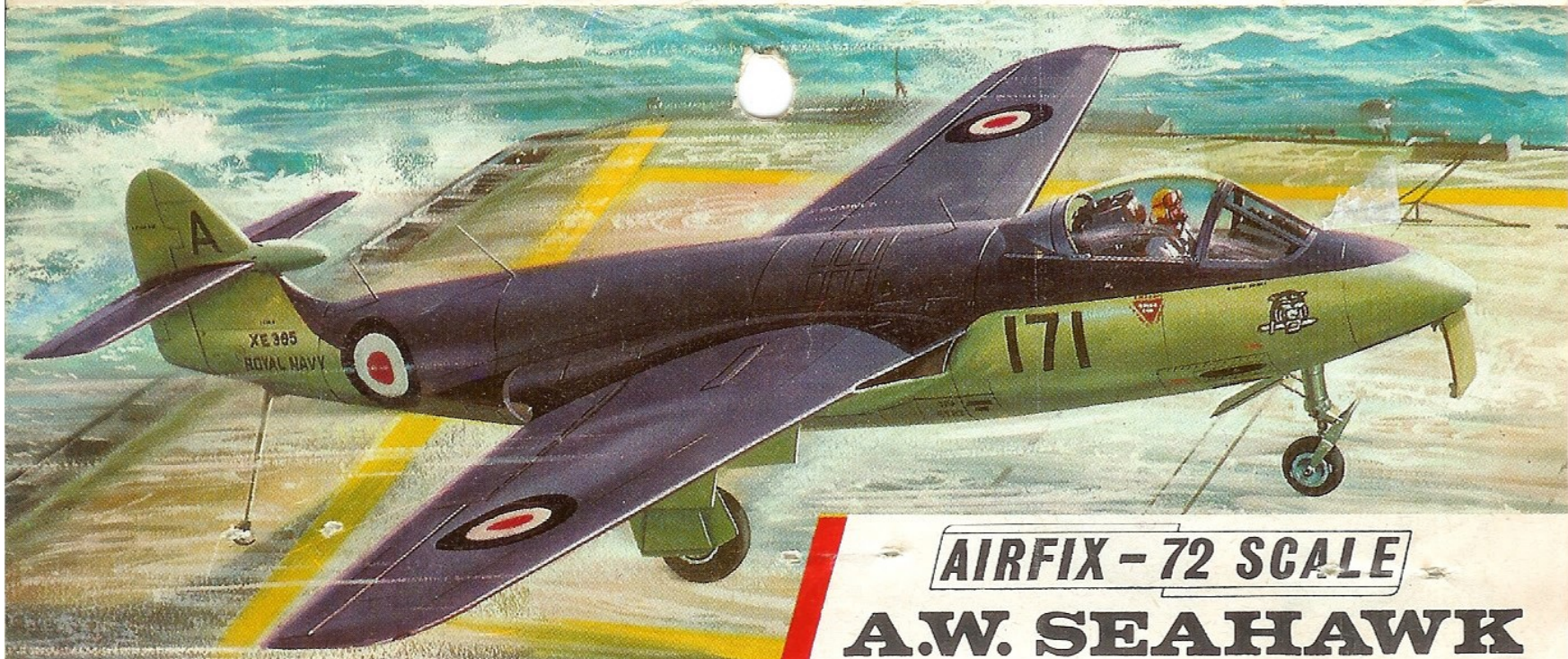

AIRFIX - 72 SCALE

A.W. SEAHAWK

4

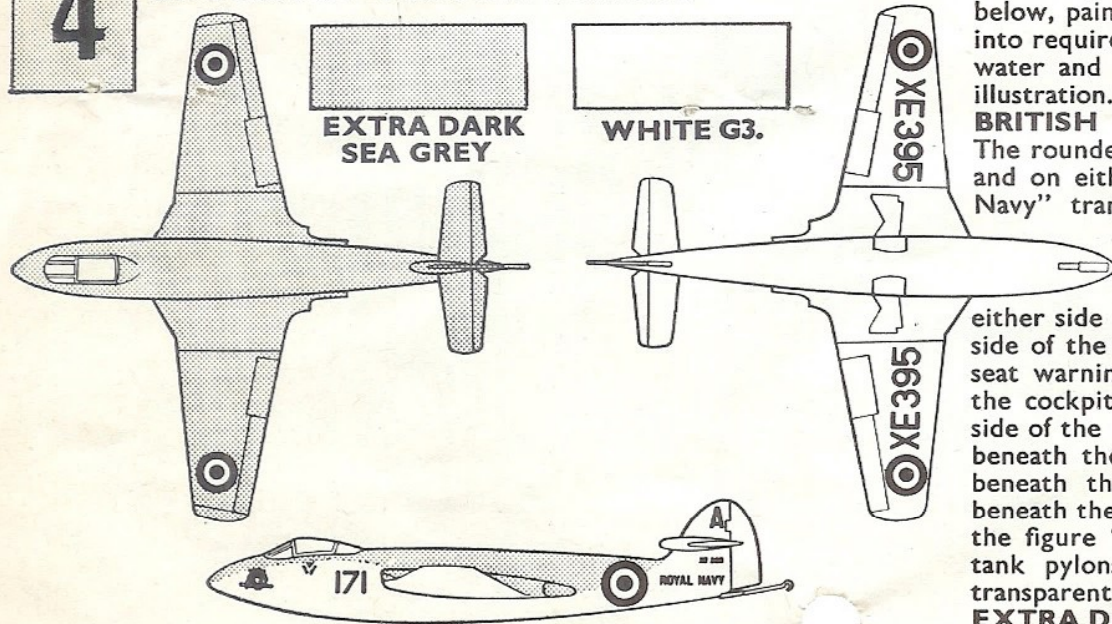
SUGGESTED COLOUR SCHEME

According to version you wish to model, read notes below, paint and then apply transfers. Separate sheet into required number of subjects, dip each into warm water and slide off backing into position shown on illustration.

BRITISH NAVAL VERSION

The roundels are applied above and below each wing and on either side of the rear fuselage. The "Royal Navy" transfers are applied to the fuselage sides directly behind roundels with the small serial numbers immediately above.

The letters "A" are applied to either side of the fin, and the figures "171" to either side of the fuselage, behind the cockpit. The ejector seat warning triangles are applied directly beneath the cockpit and the squadron tiger badge to either side of the nose. The large serial numbers are applied beneath the wings, so as to be read from the rear beneath the starboard wing, and from the front, beneath the port; note that it is necessary to separate the figure "5", so as to fit between the bomb and tank pylons. The aircraft name is applied to the transparent base.

EXTRA DARK SEA GREY. All upper surfaces.

WHITE G3. All under surfaces.

BLACK M6. Bombs, tyres, jet orifices.

SILVER G8. Undercarriage legs.

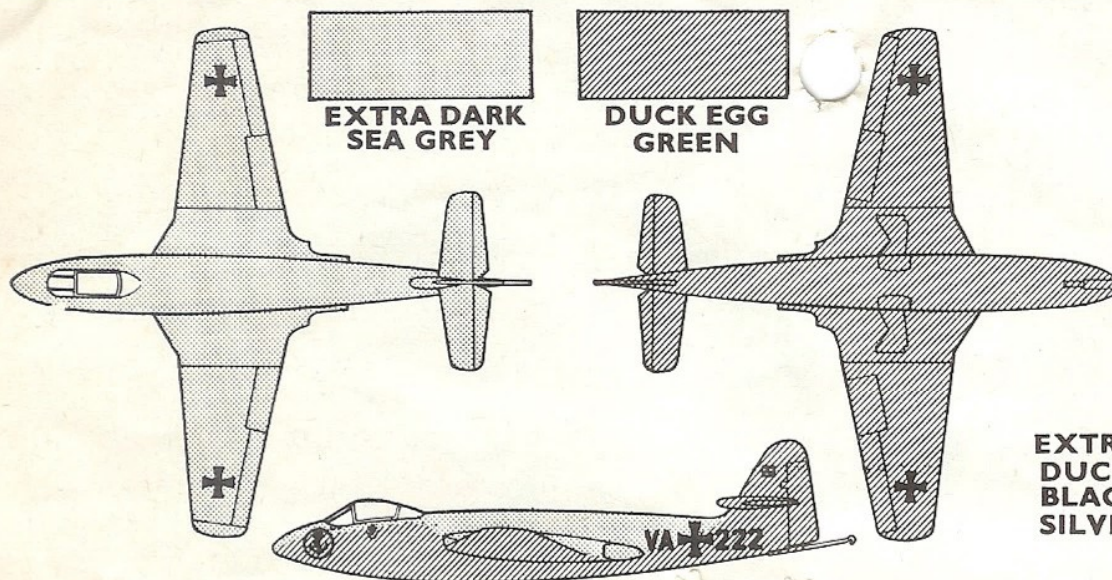
**WEST GERMAN VERSION.**

The national crosses are applied above and below each wing, and the markings with the identification numbers to the rear fuselage sides. The ejector seat warning triangles are applied beneath the cockpit and the anchor insignia on either side of the nose. The fin flashes are applied on either side of the fin, black uppermost. The aircraft name is applied to the transparent base.

EXTRA DARK SEA GREY. All upper surfaces.

DUCK EGG GREEN. All under surfaces.

BLACK M6. Bombs, tyres, jet orifices.

SILVER G8. Undercarriage legs.

AIRFIX CONSTRUCTION KIT

1/72 SCALE MODEL CONSTRUCTION KIT

SEA HAWK

INSTRUCTIONS

PAINT ALL DETAILS AND LET DRY BEFORE ASSEMBLING (SEE SECTION 4)
N.B. FOR PAINTING USE "AIRFIX" PAINTS, FOR FIXING USE "AIRFIX" POLYSTYRENE CEMENT

1

FUSELAGE ASSEMBLY

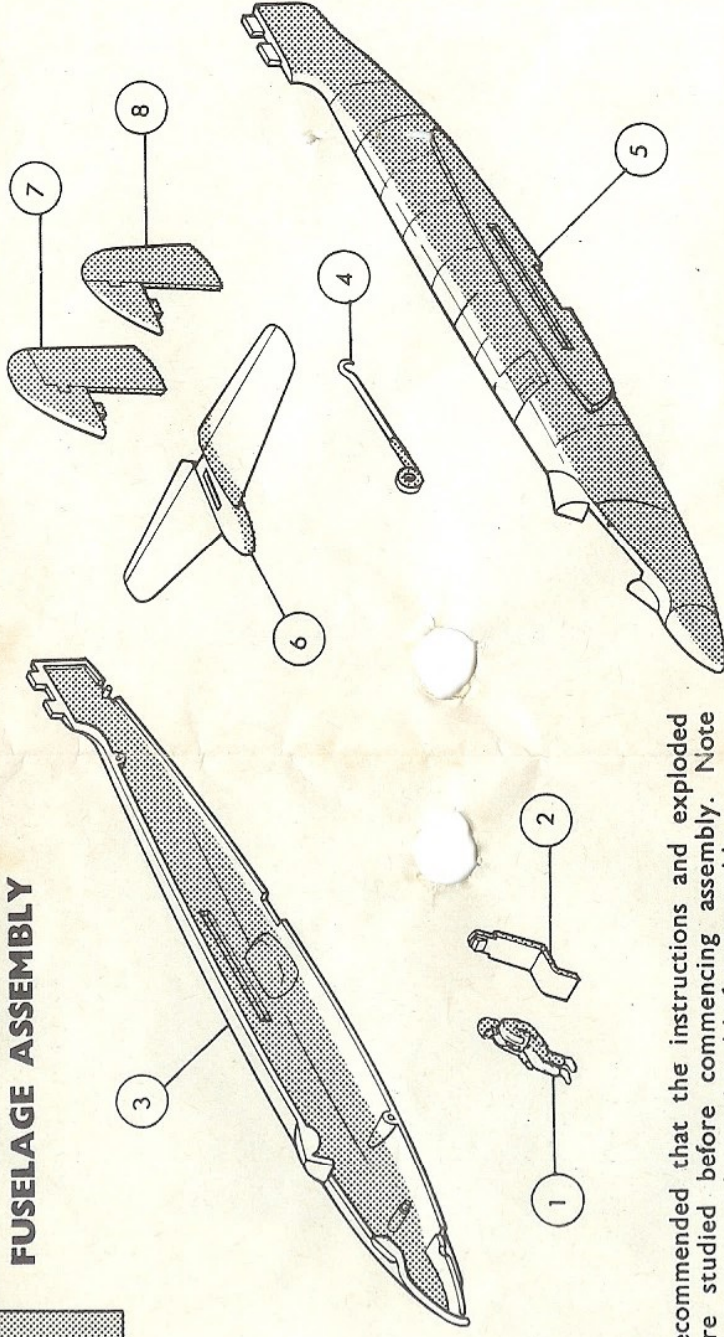

It is recommended that the instructions and exploded view are studied before commencing assembly. Note that some parts are best painted before assembly.

1. Cement pilot (1) to seat (2) after first painting if required.
2. Cement seat onto location in starboard fuselage half (3) and position arrester hook (4) on locating pivot in rear of starboard fuselage half.
3. Cement together port (5) and starboard fuselage halves,

ensuring no cement comes into contact with working arrester hook.

4. Locate and cement tailplane (6) to rear fuselage.
5. Select either the German (7), or the British (8) fin and rudder and cement in position.

2

WING ASSEMBLY

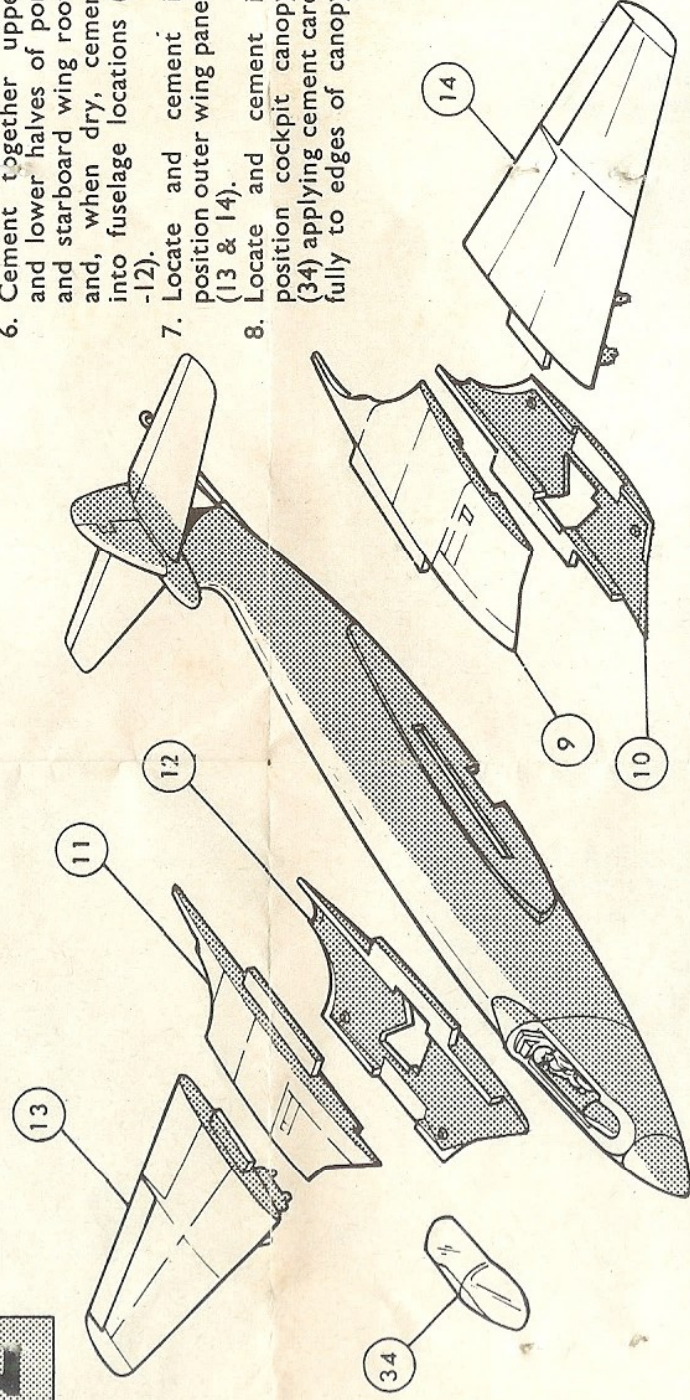

6. Cement together upper and lower halves of port and starboard wing roots and, when dry, cement into fuselage locations (9-12).

7. Locate and cement in position outer wing panels (13 & 14).

8. Locate and cement in position cockpit canopy, (34) applying cement carefully to edges of canopy.

position cockpit canopy, (34) applying cement carefully to edges of canopy.

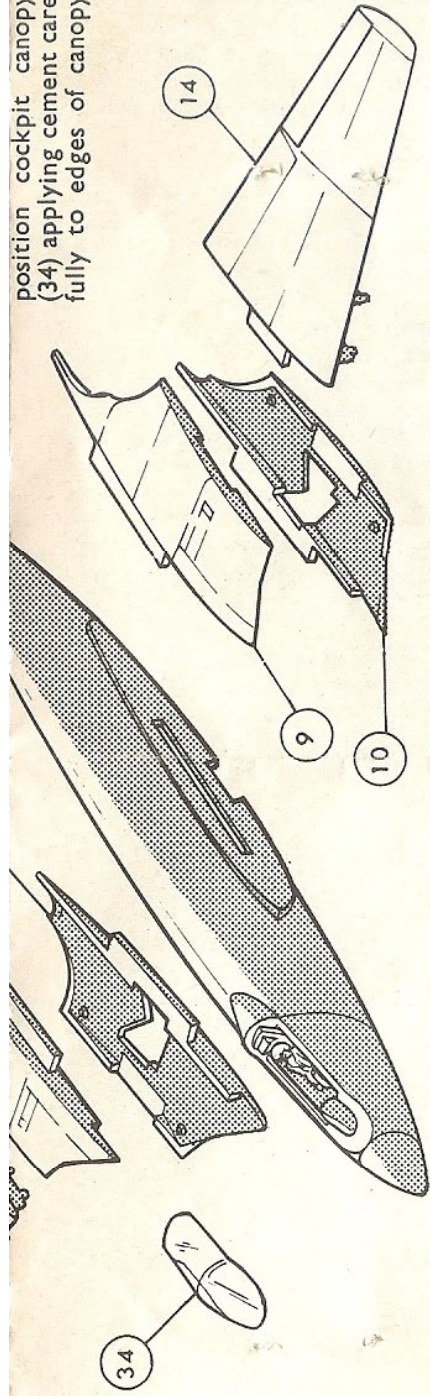

3

UNDERCARRIAGE ASSEMBLY

The desired undercarriage position should now be selected.

9. If the model is desired to stand upon the undercarriage the wheels (16 & 18) should now be cemented to the main undercarriage legs (15 & 17) and the legs cemented into the locating bushes within the wheel wells. For a model in flying position these parts should be discarded.
10. The inner undercarriage doors (19 & 20) should now be positioned, for a model with extended undercarriage, they should be cemented to the projecting pins on the undercarriage legs, and for a flying position cemented directly into the fuselage recess.
11. Similarly the outboard undercarriage doors (21 & 22) should be located, either cemented into the ends of the undercarriage well, or for a retracted undercarriage cemented straight into the wing opening, to lay flush with the wing.
12. The nose wheel undercarriage (23) is cemented into the locating hole in the nose recess, or omitted for the model with retracted undercarriage.
13. Locate and cement the nose wheel doors, (24 & 25) the front vertically down from the front of the recess, and the rear angled back from the rear; for a flying position cement both doors flush with fuselage.
14. Locate and cement together upper and lower halves of drop tanks and bombs (26-33) and, when dry, cement to underwing pylons, the drop tanks inboard and the bombs outboard.
15. Cement together both parts of stand.
16. Cement arm of stand into slot provided in fuselage. If the stand is not employed the model can be made to assume its correct position by lowering the arrester hook to the ground.

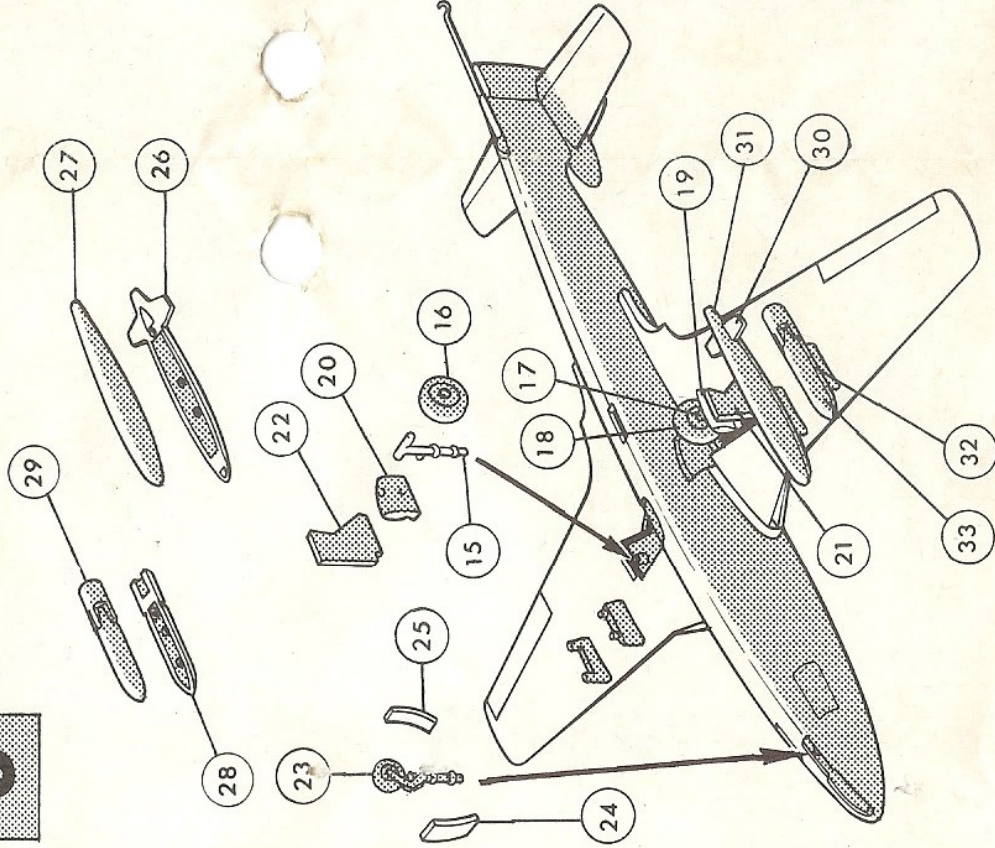

NOTE:—If it is wished to paint the model, it should be done at this stage.

The AIRFIX Range includes over 300 Constant Scale Kits and among them are Aircraft, Modern and Veteran Cars, Warships and Classic Ships, Fighting Vehicles, Historical Figures, Rolling Stock and Trackside Series, OO figures and Museum Models. AIRFIX also produce **MotorAce** Home Car Electric Racing Sets and Accessories, *New Artist* Painting by Numbers, **BETTA BILDA** Building Sets and a wide range of Toys and for the modeller, publishes Airfix Magazine. For full details of each range see separate catalogues.

TO.....
.....
.....
.....
.....

Address above label to yourself using block letters

In case of complaint fill in details and return slip to-

**AIRFIX PRODUCTS LTD. (DEPT. C)
HALDANE PLACE, LONDON, S.W.18**

**NAME OF
CONSTRUCTION KIT**

MY COMPLAINT IS

PART No.

DATE.....