

EagleCals
EC#40

1/72

1/48 1/32

eagle
EDITIONS LTD.

Messerschmitt
Bf 109 G-68
JG 1, JG 11, and JG 54



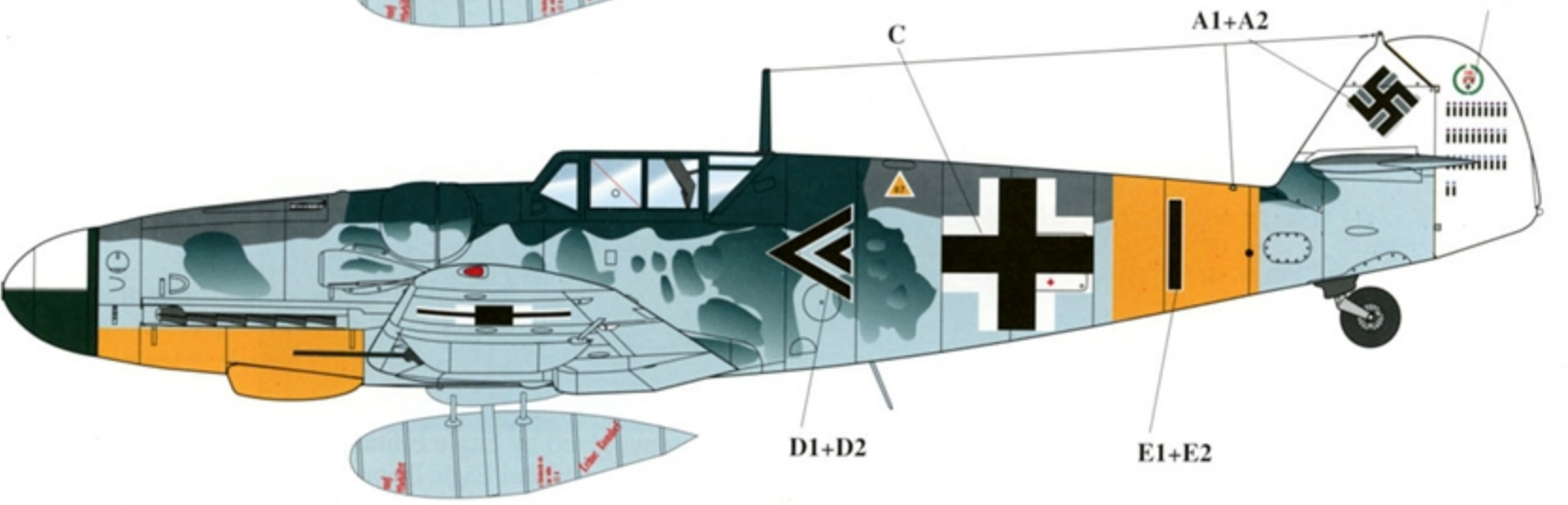
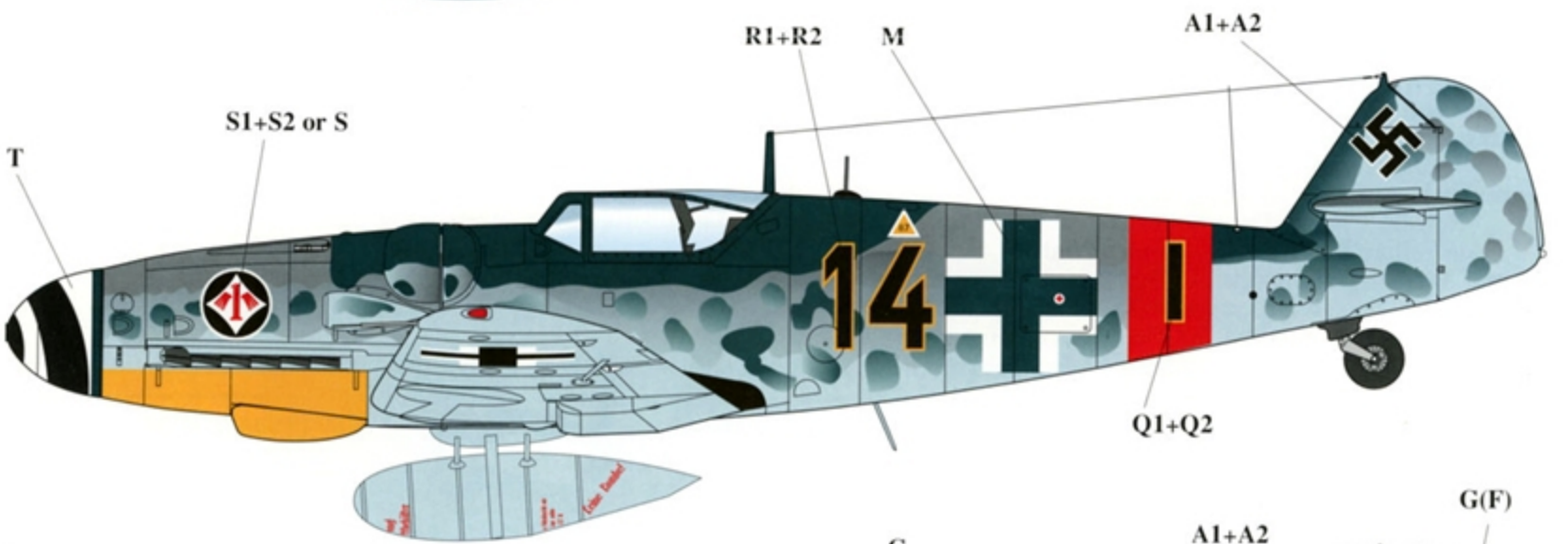
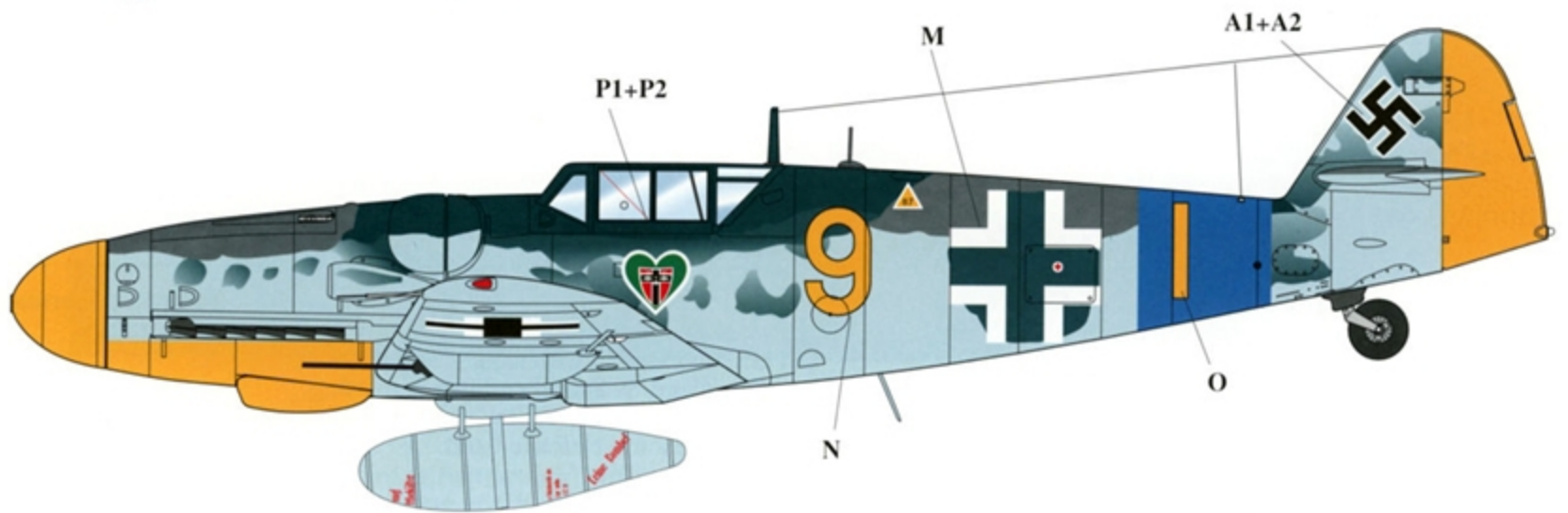
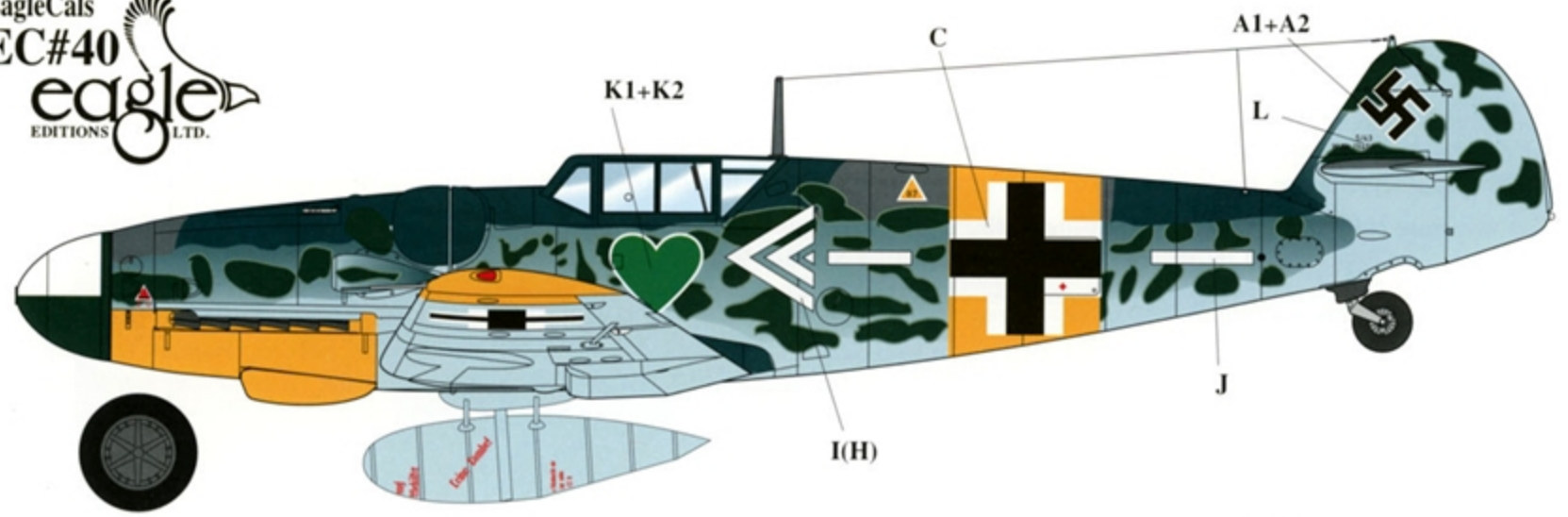

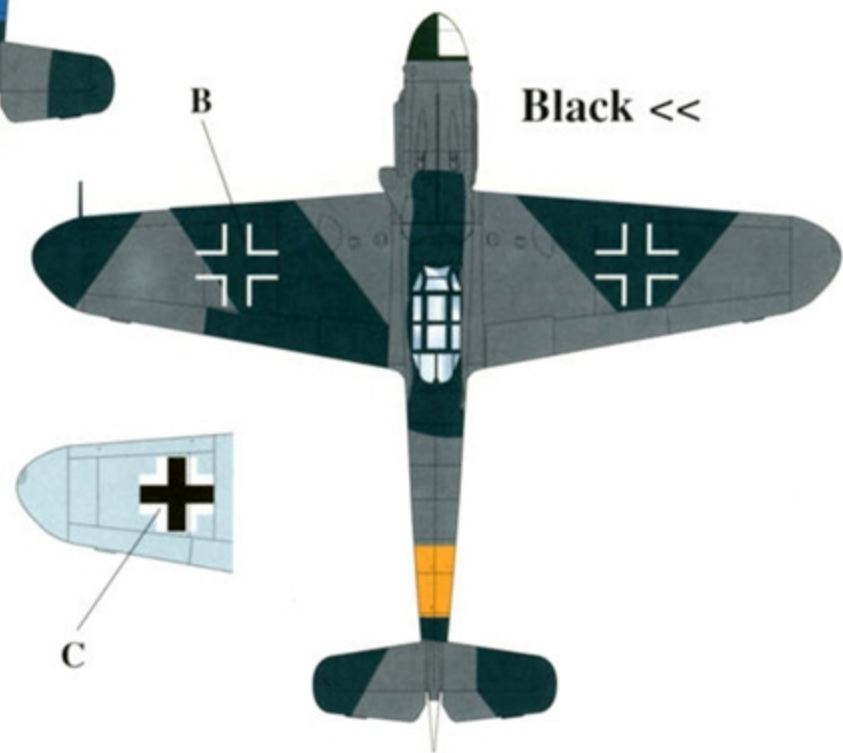
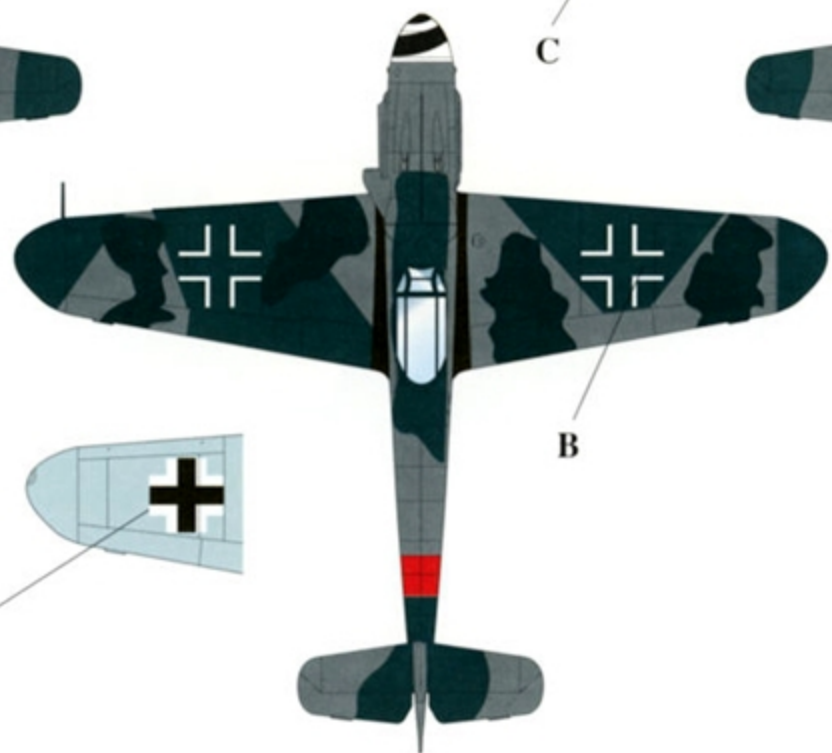
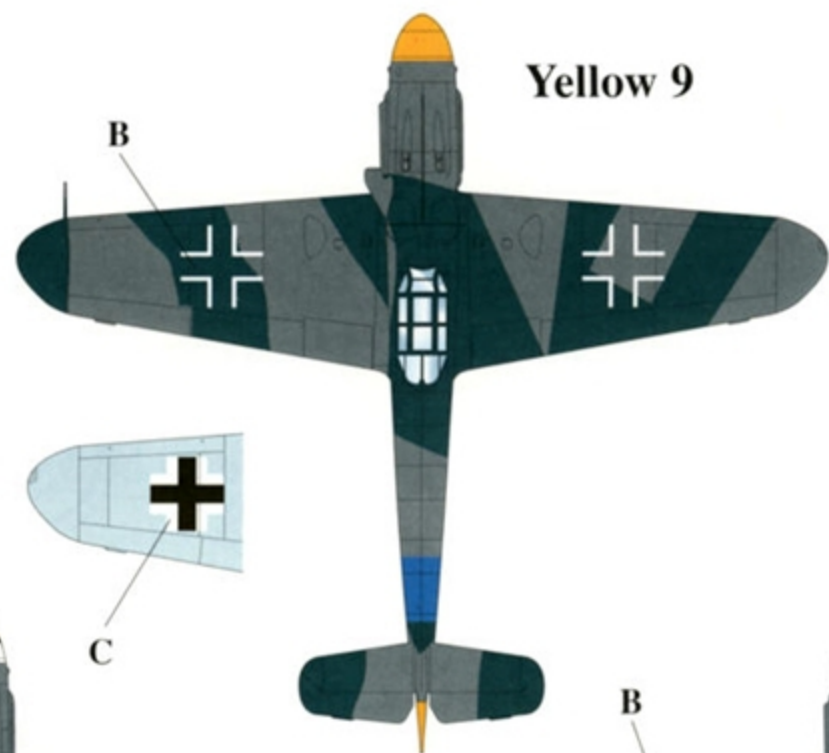
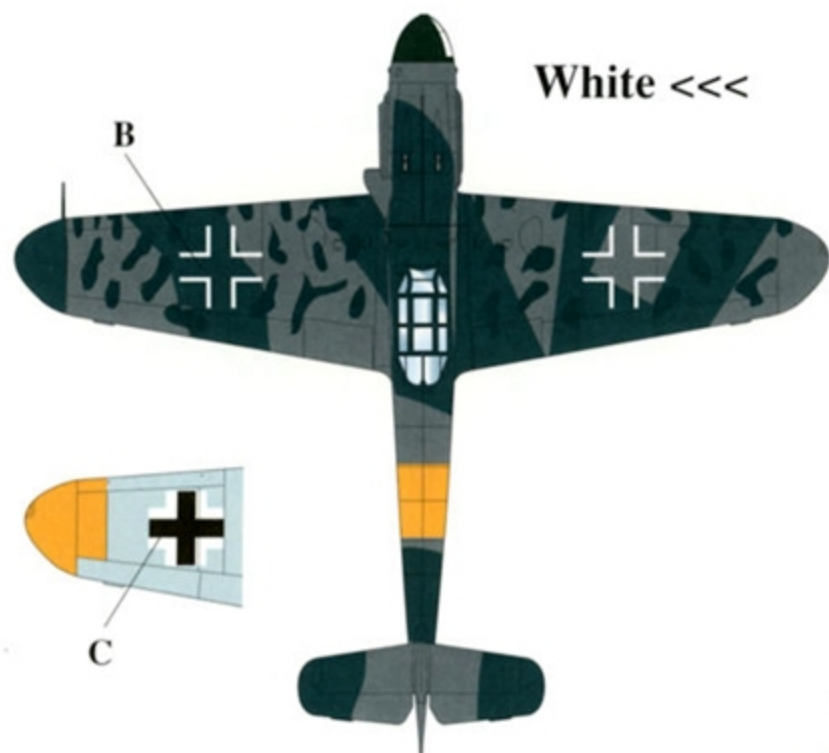

Black 14



“Yellow 9”

Fw. Emil Hecker flew this
“Yellow 9” G-6 in 9./JG 54.

Notable features of this Bf 109 G-6:

- * Tall tail with Yellow rudder
- * JG 54 Blue fuselage band
- * Yellow undercowling
- * Yellow spinner
- * Underwing 20 mm cannon gondolas
- * Short antenna mast
- * DF loop
- * FuG 25a antenna
- * RLM 74 fuselage cross

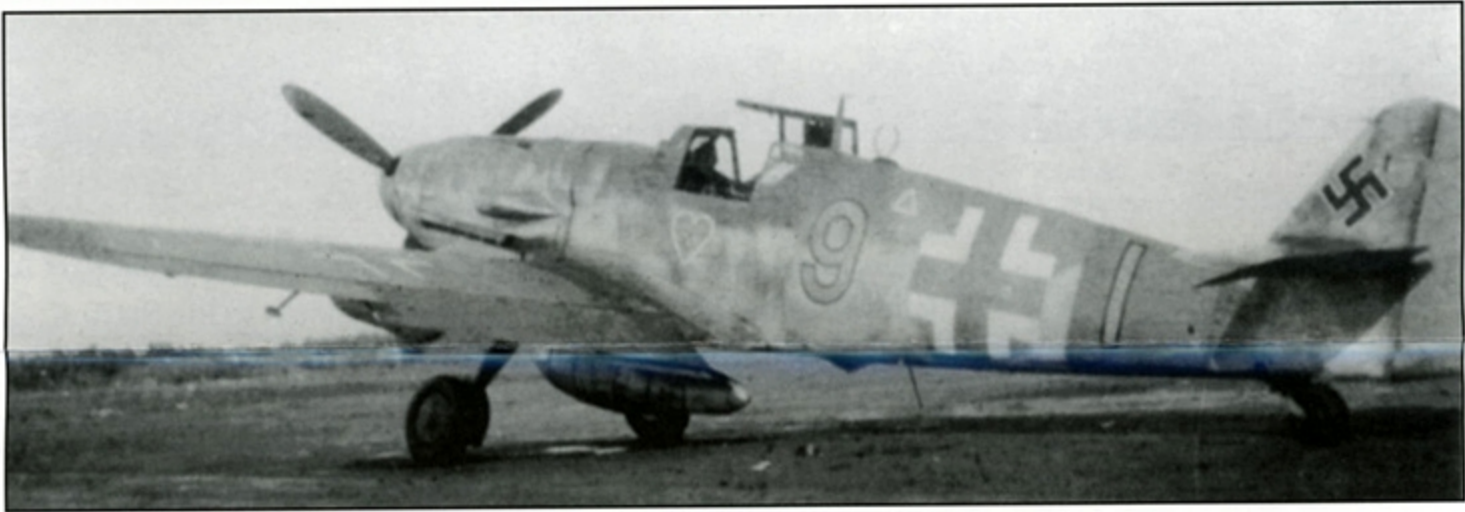

Black <<

Hptm. “Toni” Hackl’s Bf 109 G-6 flown while he was *Gruppenkommandeur* of III./JG 11.
Unfortunately in this photo, he is standing in front of the tail, blocking the view of the victory markings. Luckily there is a good photo of the rudder of his Fw 190 that shared the same design.



The tall antenna mast and missing DF loop are evident. The bright sun has lightened the Yellow band between the two men making it appear almost White.

EagleCals #40

Messerschmitt Bf 109 G-6s

Manufactured in greater numbers than any other Messerschmitt 109 variant, the G-6 has always been very popular with the modelers considered to be the classic Bf 109 by many. Luftwaffe pilots complained the *Beule* or bumps covering the breaches of the MG 131 13 mm machine guns reduced speed, nevertheless, they contribute to the distinctive personality of the Bf 109. Also the bigger guns were heavier affecting performance.

For accurate color reference we recommend the Luftwaffe Color Chart published by Eagle Editions Ltd. featuring paint chips prepared by Warnecke and Böhm available from your local hobby shop or Eagle Editions Ltd.

"White <<<" **Bf 109 G-6** **W. Nr. 19456** **Pilot: Oberst Hannes Trautloft** **JG 54** **Summer 1943**

This interesting aircraft was originally a G-4 type that was converted to a G-6 in May 1943. It was probably *Oberst Hannes Trautloft's* last personal aircraft before he was promoted from being the *Kommodore* of JG 54 "*Grunherz*" to the staff of the *General der Jagdflieger* on 6 July 1943. It appears this aircraft in service with JG 54 and ultimately was test flown by other staff officers, such as *Oberst Günther Lütow* during the fall of 1943.

Features: Tall antenna mast, no DF loop, no FuG 25a. Padded solid armored headrest. No overhead armor. Notched tail wheel opening. No cockpit fresh air scoops on quarter panel under windscreen. No umbrella holders. Boot may not be on tail wheel strut. Early spoke style main wheels with 660 mm X 160 mm tires (standard on G-6).

Colors: Undersurfaces; 76 Light Blue, Uppersurfaces 75 Gray-Violet/ 74 Gray Green. Oversprayed with 70 Black-Green/71 Dark Green mottling on fuselage and wing leading edge. Yellow undercowling and band behind fuselage, note slightly wider than cross in forward panel line. Yellow underwing tips. Spinner, 1/2 70 Black-Green, 1/2 White. Prop Blades 70 Black-Green

National Markings: 900 mm Black with White outline fuselage cross; 350 mm Black/White *Hakenkreuz*

Wings; upper 1000 mm White outline crosses (provisional), lower 900 mm Black/White cross

Stencilling: Factory standard **Reference:** Prien, Jochen. *Messerschmitt 109 F,G, & K* page 114
Photo printed on instruction sheet

"Yellow 9" **Bf 109 G-6** **Pilot: Fw. Emil Hecker** **9./ JG 54** **Spring 1944** **Ludwigslust, Germany**

Features: Standard canopy with solid padded headrest. Short antenna mast, DF loop and base, FuG 25a antennas intact. Underwing 20 mm cannon gondolas. Tall tail, no external trim tabs. JG 54 Green Hearts with III. *Gruppe* badge on both sides of fuselage, 9. *Staffel* emblem is missing.

Colors: Undersurfaces; 76 Light Blue, Uppersurfaces 75 Gray-Violet/ 74 Gray Green. Yellow spinner, undercowling and rudder. Prop blades 70 Black-Green. JG 54 Blue Home Defense band.

National Markings: 900 mm 74 Gray-Green fuselage crosses, 350 mm Black/white *Hakenkreuz*

Wings; upper 1000 mm White outline crosses, lower 900 mm Black/White outline cross (provisional).

Stencilling: Factory standard. **See Photos**

"Black 14" **Bf 109 G-6** **8./ JG 1** **February 1944** **Detmold, Germany**

Both pilot and W.Nr. are unknown. *Erla-Hauba* canopy. Unclear if battery box is present.

Features: Short antenna mast, DF loop and base, FuG 25a intact. *Panzer* glass panel armored headrest. No umbrella holders.

Colors: Undersurfaces; 76 Light Blue, Uppersurfaces 75 Gray-Violet/ 74 Gray Green. Yellow undercowling, Black wing root area. Red JG 1 Home Defense fuselage band with III. Black *Gruppe* bar superimposed. Black 14 and III. *Gruppe* vertical bar trimmed in Yellow. Spinner Black/White spiral. Prop blades 70 Black-Green.

National Markings: 900 mm 74 Gray-Green fuselage cross; 350 mm Black/White *Hakenkreuz*

Wings; upper 1000 mm White outline crosses, lower 900 mm Black/White trimmed with Black.

Stencilling: Factory standard. JG 1 emblem on port side of engine cowling only

Reference: Prien, Jochen; Rodeike, Peter. *Jagdgeschwader 1 and II Teil 2* 1944 page 749, 750

"Black <<" **Bf 109 G-6** **Pilot Hptm. Anton Hackl** **III./JG 11** **Mid-January 1944** **Northern Germany**

Gruppenkommandeur of III./JG 11, "Toni" Hackl flew this Bf 109 G-6 against the American escort fighters and an Fw 190 for the Anti bomber role. His 132nd and 133rd victories were achieved on 11 June 1944 over 2 B-17s.

Features: Tall antenna mast, no DF loop, FuG 25a seems to be intact. No umbrella holders. Pilot armor type not clear in photo. Underwing 20 mm cannon gondolas.

Colors: Undersurfaces; 76 Light Blue, Uppersurfaces 75 Gray-Violet/ 74 Gray Green. All White tail section, Yellow JG 11 *Reich's* Defense band, possibly Yellow undercowling. Spinner 70 Black-Green with White sprayed section. Prop Blades 70 Black-Green

National Markings: 900 mm Black with White outline fuselage crosses; 350 mm Black/White *Hakenkreuz*.

Almost impossible to ascertain is the way the *hakenkreuz* is masked off and sprayed in the only known photo. French artist Richard Goyat's excellent color profile published in Barbas' book *Planes of the Luftwaffe Aces Vol. 1* is probably correct.

Wings; upper 1000 mm White outline crosses, lower 900 mm Black/White crosses (Provisional).

Stencilling: Factory standard. **Reference:** Photo printed on instruction sheet

© 2002 Eagle Editions Ltd. All images/photos copyrighted by Eagle Editions Ltd.

No copies may be reproduced without written consent from publisher Eagle Editions Ltd.

The color schemes depicted are the artist's interpretations of the available photographic references only. The final decision resides with the modeler.

NOTE: Stencil diagram drawings are representational only. Check your references for the specific details and differences between variants.

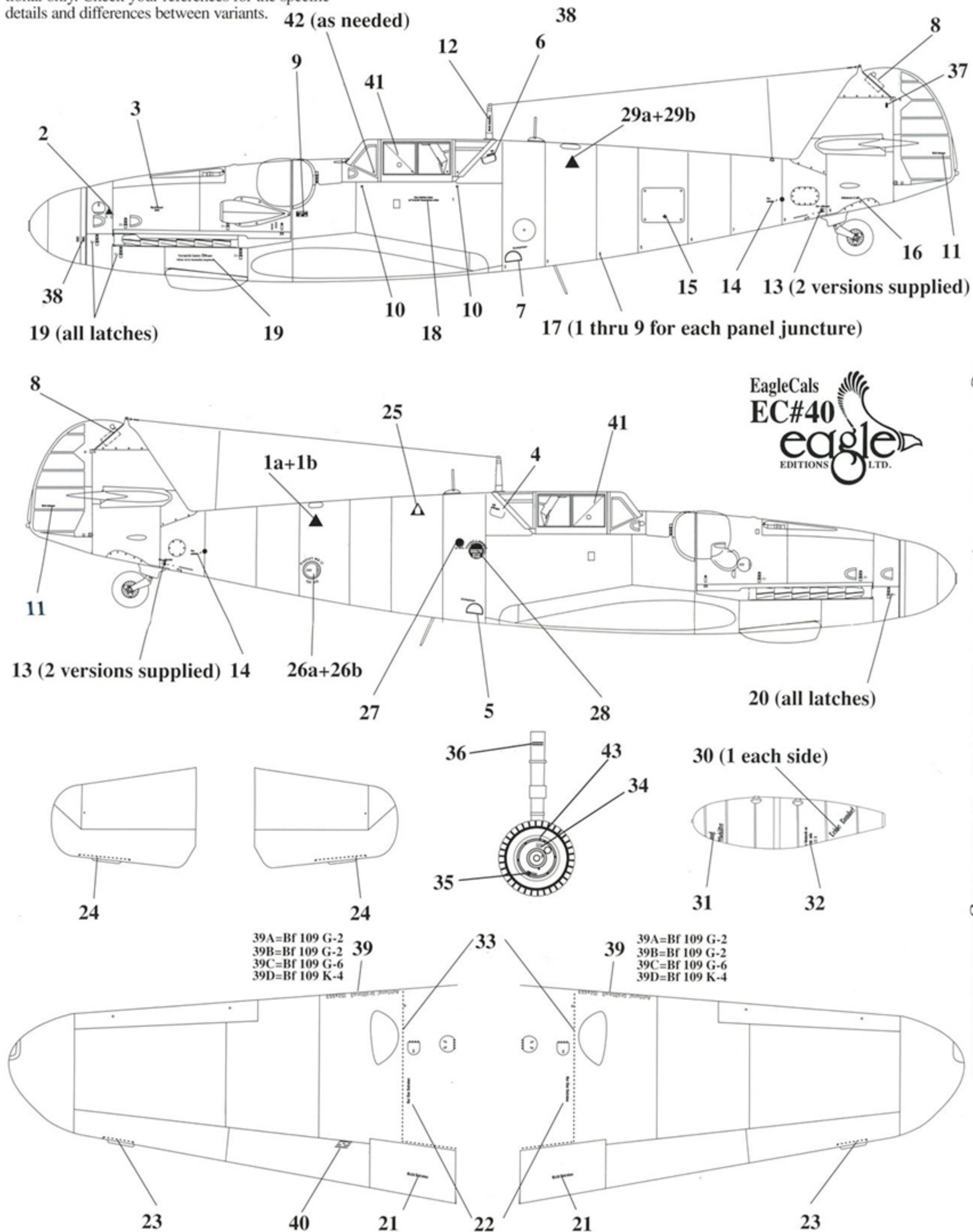

EagleCals EC32-40, EC48-40 & EC72-40 © 2002 Eagle Editions Ltd.