

**AEC**

**4x4 Armored Command Vehicle  
"Dorchester"**



\*\*Special thanks from the bottom of our heart to:  
大塚 康生  
Alistair Morton  
"David Haugh & Patrick Keenan of WarWheels.net"  
Leife Hulbert  
Ossie Orsbourn  
RAAC Museum, Paul Handel  
REME museum

Prior to outbreak of WWII, the British Army was planning a wheel armoured commander vehicle to provide the armoured troop commander and staff an appropriate command post.

CS9/LAC 4x4 chassis from Morris and Guy Lizard 4x4 chassis were adopted from 1937 to 1939, and 36 armoured commander vehicles completed. Those vehicles were used in inland UK. A few Guy Lizard armoured commander vehicles were sent to North Africa, saw services with the 8th Army. At the same time armoured regiments were blooming, obviously more armoured commander vehicles were needed.

Associated Equipment Company, who was best known by London double deck buses, was awarded with a contract from the Ministry of War Transport in April 1940, to produce a Matador 4x4 artillery tractor and an armoured commander vehicle with Matador 4x4 chassis. By 1941, AEC devoted itself to military needs totally, and the armoured commander vehicle entered mass production. With armours up 10-12 mm thick and weight up to 12.2 tons, the vehicle was able to accommodate up to 7-8 personnel. High Power and Low Power versions were built, with different radio equipment. A total of 415 were produced. It was nicknamed Dorchester by the troops, after the luxury hotel in London because it is very comfortable. The AEC Armoured Command Vehicle firstly saw service in North Africa Campaigns in the British Army service and throughout the war. 7 vehicles were handed to the Australian troops.

第二次大戦勃発前、イギリス陸軍は装甲部隊の指揮官と幕僚達の乗車する、装輪式装甲指揮車輛の開発を計画していた。

1937年から1939年の間に、モーリスCS9/LAC装甲車と、ガイ・リザード装甲車を利用して、36輛の装甲指揮車輛が完成した。これらの車輛は主に英国国内で使用されたが、一部のガイ・リザード装甲指揮車は第8軍によって北アフリカ戦線において使用された。この時期、装甲部隊は徐々に拡大しており、より多くの装甲指揮車輛が必要になるのは明白であった。

ロンドンの2階建てバスの製造で知られるAEC社(Associated Equipment Company)は、英戦争運輸部と1940年4月、マタドール4x4のシャーシを用いた、砲兵牽引車と装甲指揮車輛の製造契約を結んだ。1941年までに、AEC社は民間需要品の生産を取りやめ、軍需品の製造に専念、装甲指揮車も量産体制に入ったのだった。AEC社製装甲指揮車は、10~12mm厚の装甲を備え、重量は12.2トン、7~8名のスタッフが乗車することができた。異なる無線装置にあわせた高出力タイプと低出力タイプとが存在し、合計で415輛が製造されたのだった。大きく余裕のある快適な内部空間を持つことから、やがてロンドン的高级ホテルになぞらえて、「ドーチェスター」の愛称で呼ばれることとなったのである。AEC装甲指揮車は、はじめに北アフリカ戦線に配備され、その後大戦を通じて英軍によって使用されたのである。また7輛がオーストラリア軍に引き渡されて使用されたのだった。

二次大戰爆發之前,英國陸軍考量需要一種能夠提供裝甲部隊指揮官以及幕僚人員乘用,做為活動指揮部,並能滿足工作需要的輪型裝甲指揮車輛。

1937年至1939年間曾先後選擇以莫里斯(Morris) CS9/LAC 4x4裝甲車與蓋依蜥蜴(guy lizard) 4x4裝甲車的底盤為基礎,完成了36輛裝甲指揮車。這些車輛大部份服役於英國本土,少量的蓋依蜥蜴日後被送往北非的第八集團軍參與作戰,但這些指揮車的數量與日漸擴充的裝甲部隊相比顯得不成比例。

1940年4月,以生產倫敦紅色雙層公共汽車而知名的聯合設備公司(Associated Equipment Company)得到英國戰爭運輸部(Ministry of War Transport)的一紙合同,準備生產大量的鬥牛士4x4火砲牽引車,以及以鬥牛士4x4底盤為基礎的裝甲指揮車。1941年AEC公司完全停止了民間車輛的供應,戰爭期間全力投入軍需生產,裝甲指揮車也於此時進入量產,車身裝甲厚度達到10~12毫米,重量為12.2噸,能夠搭載7~8名的乘員,依不同的無線電配備而有高功率(HP)及低功率(LP)兩種型式,共生產了415輛,此車由於寬敞舒適的內部空間,戰場上大受歡迎,並以倫敦的著名的"多切斯特"(Dorchester)酒店為其命名,在北非戰場首度投入作戰,1943年並提供7輛交由澳洲軍隊使用,在英軍中"多切斯特"一直服役至大戰結束。

### Illustration:圖示說明



### Method For Applying Decals:

1. Clean Model Surface With Wet Cloth.
2. Cut Out Of Decal Sheet And Dip Them In Warm Water For 15 Seconds.
3. Place it on proper position on model.
4. Slide off base paper leaving decals On Model With Wet Finger Tip.
5. Move Decals To Exact Position, Push Out Excess Water Under Decal With Soft Cotton Cloth.
6. When Decals Get Dry Then Complete.

### 水貼紙使用說明:

1. 將模型表面擦乾淨
2. 將貼紙剪下泡入溫水中浸泡約15秒
3. 將泡濕之貼紙取出置於欲貼處旁
4. 用指尖輕推貼紙表面使其滑出底紙
5. 將貼紙調整至適當位置並輕擦拭水份
6. 待其自然乾燥後即完成

### Color list: 塗料表

Color	Brand	Gunze Sangyo			Humbrol	Revell	Lifecolor
		Hobby Color	Mr.Color	Mr.Color Spray			
Khaki green	卡其綠	H80	C54				
Brass	黃銅	H9	C9	J9	54	92	LC75
RLM71 Dark green	深綠	H64	C17		116		UA52
Gray FS26440	灰	H325	C325		183		UA24
Radome	天線罩	H318	C318		148		DR06
Flat white	消光白	H11	C62	J62	34	05	LC01
Red brown	紅褐	H47	C41		160	383	UA085
Dark sea gray	深海灰	H75	C25		27		UA93
Red	紅	H3	C3	J3	19	31	LC56
Silver	銀	H8	C8	J8	11	90	LC07
Tire black	輪胎黑	H77	C33+C62		85	302	LC02
Wood brown	木棕	H37	C43		169		FS12

# AEC Dorchester Armoured Command Vehicle

LP (low power) Armoured Command Vehicle

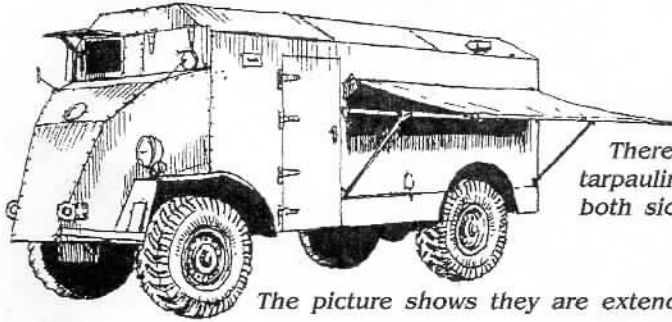

There are taraulins on both sides.

The picture shows they are extended.

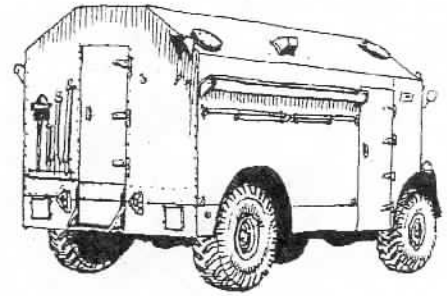

The Dorchester ACV disguised as the Matador, by Major Jasper Maskelyne.

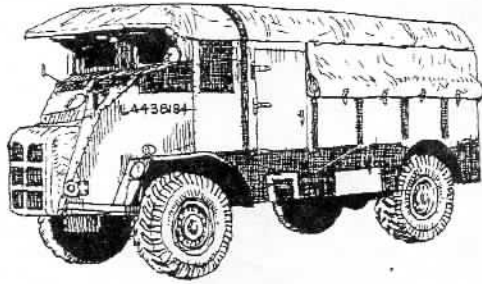

HP (High power) Armoured Command Vehicle

equipped with different radio equipment.

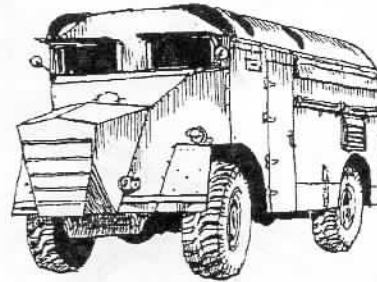

It is distinctive with streamlined roof.

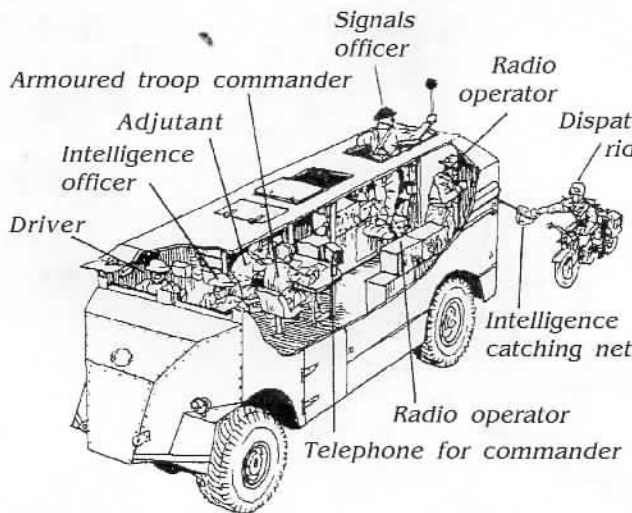

The seat in middle is for the commander. There is a board for map next to the driver.

A small number of the Dorchester were captured by the German Afrika Korps, and used by German high ranking officers, especially Rommel himself, in the North African Campaign.

German Army called them "Mammoths".



Front of the vehicle was heavily overpainted.

The famous "Moritze", British camouflage was retained. Tarpaulin was used for sunshade.

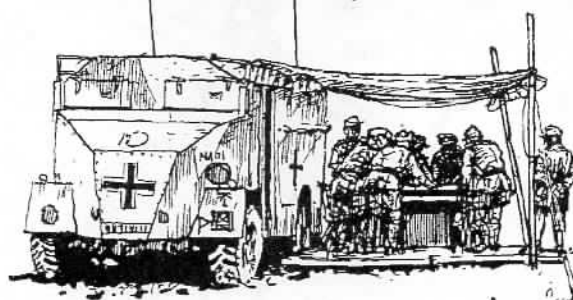

Shin. ueda

上田 信

1

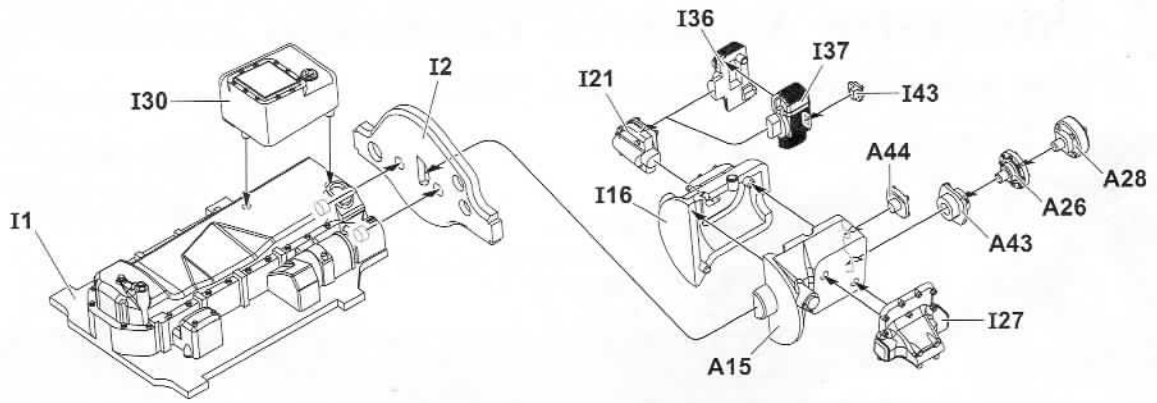

2

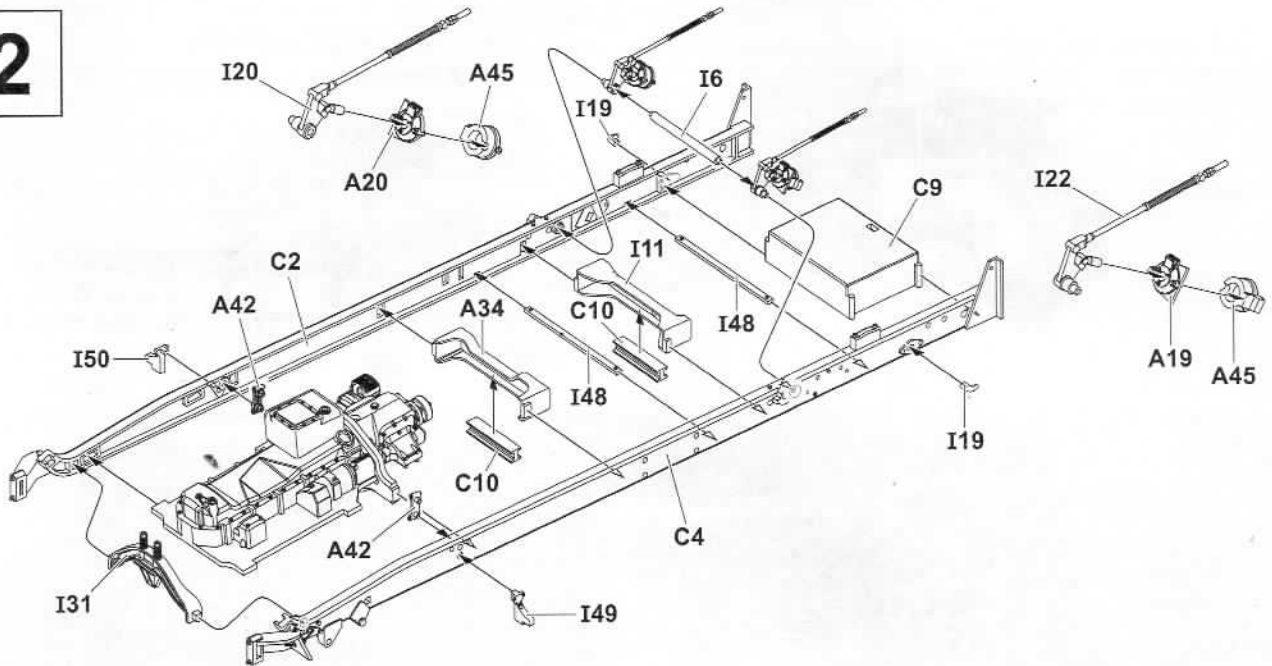

3

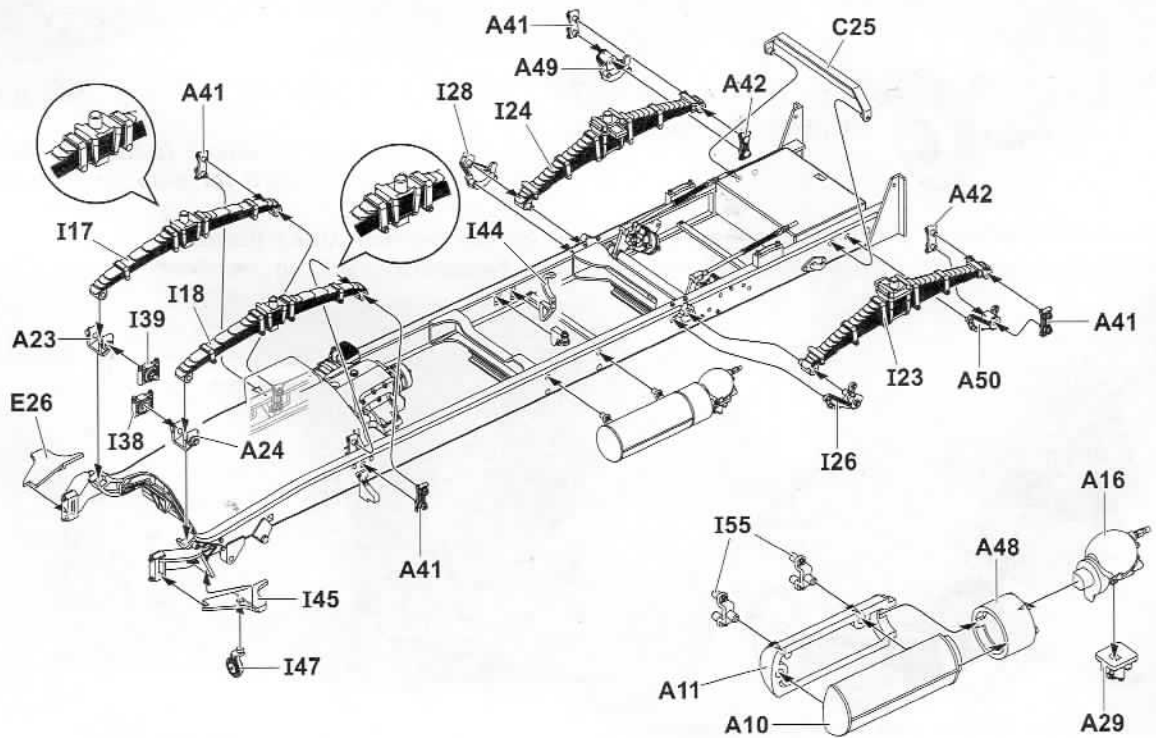

4

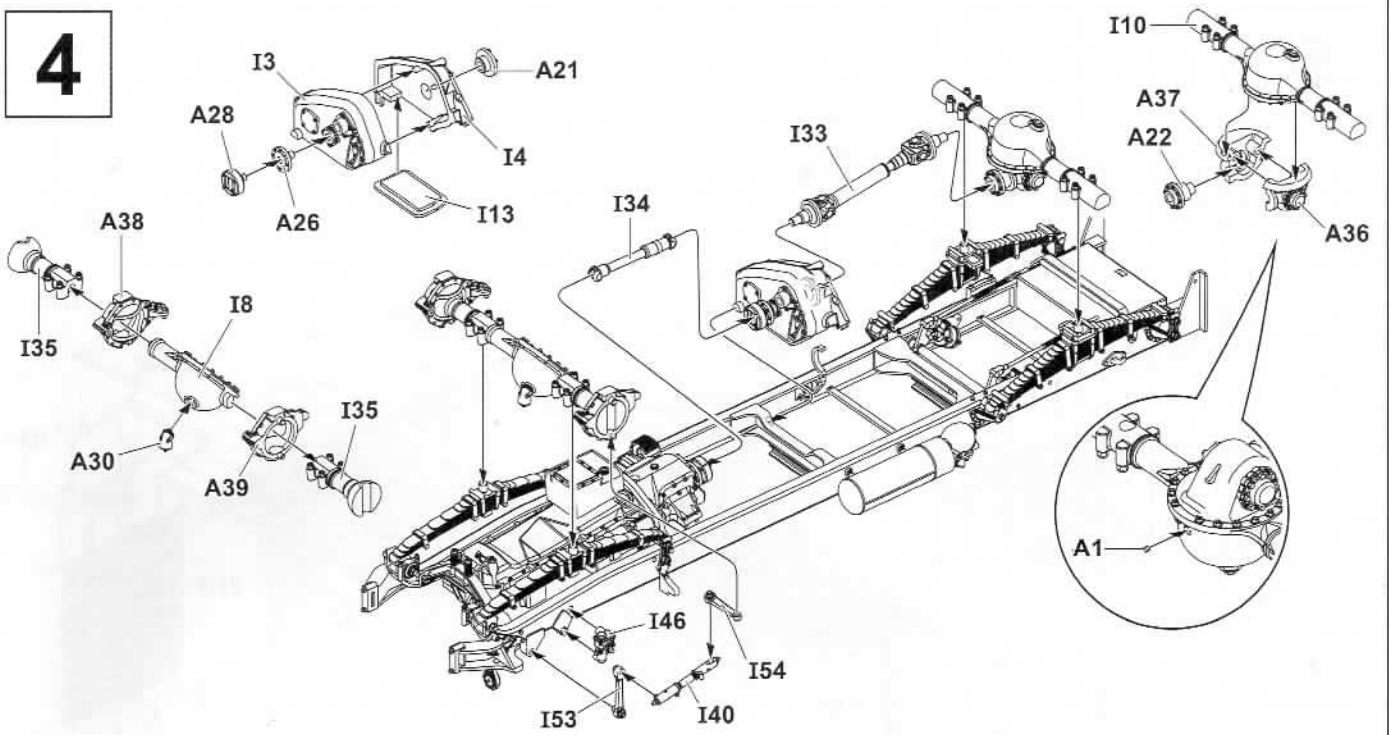

5

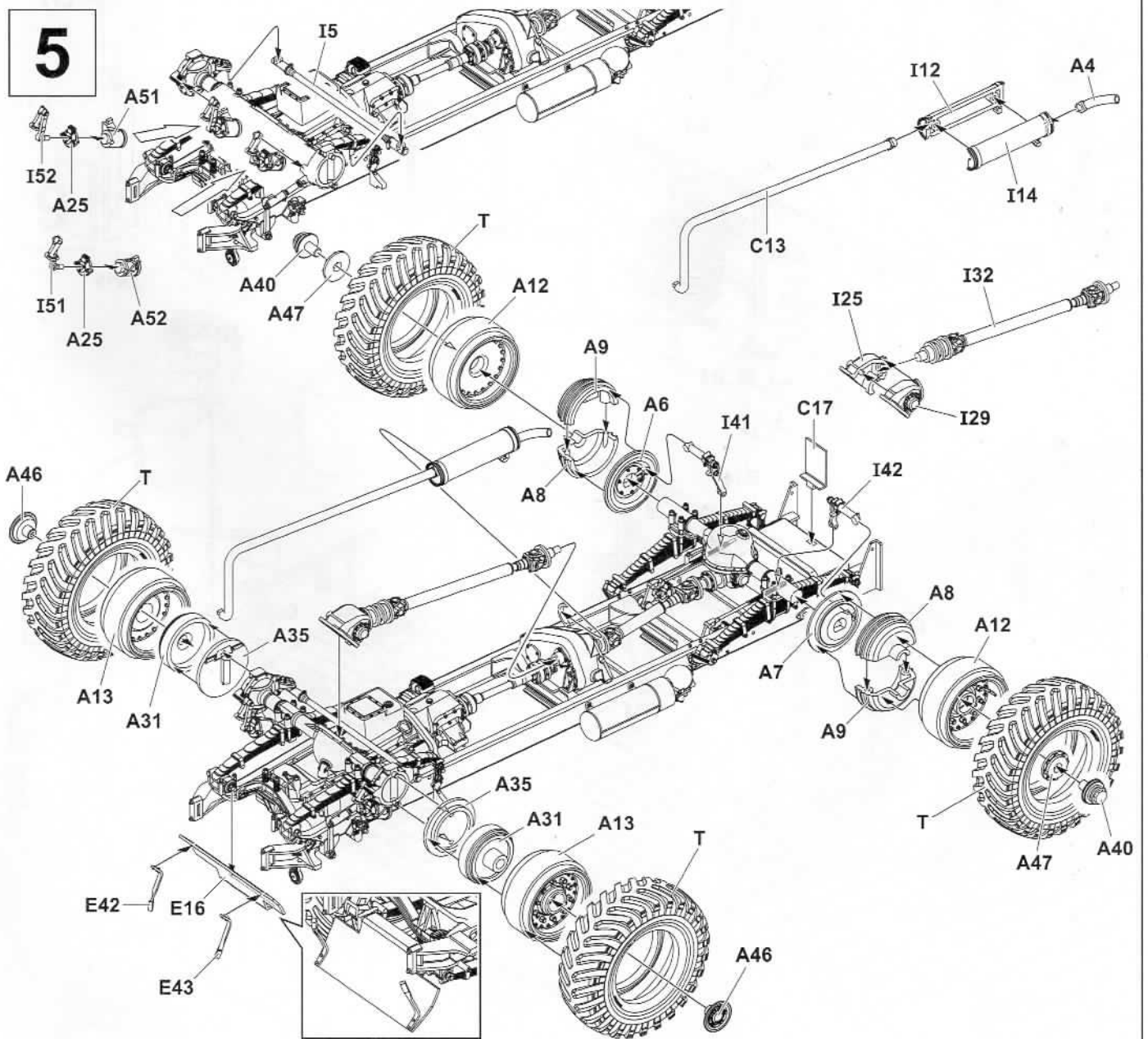

6

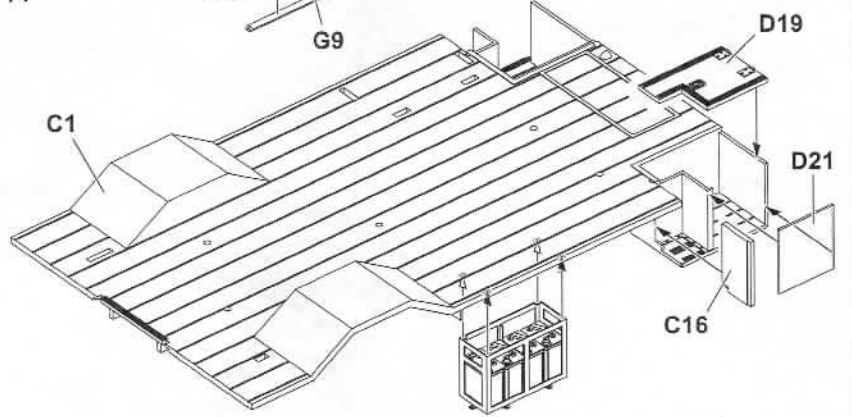
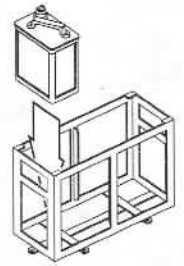
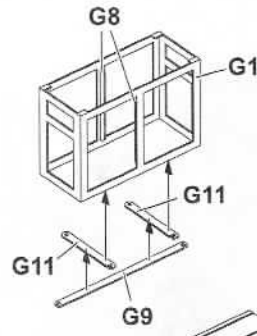
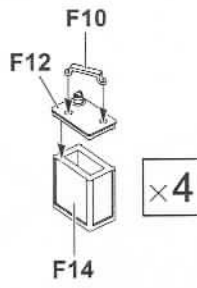
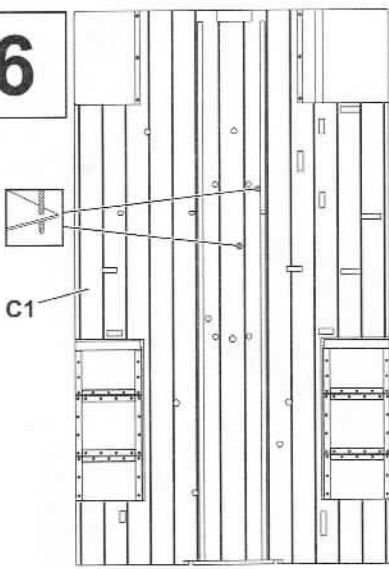

7

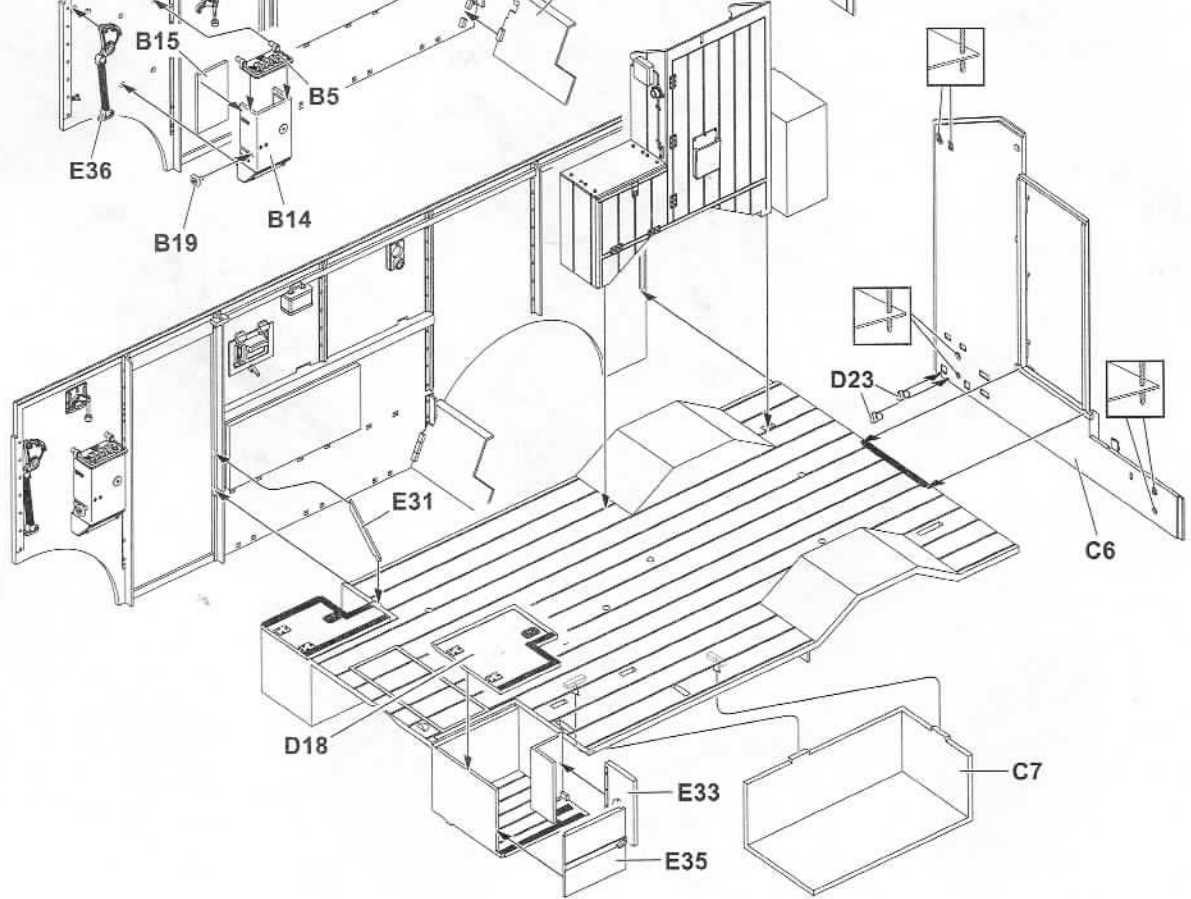
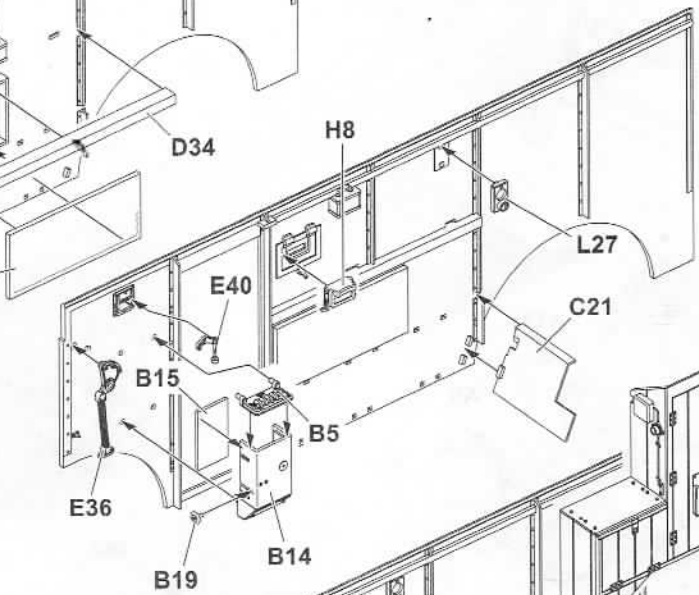
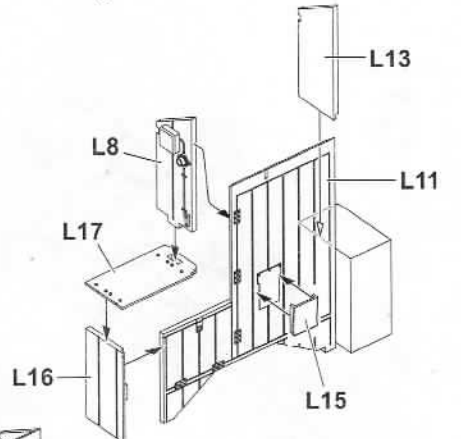
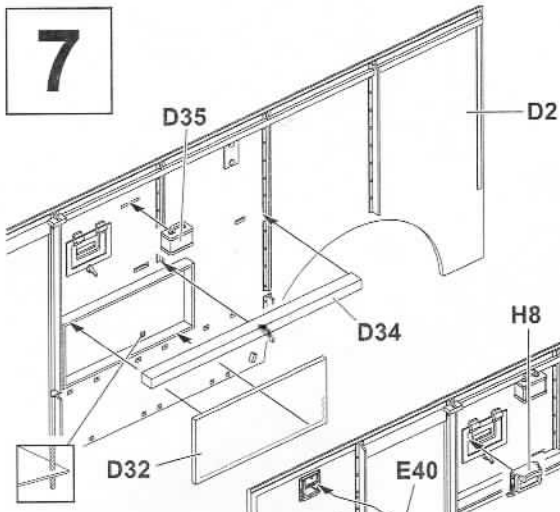

8

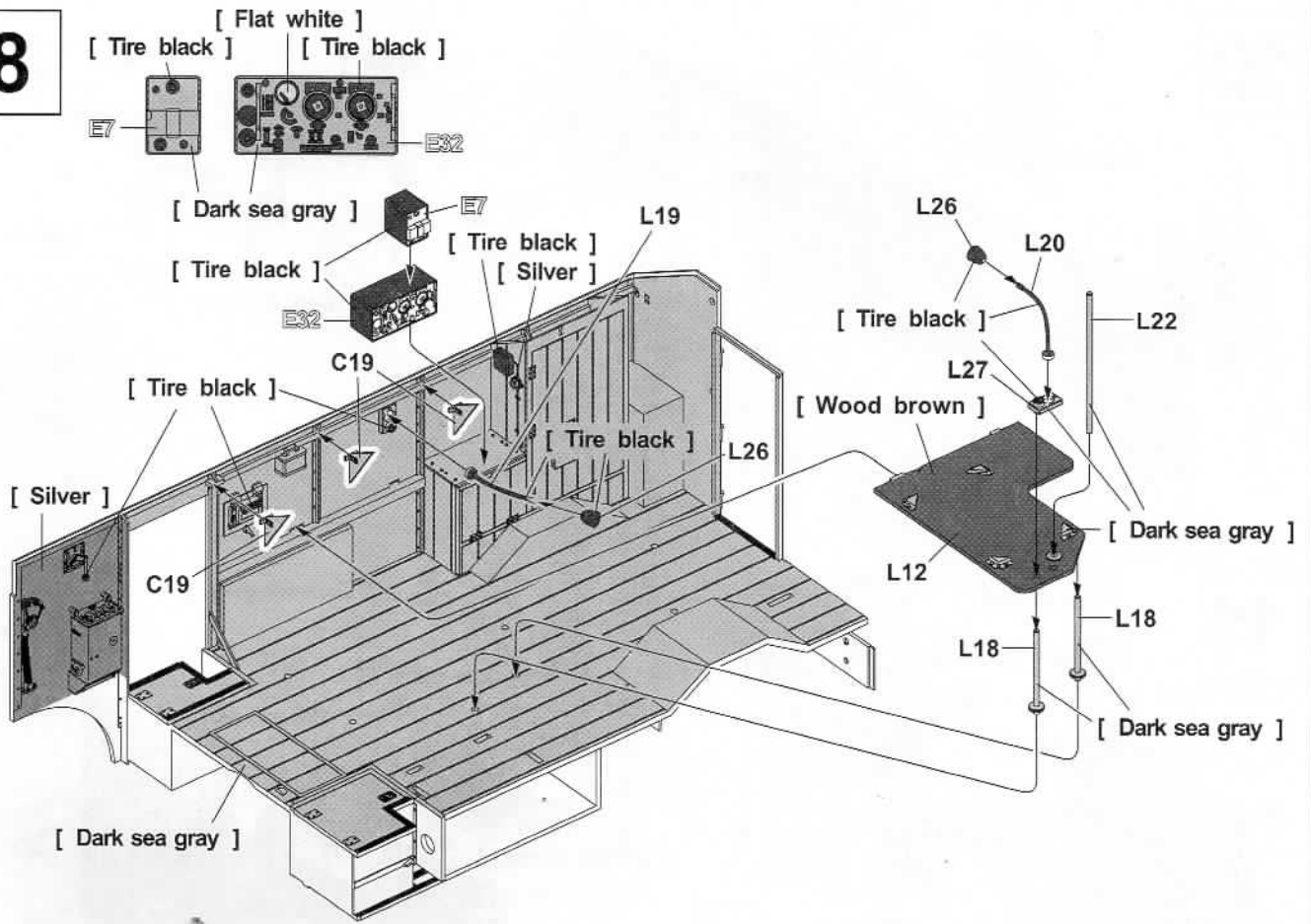

9

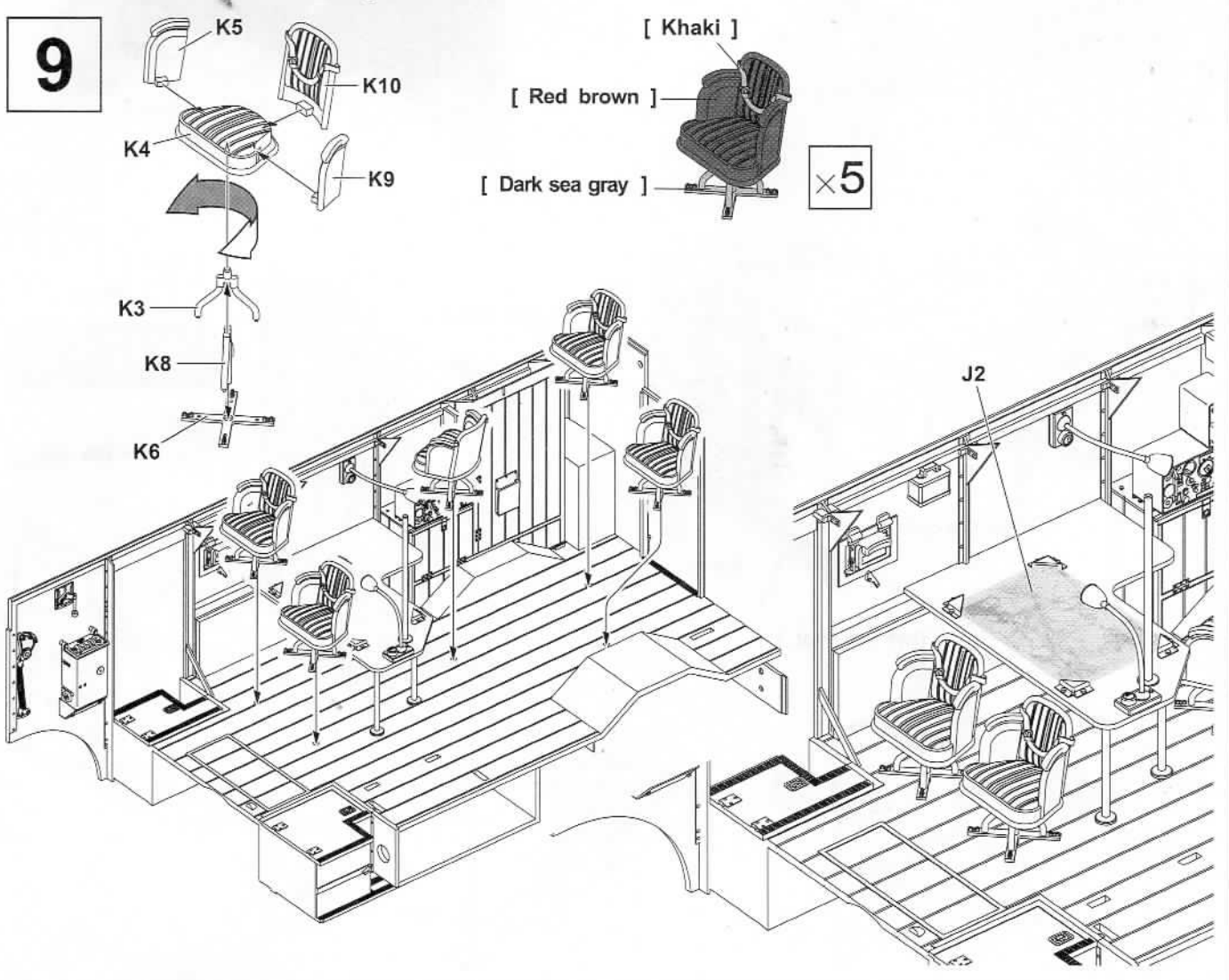

# 10

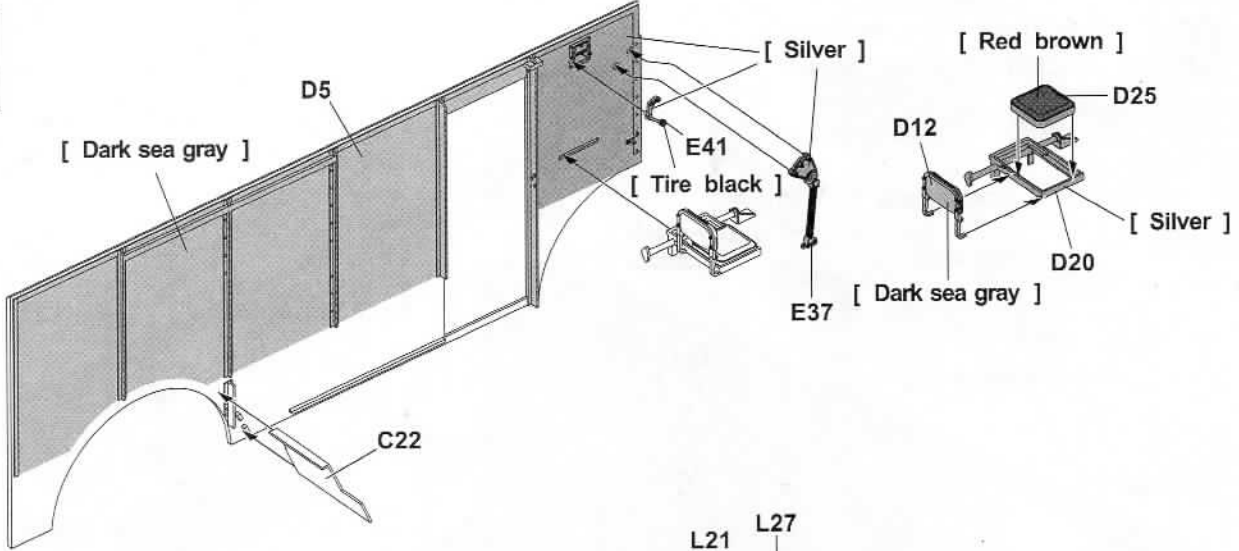

# 11

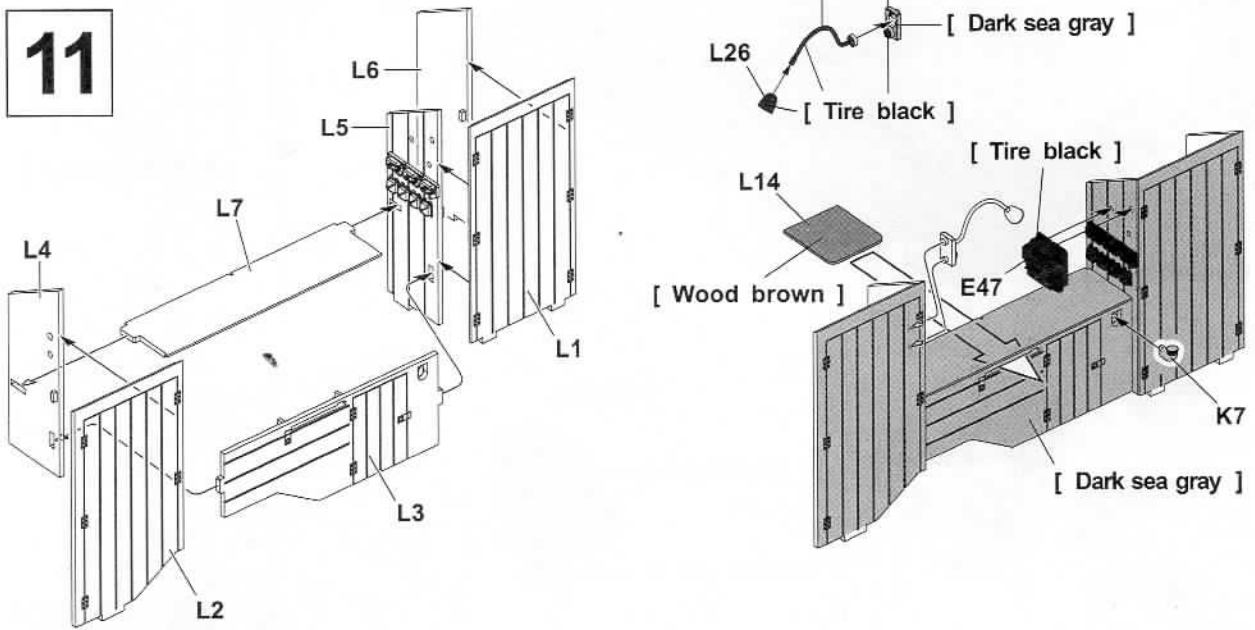

# 12

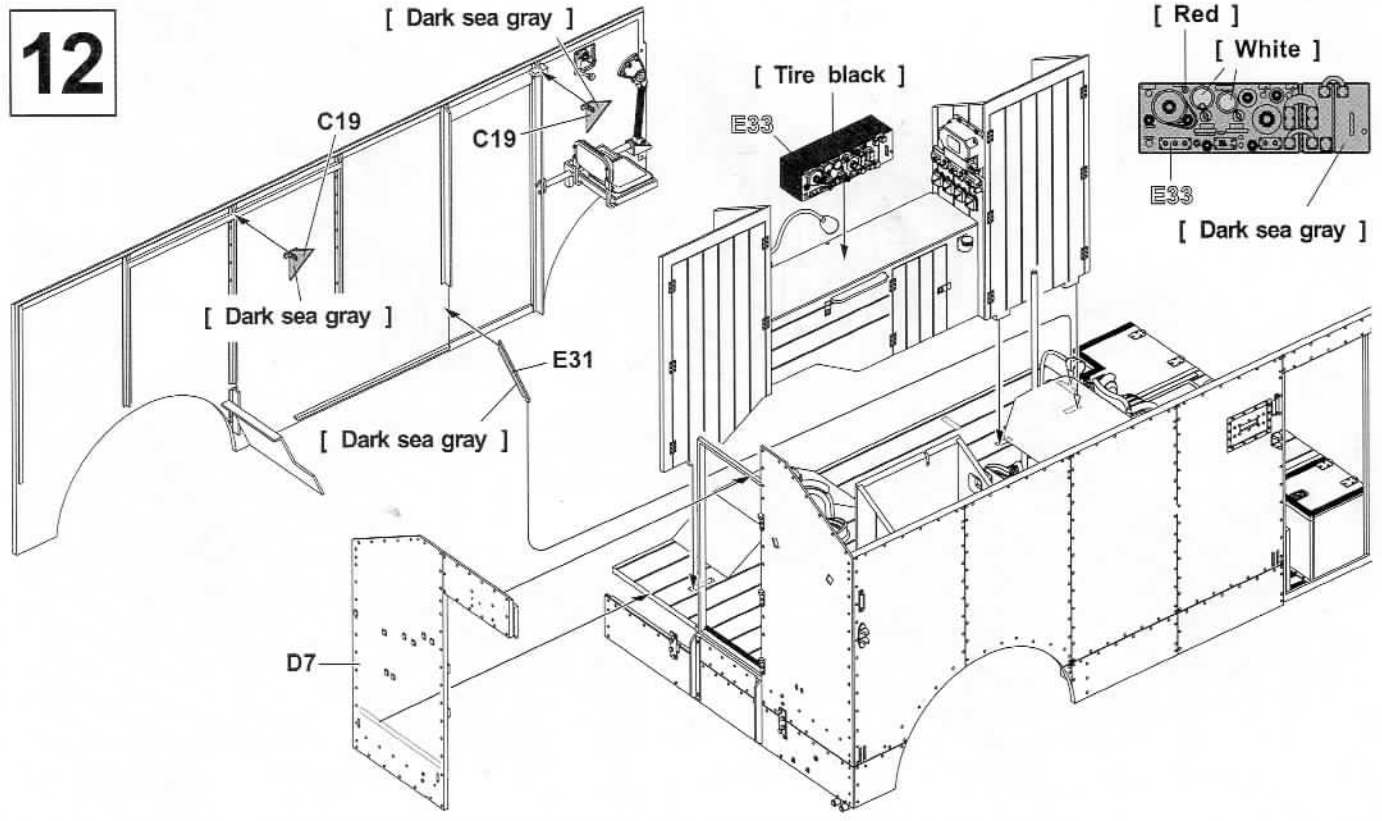



13

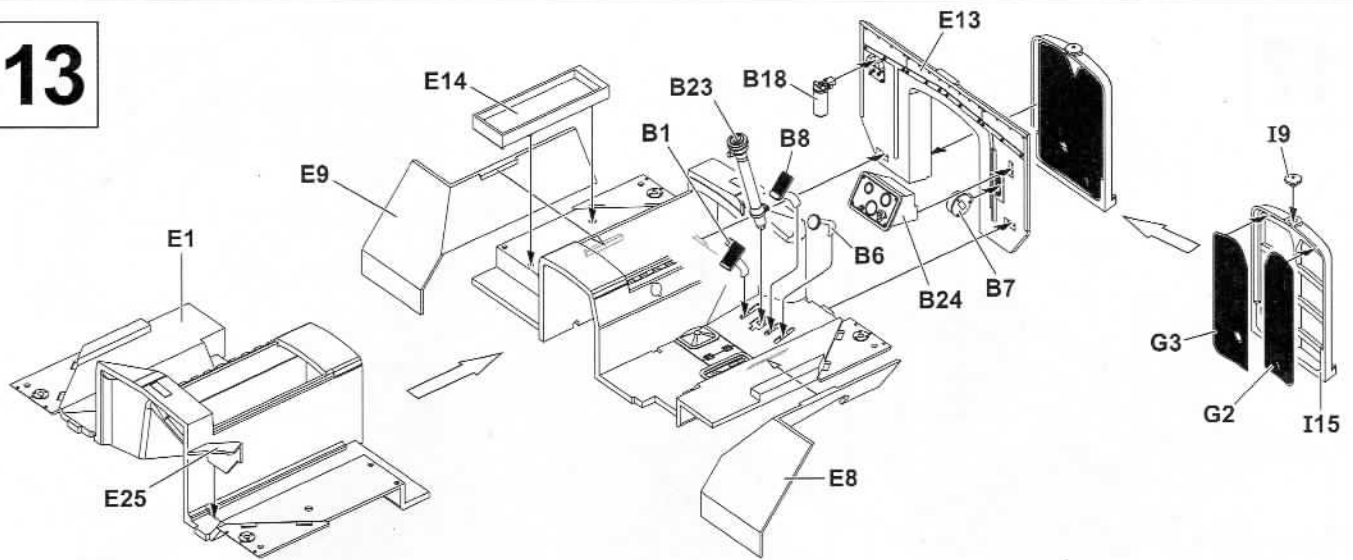

14

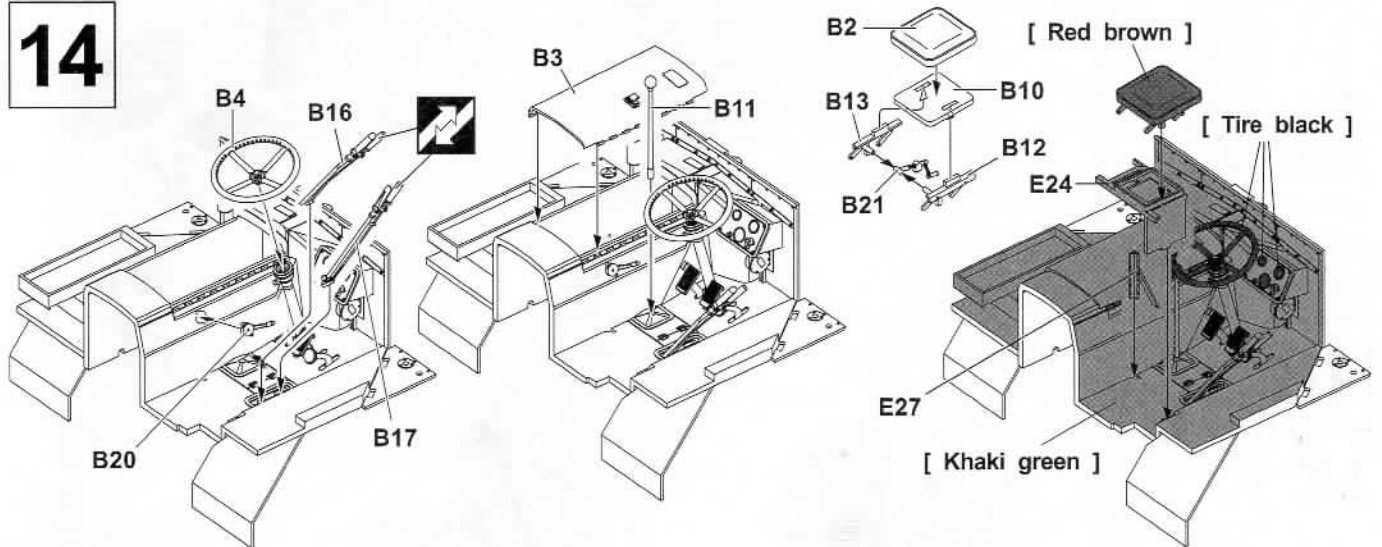

15

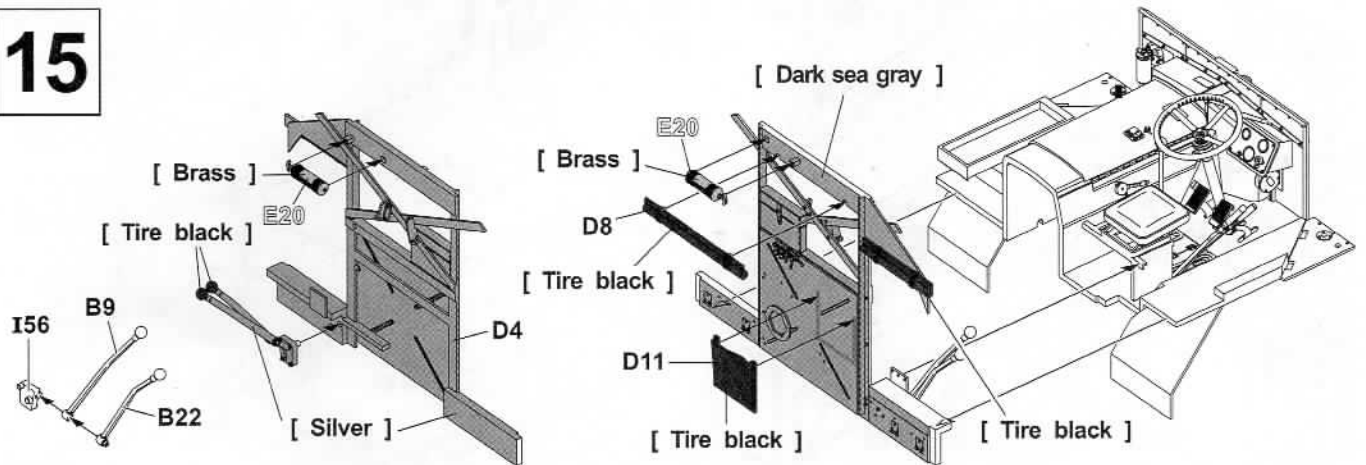

16

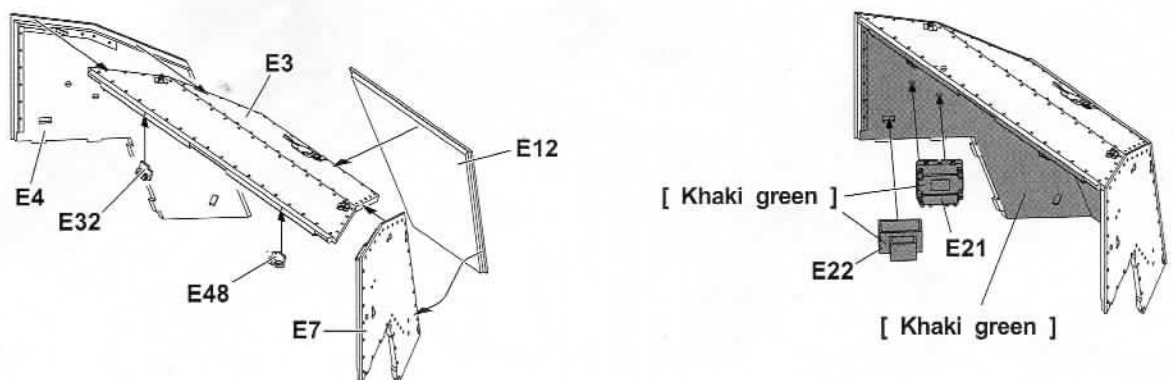

17

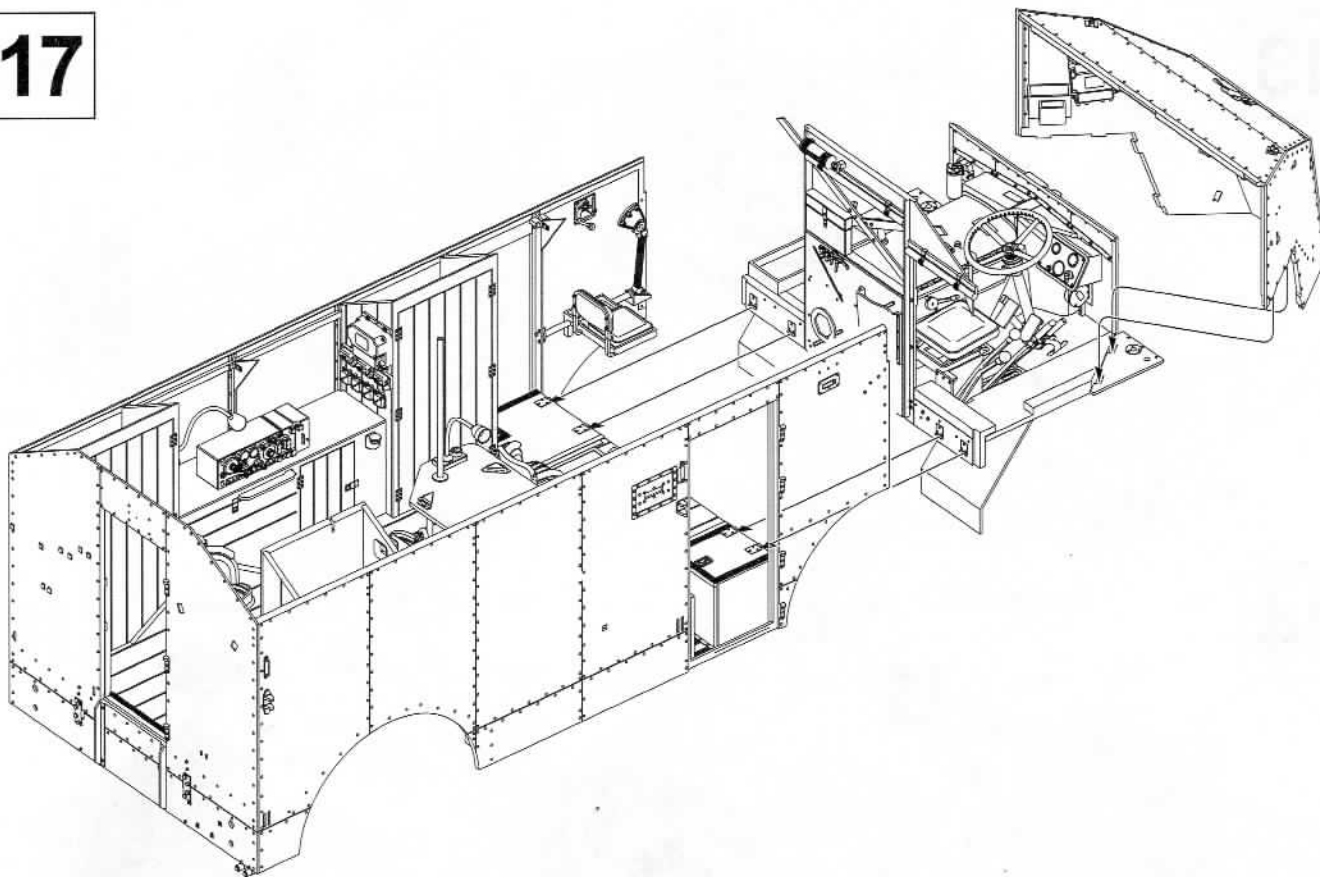

18

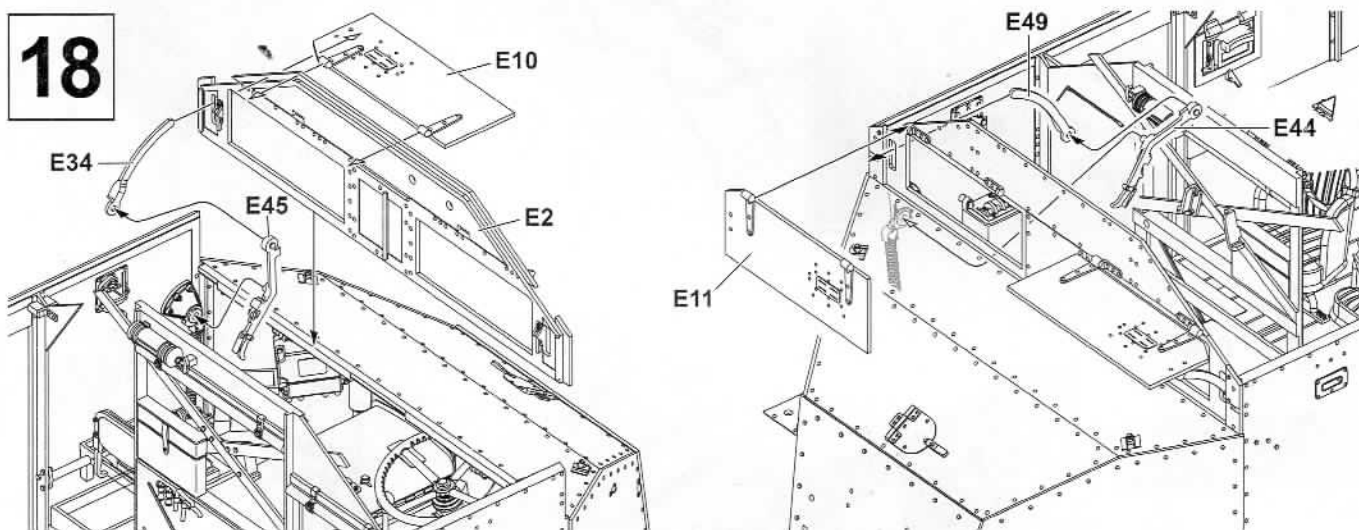

19

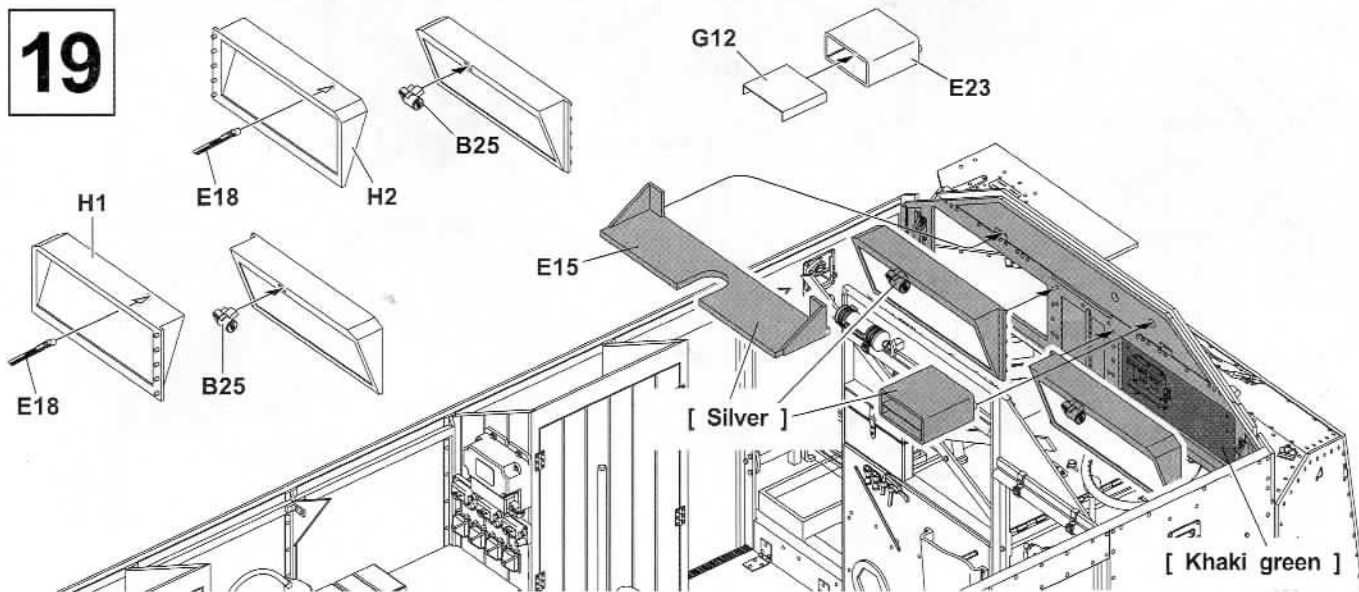

20

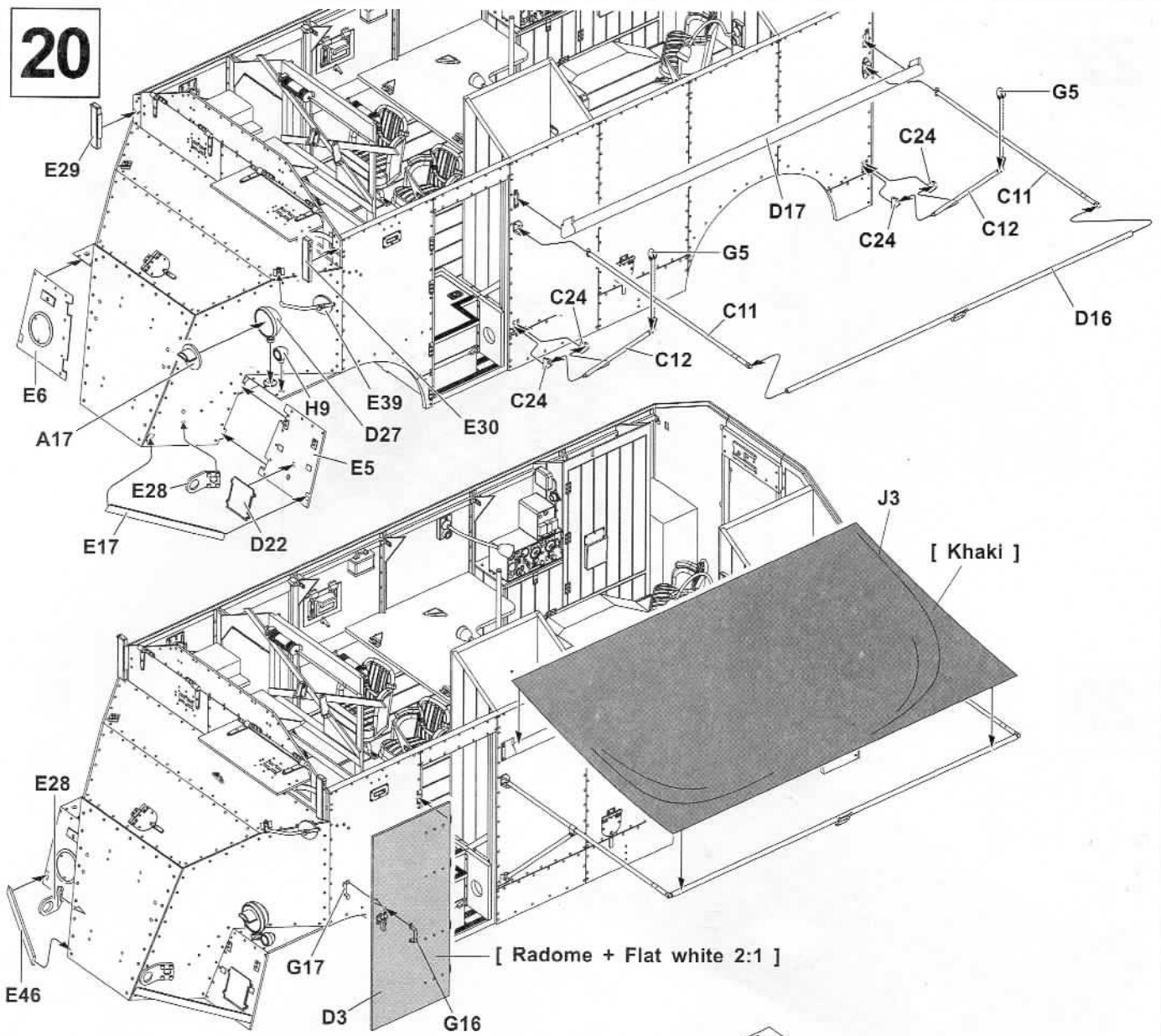

21

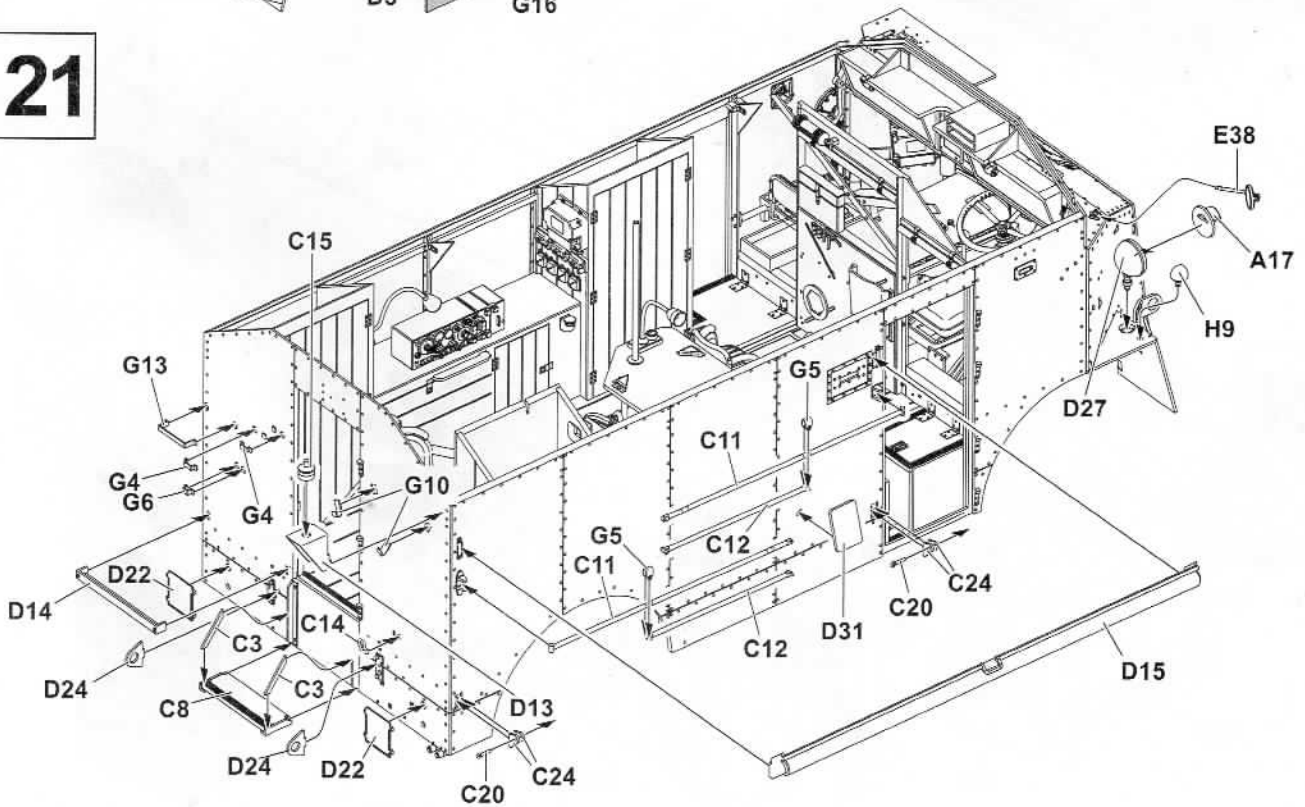

22

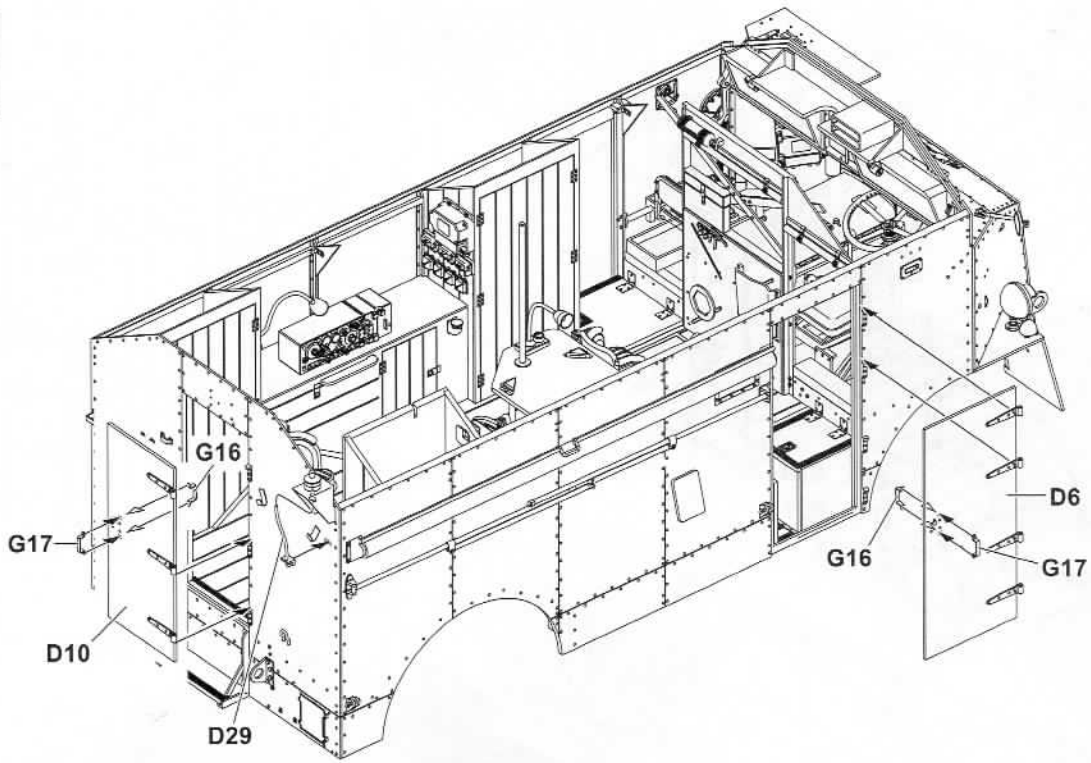

23

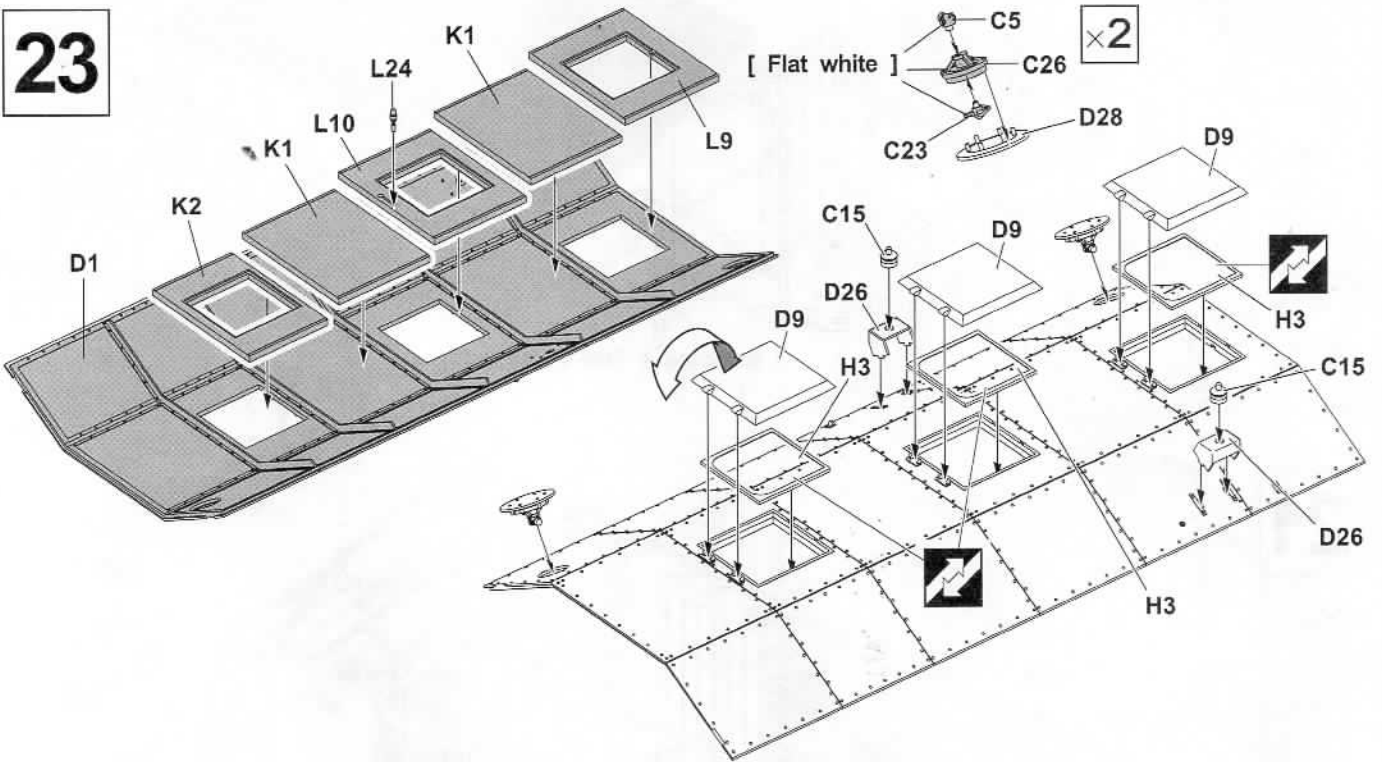

24

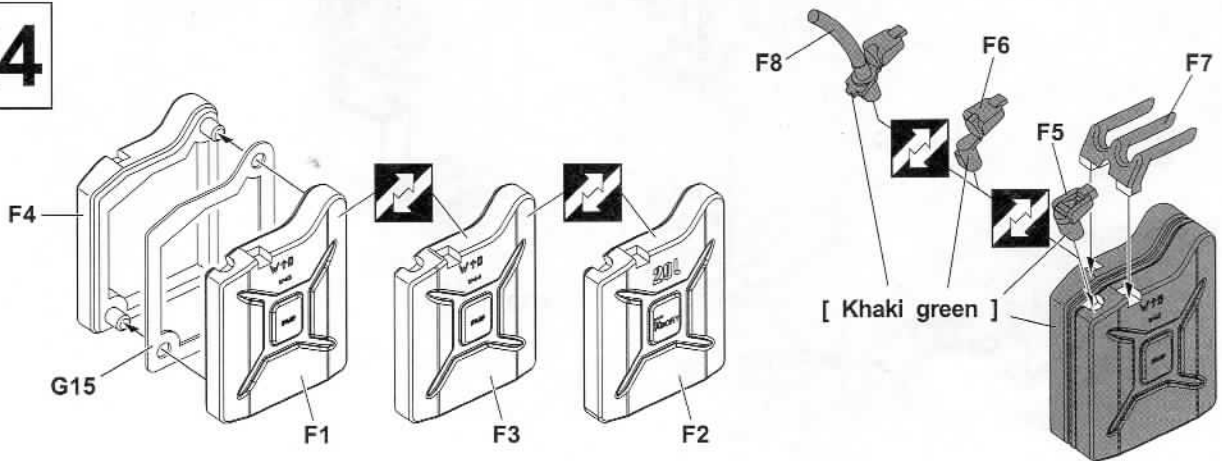

22

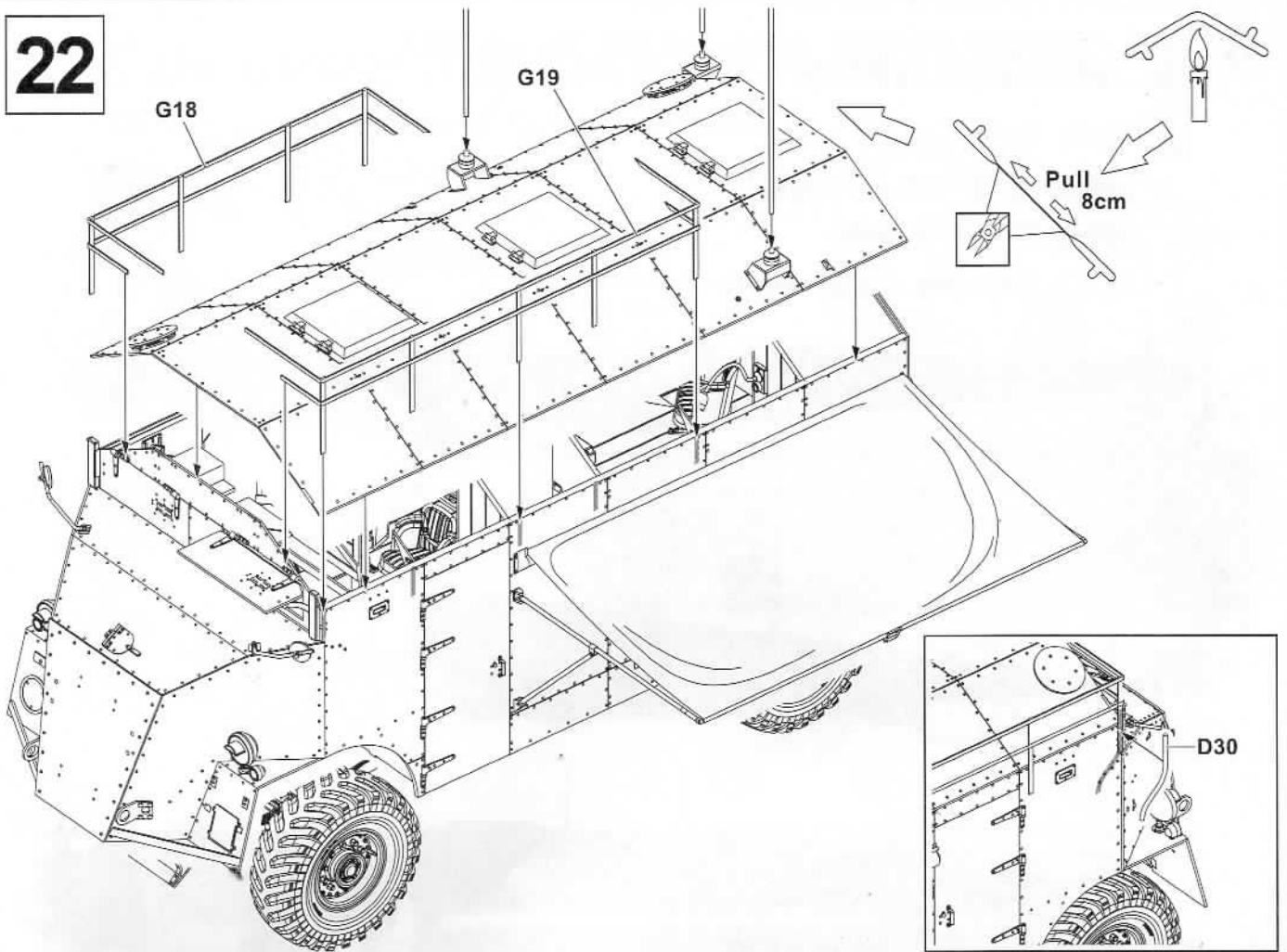

A

3rd Armoured Brigade, 2nd Armoured Division, Spring 1941  
第2装甲師第3装甲旅，1941年春



Body Color:  RLM71 Dark Green  Gray FS26440  
 Radome + Flat White 2:1

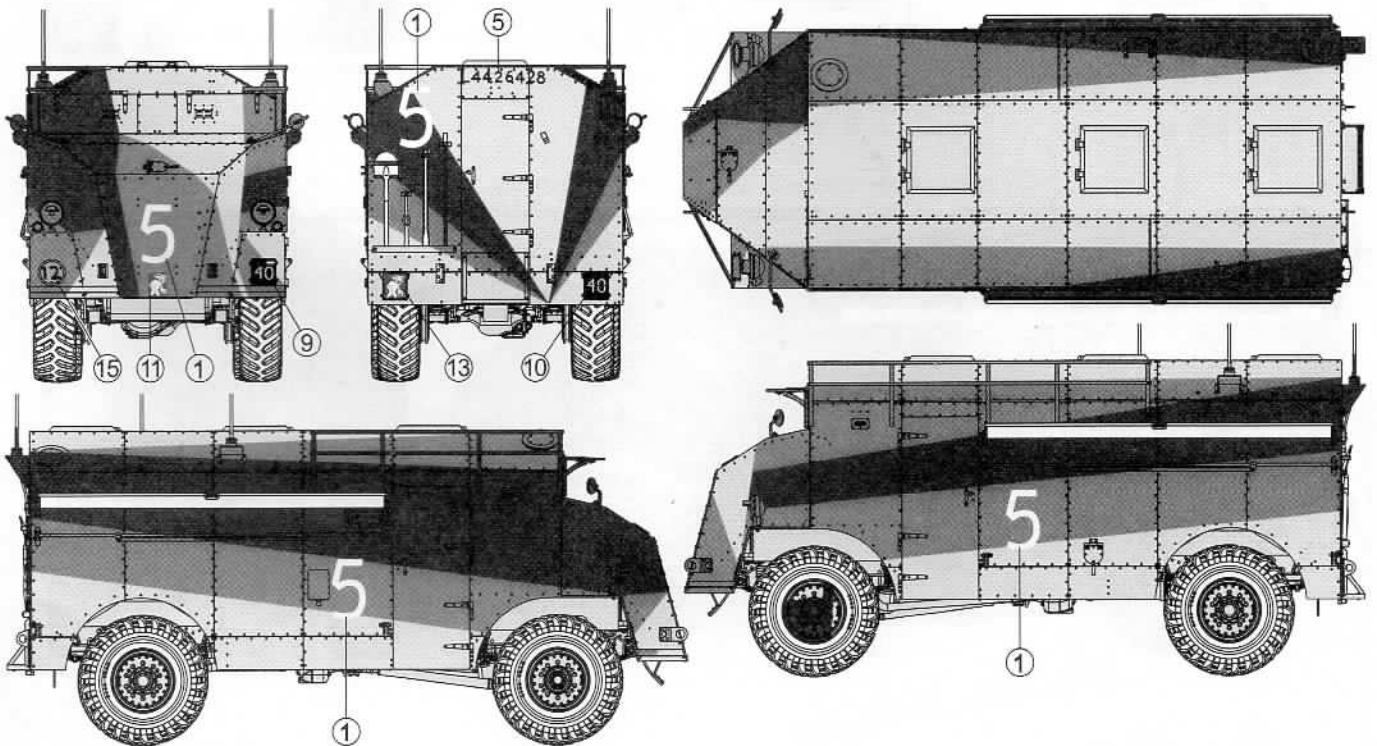

B

2nd Armoured Division, Advanced HQ, Spring 1941  
第二装甲師指揮部, 1941年春



Body Color:

-  RLM71 Dark Green
-  Gray FS26440
-  Radome + Flat White 2:1

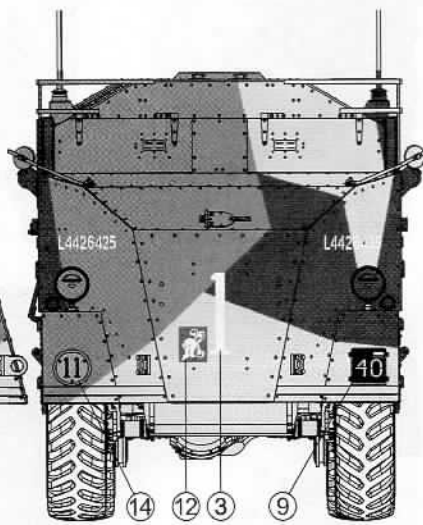
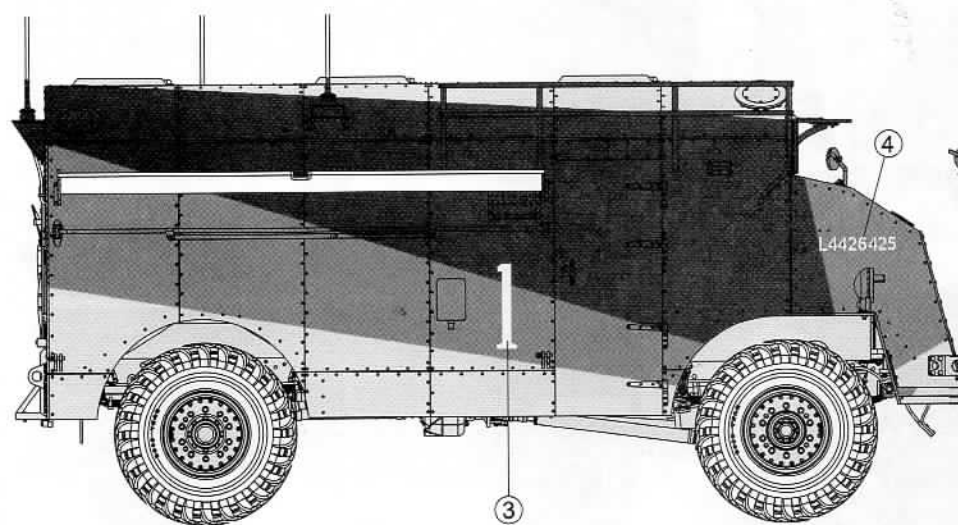
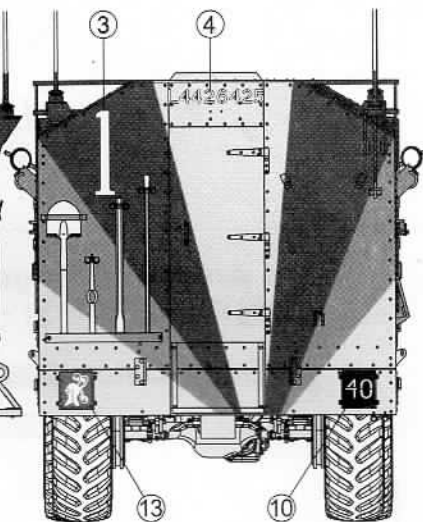
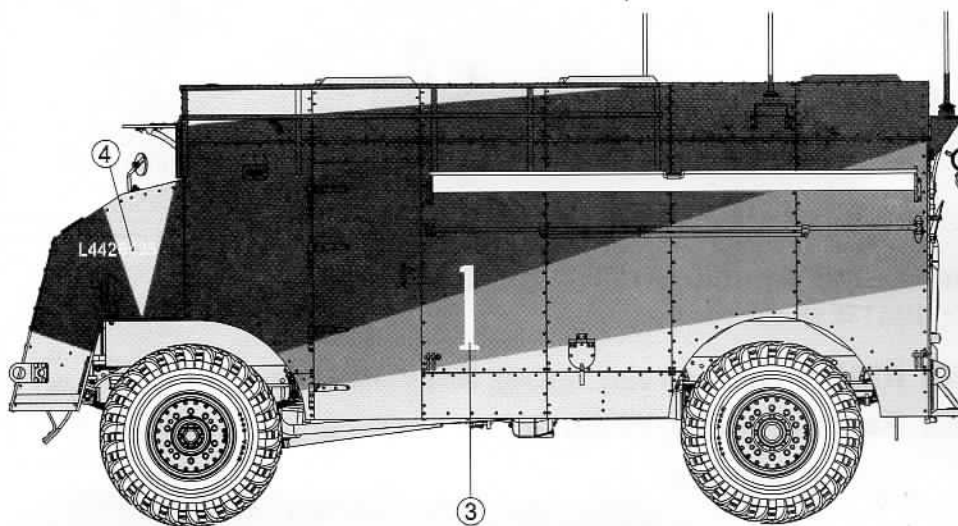
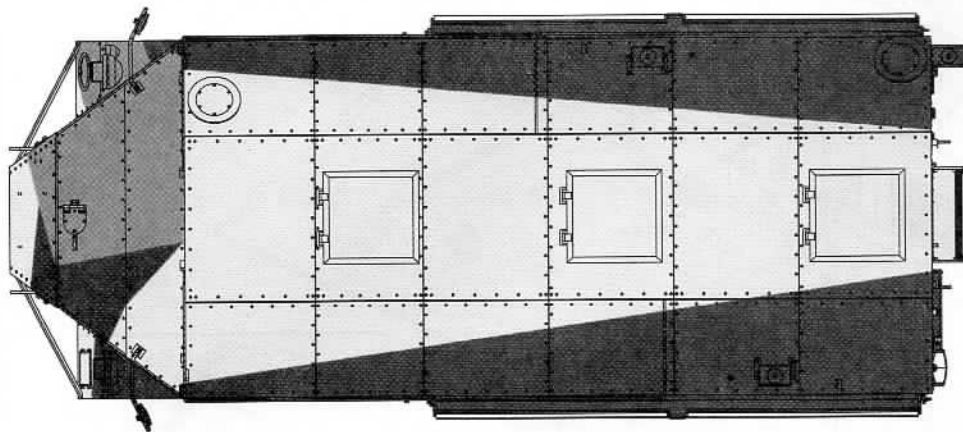

C

2nd Armoured Division, Advanced HQ, Spring 1941  
第二装甲師指揮部, 1941年春



Body Color:

RLM71 Dark Green

Gray FS26440

Radome + Flat White 2:1

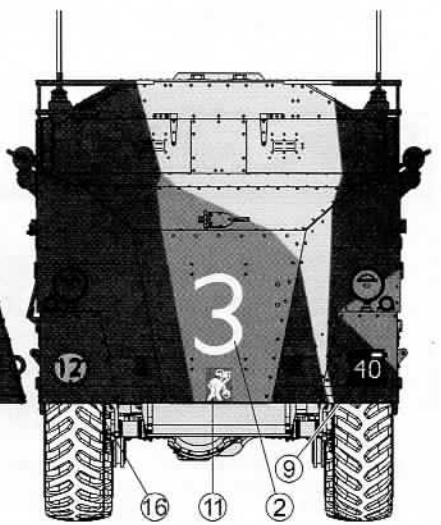
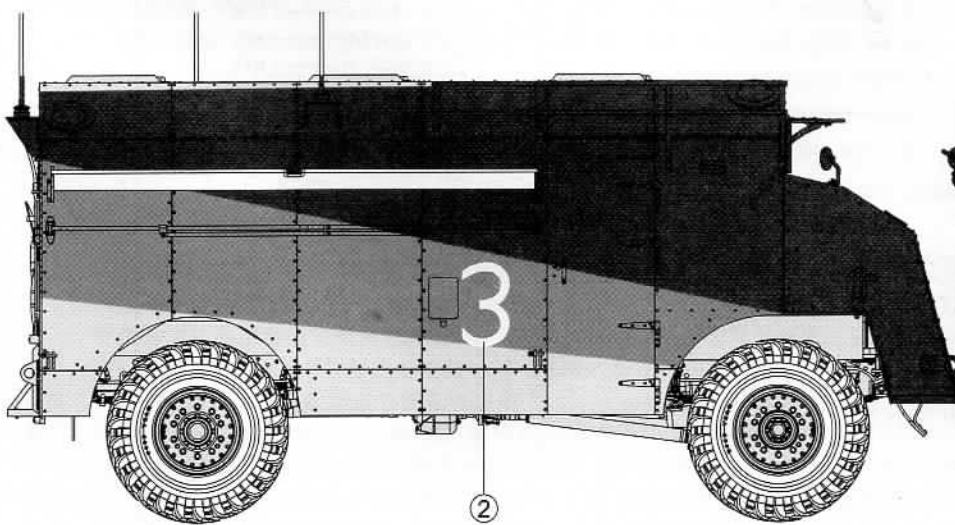
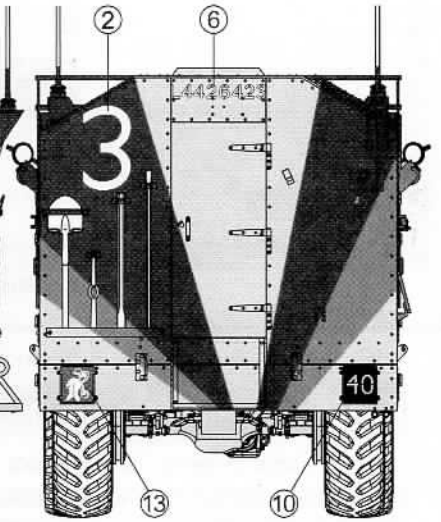
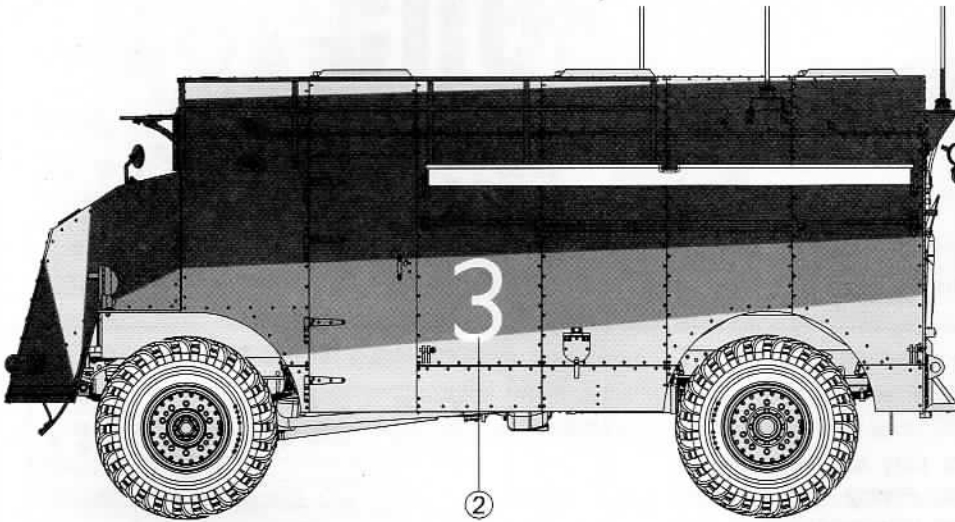
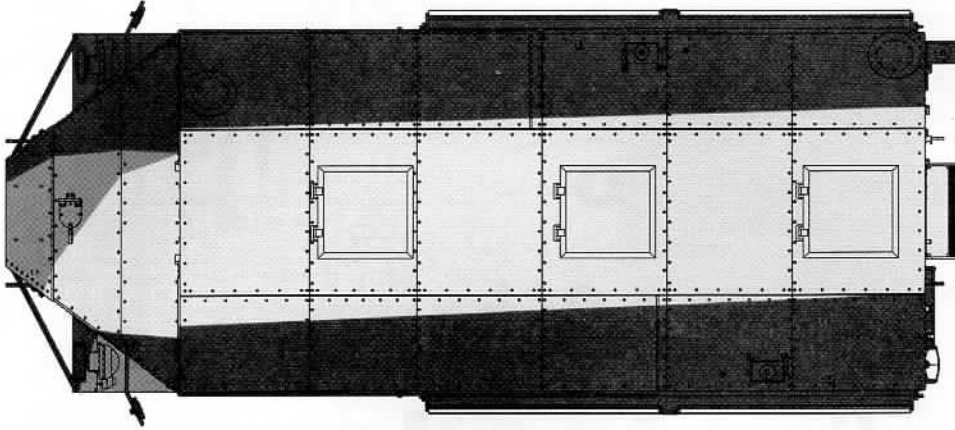

# PARTS LIST 零件表

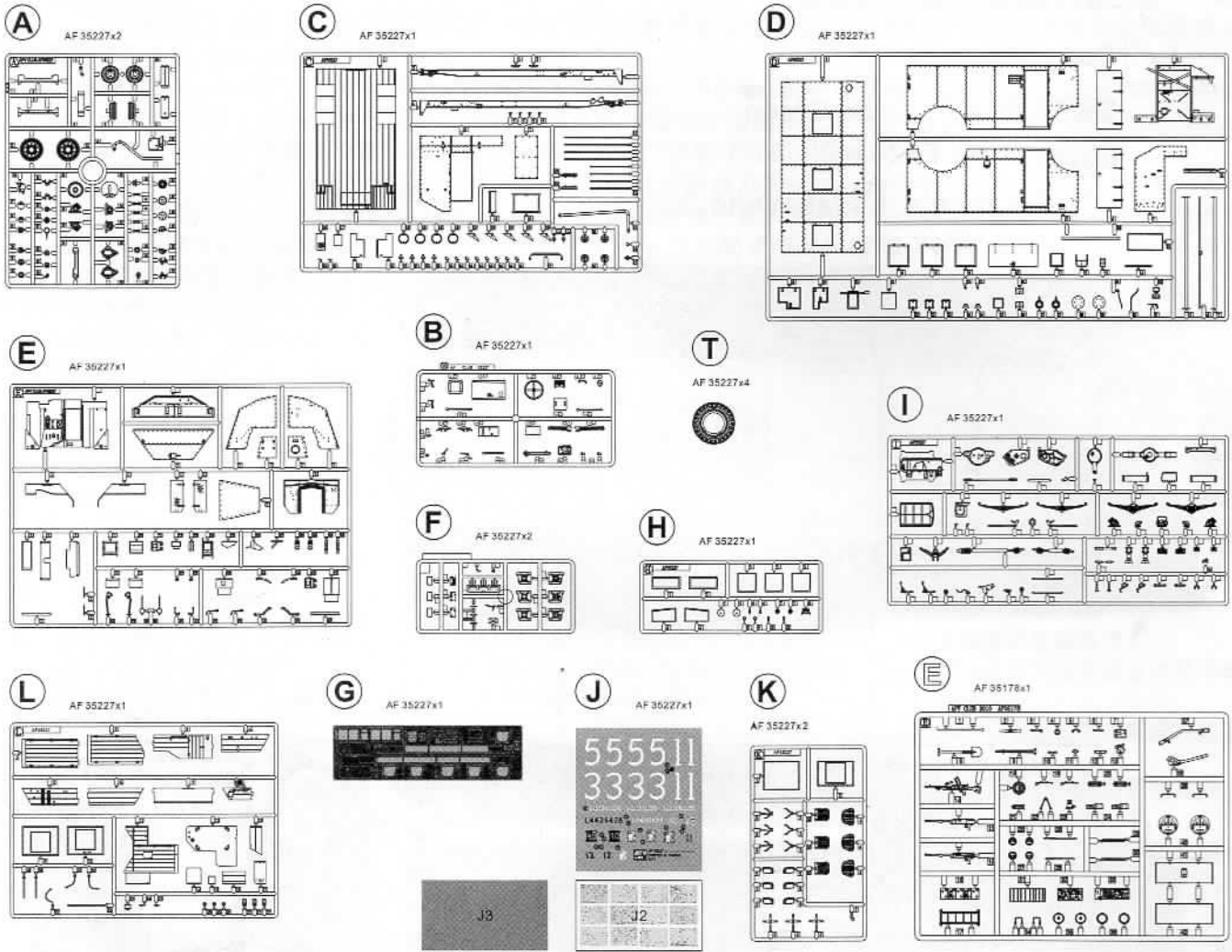

## Instructions:

If for some reason, you are not fully satisfied or have questions concerning our product; Please use the form provide, and send it to our nearest representative or mail it directly to our office.

We will deal with that A.S.A.P.

**AGV CLUB** **AF 35227**  
Parts Replacement Form

<input type="checkbox"/> AF 35227-A <input type="checkbox"/> AF 35227-B <input type="checkbox"/> AF 35227-C <input type="checkbox"/> AF 35227-D <input type="checkbox"/> AF 35227-E <input type="checkbox"/> AF 35227-F <input type="checkbox"/> AF 35227-G	<input type="checkbox"/> AF 35227-H <input type="checkbox"/> AF 35227-I <input type="checkbox"/> AF 35227-J <input type="checkbox"/> AF 35227-K <input type="checkbox"/> AF 35227-L <input type="checkbox"/> AF 35227-T <input type="checkbox"/> AF 35178-E
---	---

Reason for replacement:  Missing  Broken

Signature: \_\_\_\_\_

限臺灣地區使用 For Taiwanese use only!

<b>AGV CLUB</b>	<b>AF 35227</b>	申請人 姓名 地址 電話
<b>零件補充申請表</b>		
<input type="checkbox"/> AF 35227-A ——— NT\$ 350 <input type="checkbox"/> AF 35227-B ——— NT\$ 120 <input type="checkbox"/> AF 35227-C ——— NT\$ 250 <input type="checkbox"/> AF 35227-D ——— NT\$ 280 <input type="checkbox"/> AF 35227-E ——— NT\$ 300 <input type="checkbox"/> AF 35227-F ——— NT\$ 150 <input type="checkbox"/> AF 35227-G ——— NT\$ 220 <input type="checkbox"/> AF 35227-H ——— NT\$ 180 <input type="checkbox"/> AF 35227-I ——— NT\$ 300 <input type="checkbox"/> AF 35227-J ——— NT\$ 250 <input type="checkbox"/> AF 35227-K ——— NT\$ 250 <input type="checkbox"/> AF 35227-L ——— NT\$ 280 <input type="checkbox"/> AF 35227-T ——— NT\$ 120 <input type="checkbox"/> AF 35178-E ——— NT\$ 200		
+郵寄費 ——— NT\$ 80		
(請填)總計NT\$ _____		
零件補充原因:(請於 <input type="checkbox"/> 打 <input checked="" type="checkbox"/> ) 原包裝即 <input type="checkbox"/> 遺失或 <input type="checkbox"/> 毀損, 製作途中 <input type="checkbox"/> 遺失或 <input type="checkbox"/> 毀損, 其他原因 _____		

總代理戰鷹企業有限公司收本公司將儘速為您處理。  
請將本表與該部品相同金額之郵政匯票一同寄至。