

Hiller X-18

1/72 scale resin model kit
#AA-2011

During early 1955, Hiller Aircraft designed a large, tilting-wing V/STOL aircraft as an in-house study. In 1956, U.S. Air Force interested this concept and assigned contract to Hiller for the development of a V/STOL cargo transport. The test bed was designated X-18. In order to speed the construction process and to conserve available Air Force funding, the X-18 was built from existing materials, such as a fuselage from C-122, turboprops engines from XFV-1 and XFY-1, miscellaneous parts from R3Y. The prototype was completed and started to proceed with ground testing in 1958. A year later, it made first flight without any difficult. After a total of 20 flights were completed, Air Force ended its flight-testing and set aside for ground tests again to develop a database for the upcoming XC-142 transport project. In 1964, the X-18 was disassembled for scrap.

Specifications:

Wingspan - 48 ft
 Length - 63 ft
 Height - 24 ft 7 in
 Powerplants - Allison YT40-A-14 turboprop x 2
 Westinghouse J34-We-36 turbojet x 1
 Crew - 2
 Max speed - 253mph

The X-18 was tested on the Ground Effect Simulation test stand



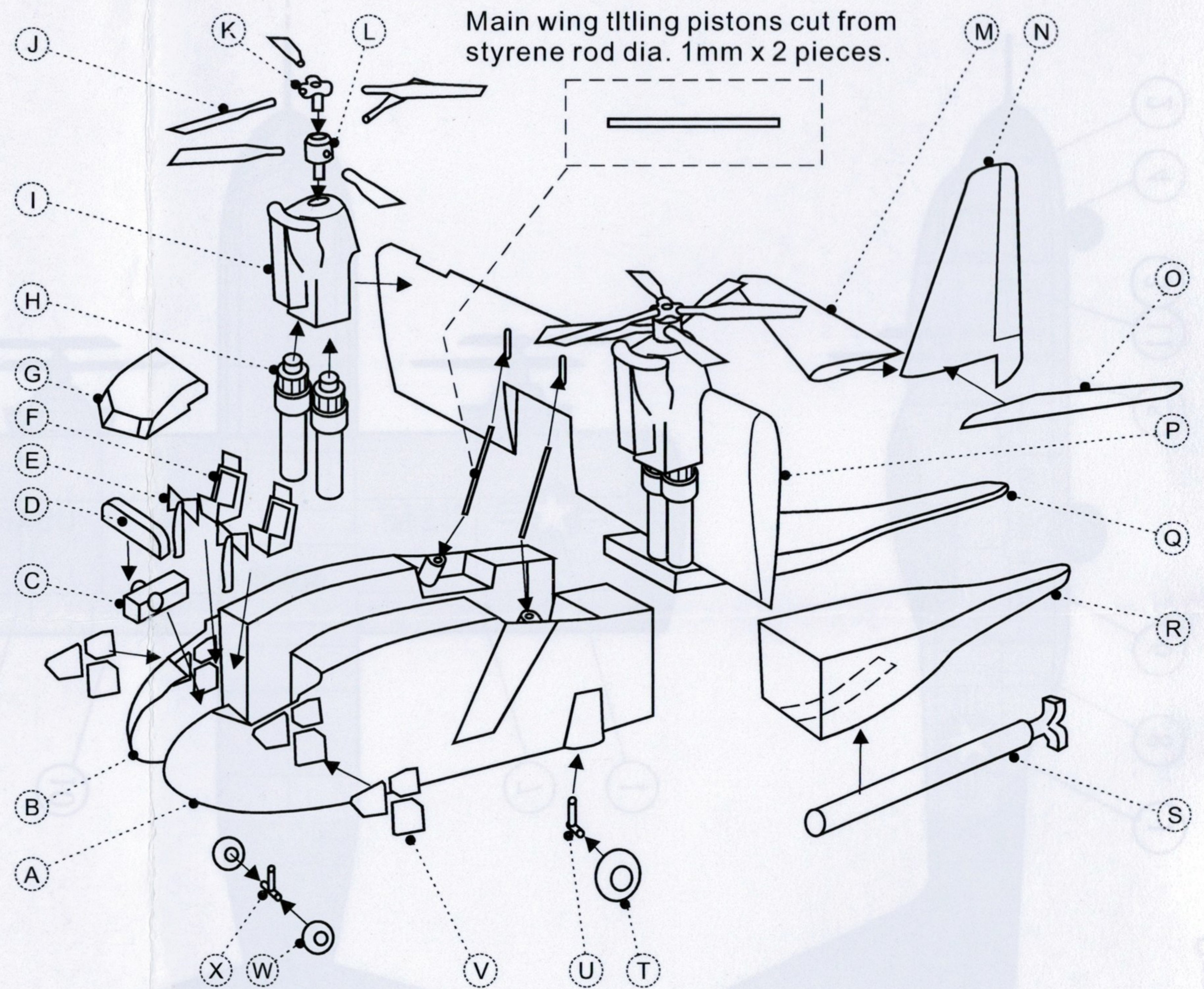

ANIGRAND
CRAFTSWORK

PO Box 40, Texaco Road,
 NT., Hong Kong.
 E-mail : email@anigrand.com
 Web : www.anigrand.com



- | | |
|--------------------------------|---------------------------------------|
| (A) Left fuselage x 1 | (M) Right tail plane x 1 |
| (B) Right fuselage x 1 | (N) Rudder x 1 |
| (C) Center console x 1 | (O) Left tail plane x 1 |
| (D) Instrument panel x 1 | (P) Main Wing x 1 |
| (E) Control levers x 2 | (Q) Rear fuselage top x 1 |
| (F) Pilot seats x 2 | (R) Rear fuselage bottom x 1 |
| (G) Canopy (clear blister) x 1 | (S) Yaw exhaust pipe x 1 |
| (H) Engine exhaust pipes x 4 | (T) Main landing wheels x 2 |
| (I) Engine nacelles x 2 | (U) Main landing gears x 2 |
| (J) Propeller blades x 12 | (V) Side windows (clear blisters) x 2 |
| (K) Top spinners x 2 | (W) Nose landing wheels x 2 |
| (L) Main spinners x 2 | (X) Nose landing gear x 1 |

Painting & Decals

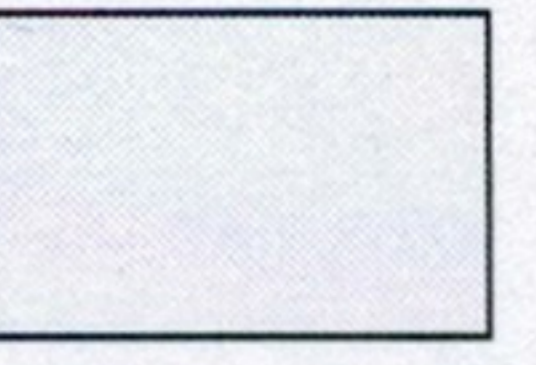
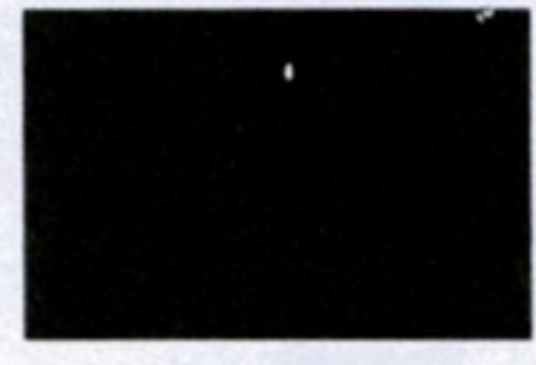
- 
 Aluminium Silver
(Overall)
- 
 Burn Iron
(Exhaust)
- 
 Red
(Nose)
(Wing tips)
(Rudder)
- 
 Mid Grey
(Cockpit Interior)
- 
 Black
(Propellers)
(Tires)

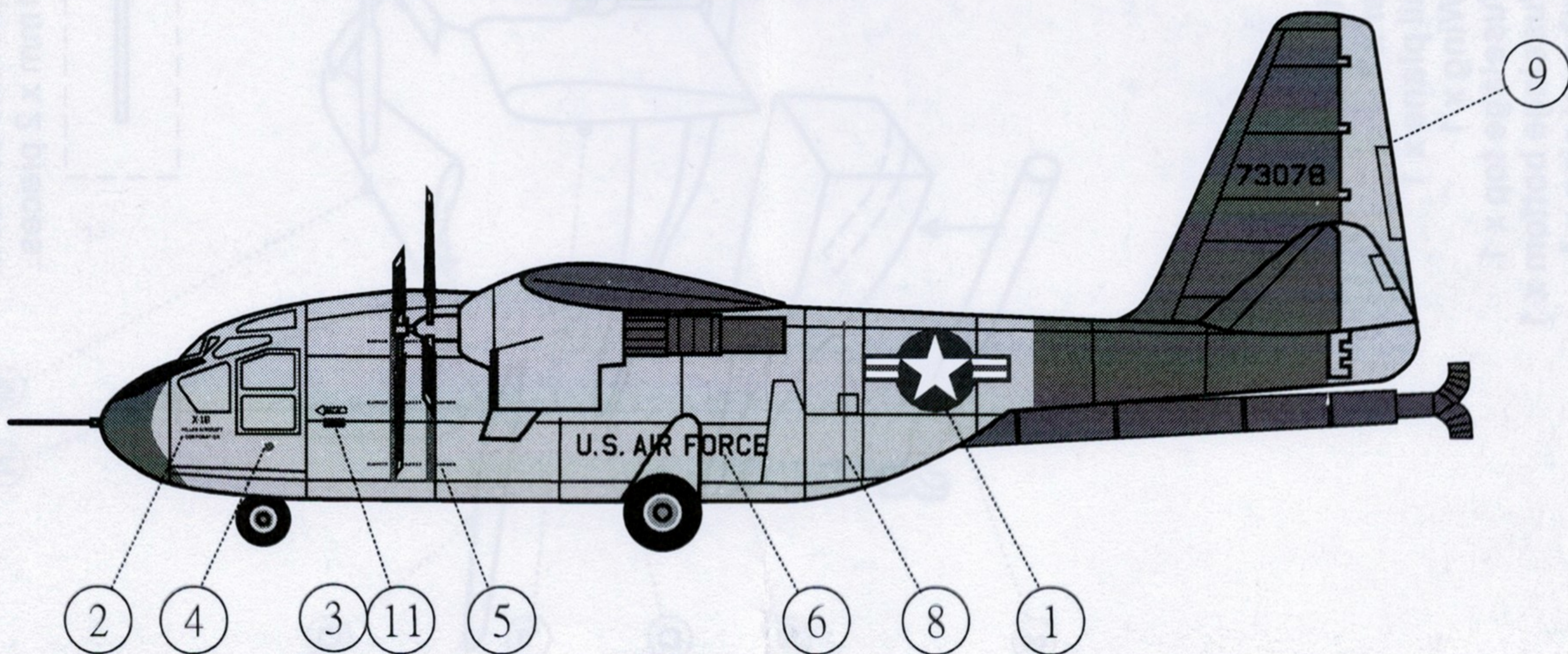
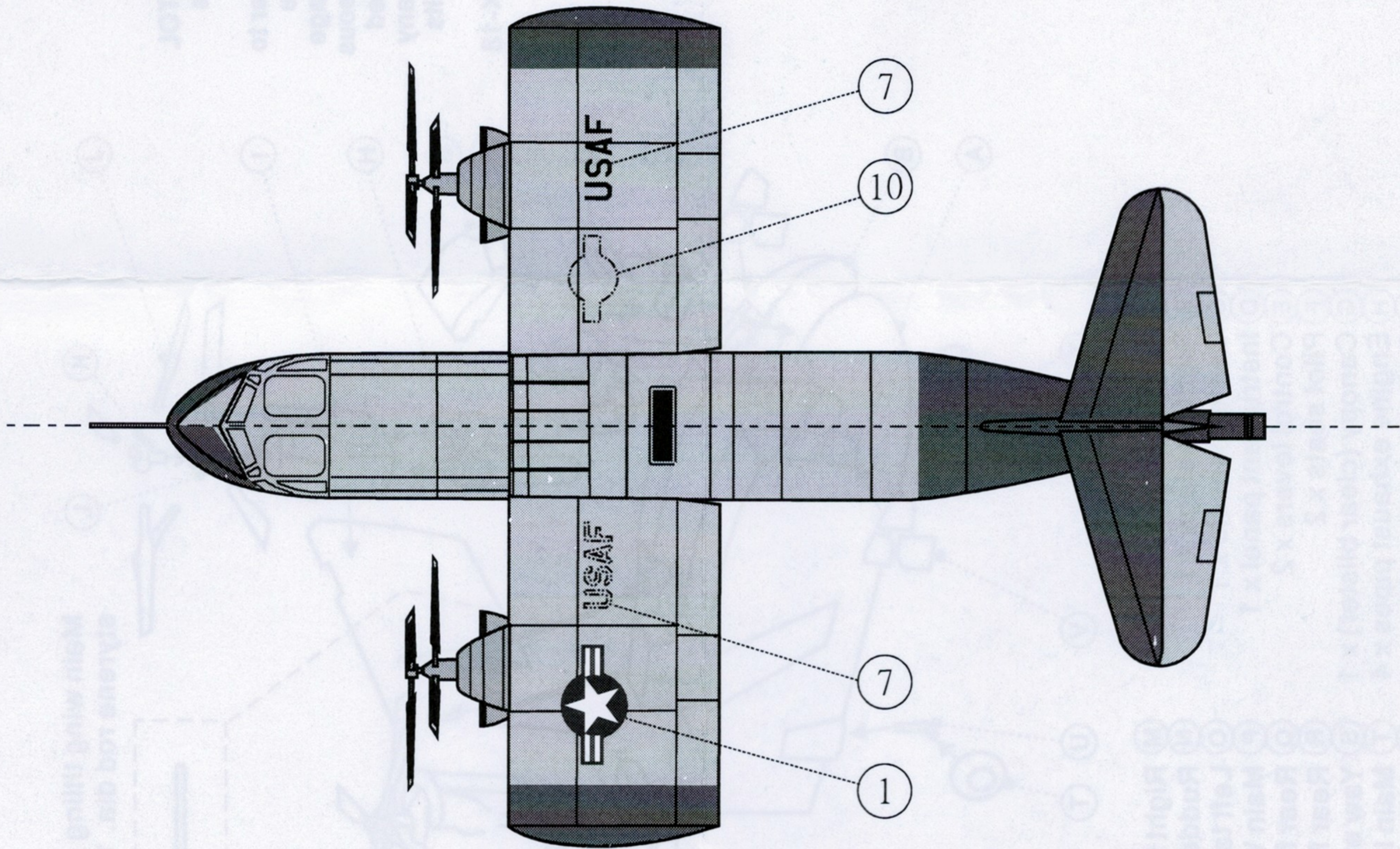
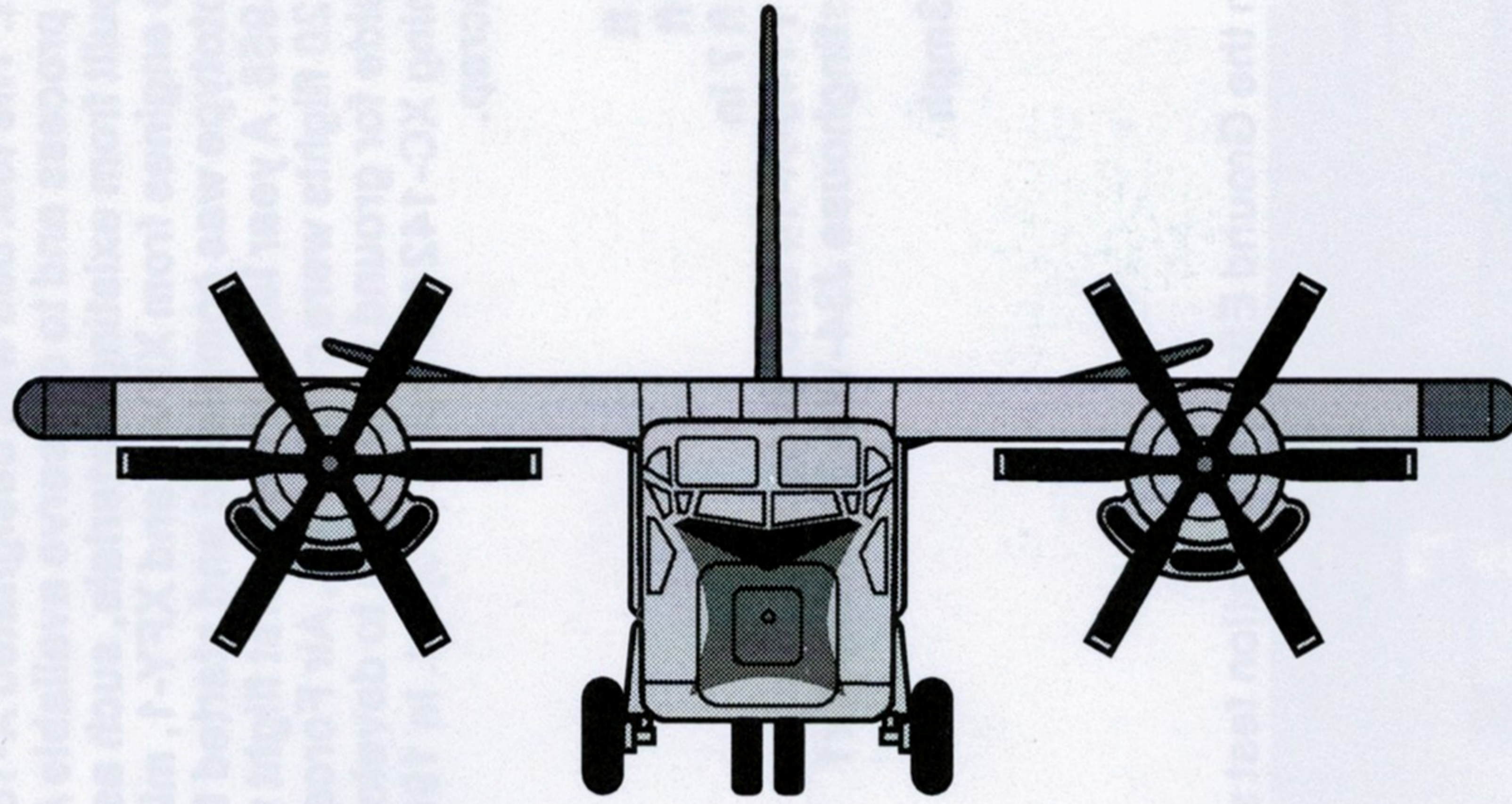

Drawing scale: 1/144