

# RNZAF - A-4K SKYHAWK

1/72  
SCALE

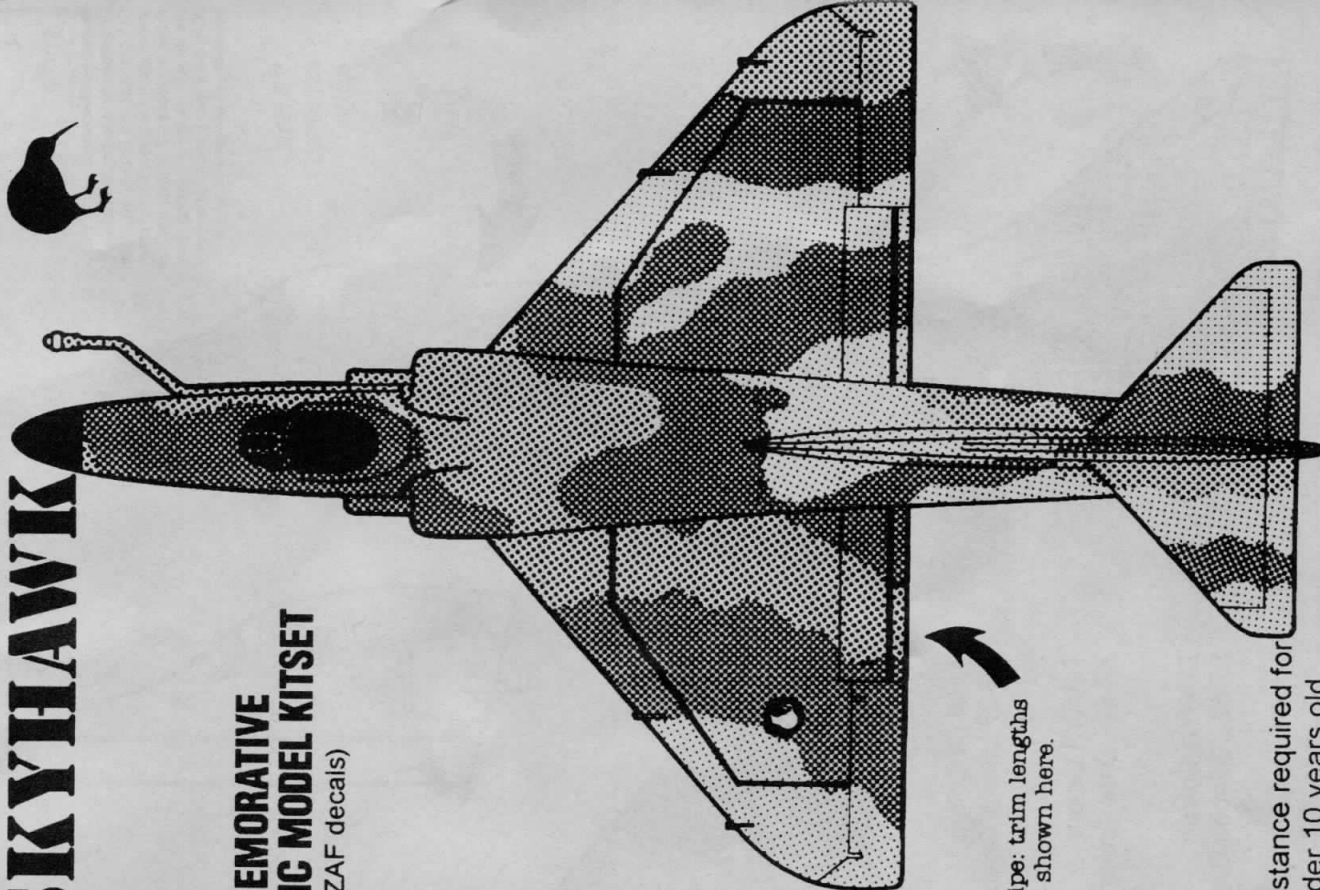

**COMMEMORATIVE  
PLASTIC MODEL KITSET**  
(with RNZAF decals)



Red stripe: trim lengths  
to fit as shown here.

Parental assistance required for  
modellers under 10 years old

## The role of the RNZAF and the Skyhawk

An air combat force is designed to make rapid responses to a range of challenges by sea, land or air. The RNZAF's frontline offensive and defensive combat aircraft is the McDonnell Douglas A-4K Skyhawk of Nos 75 and 2 Squadrons based at Ohakea. The Skyhawk is a versatile aircraft with the ability to provide close support of ground troops with ground attack and offensive maritime air support operations.

Fundamentally the Skyhawk is a highly manoeuvrable aerial weapons system that can deliver rockets, bombs, cannon fire and missiles with great accuracy.

## An Historical Overview of the RNZAF Skyhawk

In 1970, fourteen A-4K and TA-4K Skyhawks (T = twin seat for training) entered service. An additional ten were bought second-hand from the Royal Australian Navy in 1984. Between 1970 and 1990 three Skyhawks have been irreparably damaged in crashes. Of the remaining 21 aircraft, six belong to No.2 Squadron, which, since March 1991, has been based at RANAS Nowra, NSW, flying air defence support for the Australian Defence Forces and continuing to provide aircrew conversion to type and operational training. The RNZAF's primary strike unit, No.75 Squadron, based at RNZAF Base Ohakea, is responsible for the other 15 Skyhawks in the tactical jet fighter role, supporting both Army and Navy operations. No. 75 Squadron is prepared for deployment overseas at short notice.

In 1986 a major upgrade to the Skyhawk fleet began, extending its operational lifespan and combat effectiveness well into the next century. Under Project Kahu which was completed in 1991, each aircraft has been fitted with modern avionics systems, including an inertial navigation platform, head-up display and multi-mode radar. A Skyhawk's combat payload is 3727 kgs of rockets, bombs, missiles and cannon in any combination and its air-to-air refuelling capability increases both its range and flexibility.

\*\*\*This "Historical Overview" was compiled from The Royal New Zealand Air Force, Yesterday and Today (NSN 7530-98-202-9238) and RNZAF 990 (NSN 7530-98-203-2396).



Directions for applying the decals:  
 Cut the required decals out of the sheet, dip them into a dish of clean water for about 1/2 minute, position the decals on the kit, letting them slide from the paper. For a better adhesion press with a clean rag.

75 Sqn.  
 aircraft  
 only.

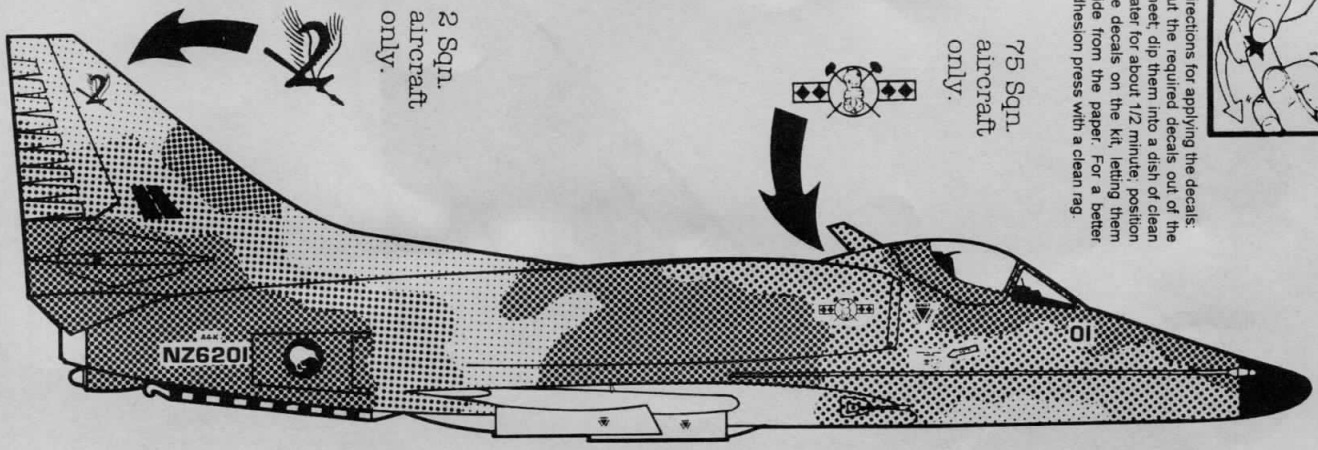

2 Sqn.  
 aircraft  
 only.

75 Sqn is based at RNZAF Ohakea, North Island, New Zealand

Gloss  
 Black  
 TAMIYA  
 X-1

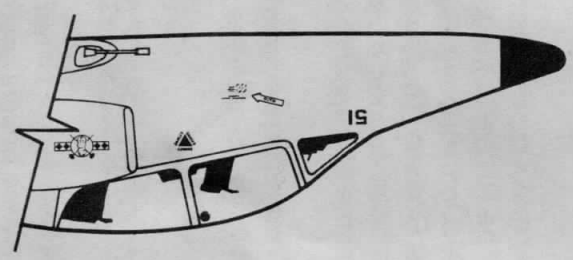
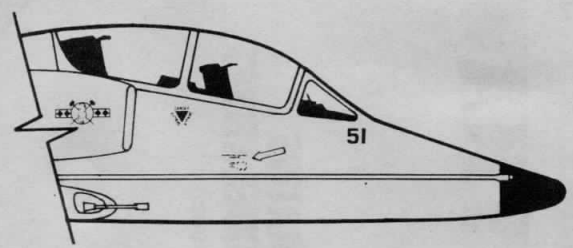

75 Sqn.  
 aircraft  
 only.

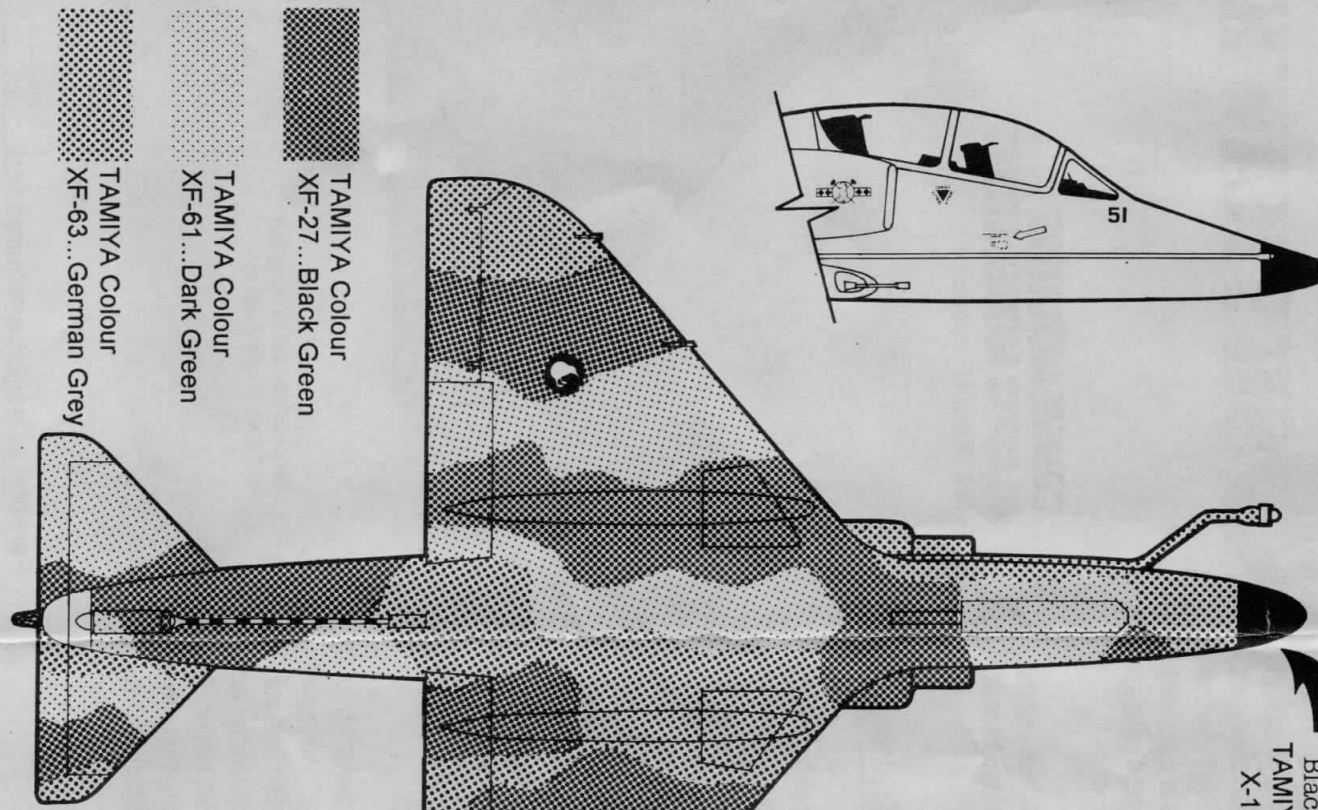

- TAMIYA Colour  
 XF-27... Black Green
- TAMIYA Colour  
 XF-61... Dark Green
- TAMIYA Colour  
 XF-63... German Grey

2 Sqn is currently based at HMAS Albatross, Nowra, New South Wales, Australia.

Camouflage scheme is standard on both single-seat A-4Ks and twin-seat TA-4Ks. Aircraft are rotated regularly between 2 Sqn. and 75 Sqn.

2 Sqn.  
 aircraft  
 only.

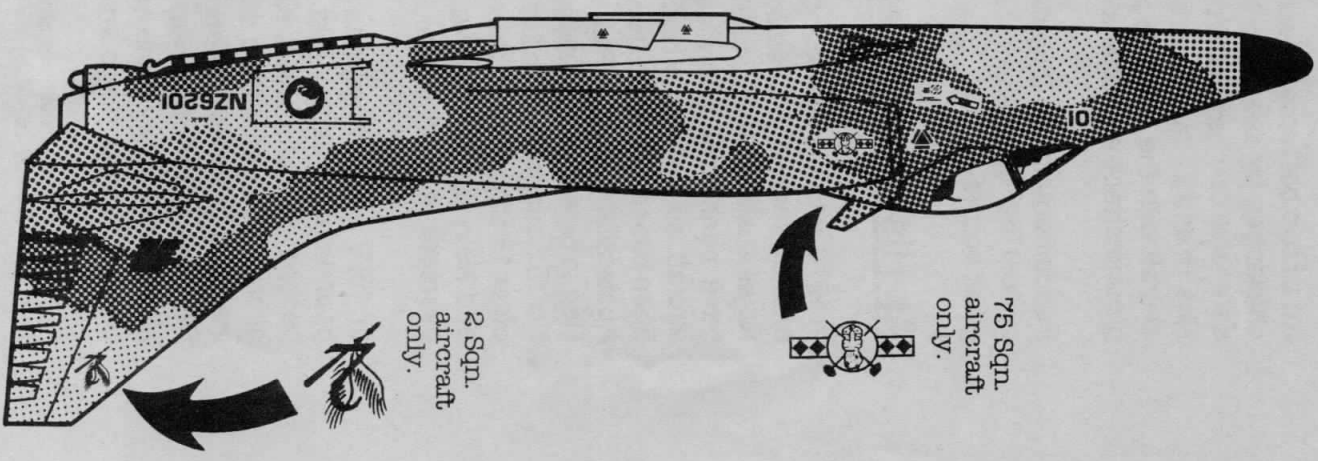

Sincere thanks goes to Flight Sergeant Bruce Mulcock of the Maintenance Support Squadron, Aircraft Finishing, RNZAF Ohakea, for his time and help in supplying all the necessary information to make this decal sheet possible.

# BRNZAIF - SKYHAWK T/A-4K

## ATTENTION: Useful Advice

Study the instructions carefully prior to assembly. Remove parts from frame with a sharp knife or sprue cutters and trim away excess plastic. Do not pull off parts. Assemble the parts in numerical sequence. Use plastic cement only and use it sparingly to avoid damaging the model. Black arrows indicate parts to be glued together. White parts indicate that parts must be assembled without using cement. A, B, C indicate on which frame the parts will be found. Paint small parts before detaching them from the frame. Remove paint from parts that are to be cemented. Crossed out parts must not be used.

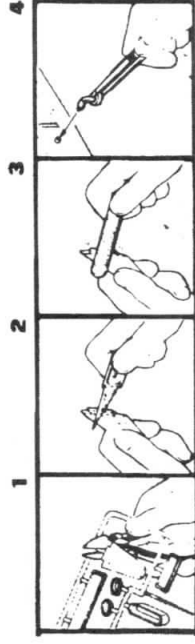

**A** **B**

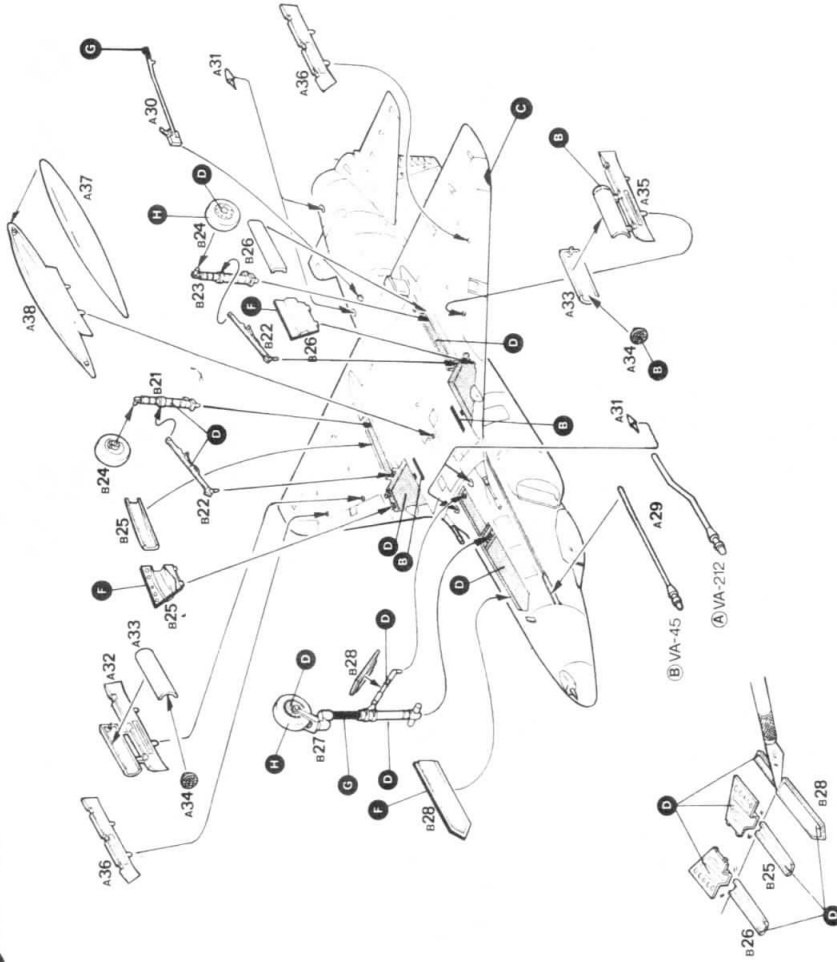
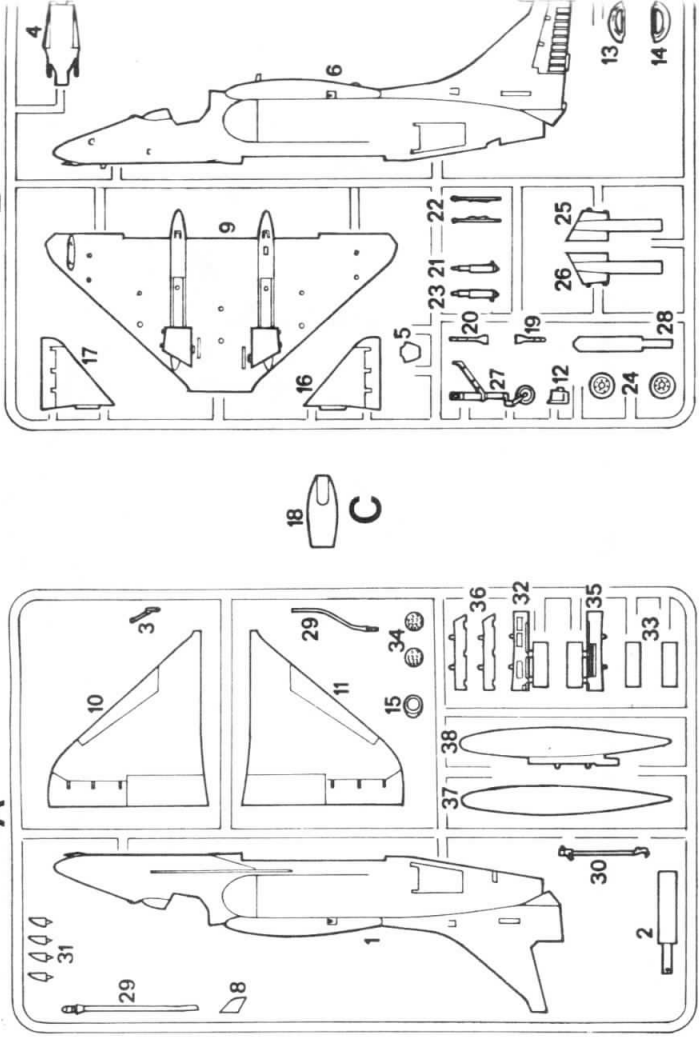



# PAINTING INSTRUCTIONS:

These letters refer to Tamiya paint colours as indicated:

<b>A</b>	refer	TAMIYA	<b>B</b>	Flat	TAMIYA	<b>C</b>	Olive	TAMIYA	<b>D</b>	refer	TAMIYA	<b>E</b>	Gun	TAMIYA	<b>F</b>	Red	TAMIYA	<b>G</b>	Chrome	TAMIYA	<b>H</b>	German	TAMIYA
<b>Page</b>			<b>Black</b>			<b>Drab</b>			<b>Page</b>			<b>Metal</b>			<b>X-7</b>			<b>Silver</b>			<b>Grey</b>		
<b>5</b>			<b>XF-1</b>			<b>XF-62</b>			<b>5</b>			<b>X-10</b>			<b>X-11</b>			<b>X-11</b>			<b>XF-63</b>		

## 1 1•8

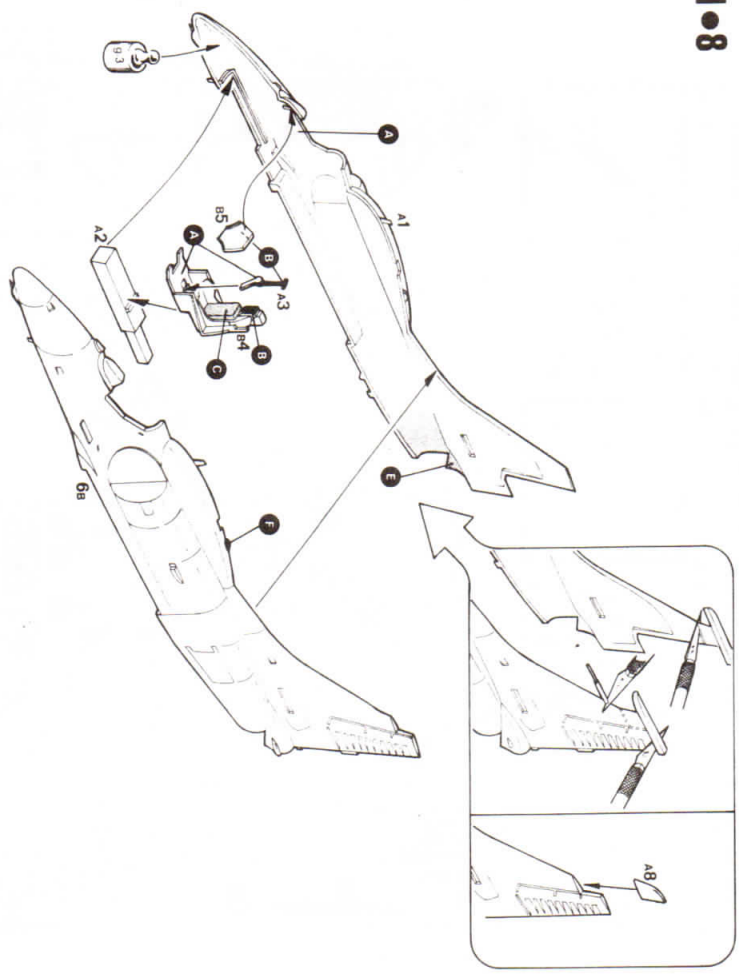

Please Note: When assembling do not use part A7

## 2 9•20

